



COPY TO O.C.G.

IN REPLY REFER TO: ✓

UNITED STATES
DEPARTMENT OF THE INTERIOR
GEOLOGICAL SURVEY
P. O. Box 965
Farmington, New Mexico

June 14, 1956

Skelly Oil Company
Box 426
Farmington, New Mexico

Re: Jicarilla Contract #34

Gentlemen:

Receipt is acknowledged of your "Notice of Intention to Drill" dated June 20, 1956 covering your well No. 2 Jicarilla "C" in SW 1/4 sec. 21, T. 25 N., R. 5 W., N. M., Rio Arriba County, New Mexico, So. Blanco (P.C.) Wildcat (M.V.).

Your proposed work is hereby approved subject to compliance with the provisions of the "Oil and Gas Operating Regulations" revised May 25, 1942, a copy of which will be sent to you on request, and subject to the following conditions:

1. Drilling operations so authorized are subject to the attached sheet for general conditions of approval.
2. Furnish copies of all logs.

Very truly yours,

(Orig. Sgd.) P. T. McGRATH

P. T. McGrath
District Engineer

P.T.McGrath:ac
cc -Jicarilla Agency

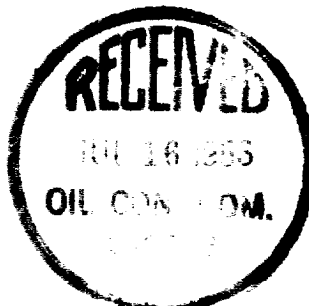

UNITED STATES
DEPARTMENT OF THE INTERIOR
GEOLOGICAL SURVEY

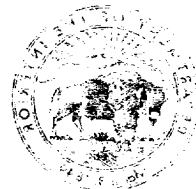

COPIED TO ORDER

RECEIVED



(SUBMIT IN TRIPLICATE)

Indian Agency _____

UNITED STATES
DEPARTMENT OF THE INTERIOR
GEOLOGICAL SURVEY

_____ **Mescalito Tribal**
Allottee **Mescalito #0**
Lease No. **Contract #34**
Tract #77

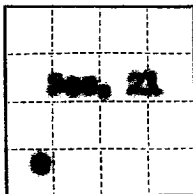

SUNDRY NOTICES AND REPORTS ON WELLS

NOTICE OF INTENTION TO DRILL _____	<input checked="" type="checkbox"/> SUBSEQUENT REPORT OF WATER SHUT-OFF _____
NOTICE OF INTENTION TO CHANGE PLANS _____	SUBSEQUENT REPORT OF SHOOTING OR ACIDIZING _____
NOTICE OF INTENTION TO TEST WATER SHUT-OFF _____	SUBSEQUENT REPORT OF ALTERING CASING _____
NOTICE OF INTENTION TO REDRILL OR REPAIR WELL _____	SUBSEQUENT REPORT OF REDRILLING OR REPAIR _____
NOTICE OF INTENTION TO SHOOT OR ACIDIZE _____	SUBSEQUENT REPORT OF ABANDONMENT _____
NOTICE OF INTENTION TO PULL OR ALTER CASING _____	SUPPLEMENTARY WELL HISTORY _____
NOTICE OF INTENTION TO ABANDON WELL _____	

(INDICATE ABOVE BY CHECK MARK NATURE OF REPORT, NOTICE, OR OTHER DATA)

Mescalito #0 _____ **June 20,** _____, 19 **56**

Well No. **3** is located **990** ft. from **N** line and **990** ft. from **W** line of sec. **21**

3 1/4 Section 21 **25N** **9W** **N. H. P. M.**
(1/4 Sec. and Sec. No.) (Twp.) (Range) (Meridian)

Smith Bluffs (Pictured Cliffs) **Rio Arriba** **New Mexico**
(Field) (County or Subdivision) (State or Territory)

The elevation of the derrick floor above sea level is **6428** ft.

DETAILS OF WORK

(State names of and expected depths to objective sands; show sizes, weights, and lengths of proposed casings; indicate mudding jobs, cementing points, and all other important proposed work)

It is our intention to drill #3 to approximately 5300' to test the Pictured Cliffs and the Mesa Verde formations. Our casing program includes 350' - 18-3/4" casing cemented with 400 lbs. reg. cement. 3500' - 8-1/2" casing cemented with 300 lbs. reg. cement. ~~Summit sandstone~~

The designated drilling unit is the S/2 - Section 21, for Mesa Verde.

The designated drilling unit is the 3/4 - Section 21, for Pictured Cliffs.

I understand that this plan of work must receive approval in writing by the Geological Survey before operations may be commenced.

Company **SEELY OIL COMPANY**

Address **Box 424**

Farmington, New Mexico

By **P. E. Cooper**

Title **District Foreman**

NEW MEXICO
OIL CONSERVATION COMMISSION

Form C-128

Well Location and/or Gas Proration Plat

Date June 20

Operator SKELLY OIL COMPANY Lease JICARILLA APACHE

Well No. C - 3 Section 21 Township 25 NORTH Range 5 WEST NMPM

Located 990 Feet From the SOUTH Line, 990 Feet From the WEST Line,

RIO ARRIBA County, New Mexico. G. L. Elevation 6618'

Name of Producing Formation Mesa Verde Pool Undesignated Dedicated Acreage 320

(Note: All distances must be from outer boundaries of Section)

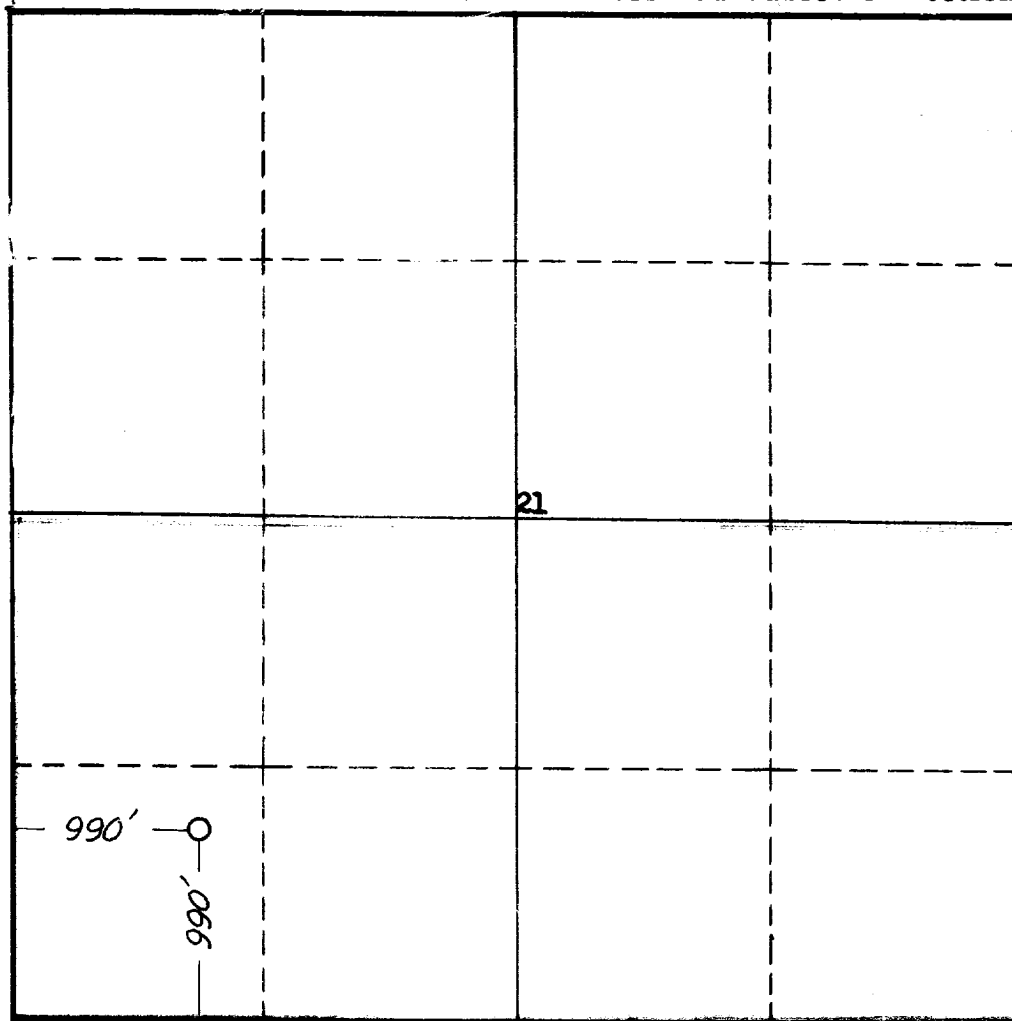

NOTE

This section of
form is to be
used for gas
wells only.



SCALE: 1"=1000'

1. Is this Well a Dual Comp. ? Yes X No .
2. If the answer to Question 1 is yes, are there any other dually completed wells within the dedicated acreage? Yes No X.

Name J. E. Cooper
Position District Foreman
Representing Skelly Oil Company
Address Box 426, Farmington, New Mexico

This is to certify that the above plat was prepared from field notes of actual surveys made by me or under my supervision and that the same are true and correct to the best of my knowledge and belief.

Date Surveyed 12 JUNE 1956
James P. Leese
Registered Professional Engineer and/or
Land Surveyor James P. Leese
N. Mex. Re g. No. 1463