

NEW MEXICO  
OIL CONSERVATION COMMISSION

Form C-128

Well Location and/or Gas Proration Plat

Date September 3, 1956

Operator Amerada Petroleum Corporation Lease Jicarilla Apache "A"

Well No. 2 Section 24 Township 25-N Range 5-W NMPM

Located 1650' Feet From East Line, 1650' Feet From South Line,

Rio Arriba County, New Mexico. G. L. Elevation \_\_\_\_\_

Name of Producing Formation Picture Cliff Pool \_\_\_\_\_ Dedicated Acreage 160

(Note: All distances must be from outer boundaries of Section)

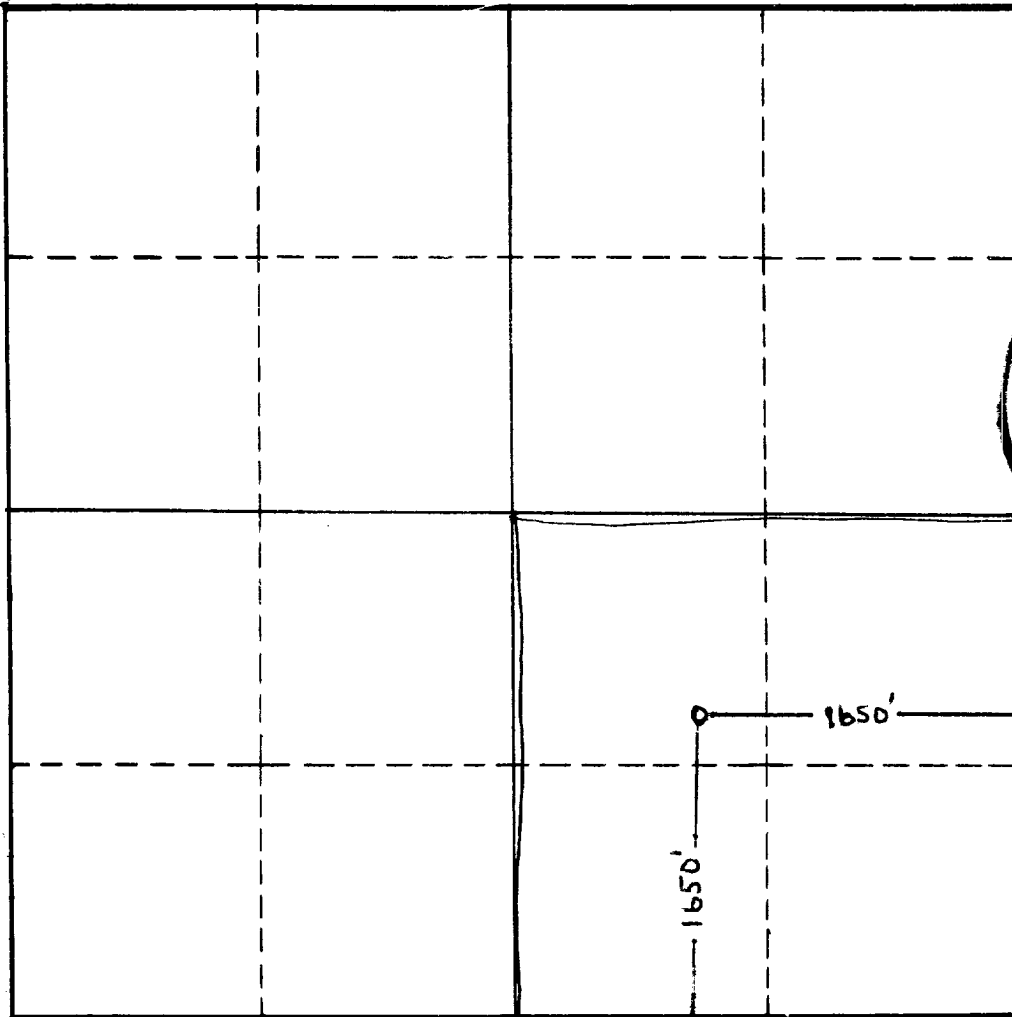

NOTE

This section of form is to be used for gas wells only.



SCALE: 1"=1000'

1. Is this Well a Dual Comp. ? Yes \_\_\_ No X.
2. If the answer to Question 1 is yes, are there any other dually completed wells within the dedicated acreage? Yes \_\_\_ No \_\_\_.

Name W. H. Smith by C.C.  
Position Performer  
Representing Amerada Petroleum Corporation  
Address Box E, Bloomfield, New Mexico

This is to certify that the above plat was prepared from field notes of actual surveys made by me or under my supervision and that the same are true and correct to the best of my knowledge and belief.

Date Surveyed # September 3, 1955  
James P. Leese - N. Mex. Reg. #1463  
Registered Professional Engineer and/or Land Surveyor

OF THE GENERAL COMMISSION

OF THE GENERAL COMMISSION

OF THE GENERAL COMMISSION

OF THE GENERAL COMMISSION

OF THE GENERAL COMMISSION

OF THE GENERAL COMMISSION

OF THE GENERAL COMMISSION

OF THE GENERAL COMMISSION

OF THE GENERAL COMMISSION

OF THE GENERAL COMMISSION

OF THE GENERAL COMMISSION

OF THE GENERAL COMMISSION

OF THE GENERAL COMMISSION