

(SUBMIT IN TRIPLICATE)

UNITED STATES
DEPARTMENT OF THE INTERIOR
GEOLOGICAL SURVEY

Land Office Santa Fe
Lease No. 78 079601
Unit Lytle Bentz

SUNDRY NOTICES AND REPORTS ON WELLS

NOTICE OF INTENTION TO DRILL	<input checked="" type="checkbox"/>	SUBSEQUENT REPORT OF WATER SHUT-OFF	
NOTICE OF INTENTION TO CHANGE PLANS		SUBSEQUENT REPORT OF SHOOTING OR ACIDIZING	
NOTICE OF INTENTION TO TEST WATER SHUT-OFF		SUBSEQUENT REPORT OF ALTERING CASING	
NOTICE OF INTENTION TO RE-DRILL OR REPAIR WELL		SUBSEQUENT REPORT OF RE-DRILLING OR REPAIR	
NOTICE OF INTENTION TO SHOOT OR ACIDIZE		SUBSEQUENT REPORT OF ABANDONMENT	
NOTICE OF INTENTION TO PULL OR ALTER CASING		SUPPLEMENTARY WELL HISTORY	
NOTICE OF INTENTION TO ABANDON WELL			

(INDICATE ABOVE BY CHECK MARK NATURE OF REPORT, NOTICE, OR OTHER DATA)

October 21, 1957

Well No. 2 is located 1650 ft. from N line and 990 ft. from E line of sec. 19

19-35N-3E (1/4 Sec. and Sec. No.) 35 (Twp.) 3E (Range) 19-35N-3E (Meridian)
Lytle Bentz (Field) Lytle Bentz (County or Subdivision) New Mexico (State or Territory)

The elevation of the derrick floor above sea level is _____ ft.

DETAILS OF WORK

(State names of and expected depths to objective sands; show sizes, weights, and lengths of proposed casings; indicate mudding jobs, cementing points, and all other important proposed work)

It is our intention to drill Well No. 2 to approximately 3900' to test the Pictured Cliffs formation. Our casing program is as follows:

Run of 10-3/4" casing, 12.75 lb., SR, 20 ft. x 40, cemented with 150 lbs. regular cement, to be circulated.

3900' of 7" casing, 20 lb., SR, 20 ft. x 40, cemented with 200 lbs. regular cement.

The designated drilling unit is the NW/4 of Section 19-35N-3E, Lytle Bentz County, New Mexico.

I understand that this plan of work must receive approval in writing by the Geological Survey before operations may be commenced.

Company SHELL OIL COMPANY

Address Box 448
Lytle Bentz, New Mexico

By _____

Title District Superintendent

NEW MEXICO OIL CONSERVATION COMMISSION
Well Location and Acreage Dedication Plat

Section A.

Date October 14, 1957

Operator SKELLY OIL COMPANY Lease LYDIA RENTZ
Well No. 2 Unit Letter E Section 19 Township 25 NORTH Range 3 WEST NMPM
Located 1650 Feet From the NORTH Line, 990 Feet From the WEST Line
County RIO ARriba G. L. Elevation _____ Dedicated Acreage 160 Acres
Name of Producing Formation Pictured Cliffs Pool Communitized

1. Is the Operator the only owner* in the dedicated acreage outlined on the plat below?
Yes _____ No _____.
2. If the answer to question one is "no," have the interests of all the owners been consolidated by communitization agreement or otherwise? Yes _____ No _____. If answer is "yes," Type of Consolidation _____
3. If the answer to question two is "no," list all the owners and their respective interests below:
Ref: GLO plat dated 18 Dec. 1917

Owner

Land Description

Section B

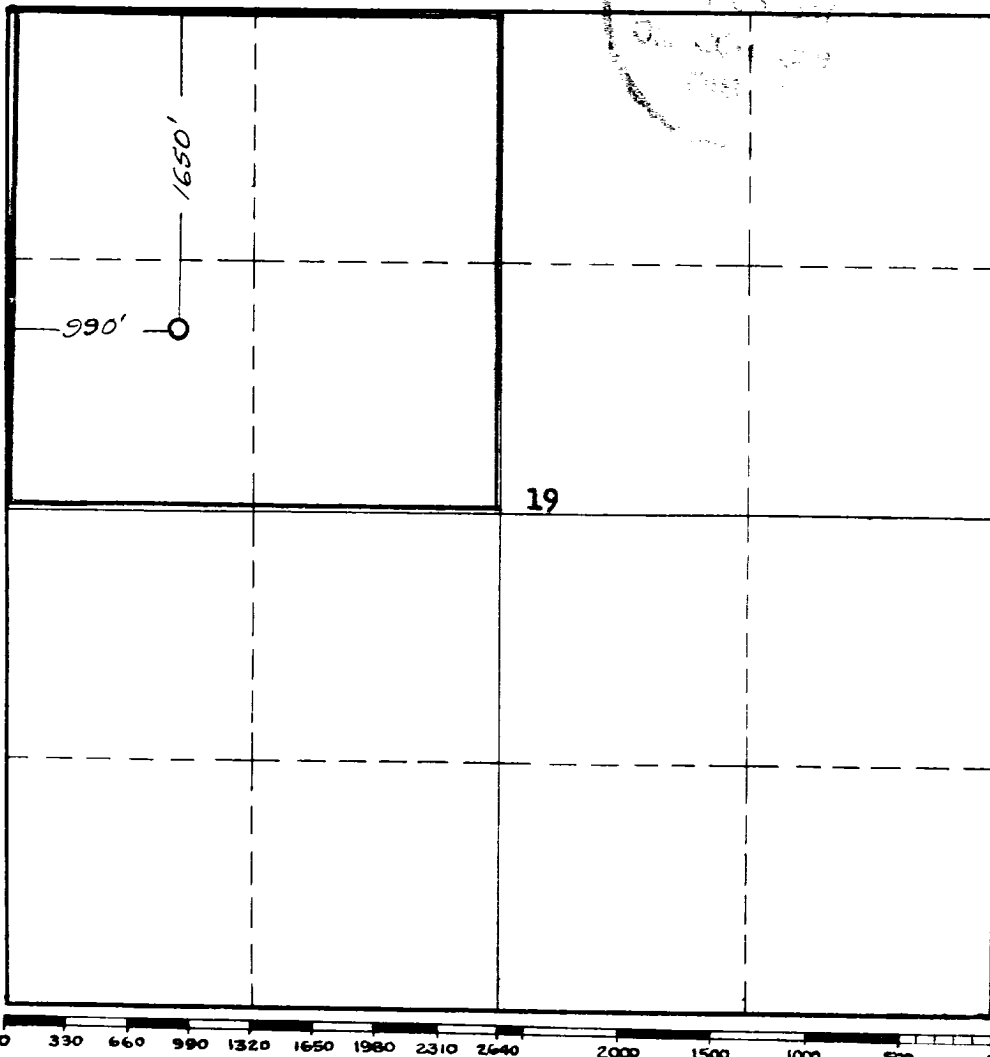

This is to certify that the information in Section A above is true and complete to the best of my knowledge and belief.

BY MY OWN SIGNATURE

(Operator)

(Signed) P. H. Casper

(Representative)

Box 406, Farmington, New Mexico
Address

This is to certify that the well location shown on the plat in Section B was plotted from field notes of actual surveys made by me or under my supervision and that the same is true and correct to the best of my knowledge and belief.

Date Surveyed 19 October 1957

James P. Leese
Registered Professional
Engineer and/or Land Surveyor.
James P. Leese

Certificate No. 1463

(See instructions for completing this form on the reverse side.)

INSTRUCTIONS FOR COMPLETION:

1. Operator shall furnish and certify to the information called for in Section A.
2. Operator shall outline the dedicated acreage for both oil and gas wells on the plat in Section B.
3. A registered professional engineer or land surveyor registered in the State of New Mexico or approved by the Commission shall show on the plat the location of the well and certify this information in the space provided.
4. All distances shown on the plat must be from the outer boundaries of Section.
5. If additional space is needed for listing owners and their respective interests as required in question 3, Section A, please use space below

* "Owner" means the person who has the right to drill into and to produce from any pool and to appropriate the production either for himself or for himself and another. (65-3-29 (e) NMSA 1953 Comp.)