



IN REPLY REFER TO:

UNITED STATES
DEPARTMENT OF THE INTERIOR
GEOLOGICAL SURVEY
P. O. Box 965
Farmington, New Mexico

November 3, 1955

Stanolind Oil & Gas Company
Box 487
Farmington, New Mexico

Re: Jicarilla Contract 148
Tract 245

Gentlemen:

Receipt is acknowledged of your "Notice of Intention to Drill" dated November 2, 1955 covering your well No. 2 Jicarilla Contract 148 in SE1/4 sec. 14, T. 25 N., R. 5 W., N. M. P. M., Rio Arriba County, New Mexico, South Blanco-Pictured Cliffs ~~apt.~~.

Your proposed work is hereby approved subject to compliance with the provisions of the "Oil and Gas Operating Regulations" revised May 25, 1942, a copy of which will be sent to you on request, and subject to the following conditions:

1. Drilling operations so authorized are subject to the attached sheet for general conditions of approval.
2. Furnish copies of all logs.

Very truly yours,

(Orig. Sgd.) P. T. McGrath

P. T. McGrath
District Engineer

PTMcGrath:ac
cc: Jicarilla Agency

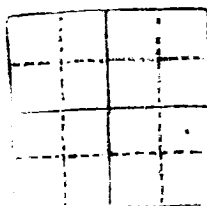

UNITED STATES
DEPARTMENT OF THE INTERIOR
GEOLOGICAL SURVEY



(SUBMIT IN TRIPLICATE)

UNITED STATES
DEPARTMENT OF THE INTERIOR
GEOLOGICAL SURVEY

Indian Agency

Jicarilla Apache

Allottee

Lease No. Jicarilla Contract

#148
Tract #245

SUNDRY NOTICES AND REPORTS ON WELLS

NOTICE OF INTENTION TO DRILL.....	<input checked="" type="checkbox"/>	SUBSEQUENT REPORT OF WATER SHUT-OFF.....
NOTICE OF INTENTION TO CHANGE PLANS.....		SUBSEQUENT REPORT OF SHOOTING OR ACIDIZING.....
NOTICE OF INTENTION TO TEST WATER SHUT-OFF.....		SUBSEQUENT REPORT OF ALTERING CASING.....
NOTICE OF INTENTION TO REDRILL OR REPAIR WELL.....		SUBSEQUENT REPORT OF REDRILLING OR REPAIR.....
NOTICE OF INTENTION TO SHOOT OR ACIDIZE.....		SUBSEQUENT REPORT OF ABANDONMENT.....
NOTICE OF INTENTION TO PULL OR ALTER CASING.....		SUPPLEMENTARY WELL HISTORY.....
NOTICE OF INTENTION TO ABANDON WELL.....		

(INDICATE ABOVE BY CHECK MARK NATURE OF REPORT, NOTICE, OR OTHER DATA)

Farmington, New Mexico November 2, 1955

Jicarilla Contract #148

Well No. 2 is located 1500 ft. from S line and 900 ft. from E line of sec. 14

SE 1/4 of Section 14

(1/4 Sec. and Sec. No.)

T-25-N

(Twp.)

R-5-W

(Range)

MPM

(Meridian)

South Blanco-Pictured Cliffs

(Field)

in Rio Arriba

(County or Subdivision)

New Mexico

(State or Territory)

The elevation of the derrick floor above sea level is 6673 ft.

DETAILS OF WORK

(State names of and expected depths to objective sands; show sizes, weights, and lengths of proposed casings; indicate mudding jobs, cementing points, and all other important proposed work)

We propose to drill the well to approximately 3100'. Rotary tools will be used to total depth. Anticipate production in the Pictured Cliffs formation. Stimulation will be with sand and water.

The following casing program is proposed:

Size
2 3/8"
5-1/2"

Depth
150'
3050'

Cement
75 Sx
100 Sx

Remarks:
20% of theoretical fill.
100% of theoretical fill.

Copies of location plat are attached. A copy of any survey taken will be submitted upon completion of well.

I understand that this plan of work must receive approval in writing by the Geological Survey before operation may be commenced.

Company Stanolind Oil & Gas Company

Address Box 487

Farmington, New Mexico

By [Signature]

Title Field Superintendent

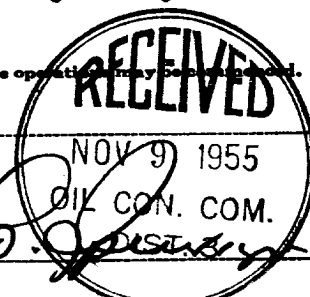

COMPANY Stanolind Oil and Gas Company

Well Name & No. Jicarilla Contract 140, Well No. 2 Lease No. _____

Location 1530' from the South line and 900' from the East line.

Being in NE 1/4 Sec. 14

Sec. 14, T25 N., R. 5 W., N.M.P.M., Rio Arriba County, New Mexico.

Ground Elevation 6873, ungraded.

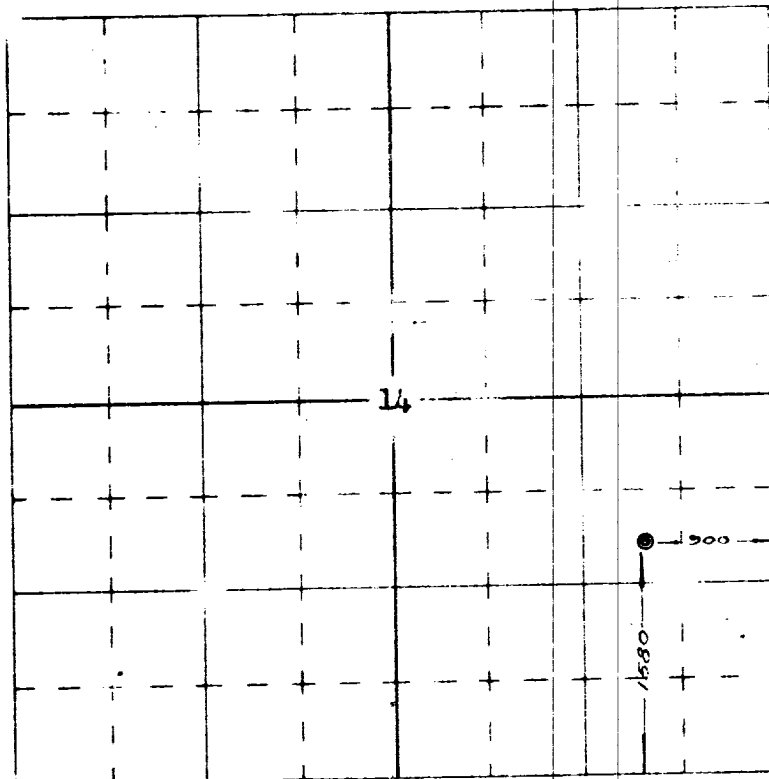

Scale -- 4 inches equals 1 mile

Surveyed October 20

1955

This is to certify that the above plat was prepared from field notes of actual surveys made by me or under my supervision and that the same are true and correct to the best of my knowledge and belief.

Ernest V. Echohawk

Ernest V. Echohawk
Registered Land Surveyor
N. M. Reg. #1545



RECEIVED
NOV 3 1955
U. S. GEOLOGICAL SURVEY
FARMINGTON, NEW MEXICO

