

(SUBMIT IN TRIPLICATE)

UNITED STATES
DEPARTMENT OF THE INTERIOR
GEOLOGICAL SURVEY

Indian Agency Sanilla Apache

Contract #149, Tract #246

Allottee _____

Lease No. Sanilla Apache

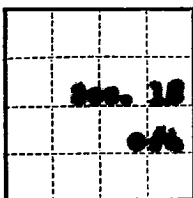

2-5-54

SUNDRY NOTICES AND REPORTS ON WELLS

NOTICE OF INTENTION TO DRILL _____	<input checked="" type="checkbox"/>	SUBSEQUENT REPORT OF WATER SHUT-OFF _____
NOTICE OF INTENTION TO CHANGE PLANS _____		SUBSEQUENT REPORT OF SHOOTING OR ACIDIZING _____
NOTICE OF INTENTION TO TEST WATER SHUT-OFF _____		SUBSEQUENT REPORT OF ALTERING CASING _____
NOTICE OF INTENTION TO REDRILL OR REPAIR WELL _____		SUBSEQUENT REPORT OF REDRILLING OR REPAIR _____
NOTICE OF INTENTION TO SHOOT OR ACIDIZE _____		SUBSEQUENT REPORT OF ABANDONMENT _____
NOTICE OF INTENTION TO PULL OR ALTER CASING _____		SUPPLEMENTARY WELL HISTORY _____
NOTICE OF INTENTION TO ABANDON WELL _____		

(INDICATE ABOVE BY CHECK MARK NATURE OF REPORT, NOTICE, OR OTHER DATA)

RECEIVED
JUL 8 1957
U. S. GEOLOGICAL SURVEY
FACIMINGTON, NEW MEXICO

July 5, 1957

Well No. 4 is located 1620 ft. from N line and 1450 ft. from E line of sec. 18

SW 1/4 of SW 1/4 Sec. 18 T-25-N R-5-E 1450
(1/4 Sec. and Sec. No.) (Twp.) (Range) (Meridian)
Undesignated Rio Arriba New Mexico
(Field) (County or Subdivision) (State or Territory)

The elevation of the derrick floor above sea level is _____ ft. Not determined

DETAILS OF WORK

(State names of and expected depths to objective sands; show sizes, weights, and lengths of proposed casings; indicate mudding jobs, cementing points, and all other important proposed work)

Plan to drill with rotary tools all the way to 3700' to test the 1st Ventana

PIPE	CASING	WEIGHT	NEEDLE	DEPTH	NEEDLE SET	DEPTH
12-1/4"	8-5/8"	24.0	Now	200'	Cemented	190
7-7/8"	5-1/2"	15.20	Now	3700'	Cemented	375



I understand that this plan of work must receive approval in writing by the Geological Survey before operations may be commenced.

Company Amerada Petroleum Corporation

Address Box 5
Blancofield, New Mexico

By D. F. Furrer

Title Foreman

NEW MEXICO OIL CONSERVATION COMMISSION
Well Location and Acreage Dedication Plat

Section A.

Date _____

Operator A MERADA PETROLEUM CORP. Lease J APACHE
Well No. F-4 Unit Letter J Section 18 Township 25 NORTH Range 5 WEST NMPM
Located 1650 Feet From the SOUTH Line, 1450 Feet From the EAST Line
County RIO ARriba G. L. Elevation 6532 Dedicated Acreage 160 Acres
Name of Producing Formation Pict. Cliff - LaVentana Pool _____

1. Is the Operator the only owner* in the dedicated acreage outlined on the plat below?
Yes X No _____.
2. If the answer to question one is "no," have the interests of all the owners been consolidated by communitization agreement or otherwise? Yes _____ No _____. If answer is "yes," Type of Consolidation _____
3. If the answer to question two is "no," list all the owners and their respective interests below:

Owner

Land Description

Section B

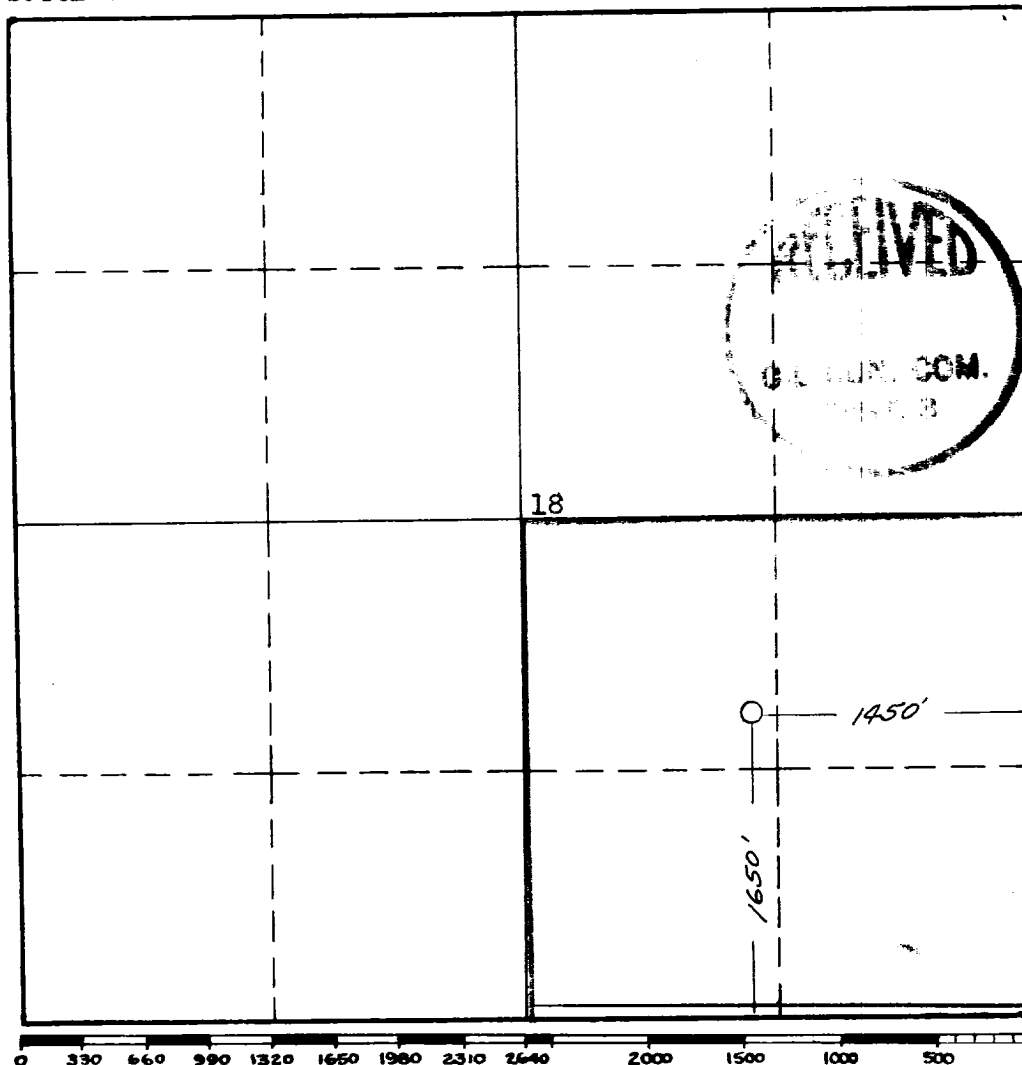

U. S. GEOLOGICAL SURVEY
FARMINGTON, NEW MEXICO

This is to certify that the information in Section A above is true and complete to the best of my knowledge and belief.

Amerada Petroleum Corporation
(Operator)

A. J. Furse
(Representative)

Box E - Bloomfield, New Mex.
Address

This is to certify that the well location shown on the plat in Section B was plotted from field notes of actual surveys made by me or under my supervision and that the same is true and correct to the best of my knowledge and belief.

Date Surveyed 12 June 1957

James P. Leese
Registered Professional
Engineer and/or Land Surveyor.

James P. Leese
Certificate No. 1463

INSTRUCTIONS FOR COMPLETION:

1. Operator shall furnish and certify to the information called for in Section A.
2. Operator shall outline the dedicated acreage for both oil and gas wells on the plat in Section B.
3. A registered professional engineer or land surveyor registered in the State of New Mexico or approved by the Commission shall show on the plat the location of the well and certify this information in the space provided. X
4. All distances shown on the plat must be from the outer boundaries of Section.
5. If additional space is needed for listing owners and their respective interests as required in question 3, Section A, please use space below

* "Owner" means the person who has the right to drill into and to produce from any pool and to appropriate the production either for himself or for himself and another. (65-3-29 (e) NMSA 1953 Comp.)