

(SUBMIT IN TRIPLICATE)

Indian Agency Jicarilla

UNITED STATES
DEPARTMENT OF THE INTERIOR
GEOLOGICAL SURVEY

Apache Tribal Agency

Contract #65

Allottee

Lease No.

Jicarilla

SUNDRY NOTICES AND REPORTS ON WELLS

NOTICE OF INTENTION TO DRILL	<input checked="" type="checkbox"/>	SUBSEQUENT REPORT OF WATER SHUT-OFF
NOTICE OF INTENTION TO CHANGE PLANS		SUBSEQUENT REPORT OF SHOOTING OR ACIDIZING
NOTICE OF INTENTION TO TEST WATER SHUT-OFF		SUBSEQUENT REPORT OF ALTERING CASING
NOTICE OF INTENTION TO REDRILL OR REPAIR WELL		SUBSEQUENT REPORT OF REDRILLING OR REPAIR
NOTICE OF INTENTION TO SHOOT OR ACIDIZE		SUBSEQUENT REPORT OF ABANDONMENT
NOTICE OF INTENTION TO PULL OR ALTER CASING		SUPPLEMENTARY WELL HISTORY
NOTICE OF INTENTION TO ABANDON WELL		

RECEIVED

APR 9 1958

U.S. GEOLOGICAL SURVEY
FARMINGTON, NEW MEXICO

(INDICATE ABOVE BY CHECK MARK NATURE OF REPORT, NOTICE, OR OTHER DATA)

April 8, 1958

Well No. 4-C (FM) is located 1660 ft. from N line and 1600 ft. from E line of sec. 16
NE Sec. 16 25N 4W N.M.P.M.
(1/4 Sec. and Sec. No.) (Twp.) (Range) (Meridian)
Undesignated N. V.
So. Blanco P. C. Est. Rio Arriba New Mexico
(Field) (County or Subdivision) (State or Territory)

The elevation of the derrick floor above sea level is 7377 ft.

DETAILS OF WORK

(State names of and expected depths to objective sands; show sizes, weights, and lengths of proposed casings; indicate mudding jobs, cementing points, and all other important proposed work)

It is intended to drill & dual complete a well in the Pictured Cliffs formation & Mesa Verde formation. Mud circulation will be used through the Pictured Cliffs formation & set intermediate casing. Gas circulation will be used thru the Mesa Verde & a production liner will be set. Possible productive intervals will be perforated & fractured. Estimated Total Depth 6141'.

Casing Program:

10 3/4" at 170' with 125 sacks cement circulated to the surface

7 5/8" at 4016' with 250 sacks cement.

5 1/2" liner from 3870' to 6141' with 300 sacks cement.

The E/2 of Section 16 is dedicated to the Mesa Verde

The NE/4 of Section 16 is dedicated to the Pictured Cliffs.

E/2: Jicarilla Apache Tribal Contract Lease #65, Tract #122.

I understand that this plan of work must receive approval in writing by the Geological Survey before operations may be commenced.

Company El Paso Natural Gas Company

Address Box 997

Farmington, New Mexico

By Original Signed D. C. Johnston

Title Petroleum Engineer

Well Location and Acreage Dedication Plat

Section A.

Date APRIL 8, 1958**JICARILLA APACHE TRIBAL****LEASE NO. 65 TRACT 122**Operator **EL PASO NATURAL GAS COMPANY**Lease **JICARILLA**Well No. 4-C Unit Letter G Section 16 Township 25-N Range 4-W NMPMLocated 1660 Feet From NORTH Line, 1600 Feet From EAST LineCounty RIO ARriba G. L. Elevation 7367 Dedicated Acreage 320 & 160 AcresName of Producing Formation MESA VERDE & PICTURED CLIFF Pool WILDCAT & SO. BLANCO P.C. EXT.

1. Is the Operator the only owner in the dedicated acreage outlined on the plat below?

Yes ☒ No ☐2. If the answer to question one is "no", have the interests of all the owners been consolidated by communitization agreement or otherwise? Yes ☐ No ☐ If answer is "yes", Type of Consolidation.

3. If the answer to question two is "no", list all the owners and their respective interests below:

Owner

Land Description

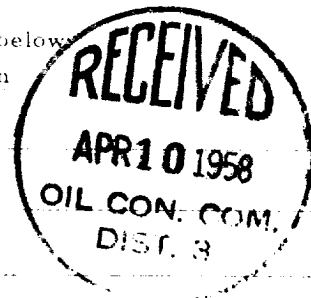

Section B.

Note: All distances must be from the same point.

This is to certify that the information in Section A above is true and complete to the best of my knowledge and belief.

El Paso Natural Gas CompanyOriginal Signed D. C. Johnson

(Representative)

Box 997

(Address)

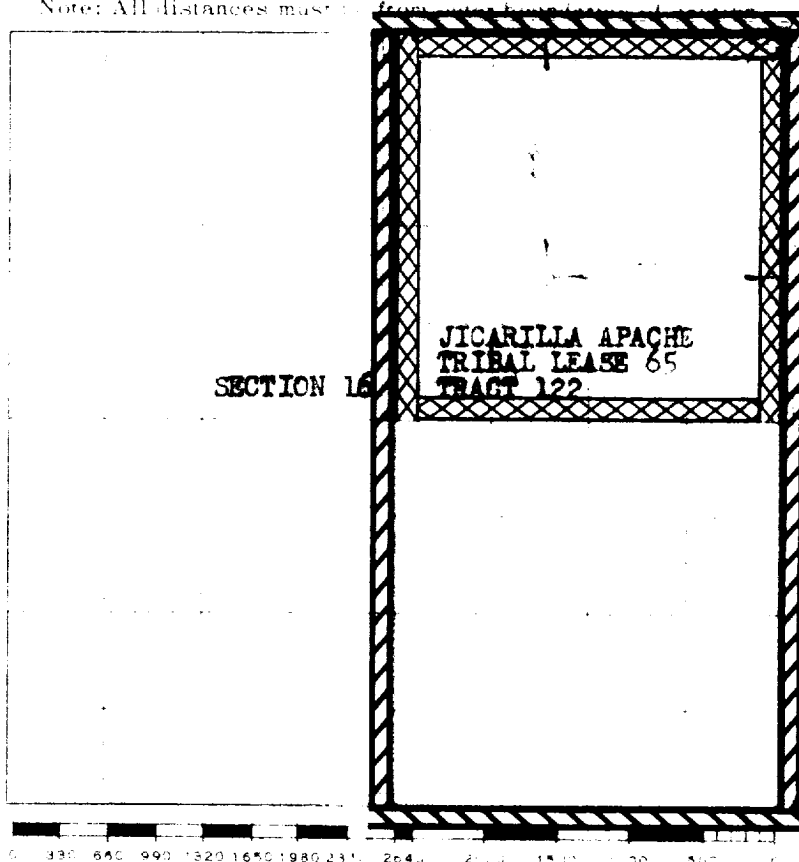
Farmington, New Mexico

Scale 4 inches equal 1 mile

This is to certify that the above plat was prepared from field notes of actual surveys made by me or under my supervision and that the same are true and correct to the best of my knowledge and belief.

(Seal)

Date Surveyed JANUARY 20, 1958

David O. Wilson
Registered Professional Engineer and/or Land Surveyor

Farmington, New Mexico