

NEW MEXICO  
OIL CONSERVATION COMMISSION

Form C-128

Well Location and/or Gas Proration Plat

Date April 30, 1957

Operator SKELLY OIL COMPANY Lease W. F. HURT

Well No. 1 Section 13 Township 25 NORTH Range 3 WEST NMPM

Located 990 Feet From the NORTH Line, 1650 Feet From the WEST Line,

RIO ARriba County, New Mexico. G. L. Elevation \_\_\_\_\_

Name of Producing Formation Pictured Cliffs Pool Undesignated Dedicated Acreage 160

(Note: All distances must be from outer boundaries of Section)

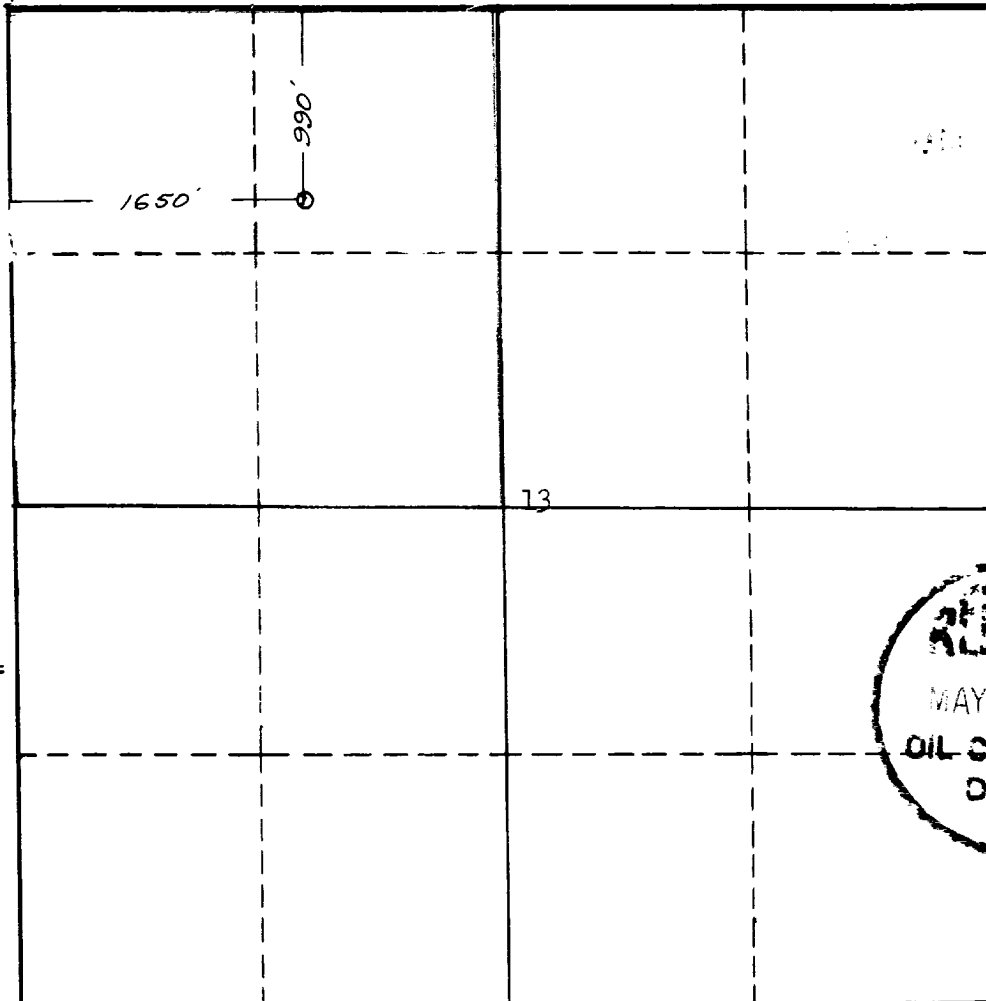

NOTE

This section of form is to be used for gas wells only.

SCALE: 1"=1000'

1. Is this Well a Dual Comp. ? Yes \_\_\_ No X.
2. If the answer to Question 1 is yes, are there any other dually completed wells within the dedicated acreage? Yes \_\_\_ No X.

Name (Signed) P. E. Cosper

Position District Superintendent

Representing SKELLY OIL COMPANY

Address 425

Albuquerque, New Mexico

This is to certify that the above plat was prepared from field notes of actual surveys made by me or under my supervision and that the same are true and correct to the best of my knowledge and belief.

Date Surveyed 26 APRIL 1957

James P. Leese  
Registered Professional Engineer and/or  
Land Surveyor

James P. Leese  
N. Mex. Reg. No. 1463