



COPY TO O.G.C.

UNITED STATES
DEPARTMENT OF THE INTERIOR
GEOLOGICAL SURVEY
P. O. Box 965
Farmington, New Mexico

IN REPLY REFER TO:

May 7, 1956



Humble Oil & Refining Company
Box 1600
Midland, Texas

Re: Jicarilla Contract 147

Gentlemen:

Receipt is acknowledged of your "Notice of Intention to Drill" dated April 30, 1956 covering your well No. 8 Jicarilla Apache Tribe of Indians "J" in SE $\frac{1}{4}$ SE $\frac{1}{4}$ sec. 8, T. 25 N., R. 5 W., N.M.P.M., Rio Arriba County, New Mexico, South Blanco Pie Cliffs ext.

Your proposed work is hereby approved subject to compliance with the provisions of the "Oil and Gas Operating Regulations" revised May 25, 1942, a copy of which will be sent to you on request, and subject to the following conditions:

1. Drilling operations so authorized are subject to the attached sheet for general conditions of approval.
2. Furnish copies of all logs.

Very truly yours,

[Signature]

Jerry W. Long
Acting District Engineer

J. Longsac
cc - Jicarilla Agency

UNITED STATES
DEPARTMENT OF THE INTERIOR
GEOLOGICAL SURVEY



COPY TO O.G.C.

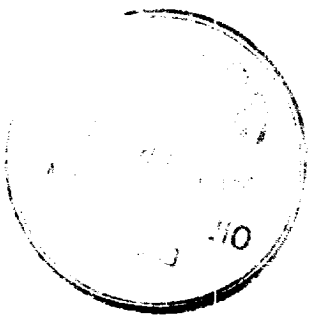

TO THE DIRECTOR, GEOLOGICAL SURVEY
WASHINGTON, D.C.

FROM THE CHIEF OF BUREAU OF LAND MANAGEMENT
WASHINGTON, D.C.

SUBJECT: [Illegible]

DATE: [Illegible]

RE: [Illegible]

REFERENCE: [Illegible]

NOTES: [Illegible]

(SUBMIT IN TRIPLICATE)

Indian Agency Alamogordo

Contract No. 147

UNITED STATES
DEPARTMENT OF THE INTERIOR
GEOLOGICAL SURVEY

Allottee Company
Lease No. 100100

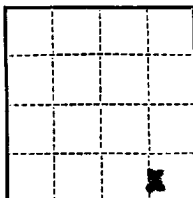

See Attached Plat

SUNDRY NOTICES AND REPORTS ON WELLS

NOTICE OF INTENTION TO DRILL <u>X</u>	SUBSEQUENT REPORT OF WATER SHUT-OFF
NOTICE OF INTENTION TO CHANGE PLANS	SUBSEQUENT REPORT OF SHOOTING OR ACIDIZING
NOTICE OF INTENTION TO TEST WATER SHUT-OFF	SUBSEQUENT REPORT OF ALTERING CASING
NOTICE OF INTENTION TO REDRILL OR REPAIR WELL	SUBSEQUENT REPORT OF REDRILLING OR REPAIR
NOTICE OF INTENTION TO SHOOT OR ACIDIZE	SUBSEQUENT REPORT OF ABANDONMENT
NOTICE OF INTENTION TO PULL OR ALTER CASING	SUPPLEMENTARY WELL HISTORY
NOTICE OF INTENTION TO ABANDON WELL	

(INDICATE ABOVE BY CHECK MARK NATURE OF REPORT, NOTICE, OR OTHER DATA)

JICARILLA ARAGON TRIBE
OF JICARILLA CO.

Midland, Texas April 30, 19 66

Well No. 8 is located 900 ft. from SW line and 900 ft. from E line of sec. 8

SW/4 SW/4 Section 8 T-25-N R-5-W 10N
(1/4 Sec. and Sec. No.) (Twp.) (Range) (Meridian)

South Blanco Pictured Cliffs Ext. Rio Arriba New Mexico
(Field) (County or Subdivision) (State or Territory)

The elevation of the derrick floor above sea level is later ft.

DETAILS OF WORK

(State names of and expected depths to objective sands; show sizes, weights, and lengths of proposed casings; indicate mudding jobs, cementing points, and all other important proposed work)

CASING PROGRAM
8-1/8" 140' 3100'
8-1/8" 140'

CEMENTING PROGRAM
Cement to surface
Cement back to 8-1/8" cas.

CORING PROGRAM
Pictured Cliffs

Proposed total depth 3100 feet to test Pictured Cliffs. Halliburton method of cementing to be used. Low water loss and with diesel oil additive.

I understand that this plan of work must receive approval in writing by the Geological Survey before operations may be commenced.

Company Mobile Oil & Refining Company

Address Box 1000

Midland, Texas

By A. B. Bedford

Title Division Chief Clerk

NEW MEXICO
OIL CONSERVATION COMMISSION

Form C-128

Well Location and/or Gas Proration Plat

Date 4-27-56

Operator HUMBLE OIL & REFINING CO. Lease JICARILLA TRIBE OF INDIANS "J"

Well No. 8 Section 8 Township 25-NORTH Range 5-W NMPM

Located 990 Feet From SOUTH Line, 990 Feet From EAST Line,

RIO ARRIBA County, New Mexico. G. L. Elevation _____

Name of Producing Formation PICTURED CLIFFS Pool SO. BLANCO Dedicated Acreage 160
Ext.

(Note: All distances must be from outer boundaries of Section)

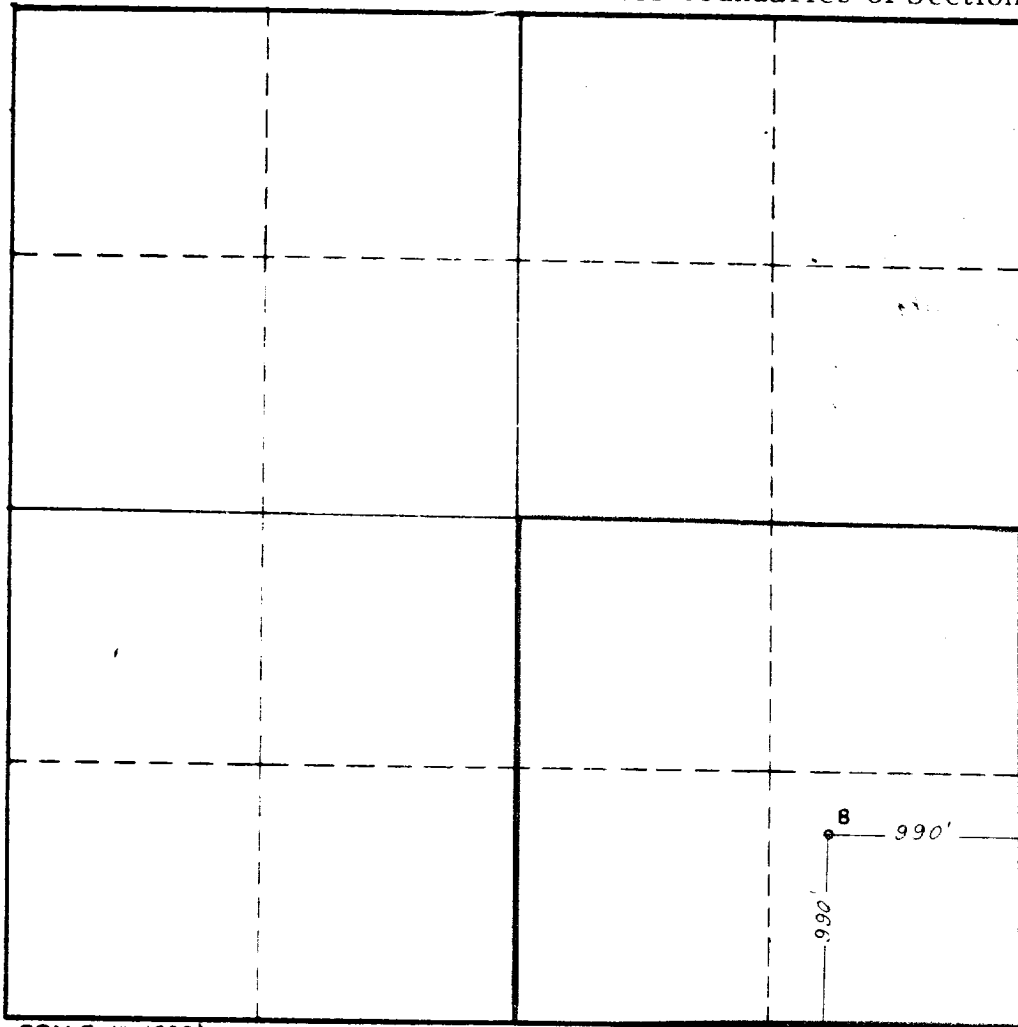

SCALE: 1"=1000'

1. Is this Well a Dual Comp.? Yes No _____
2. If the answer to Question 1 is yes, are there any other dually completed wells within the dedicated acreage? Yes _____ No _____

This is to certify that the above plat was prepared from field notes of actual surveys made by me or under my supervision and that the same are true and correct to the best of my knowledge and belief.

Name A. P. Henoley
Position ASSISTANT DIVISION SUPERINTENDENT
Representing HUMBLE OIL & REFINING CO.
Address BOX 1600 MIDLAND, TEXAS

Date Surveyed 4-25-56
E. T. Shaban
Registered Professional Engineer and/or
Land Surveyor
LEASE 196183

WA 2124