

(SUBMIT IN TRIPLICATE)

UNITED STATES  
DEPARTMENT OF THE INTERIOR  
GEOLOGICAL SURVEYLand Office Santa Fe  
Lease No. N. M. 04889  
Unit \_\_\_\_\_

## SUNDRY NOTICES AND REPORTS ON WELLS

|  |                                     |  |  |
|--|-------------------------------------|--|--|
| NOTICE OF INTENTION TO DRILL                   | <input checked="" type="checkbox"/> | SUBSEQUENT REPORT OF WATER SHUT-OFF        |  |
| NOTICE OF INTENTION TO CHANGE PLANS            |                                     | SUBSEQUENT REPORT OF SHOOTING OR ACIDIZING |  |
| NOTICE OF INTENTION TO TEST WATER SHUT-OFF     |                                     | SUBSEQUENT REPORT OF ALTERING CASING       |  |
| NOTICE OF INTENTION TO RE-DRILL OR REPAIR WELL |                                     | SUBSEQUENT REPORT OF RE-DRILLING OR REPAIR |  |
| NOTICE OF INTENTION TO SHOOT OR ACIDIZE        |                                     | SUBSEQUENT REPORT OF ABANDONMENT           |  |
| NOTICE OF INTENTION TO PULL OR ALTER CASING    |                                     | SUPPLEMENTARY WELL HISTORY                 |  |
| NOTICE OF INTENTION TO ABANDON WELL            |                                     |  |  |

(INDICATE ABOVE BY CHECK MARK NATURE OF REPORT, NOTICE, OR OTHER DATA)

December 19, 1956

Well No. 7-G Fed is located 890 ft. from N line and 1650 ft. from W line of sec. 7

|   |   |   |
|---|---|---|
| <u>NW/4 Sec. 7</u><br>(1/4 Sec. and Sec. No.) | <u>T25N. R1W</u><br>(Twp.)                  | <u>New Mexico Prime</u><br>(Meridian)     |
| <u>Garfield</u><br>(Field)                    | <u>La Arriba</u><br>(County or Subdivision) | <u>New Mexico</u><br>(State or Territory) |

The elevation of the Ground Level ~~surface~~ above sea level is 7496.4 ft.

## DETAILS OF WORK

(State names of and expected depths to objective sands; show sizes, weights, and lengths of proposed casings; indicate mudding jobs, cementing points, and all other important proposed work)

The Pictured Cliffs Sandstone.

Approximately 100' of 5-5/8" 24-pound surface casing.

Approximately 3500' of 5-1/2" 14-pound production casing.

Cement both surface and production casing.

Mud up for surface.



I understand that this plan of work must receive approval in writing by the Geological Survey before operations may be commenced.

Company San Juan Gas CorporationAddress 1716 First National BuildingTulsa, OklahomaBy Robert C. LarsonTitle Vice President

RCL:mar



NEW MEXICO  
OIL CONSERVATION COMMISSION

Form C-128

Well Location and/or Gas Proration Plat

Date December 19, 1956

Operator SAN JUAN GAS CORPORATION Lease N.M. 04089

Well No. 7-G Fed. Section 7 Township 25 NORTH Range 1 WEST, NMPM

Located 890 Feet From the NORTH Line, 1650 Feet From the WEST, Line,

RIO ARRIBA County, New Mexico. G. L. Elevation 7496.4 UNGRADED.

Name of Producing Formation Pictured Cliffs Pool Cavilan 200 Dedicated Acreage 160

(Note: All distances must be from outer boundaries of Section)

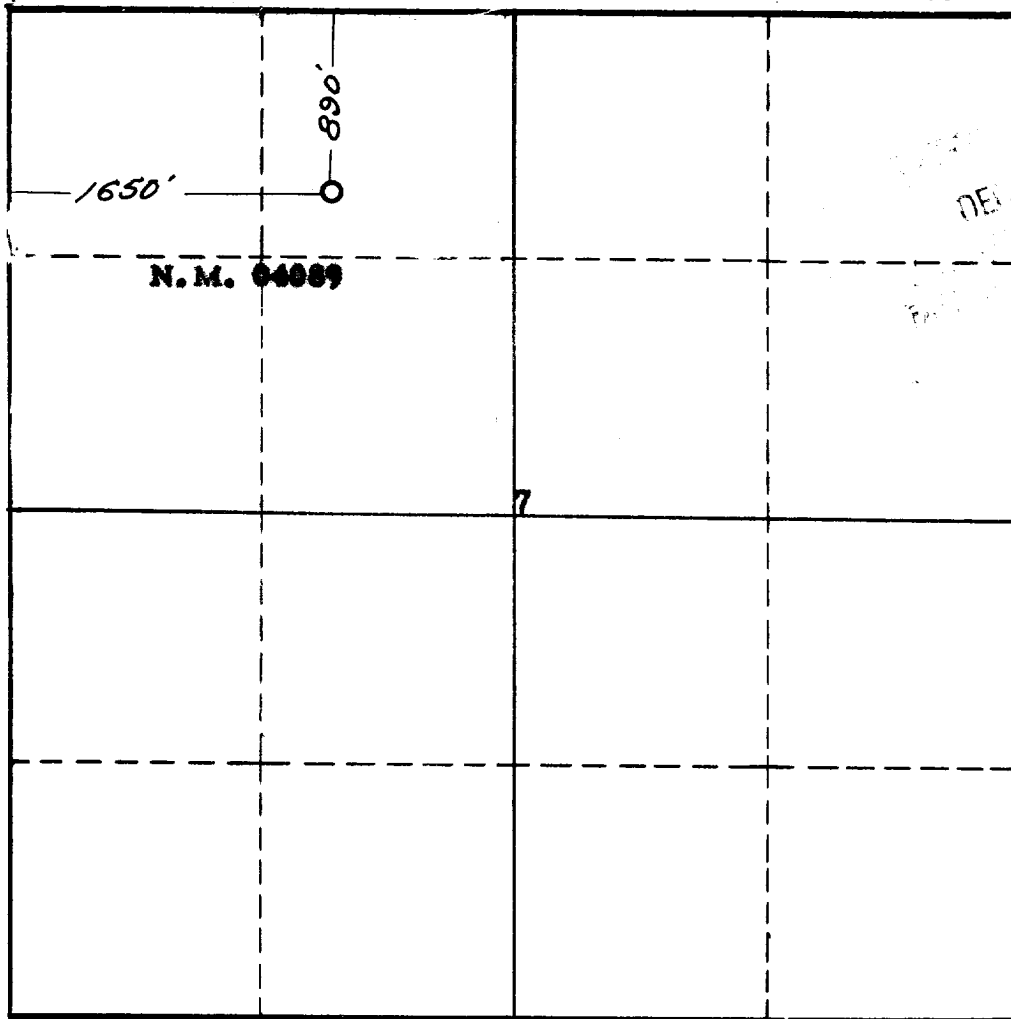

NOTE

This section of form is to be used for gas wells only.



SCALE: 1"=1000'

1. Is this Well a Dual Comp. ? Yes \_\_\_ No x.
2. If the answer to Question 1 is yes, are there any other dually completed wells within the dedicated acreage? Yes \_\_\_ No \_\_\_.

Name Robert C. Pearson Vice President  
SAN JUAN GAS CORPORATION  
Position 1716 First National Building  
Representing Tulsa, Oklahoma  
Address \_\_\_\_\_

This is to certify that the above plat was prepared from field notes of actual surveys made by me or under my supervision and that the same are true and correct to the best of my knowledge and belief.

Date Surveyed 3 NOVEMBER 1956  
James P. Leese  
Registered Professional Engineer and/or  
Land Surveyor James P. Leese  
N. Mex. Reg. No. 1463