



COPY TO O.C.C.

IN REPLY REFER TO:

UNITED STATES  
DEPARTMENT OF THE INTERIOR  
GEOLOGICAL SURVEY  
P. O. Box 965  
Farmington, New Mexico

April 19, 1956

Humble Oil & Refining Company  
Box 1600  
Midland, Texas

Re: Jicarilla Cont. #147

Gentlemen:

Receipt is acknowledged of your "Notice of Intention to Drill" dated April 17, 1956 covering your well No. 5 Jicarilla Apache Tribe of Indians "J" in NW<sup>1</sup> NE<sup>1</sup> sec. 7, T. 25 N., R. 5 W., N. M. P. M., Rio Arriba County, New Mexico, So. Blanco-Pic Cliffs ext.

Your proposed work is hereby approved subject to compliance with the provisions of the "Oil and Gas Operating Regulations" revised May 25, 1942, a copy of which will be sent to you on request, and subject to the following conditions:

1. Drilling operations so authorized are subject to the attached sheet for general conditions of approval.
2. Furnish copies of all logs.

Very truly yours,

Jerry W. Long  
Acting District Engineer



JWLong:as  
cc - Jicarilla Agency

(SUBMIT IN TRIPLICATE)

Indian Agency Jicarilla

Contract #147

UNITED STATES  
DEPARTMENT OF THE INTERIOR  
GEOLOGICAL SURVEY

Allottee

Co. Lease No. 196183

X			

SUNDRY NOTICES AND REPORTS ON WELLS

NOTICE OF INTENTION TO DRILL	X	SUBSEQUENT REPORT OF WATER SHUT-OFF	
NOTICE OF INTENTION TO CHANGE PLANS		SUBSEQUENT REPORT OF SHOOTING OR ACIDIZING	
NOTICE OF INTENTION TO TEST WATER SHUT-OFF		SUBSEQUENT REPORT OF ALTERING CASING	
NOTICE OF INTENTION TO REDRILL OR REPAIR WELL		SUBSEQUENT REPORT OF REDRILLING OR REPAIR	
NOTICE OF INTENTION TO SHOOT OR ACIDIZE		SUBSEQUENT REPORT OF ABANDONMENT	
NOTICE OF INTENTION TO PULL OR ALTER CASING		SUPPLEMENTARY WELL HISTORY	
NOTICE OF INTENTION TO ABANDON WELL			

(INDICATE ABOVE BY CHECK MARK NATURE OF REPORT, NOTICE, OR OTHER DATA)

RECEIVED  
APR 19 1956  
U. S. GEOLOGICAL SURVEY  
FARMINGTON, NEW MEXICO

JICARILLA APACHE TRIBE  
OF INDIANS "J"

Midland, Texas

April 17, 19 56

Well No. 5 is located 990 ft. from N line and 880 ft. from W line of sec. 7

NW/4 NW/4 Sec. 7  
(1/4 Sec. and Sec. No.)

T-25-N  
(Twp.)

R-5-W  
(Range)

--  
(Meridian)

South Blanco Pictured Cliff  
(Field) ext.

Rio Arriba  
(County or Subdivision)

New Mexico  
(State or Territory)

The elevation of the derrick floor above sea level is later ft.

DETAILS OF WORK

(State names of and expected depths to objective sands; show sizes, weights, and lengths of proposed casings; indicate mudding jobs, cementing points, and all other important proposed work)

CASING PROGRAM		
Size	Weight	Depth
8-5/8"	24#	150'
5-1/2"	14#	3100'

CEMENTING RECORD  
Cement to surface.  
Circulate back to 8-5/8" casing.

CORING PROGRAM  
Pictured Cliff

Proposed total depth to test Pictured Cliff.  
Halliburton method of cementing.  
Low water loss mud w/diesel oil additive.

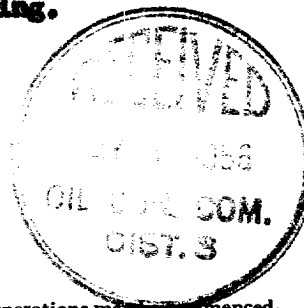

I understand that this plan of work must receive approval in writing by the Geological Survey before operations may be commenced.

Company Humble Oil & Refining Company

Address Box 1800, Midland, Texas

By [Signature]

Title Division Chief Clerk

NEW MEXICO  
OIL CONSERVATION COMMISSION

Form C-128

Well Location and/or Gas Proration Plat

Date 4-16-56

Operator HUMBLE OIL REFINING CO Lease JICARILLA "J"

Well No. 5 Section 7 Township 25-N Range 5-W NMPM

Located 990 Feet From NORTH Line, 880 Feet From WEST Line,

RIO ARRIBA County, New Mexico. G. L. Elevation \_\_\_\_\_

Name of Producing Formation PICTURED CLIFFS Pool SO. BLANCO Dedicated Acreage 159.29  
~~160~~

PICTURED CLIFFS EXTENSION

(Note: All distances must be from outer boundaries of Section)

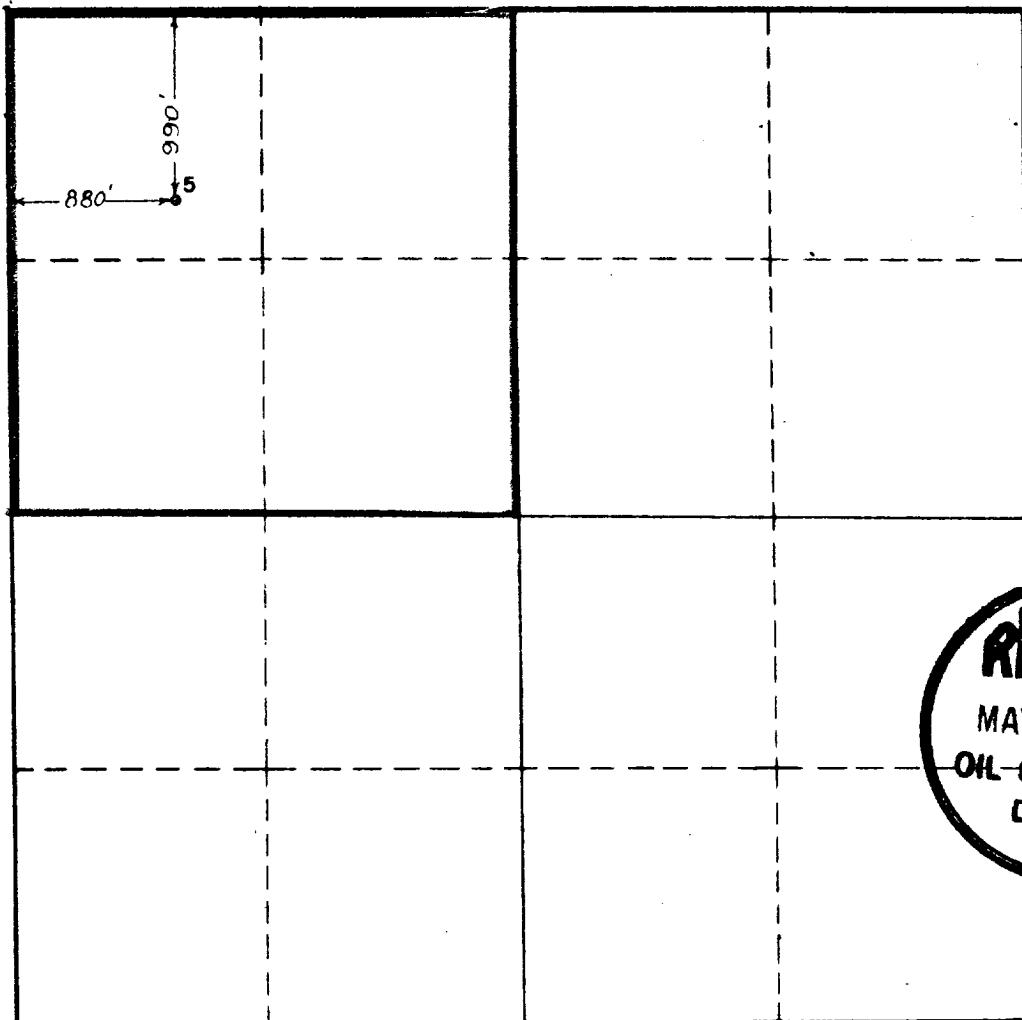

SCALE: 1"=1000'



1. Is this Well a Dual Comp. ? ~~Yes~~ No     .
2. If the answer to Question 1 is yes, are there any other dually completed wells within the dedicated acreage? Yes      No     .

This is to certify that the above plat was prepared from field notes of actual surveys made by me or under my supervision and that the same are true and correct to the best of my knowledge and belief.

Name N. L. Henoley  
Position ASSISTANT DIVISION SUPERINTENDENT  
Representing HUMBLE OIL & REFINING CO.  
Address BOX 1600 MIDLAND, TEXAS

Date Surveyed 4-5-56  
E. T. Shahan  
Registered Professional Engineer and/or  
Land Surveyor

LEASE NO. 196183

WA 2108