

(SUBMIT IN TRIPLICATE)

UNITED STATES
DEPARTMENT OF THE INTERIOR
GEOLOGICAL SURVEY

Land Office **Santa Fe**
Lease No. **RM 08555**
Unit **S1/4 Sec. 4, T25N, R3W,
E.M.P.M., Rio Arriba Co.,
New Mexico**

SUNDRY NOTICES AND REPORTS ON WELLS

NOTICE OF INTENTION TO DRILL.....	<input checked="" type="checkbox"/>	SUBSEQUENT REPORT OF WATER SHUT-OFF.....	
NOTICE OF INTENTION TO CHANGE PLANS.....		SUBSEQUENT REPORT OF SHOOTING OR ACIDIZING.....	
NOTICE OF INTENTION TO TEST WATER SHUT-OFF.....		SUBSEQUENT REPORT OF ALTERING CASING.....	
NOTICE OF INTENTION TO RE-DRILL OR REPAIR WELL.....		SUBSEQUENT REPORT OF RE-DRILLING OR REPAIR.....	
NOTICE OF INTENTION TO SHOOT OR ACIDIZE.....		SUBSEQUENT REPORT OF ABANDONMENT.....	
NOTICE OF INTENTION TO PULL OR ALTER CASING.....		SUPPLEMENTARY WELL HISTORY.....	
NOTICE OF INTENTION TO ABANDON WELL.....			

(INDICATE ABOVE BY CHECK MARK NATURE OF REPORT, NOTICE, OR OTHER DATA)

June 5, 19 57

Well No. **1-3** is located **1850** ft. from **S** line and **1850** ft. from **W** line of sec. **4**

S1/4 **31/4** Section **4** **25N** **3W** **E.M.P.M.**
(1/4 Sec. and Sec. No.) (Twp.) (Range) (Meridian)

Tapatio Pictured Cliffs **Rio Arriba County** **New Mexico**
(Field) (County or Subdivision) (State or Territory)

The elevation of the derrick floor above sea level is _____ ft. **To be determined.**

DETAILS OF WORK

(State names of and expected depths to objective sands; show sizes, weights, and lengths of proposed casings; indicate mudding jobs, cementing points, and all other important proposed work)

The objective sand is the Pictured Cliffs formation anticipated at approximately 3900'.

Proposed Casing Program: 800' 9-5/8" J-55 cemented to surface
4000' 9-1/2" J-55 cemented with 150 sacks

Rotary Tools will be used from surface to T.D. Estimated T.D. 4000'.

The well will be sand fraced in an effort to stimulate production.

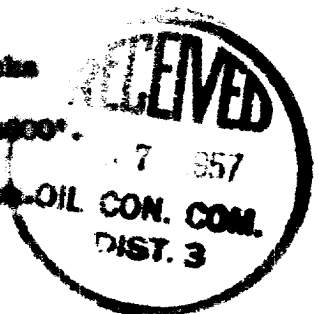

I understand that this plan of work must receive approval in writing by the Geological Survey before operations may be commenced.

Company **SOUTHERN UNION GAS COMPANY**

Address **1002 WEST BUILDING**

DALLAS, TEXAS

By **A. M. Wicks**

A. M. Wicks

Title **Mgr., Exploration Dept.**

NEW MEXICO
OIL CONSERVATION COMMISSION

Form C-128

Well Location and/or Gas Proration Plat

Date June 5, 1957

Operator SOUTHERN UNION GAS COMPANY Lease McCredon

Well No. 1-B Section 4 Township 25 NORTH Range 3 WEST, NMPM

Located 1850 Feet From the SOUTH Line, 1850 Feet From the WEST Line,

RIO ARRIBA County, New Mexico. G. L. Elevation To be determined

Name of Producing Formation Pictured Cliffs Pool Tupacito Dedicated Acreage 160

(Note: All distances must be from outer boundaries of Section)

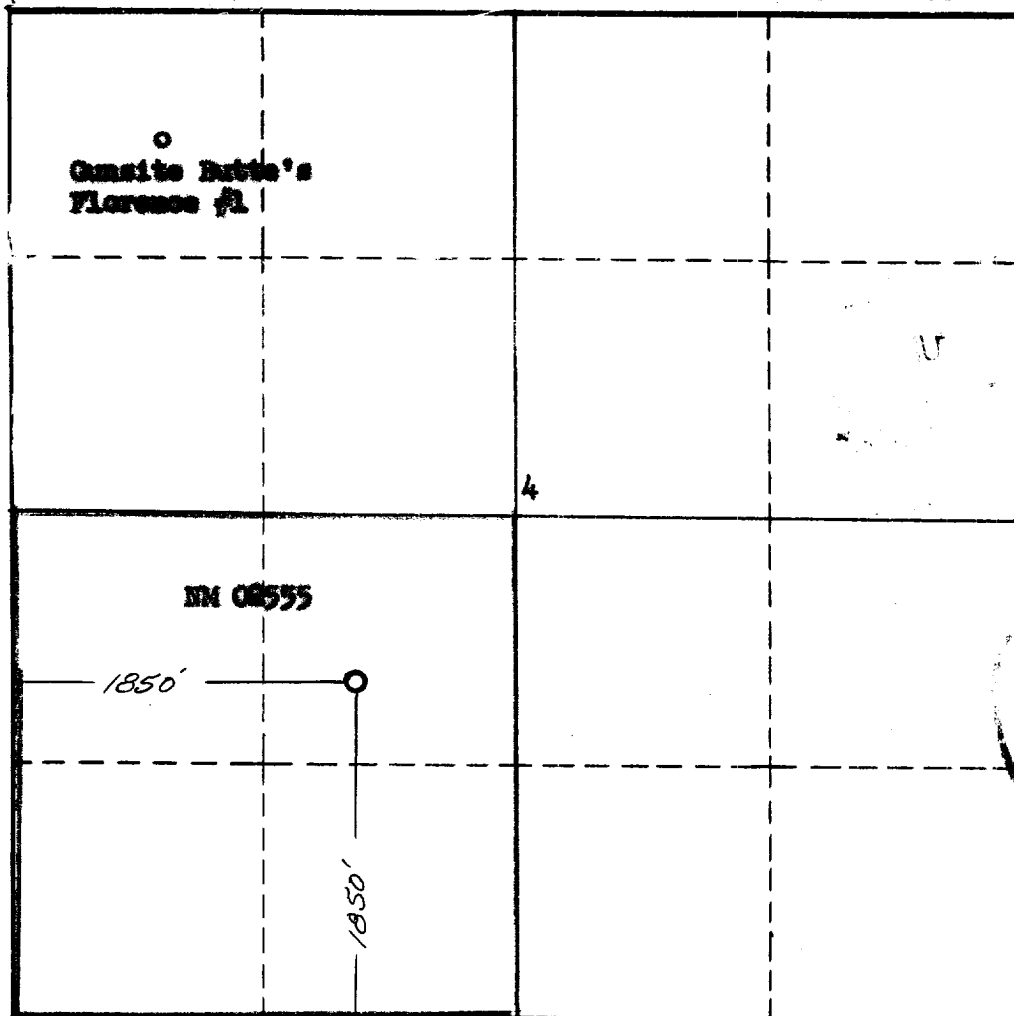

NOTE

This section of
form is to be
used for gas
wells only.



1. Is this Well a Dual Comp.? Yes No.

2. If the answer to Question 1 is yes, are there
any other dually completed wells within the
dedicated acreage? Yes No.

Name James P. Leese
Position Mr., Exploration Dept.
Representing Southern Union Gas Co.
Address 1001 Fort Bldg., Dallas, Texas

This is to certify that the above plat was
prepared from field notes of actual surveys
made by me or under my supervision and
that the same are true and correct to the
best of my knowledge and belief.

Date Surveyed 14 FEBRUARY 1957
James P. Leese
Registered Professional Engineer and/or
Land Surveyor James P. Leese
N. Mex. Reg. No. 1463

NEW MEXICO
OIL CONSERVATION COMMISSION

Form C-128

Well Location and/or Gas Proration Plat

Date June 5, 1957

Operator SOUTHERN UNION GAS COMPANY

Lease McCroden

Well No. 1-B Section 4 Township 25 NORTH Range 3 WEST, NMPM

Located 1850 Feet From the SOUTH Line, 1850 Feet From the WEST Line,

RIO ARRIBA County, New Mexico. G. L. Elevation To be determined

Name of Producing Formation Pictured Cliffs Pool Tapacito Dedicated Acreage 160

(Note: All distances must be from outer boundaries of Section)

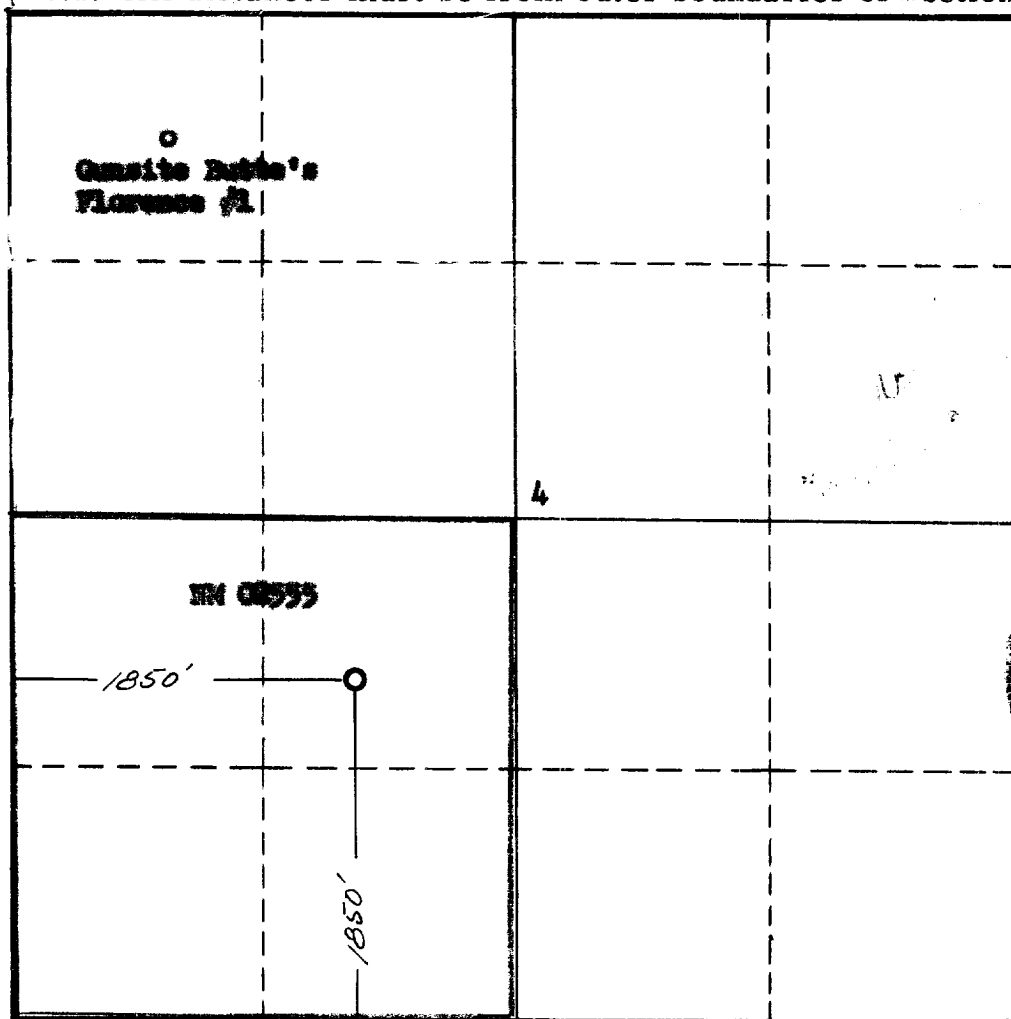

NOTE

This section of
form is to be
used for gas
wells only.



1. Is this Well a Dual Comp.? Yes No X.

2. If the answer to Question 1 is yes, are there
any other dually completed wells within the
dedicated acreage? Yes No X.

Name A. M. Hinderliter

Position Eng., Exploration Dept.

Representing Southern Union Gas Co.

Address 1001 Hart Bldg., Dallas, Texas

This is to certify that the above plat was
prepared from field notes of actual surveys
made by me or under my supervision and
that the same are true and correct to the
best of my knowledge and belief.

Date Surveyed 14 FEBRUARY 1957

James P. Leese
Registered Professional Engineer and/or
Land Surveyor
James P. Leese
N. Mex. Reg. No. 1463