

(SUBMIT IN TRIPLICATE)

UNITED STATES
DEPARTMENT OF THE INTERIOR
GEOLOGICAL SURVEY

Indian Agency 3100111a

Contract No. 147

Allottee Co. Loc. No. 150183

Lease No. _____

| | | |
|--|---|--|
| | | |
| | | |
| | | |
| | X | |

See Attached Flst

SUNDRY NOTICES AND REPORTS ON WELLS

| | | |
|---|---|--|
| NOTICE OF INTENTION TO DRILL | X | SUBSEQUENT REPORT OF WATER SHUT-OFF |
| NOTICE OF INTENTION TO CHANGE PLANS | | SUBSEQUENT REPORT OF SHOOTING OR ACIDIZING |
| NOTICE OF INTENTION TO TEST WATER SHUT-OFF | | SUBSEQUENT REPORT OF ALTERING CASING |
| NOTICE OF INTENTION TO REDRILL OR REPAIR WELL | | SUBSEQUENT REPORT OF REDRILLING OR REPAIR |
| NOTICE OF INTENTION TO SHOOT OR ACIDIZE | | SUBSEQUENT REPORT OF ABANDONMENT |
| NOTICE OF INTENTION TO PULL OR ALTER CASING | | SUPPLEMENTARY WELL HISTORY |
| NOTICE OF INTENTION TO ABANDON WELL | | |

(INDICATE ABOVE BY CHECK MARK NATURE OF REPORT, NOTICE, OR OTHER DATA)

JICARILLA APACHE
TRIBE OF INDIANS "J"

June 11 1957

Well No. 9 is located 990 ft. from S line and 2510 ft. from E line of sec. 6

34/4 of 35/4
(1/4 Sec. and Sec. No.)

T-23-N
(Twp.)

(Range)

(Meridian)

South Blaine
(Field)

Rio Arriba
(Count)

New Mexico
(State or Territory)

***Pictured Cliffs SMI & Leventown Gas Deal**
The elevation of the derrick floor above sea level is 120 ft.

DETAILS OF WORK

(State names of and expected depths to objective sands; show sizes, weights, and lengths of proposed casings; indicate mudding jobs, cementing points, and all other important proposed work)

| CASING PROGRAM | | | CEMENTING RECORD | CORING PROGRAM | |
|----------------|--------|-------|----------------------|----------------|-----------|
| Size | Weight | Depth | | | |
| 8-5/8" | 24 | 150' | Circulate to surface | 3-Laventans | 3700-3850 |
| 5-1/2" | 14 | 4100' | Circulate to 8-5/8" | | |

Proposed total depth 4100' to test Laventona. We plan to finally complete this well in the South Blanco-Flinted Cliffs & Laventona.

HONGCO method of counting to be used. Low water loss and v/diesel fuel added

I understand that this plan of work must receive approval in writing by the Geological Survey before operations may be commenced.

Company Humble Oil & Refining Company

Address _____ Box 1600

Added Terms

By J. D. Ferguson

Title Asst. Division Chief Clerk

correct plat
show - 990/S
1850/E Recd 11/5/57

6110193
7.20



NEW MEXICO OIL CONSERVATION COMMISSION
Well Location and Acreage Dedication Plat

Section A.

Date June 10 1957

Operator Humble Oil & Refining Co. Lease Jicarilla Apache Tribe of Indians "J"
Well No. 9 Unit Letter "O" Section 6 Township 25 North Range 5 West NMPM
Located 2310 Feet From East Line, 990 Feet From South Line
County Rio Arriba G. L. Elevation _____ Dedicated Acreage 160 Acres
Name of Producing Formation Pictured Cliffs Gas & Laventana Gas Pool South Blanco

1. Is the Operator the only owner* in the dedicated acreage outlined on the plat below?
Yes ✓ No _____. *Dual Comp.*
2. If the answer to question one is "no," have the interests of all the owners been consolidated by communitization agreement or otherwise? Yes ____ No _____. If answer is "yes," Type of Consolidation _____
3. If the answer to question two is "no," list all the owners and their respective interests below:

Owner

Land Description

Section B

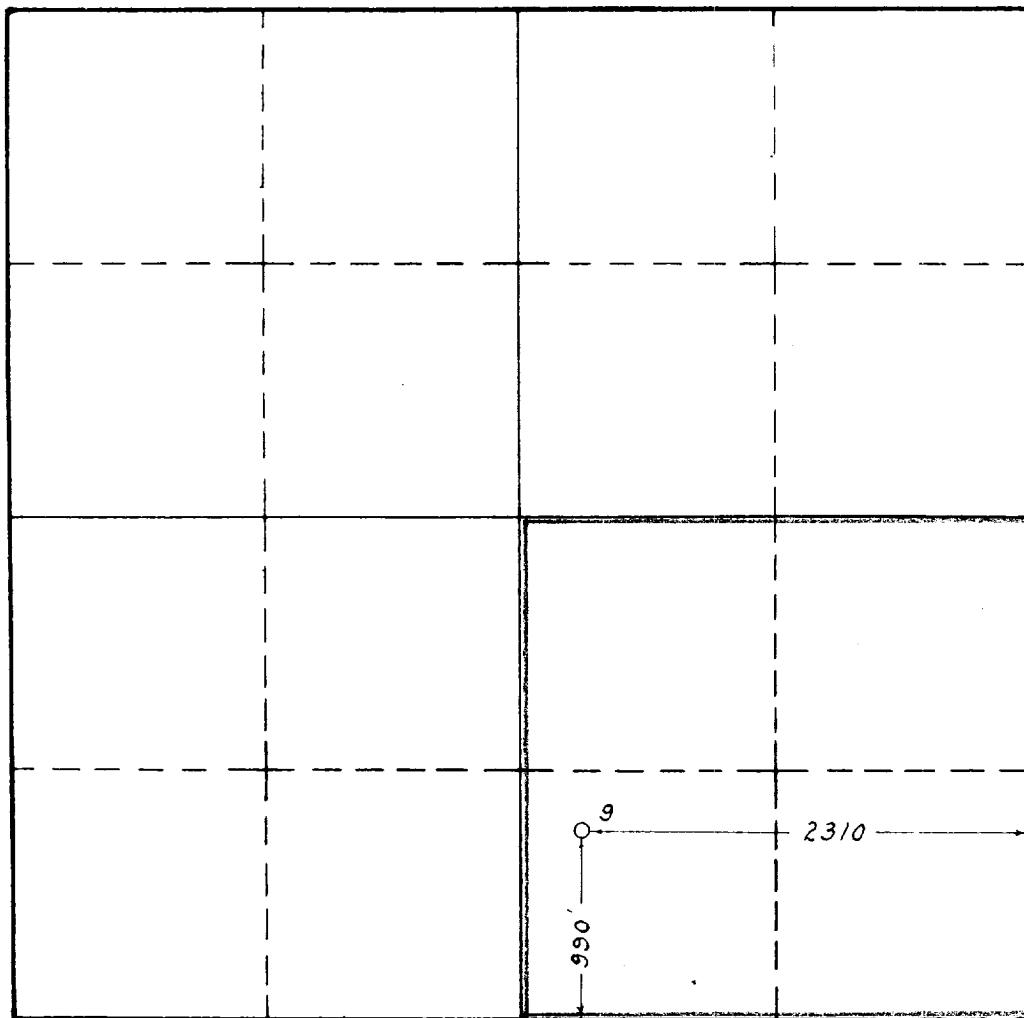

This is to certify that the information in Section A above is true and complete to the best of my knowledge and belief.

Humble Oil & Refining Co.
(Operator)

(Representative)

Asst. Division Superintendent
Box 1600 Midland, Texas
Address

This is to certify that the well location shown on the plat in Section B was plotted from field notes of actual surveys made by me or under my supervision and that the same is true and correct to the best of my knowledge and belief.

Date Surveyed 6-6-57

R. A. Foster
Registered Professional
Engineer and/or Land Surveyor.

Certificate No. 554

(See instructions for completing this form on the reverse side)