

(SUBMIT IN TRIPLICATE)

UNITED STATES  
DEPARTMENT OF THE INTERIOR  
GEOLOGICAL SURVEY

Land Office Santa Fe  
Lease No. 978885  
Unit SE 1/4 sec. 5

RECEIVED

SUNDRY NOTICES AND REPORTS ON WELLS

APR 27 1953

NOTICE OF INTENTION TO DRILL <input checked="" type="checkbox"/>	SUBSEQUENT REPORT OF WATER SHUT-OFF
NOTICE OF INTENTION TO CHANGE PLANS	SUBSEQUENT REPORT OF SHOOTING OR ACIDIZING
NOTICE OF INTENTION TO TEST WATER SHUT-OFF	SUBSEQUENT REPORT OF ALTERING CASING
NOTICE OF INTENTION TO RE-DRILL OR REPAIR WELL	SUBSEQUENT REPORT OF RE-DRILLING OR REPAIR
NOTICE OF INTENTION TO SHOOT OR ACIDIZE	SUBSEQUENT REPORT OF ABANDONMENT
NOTICE OF INTENTION TO PULL OR ALTER CASING	SUPPLEMENTARY WELL HISTORY
NOTICE OF INTENTION TO ABANDON WELL	

(INDICATE ABOVE BY CHECK MARK NATURE OF REPORT, NOTICE, OR OTHER DATA)

SEALY-GOVERNMENT 11-5

April 25, 19 53.

Well No. 1 is located 2610 ft. from N line and 962 ft. from E line of sec. 5

NE SE Section 5  
(1/4 Sec. and Sec. No.)

25-N  
(Twp.)

6-W  
(Range)

(Meridian)

Wildcat

(Field)

Rio Arriba

(County or Subdivision)

New Mexico

(State or Territory)

Unknown as yet.

The elevation of the derrick floor above sea level is 1 ft.

DETAILS OF WORK

(State names of and expected depths to objective sands; show sizes, weights, and lengths of proposed casings; indicate mudding jobs, cementing points, and all other important proposed work)

Propose to drill well to Pictured Cliffs formation, or 2275 ft., or production, whichever is the lesser.

Propose to set approximately 150' of 9-5/8" casing with cement circulated to surface.

Propose to cement 7" through or on top of producing zone if production is encountered.

I understand that this plan of work must receive approval in writing by the Geological Survey before operations may be commenced.

Company The Superior Oil Company

Address Midland, Texas

By D.V. Prescott

Title Division Engineer.

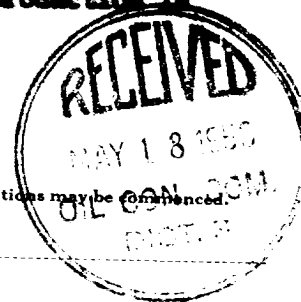

W. W. STUDDERT

MEMBER  
AMERICAN SOCIETY OF  
CIVIL ENGINEERS

REGISTERED ENGINEERS  
& LAND SURVEYORS

ARIZONA  
COLORADO  
IDAHO  
LOUISIANA  
MONTANA  
NEVADA  
NEW MEXICO  
OKLAHOMA  
TEXAS  
UTAH  
WYOMING

# STUDDERT ENGINEERING CO.

CIVIL ENGINEERS

221 SOUTH COLORADO

MIDLAND, TEXAS

TELEPHONES 4-8682 & 2-1373

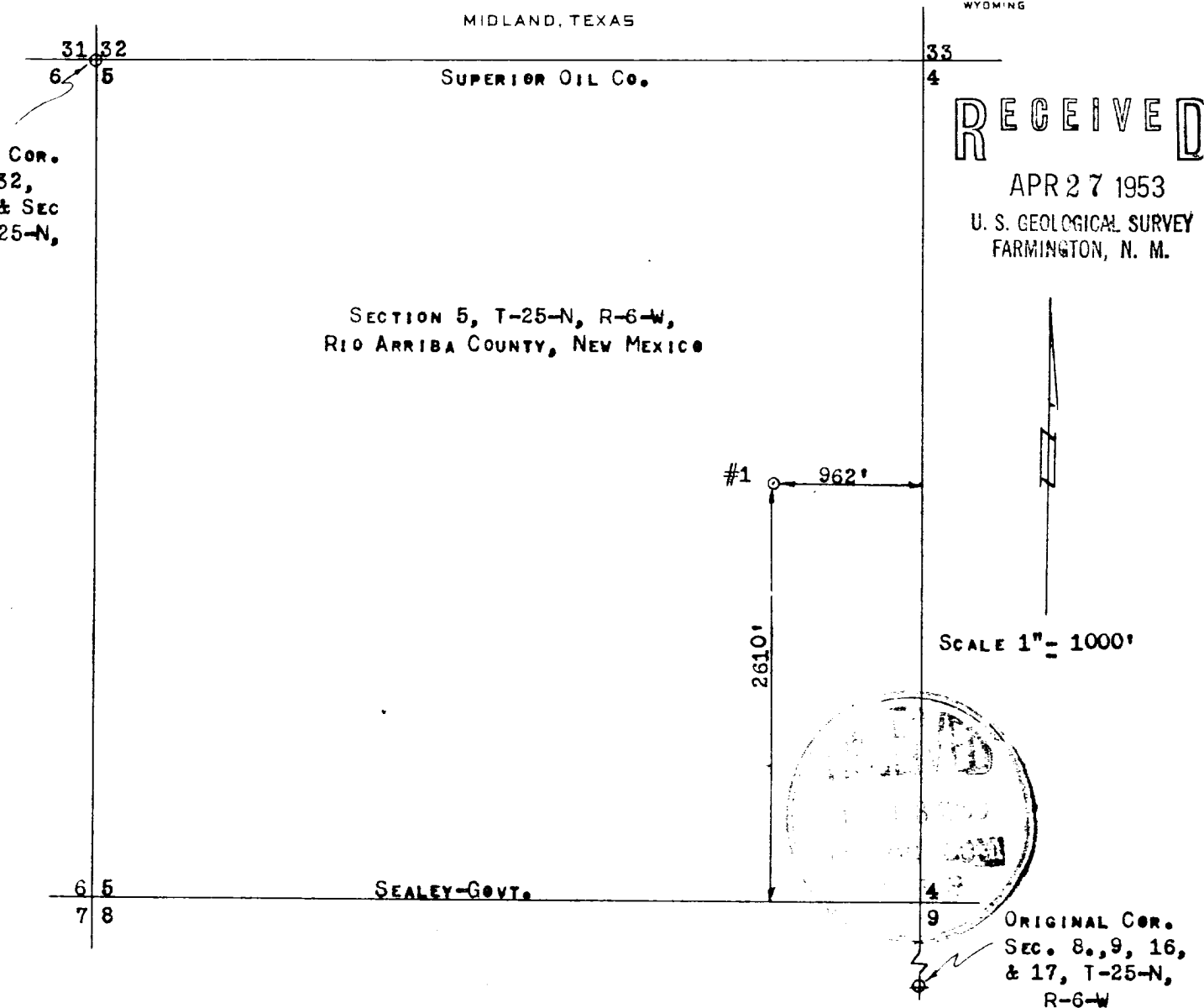

I, EARL K. MONTEITH, REGISTERED LAND SURVEYOR No. 1317, STATE OF NEW MEXICO, HEREBY CERTIFY THAT THIS WELL LOCATION: SUPERIOR-SEALEY-GOVT. #1, 2610' FROM THE SOUTH LINE AND 962' FROM THE EAST LINE, SECTION 5, T-25-N, R-6-W, RIO ARRIBA COUNTY, NEW MEXICO, WAS STAKED ON THE GROUND UNDER MY SUPERVISION AND THAT THIS PLAT IS TRUE AND CORRECT. APRIL 24, 1953

*Earl K. Monteith*  
EARL K. MONTEITH