

9-3310
(May 1963)

SUBMIT IN TRIPLICATE*
(Other instructions on
reverse side)

Form approved
Budget Bureau No. 42-R1425.

UNITED STATES
DEPARTMENT OF THE INTERIOR
GEOLOGICAL SURVEY

APPLICATION FOR PERMIT TO DRILL, DEEPEN, OR PLUG BACK

1a. TYPE OF WORK

DRILL ☒

DEEPEN ☐

PLUG BACK ☐

b. TYPE OF WELL

OIL
WELL ☐

GAS
WELL ☒

OTHER

SINGLE
ZONE ☐

MULTIPLE
ZONE ☒

2. NAME OF OPERATOR

Continental Oil Company

3. ADDRESS OF OPERATOR

P. O. Box 1312 - Durango, Colorado

4. LOCATION OF WELL (Report location clearly and in accordance with any State requirements.*)
At surface 990' FNL, 1190' FNL

At proposed prod. zone

14. DISTANCE IN MILES AND DIRECTION FROM NEAREST TOWN OR POST OFFICE*
45 Miles NW Cuba, New Mexico

15. DISTANCE FROM PROPOSED*
LOCATION TO NEAREST
PROPERTY OR LEASE LINE, FT.

(Also to nearest drig. unit line, if any)

18. DISTANCE FROM PROPOSED LOCATION*
TO NEAREST WELL, DRILLING, COMPLETED,
OR APPLIED FOR, ON THIS LEASE, FT.

21. ELEVATIONS (Show whether DF, RT, GR, etc.)
6644' GR

16. NO. OF ACRES IN LEASE
2340

17. NO. OF ACRES ASSIGNED
TO THIS WELL 140

20. ROTARY OR CABLE TOOLS
Rotary

22. APPROX. DATE WORK WILL START*
6-10-65

PROPOSED CASING AND CEMENTING PROGRAM

23.

SIZE OF HOLE	SIZE OF CASING	WEIGHT PER FOOT	SETTING DEPTH	QUANTITY OF CEMENT
12 1/4"	8 3/8"	24.7	200'	150 sacks
6 3/4"	4 1/2"	15.30	3930'	375 sacks

We propose to drill the subject well to an approximate depth of 3930' and to further develop the Pictured Cliffs and Chacra gas reservoirs and to increase gas production. A string of surface casing will be cemented to surface. A 1 1/2" production casing will be run and cemented if commercial production is encountered and the well will be fully completed.

RECEIVED
JUN 2 1965
CON. COM.
DIST. 3

RECEIVED

JUN 1 1965

U. S. GEOLOGICAL SURVEY
FARMINGTON, N. M.

IN ABOVE SPACE DESCRIBE PROPOSED PROGRAM: If proposal is to deepen or plug back, give data on present productive zone and proposed new production zone. If proposal is to drill or deepen directionally, give pertinent data on subsurface locations and measured and true vertical depths. Give blow prevention program, if any.

24. Original Signed By:

SIGNED H. D. HALEY

TITLE

District Manager

DATE

5-28-65

(This space for Federal or State office use)

APPROVAL DATE

PERMIT NO.

TITLE

DATE

APPROVED BY
CONDITIONS OF APPROVAL, IF ANY:

*See Instructions On Reverse Side

5005 (4)-2000 (2)-200-200-200-200-200-200

Instructions

General: This form is designed for submitting proposals to perform certain well operations, as indicated, on all types of lands and leases for appropriate action by either a Federal or a State agency, or both, pursuant to applicable Federal and/or State laws and regulations. Any necessary special instructions concerning the use of this form and the number of copies to be submitted, particularly with regard to local, area, or regional procedures and practices, either are shown below or will be issued by, or may be obtained from, the local Federal and/or State office.

Item 1: If the proposal is to redrill to the same reservoir at a different subsurface location or to a new reservoir, use this form with appropriate notations. Consult applicable State or Federal regulations concerning subsequent work proposals or reports on the well.

Item 4: If there are no applicable State requirements, locations on Federal or Indian land should be described in accordance with Federal requirements. Consult local State or Federal office for specific instructions.

Item 14: Needed only when location of well cannot readily be found by road from the land or lease description. A plat, or plats, separate or on this reverse side, showing the roads to, and the surveyed location of, the well, and any other required information, should be furnished when required by Federal or State agency offices.

Items 15 and 18: If well is to be, or has been directionally drilled, give distances for subsurface location of hole in any present or objective production zone.

Item 22: Consult applicable Federal or State regulations, or appropriate officials, concerning approval of the proposal before operations are started.

**NEW MEXICO OIL CONSERVATION COMMISSION
WELL LOCATION AND ACREAGE DEDICATION PLAT**

Form C-102
Supersedes C-128
Effective 1-1-65

All distances must be from the outer boundaries of the Section.

Operator Continental Oil Company			Lease AKI Apache "J"		Well No. 11
Unit Letter A	Section 6	Township 25N	Range 5W	County Rio Arriba	
Actual Footage Location of Well: <div style="display: flex; justify-content: space-between;"> 990 feet from the North line and 1190 feet from the East line </div>					
Ground Level Elev: 6644'	Producing Formation Chacra-Pictured Cliffs	Pool Otore Chacra-South Blanco Pictured Cliffs	Dedicated Acreage: 140-159.69 Acres		

1. Outline the acreage dedicated to the subject well by colored pencil or hachure marks on the plat below.
2. If more than one lease is dedicated to the well, outline each and identify the ownership thereof (both as to working interest and royalty).
3. If more than one lease of different ownership is dedicated to the well, have the interests of all owners been consolidated by communitization, unitization, force-pooling, etc?

☐ Yes ☐ No If answer is "yes," type of consolidation _____

If answer is "no," list the owners and tract descriptions which have actually been consolidated (on the reverse side of this form if necessary.) _____

No allowable will be assigned to the well until all interests have been consolidated (by communitization, unitization, forced-pooling, or otherwise) or until a non-standard unit, eliminating such interests, has been approved by the Commission.

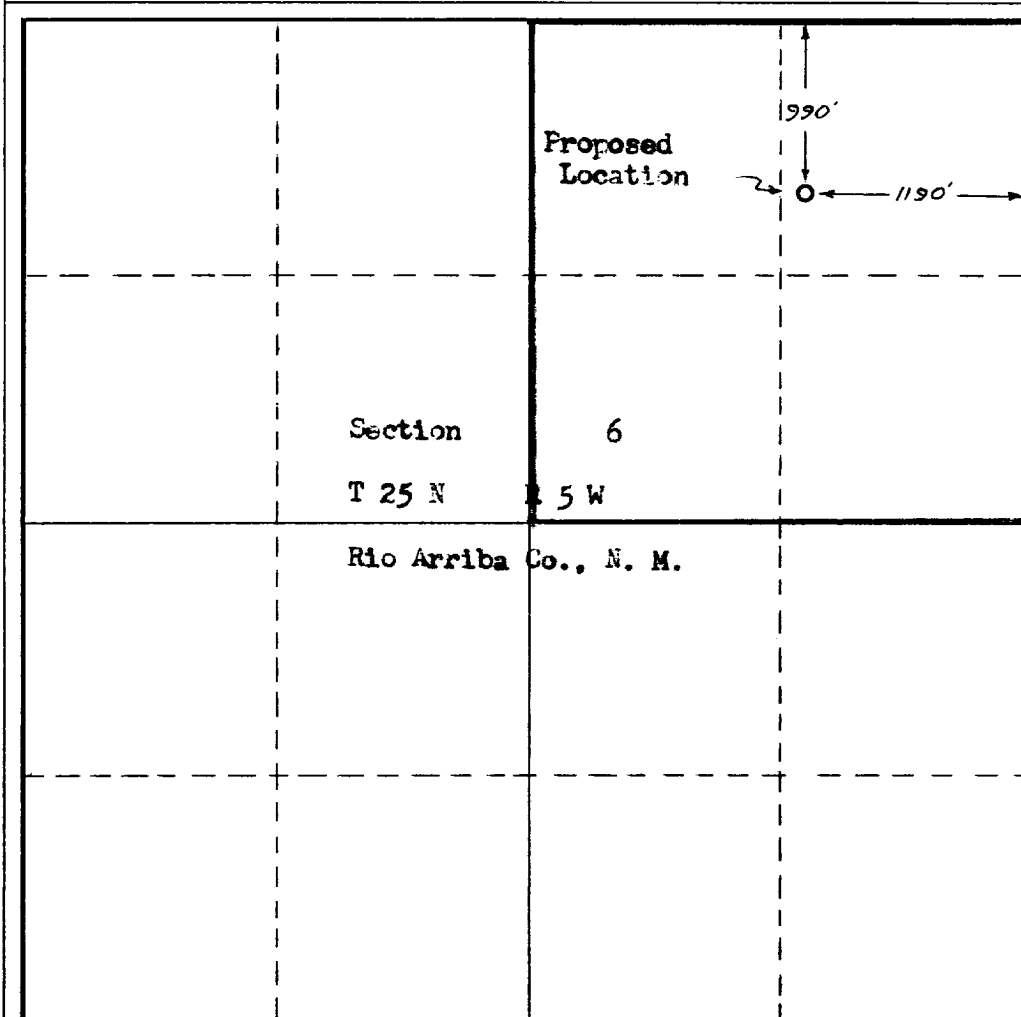
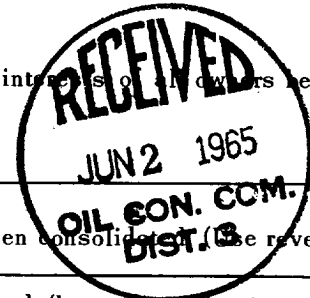

CERTIFICATION

I hereby certify that the information contained herein is true and complete to the best of my knowledge and belief.

Original Signed By:

Name **H. D. HALEY**
District Manager
 Position
Continental Oil Company
 Company

Date
5/28/65

I hereby certify that the well location shown on this plat was plotted from field notes of actual surveys made by me or under my supervision, and that the same is true and correct to the best of my knowledge and belief.

Date Surveyed
May 24, 1965
 Registered Professional Engineer
 and/or Land Surveyor

Frederick H. Reed

Certificate No.
N. M. # 3795

