

UNITED STATES
DEPARTMENT OF THE INTERIOR
GEOLOGICAL SURVEY

APPLICATION FOR PERMIT TO DRILL, DEEPEN, OR PLUG BACK

1a. TYPE OF WORK DRILL <input checked="" type="checkbox"/> DEEPEN <input type="checkbox"/> PLUG BACK <input type="checkbox"/>			5. LEASE DESIGNATION AND SERIAL NO. SF 079177		
b. TYPE OF WELL OIL WELL <input type="checkbox"/> GAS WELL <input checked="" type="checkbox"/> OTHER <input type="checkbox"/> SINGLE ZONE <input type="checkbox"/> MULTIPLE ZONE <input type="checkbox"/>			6. IF INDIAN, ALLOTTEE OR TRIBE NAME		
2. NAME OF OPERATOR Merrion & Bayless			7. UNIT AGREEMENT NAME Canyon Largo Unit		
3. ADDRESS OF OPERATOR Box 1541 Farmington, New Mexico			8. FARM OR LEASE NAME		
4. LOCATION OF WELL (Report location clearly and in accordance with any State requirements.) At surface 790' from North line and 870' from East line At proposed prod. zone same			9. WELL NO. 140		
14. DISTANCE IN MILES AND DIRECTION FROM NEAREST TOWN OR POST OFFICE*			10. FIELD AND POOL, OR WILDCAT Undesignated Chacra		
15. DISTANCE FROM PROPOSED* LOCATION TO NEAREST PROPERTY OR LEASE LINE, FT. (Also to nearest dr. hole if any) 790			11. SEC., T., R., M., OR BLK. AND SURVEY OR AREA 9-25N-6W		
16. NO. OF ACRES IN LEASE			12. COUNTY OR PARISH		
17. NO. OF ACRES ASSIGNED TO THIS WELL			13. STATE		
18. DISTANCE FROM PROPOSED* LOCATION TO NEAREST WELL, DRILLING COMPLETED, OR APPLIED FOR, ON THIS LEASE, FT.			Rio Arriba New Mexico		
19. PROPOSED DEPTH 3600			20. ROTARY OR CABLE TOOLS Rotary		
21. ELEVATIONS (Show whether TD, GR, etc.) 6503 ground			22. APPROX. DATE WORK WILL START* 10-5-67		

23. PROPOSED CASING AND CEMENTING PROGRAM				
SIZE OF HOLE	SIZE OF CASING	WEIGHT PER FOOT	SETTING DEPTH	QUANTITY OF CEMENT
11"	7-5/8"	24#	100'	75 sax
6-3/4"	2-7/8"	6.5#	3600'	250 sax

Drill 11" hole to 100' and set 100' of 7-5/8 csng w/ 75 sax cement

Drill 6-3/4" hole to 3600' to test Chacra. Will run 2-7/8" EUE casng to TD and cement w/ 250 sax



IN ABOVE SPACE DESCRIBE PROPOSED PROGRAM: If proposal is to deepen or plug back, give data on present productive zone and proposed new productive zone. If proposal is to drill or deepen directionally, give pertinent data on subsurface locations and measured and true vertical depths. Give blowout preventer program, if any.

24. SIGNED B. L. Bayless TITLE _____ DATE Sept 21, 1967
(This space for Federal or State office use)

PERMIT NO. _____ APPROVAL DATE _____
APPROVED BY [Signature] TITLE _____ DATE _____
CONDITIONS OF APPROVAL, IF ANY:

RECEIVED
SEP 23 1967

**NEW MEXICO OIL CONSERVATION COMMISSION
WELL LOCATION AND ACERAGE DEDICATION PLAT**

All distances must be from the outer boundaries of the Section

Operator MERRION & BAYLESS		Lease Canyon Largo Unit		Well No. 140	
Unit Letter A	Section 9	Township 25 North	Range 6 West	County Rio Arriba	
Actual Footage Location of Well:					
790	feet from the	North	line and	870	feet from the East line
Ground Level Elev. 6503, ungraded	Producing Formation Chacra		Poc Undesignated Chacra	Dedicated Acreage 160	Acres

1. Outline the acreage dedicated to the subject well by colored pencil or hatchure marks on the plat below.
2. If more than one lease is dedicated to the well, outline each and certify the ownership thereof both as to working interest and royalty).
3. If more than one lease of different ownership is dedicated to the well, have the interests of all owners been consolidated by communization, unitization, force-pooling, etc?

☒ Yes ☐ No If answer is "yes," type of consolidation: Unitization

If answer is "no," list the owners and tract descriptions which have actually consolidated. (Use reverse side of this form if necessary.)

No allowable will be assigned to the well until all interests have been consolidated (by communization, unitization, forced-pooling, or otherwise) or until a non standard unit, eliminating such interests, has been approved by the Commission.

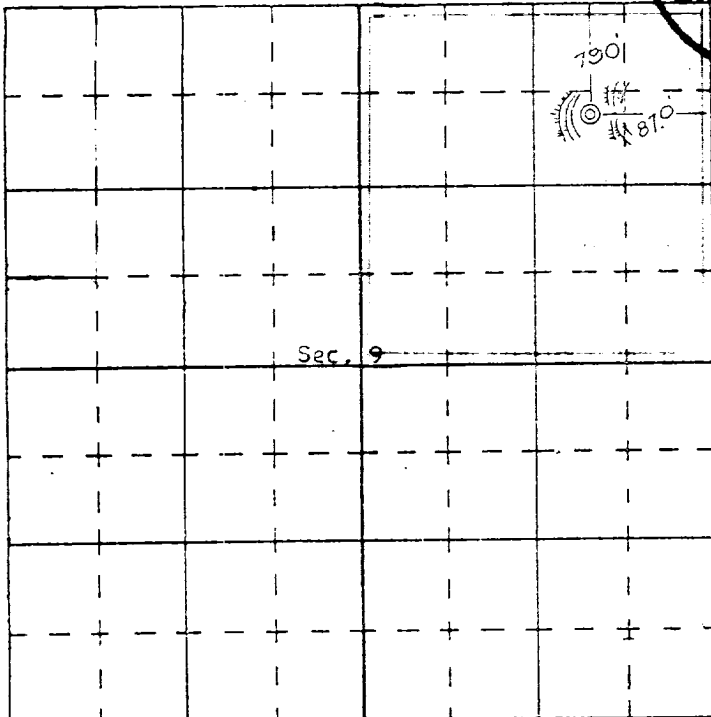

N

CERTIFICATION

I hereby certify that the information contained herein is true and complete to the best of my knowledge and belief.

Name _____

R. L. Bayless
Company
Merrion & Bayless

Date
9-21-67

I hereby certify that the well location shown on this plat was plotted from field notes of actual surveys made by me or under my supervision, and that the same is true and correct to the best of my knowledge and belief.

Date Surveyed _____

September 14, 1967
Registered Professional Engineer
and/or Land Surveyor

E. U. Echohawk
Certificate No. **3602**