

UNITED STATES
DEPARTMENT OF THE INTERIOR
GEOLOGICAL SURVEY

30-039-20415

APPLICATION FOR PERMIT TO DRILL, DEEPEN, OR PLUG BACK

1a. TYPE OF WORK

DRILL ☒DEEPEN ☐PLUG BACK ☐

b. TYPE OF WELL

OIL
WELL ☐GAS
WELL ☒

OTHER

SINGLE
ZONE ☒MULTIPLE
ZONE ☐

2. NAME OF OPERATOR

Continental Oil Company

3. ADDRESS OF OPERATOR

152 North Durbin, Casper, Wyoming 82601

4. LOCATION OF WELL (Report location clearly and in accordance with any State requirements.*)

At surface

NE NW, 790' FNL, 1790' FWL (Unit Letter "C")

At proposed prod. zone

14. DISTANCE IN MILES AND DIRECTION FROM NEAREST TOWN OR POST OFFICE*

15. DISTANCE FROM PROPOSED*

LOCATION TO NEAREST
PROPERTY OR LEASE LINE, FT.
(Also to nearest drlg. unit line, if any)18. DISTANCE FROM PROPOSED LOCATION*
TO NEAREST WELL, DRILLING, COMPLETED,
OR APPLIED FOR, ON THIS LEASE, FT.

21. ELEVATIONS (Show whether DF, RT, GR, etc.)

6610' GR

16. NO. OF ACRES IN LEASE

2560

19. PROPOSED DEPTH

3890'

17. NO. OF ACRES ASSIGNED
TO THIS WELL

160

20. ROTARY OR CABLE TOOLS

Rotary

22. APPROX. DATE WORK WILL START*

10-1-71

5. LEASE DESIGNATION AND SERIAL NO.

147

6. IF INDIAN, ALLOTTEE OR TRIBE NAME

Jicarilla Apache

7. UNIT AGREEMENT NAME

8. FARM OR LEASE NAME

AXI Apache "J"

9. WELL NO.

20

10. FIELD AND POOL, OR WILDCAT

Otero Chacra

11. SEC., T., R., M., OR BLK.
AND SURVEY OR AREA

Sec. 5, T25N, R5W

12. COUNTY OR PARISH

Rio Arriba

13. STATE

New Mexico

23.

PROPOSED CASING AND CEMENTING PROGRAM

SIZE OF HOLE	SIZE OF CASING	WEIGHT PER FOOT	SETTING DEPTH	QUANTITY OF CEMENT
12 1/4"	8 5/8"	24.0#	200'	100 sacks (to surface)
7 7/8"	4 1/2"	11.6#	3890'	160 sacks (to 200' above P.C.)

We propose to drill this well to develop the Chacra reserves. No cores or DST's are planned. All appropriate logs will be run. The rig will be equipped with a blowout preventer.

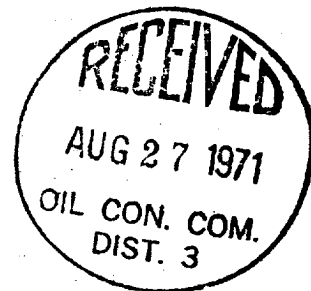

USGS(6) File(2)

IN ABOVE SPACE DESCRIBE PROPOSED PROGRAM: If proposal is to deepen or plug back, give data on present productive zone and proposed new productive zone. If proposal is to drill or deepen directionally, give pertinent data on subsurface locations and measured and true vertical depths. Give blowout preventer program, if any.

24.

SIGNED

Elmer L. Phillips

TITLE

Administrative Supervisor

DATE

8-23-71

(This space for Federal or State office use)

PERMIT NO.

APPROVAL DATE

APPROVED BY

GA

TITLE

DATE

CONDITIONS OF APPROVAL, IF ANY:

**NEW MEXICO OIL CONSERVATION COMMISSION
WELL LOCATION AND ACERAGE DEDICATION PLAT**

All distances must be from the outer boundaries of the Section

Operator **CONTINENTAL OIL COMPANY** Name **JICARILLA** "J" Well No. **20**
 Unit Letter **C** Section **5** Township **25 NORTH** Range **5 WEST** County **RIO ARriba**
 Actual Footage Location of Well **790** feet from the **NORTH** line **1790** feet from the **WEST** line
 Ground Level Elev. **6610.0** Producing Formation **Chacra** For **Under. MV Otero-Chacra** Dedicated Average **159.74** Acres **160**

Outline the acreage dedicated to the subject well by colored pencil or machine marks on the plat below.

2. If more than one lease is dedicated to the well, outline each and identify the ownership (the estate, both as to working interest and royalty).

3. If more than one lease of different ownership is dedicated to the well, have the interests of all owners been consolidated by communitization, unitization, force-pooling, etc?

Yes ☐ No ☐ If answer is "yes," type of consolidation

If answer is "no," list the owners and tract descriptions which have actually consolidated. (Use reverse side of this form if necessary)

No oil well will be assigned to the well until all interests have been consolidated (by communitization, unitization, forced-pooling or otherwise) or until a non standard unit, eliminating such interests, has been approved by the Commission.



CERTIFICATION

I hereby certify that the information contained herein is true and complete to the best of my knowledge and belief.

Name Elmer L. Phillips
 Position Acty. Administrative Supervisor
 Company CONTINENTAL OIL COMPANY
 Date August 23, 1971

I hereby certify that the well location shown on this plat was plotted from field notes of actual surveys made by me or under my supervision, and that the same is true and correct to the best of my knowledge and belief.

18 August, 1971
 Date
 Registered Professional Engineer
 and/or Land Surveyor
JAMES P. LEASE
 1463
 Certificate No.

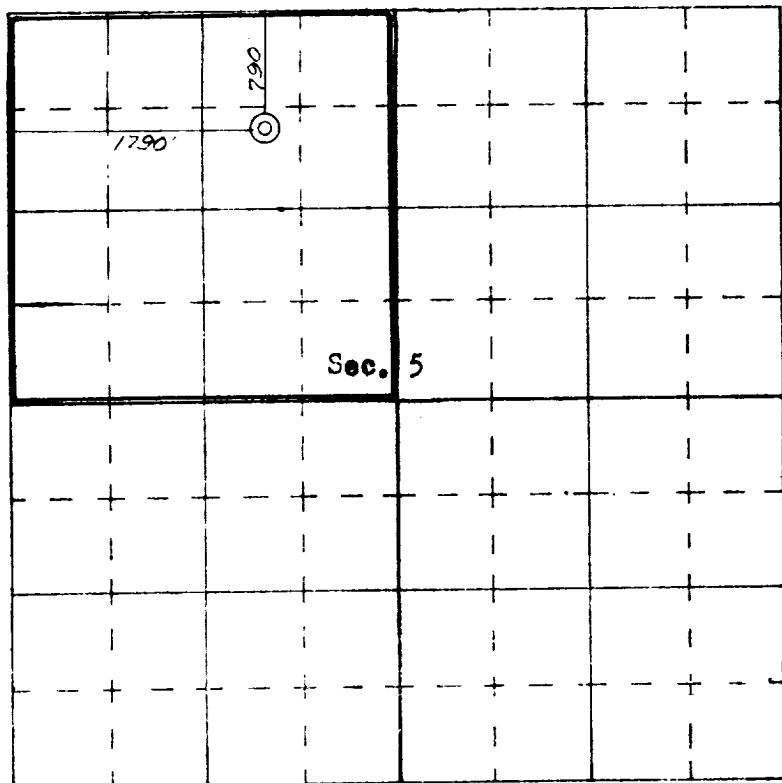

SCALE—4 INCHES EQUALS 1 MILE

SAN JUAN ENGINEERING COMPANY, FARMINGTON, N. M.