

UNITED STATES
DEPARTMENT OF THE INTERIOR
GEOLOGICAL SURVEY

30-039-20419

APPLICATION FOR PERMIT TO DRILL, DEEPEN, OR PLUG BACK

1a. TYPE OF WORK DRILL <input checked="" type="checkbox"/> DEEPEN <input type="checkbox"/> PLUG BACK <input type="checkbox"/>		5. LEASE DESIGNATION AND SERIAL NO. 147
b. TYPE OF WELL OIL WELL <input type="checkbox"/> GAS WELL <input checked="" type="checkbox"/> OTHER <input type="checkbox"/>		6. IF INDIAN, ALLOTTEE OR TRIBE NAME Jicarilla Apache
2. NAME OF OPERATOR Continental Oil Company		7. UNIT AGREEMENT NAME
3. ADDRESS OF OPERATOR 152 North Durbin, Casper, Wyoming 82601		8. FARM OR LEASE NAME AXI Apache
4. LOCATION OF WELL (Specify location clearly and in accordance with any State requirements.)* At surface NE NE 1050' FNL, 990' FEL		9. WELL NO. 18
14. DISTANCE IN MILES AND DIRECTION FROM NEAREST TOWN OR POST OFFICE*		10. FIELD AND POOL, OR WILDCAT AXI Apache - Chacra Chacra and Mesa Verde
15. DISTANCE FROM PROPOSED LOCATION TO NEAREST PROPERTY OR LAND INTEREST (Also to nearest city, town, or village, if any)		11. SEC., T., R., NE, OR ENE, AND SURVEY OR AREA Sec. 8, T25N, R5W
16. NO. OF ACRES IN LEASE 2560		12. COUNTY OR PARISH Rio Arriba
17. NO. OF ACRES ASSIGNED TO THIS WELL 160		13. STATE New Mexico
18. DISTANCE FROM PROPOSED LOCATION TO NEAREST WELL (Existing, completed, or applied for, on this lease, if any)		19. PROPOSED DEPTH 5390'
20. ROTARY OR CABLE TOOLS Rotary		21. APPROX. DATE WORK WILL START* 9-12-71
21. ELEVATIONS (Show whether DE, RT, CR, etc.) 6757' GR		

23. PROPOSED CASING AND CEMENTING PROGRAM

SIZE OF HOLE	SIZE OF CASING	WEIGHT PER FOOT	SETTING DEPTH	QUANTITY OF CEMENT
12 1/4"	8 5/8"	24.0#	200'	150 sacks (to surface)
7 7/8"	4 1/2"	10.5#	5390'	550 sacks (to 200' above P.C.)

We are proposing to drill and equip AXI Apache Well No. 18 to test for commercial production in both the Chacra and Mesa Verde zones. The well will be drilled to a total depth of 5390' with rotary tools. All appropriate logs will be run and no coring or DST's are planned. If commercial production exists the well will be completed by running production casing as indicated above. The rig will be equipped with a blowout preventer.

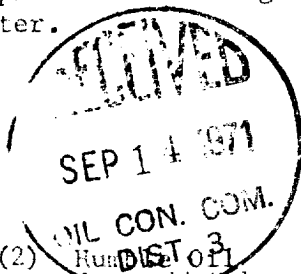

USGS-Durango(6) File(2) Run DIST 3

IN ABOVE SPACE DESCRIBE PROPOSED PROGRAM: If proposal is to deepen or plug back, give data on present productive zone and proposed new productive zone. If proposal is to drill or deepen directionally, give pertinent data on subsurface locations and measured and true vertical depths. Give blowout preventer program, if any.

24. SIGNED J. C. Hallen TITLE Administrative Supervisor DATE 9-9-71
(This space for Federal or State office use)

PERMIT NO. _____ APPROVAL DATE _____

APPROVED BY _____ TITLE _____ DATE _____
CONDITIONS OF APPROVAL, IF ANY:

Hold C-104 for
Continuing Order

*See Instructions On Reverse Side

NEW OIL CON. RVA N. COMMIS
ATION AND / AGE. TION PLAT

All distances must be from the outer boundaries of the Section

CONTINENTAL OIL COMPANY

~~XXXXXXXXXX~~ AXI APACHE "J"

XX 18

6

25 NORTH

5 WEST

RIO AGRIBA

1050'

North

990'

EA T

6757.0

Undes m
Otero Chacra

160 ~~Acres~~



CERTIFICATION

I hereby certify that the information contained herein is true and complete to the best of my knowledge and belief.

Name

Position

Administrative Supervisor

Company

Continental Oil Company

Date

September 9, 1971

I hereby certify that the well location shown on this plat was plotted from field notes of actual surveys made by me or under my supervision, and that the same is true and correct to the best of my knowledge and belief.

3 September, 1971

James P. Leese
Professional Engineer
and/or Land Surveyor

JAMES P. LEESE

1463

ertificate No.

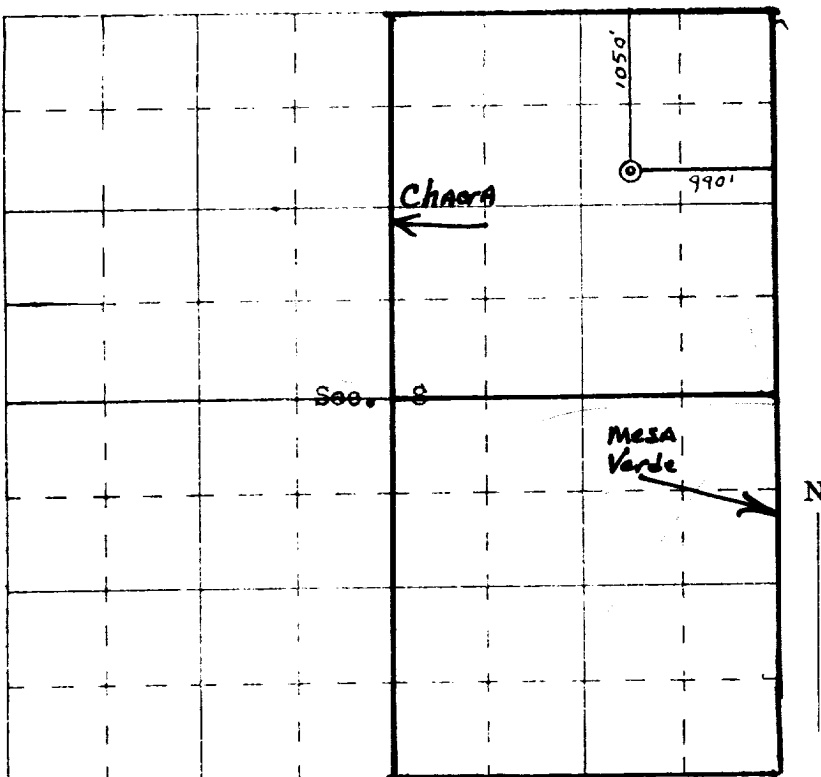

SCALE—4 INCHES EQUALS 1 MILE

SAN JUAN ENGINEERING COMPANY, FARMINGTON, N. M.