

UNITED STATES
DEPARTMENT OF THE INTERIOR
GEOLOGICAL SURVEY

APPLICATION FOR PERMIT TO DRILL, DEEPEN, OR PLUG BACK

1a. TYPE OF WORK

DRILL ☒DEEPEN ☐PLUG BACK ☐

b. TYPE OF WELL

OIL
WELL ☐GAS
WELL ☒

OTHER

SINGLE
ZONE ☐MULTIPLE
ZONE ☐

2. NAME OF OPERATOR

Continental Oil Company

3. ADDRESS OF OPERATOR

152 North Durbin St., Casper, Wyo. 82601

4. LOCATION OF WELL (Report location clearly and in accordance with any State requirements.)*

At surface

1120' FSL, 790' FWL (SW SW)

At proposed prod. zone

14. DISTANCE IN MILES AND DIRECTION FROM NEAREST TOWN OR POST OFFICE*

15. DISTANCE FROM PROPOSED*

LOCATION TO NEAREST
PROPERTY OR LEASE LINE, FT.
(Also to nearest drig. unit line, if any)

18. DISTANCE FROM PROPOSED LOCATION*

TO NEAREST WELL, DRILLING, COMPLETED,
OR APPLIED FOR, ON THIS LEASE, FT.

16. NO. OF ACRES IN LEASE

19. PROPOSED DEPTH

3950'

17. NO. OF ACRES ASSIGNED
TO THIS WELL

20. ROTARY OR CABLE TOOLS

Rotary

21. ELEVATIONS (Show whether DF, RT, GR, etc.)

7290' GR

22. APPROX. DATE WORK WILL START*

July 10, 1973

23.

PROPOSED CASING AND CEMENTING PROGRAM

| SIZE OF HOLE | SIZE OF CASING | WEIGHT PER FOOT | SETTING DEPTH | QUANTITY OF CEMENT |
|--------------|----------------|-----------------|---------------|--------------------|
| 12 1/4" | 8 5/8" | 24 # | 200' | 150 sacks |
| 7 7/8" | 4 1/2" | 10.5# | 3950' | 100 sacks |

It is proposed to drill the subject well to further develop and outline the Pictured Cliffs formation on this lease. No cores or DST's are planned. All appropriate logs will be run. The drilling rig will be equipped with a blowout preventer which will be tested daily.



USGS(4) NMOCC(2) Jicarilla Apache Tribe, EXXON, Amoco, Aztec, File(2)

IN ABOVE SPACE DESCRIBE PROPOSED PROGRAM: If proposal is to deepen or plug back, give data on present productive zone and proposed new productive zone. If proposal is to drill or deepen directionally, give pertinent data on subsurface locations and measured and true vertical depths. Give blowout preventer program, if any.

24.

SIGNED

J.A. Ubben

TITLE Administrative Supervisor

DATE 6/14/73

(This space for Federal or State office use)

PERMIT NO.

APPROVAL DATE

APPROVED BY

SA

TITLE

DATE

CONDITIONS OF APPROVAL, IF ANY:

NEW MEXICO OIL CONSERVATION COMMISSION

WELL LOCATION AND ACERAGE DEDICATION PLAT

All distances must be from the outer boundaries of the Section

| | | | | | |
|---|--|-----------------------------|---|-----------------------------|--|
| Operator CONTINENTAL OIL COMPANY | | Lease AXI APACHE | | Well No. 0 3 | |
| Unit Letter M | Section 9 | Township 25 NORTH | Range 4 WEST | County RIO ARriba | |
| Actual Footage Location of Well: 1120 feet from the SOUTH line and 790 feet from the WEST line | | | | | |
| Ground Level Elev 7290.0 | Producing Formation South Blanco - Pictured Cliffs | | Pool South Blanco - Pictured Cliffs | | Dedicated Acreage: 160 Acres |

- Outline the acreage dedicated to the subject well by colored pencil or hatchure marks on the plat below.
- If more than one lease is dedicated to the well, outline each and identify the ownership thereof (both as to working interest and royalty).
- If more than one lease of different ownership is dedicated to the well, have the interests of all owners been consolidated by communitization, unitization, force-pooling, etc?

() Yes () No If answer is "yes," type of consolidation _____

If answer is "no," list the owners and tract descriptions which have actually consolidated (use reverse side of this form if necessary.) _____

No allowable will be assigned to the well until all interests have been consolidated (by communitization, unitization, forced-pooling, or otherwise) or until a non standard unit, eliminating such interests, has been approved by the Commission.

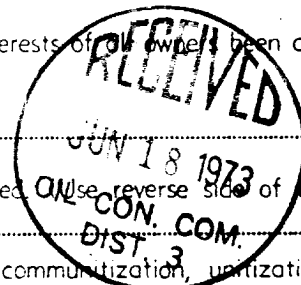

CERTIFICATION

I hereby certify that the information contained herein is true and complete to the best of my knowledge and belief.

John A. Ubben
Name
John A. Ubben
Position

Administrative Supervisor
Company

Continental Oil Company
Date

June 14, 1973

I hereby certify that the well location shown on this plat was plotted from field notes of actual surveys made by me or under my supervision, and that the same is true and correct to the best of my knowledge and belief.

6 June 1973
Date Signed

James P. Leese
Registered Professional Engineer
and/or Land Surveyor

JAMES P. LEESE

1463

Certificate No.

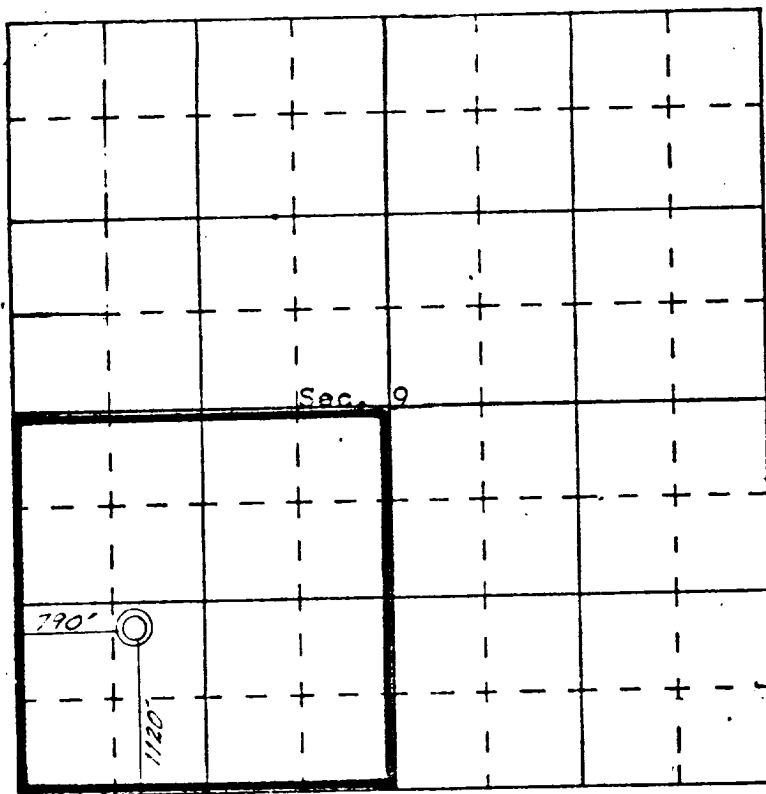

SCALE—4 INCHES EQUALS 1 MILE

SAN JUAN ENGINEERING COMPANY, FARMINGTON, N. M.