

UNITED STATES  
DEPARTMENT OF THE INTERIOR  
GEOLOGICAL SURVEY

(Other instructions on reverse side)

Budget Bureau No. 12-81120.

30-039-20910

APPLICATION FOR PERMIT TO DRILL, DEEPEN, OR PLUG BACK

## 1a. TYPE OF WORK

DRILL ☒DEEPEN ☐PLUG BACK ☐

## b. TYPE OF WELL

OIL  
WELL ☒GAS  
WELL ☐

OTHER

SINGLE  
ZONE ☒MULTIPLE  
ZONE ☐

## 2. NAME OF OPERATOR

Clinton Oil Company

## 3. ADDRESS OF OPERATOR

P.O. Box 2434, Casper, Wyoming 82601

## 4. LOCATION OF WELL (Report location clearly and in accordance with any State requirements.)\*

At surface 990' FWL &amp; 990' FSL of Sec 36-T25N-R5W

Rio Arriba Co., New Mexico

At proposed prod. zone

## 14. DISTANCE IN MILES AND DIRECTION FROM NEAREST TOWN OR POST OFFICE\*

35 Miles North of Cuba, New Mexico

## 15. DISTANCE FROM PROPOSED\*

LOCATION TO NEAREST  
PROPERTY OR LEASE LINE, FT.  
(Also to nearest drilg. unit line, if any)

990'

## 16. NO. OF ACRES IN LEASE

2400

17. NO. OF ACRES ASSIGNED  
TO THIS WELL

320

18. DISTANCE FROM PROPOSED LOCATION\*  
TO NEAREST WELL, DRILLING, COMPLETED,  
OR APPLIED FOR, ON THIS LEASE, FT.

5125'

## 19. PROPOSED DEPTH

6550'

## 20. ROTARY OR CABLE TOOLS

Rotary

## 21. ELEVATIONS (Show whether DF, RT, GR, etc.)

6798' GR

## 22. APPROX. DATE WORK WILL START\*

June 1, 1974

## 23.

## PROPOSED CASING AND CEMENTING PROGRAM

SIZE OF HOLE	SIZE OF CASING	WEIGHT PER FOOT	SETTING DEPTH	QUANTITY OF CEMENT
12-1/4"	8-5/8"	23#	500'	350 SXS
7-7/8"	5-1/2"	14-15.5#	6550'	675 SXS

We propose to drill the above well with rotary tools to an approximate total depth of 6550' into the Gallup Formation. Stimulation and completion will be indicated upon reaching the formation. Copies of the location plat are attached.

A copy of any logs or surveys run will be submitted upon completion of the well.

The following formations are anticipated - Pictured Cliffs - 2890', Chacra - 3730', Menefee - 4990', Mancos - 5125', Gallup - 6207'. No cores are anticipated.

Possible Drill Stem Test in the Menefee or Mancos Gas Sand.

Archeological approval obtained verbally from Mr. Leland J. Able, Albuquerque, New Mexico

IN ABOVE SPACE DESCRIBE PROPOSED PROGRAM: If proposal is to deepen or plug back, give data on present productive zone and proposed new productive zone. If proposal is to drill or deepen directionally, give pertinent data on subsurface locations and measured and true vertical depths. Give blowout preventer program, if any.

## 24.

SIGNED

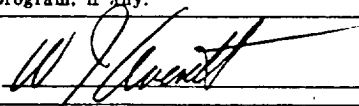

TITLE District Manager

DATE 5-16-74

(This space for Federal or State office use)

PERMIT NO.

APPROVAL DATE

APPROVED BY



TITLE

DATE

CONDITIONS OF APPROVAL, IF ANY:

\*See Instructions On Reverse Side



**NEW MEXICO OIL CONSERVATION COMMISSION  
WELL LOCATION AND ACREAGE DEDICATION PLAT**

Form C-102  
Supersedes C-128  
Effective 1-1-65

All distances must be from the outer boundaries of the Section.

Operator <b>Clinton Oil Company</b>			Lease		Well No.
Unit Letter <b>M</b>	Section <b>36</b>	Township <b>25 North</b>	Range <b>5 West</b>	County <b>Rio Arriba</b>	
Actual Footage Location of Well: <div style="display: flex; justify-content: space-between;"> <span><b>990</b> feet from the <b>South</b> line and</span> <span><b>990</b> feet from the <b>West</b> line</span> </div>					
Ground Level Elev: <b>6798</b>	Producing Formation <b>Gallup</b>	Pool <b>Otero Gallup</b>		Dedicated Acreage: <div style="text-align: right;">Acres</div>	

1. Outline the acreage dedicated to the subject well by colored pencil or hachure marks on the plat below.
2. If more than one lease is dedicated to the well, outline each and identify the ownership thereof (both as to working interest and royalty).
3. If more than one lease of different ownership is dedicated to the well, have the interests of all owners been consolidated by communitization, unitization, force-pooling, etc?

☐ Yes    ☐ No    If answer is "yes," type of consolidation \_\_\_\_\_

If answer is "no," list the owners and tract descriptions which have actually been consolidated. (Use reverse side of this form if necessary.) \_\_\_\_\_

No allowable will be assigned to the well until all interests have been consolidated (by communitization, unitization, forced-pooling, or otherwise) or until a non-standard unit, eliminating such interests, has been approved by the Commission.

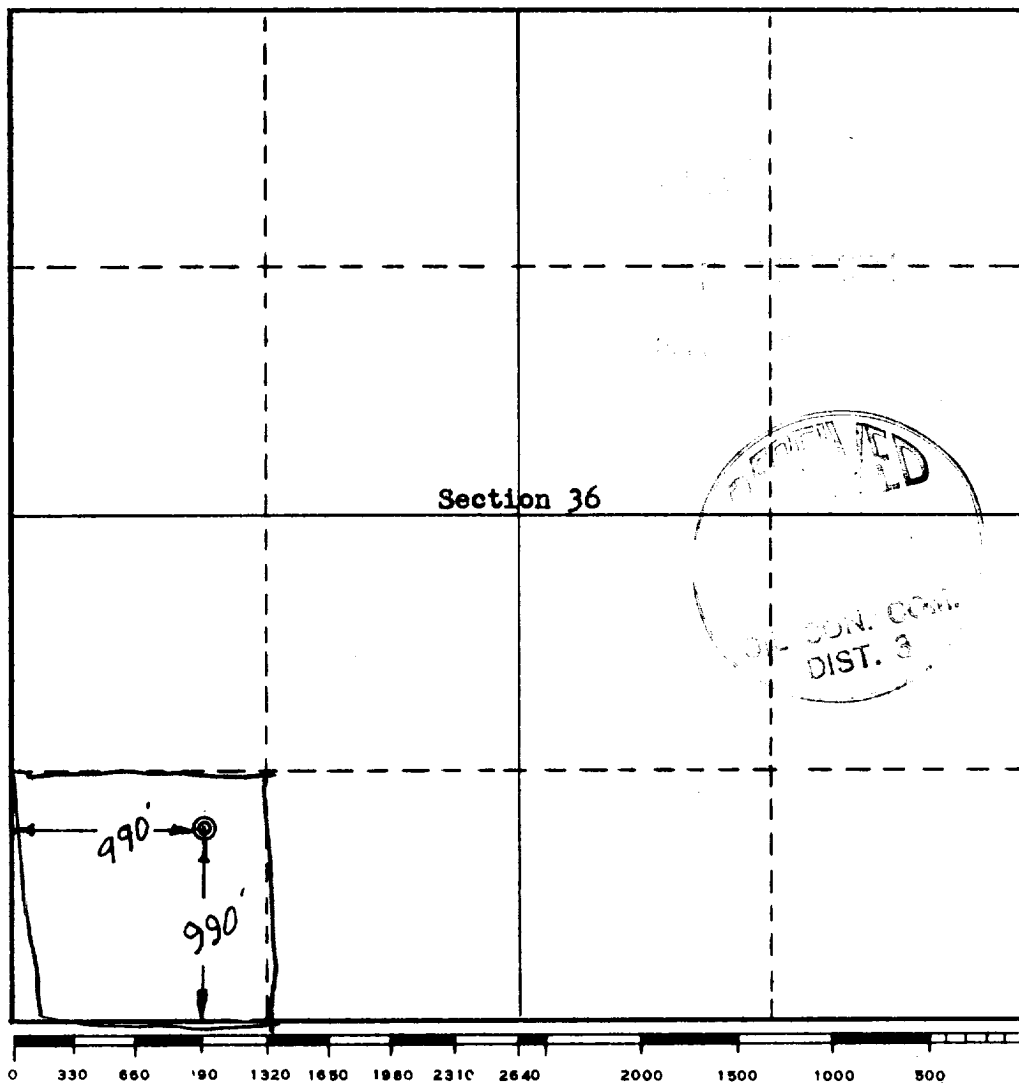

**CERTIFICATION**

*I hereby certify that the information contained herein is true and complete to the best of my knowledge and belief.*

Name \_\_\_\_\_

Position \_\_\_\_\_

Company \_\_\_\_\_

Date \_\_\_\_\_

*I hereby certify that the well location shown on this plat was plotted from field notes of actual surveys made by me or under my supervision, and that the same is true and correct to the best of my knowledge and belief.*

Date Surveyed \_\_\_\_\_

**March 20, 1974**

Registered Professional Engineer and Land Surveyor

Certificate No. \_\_\_\_\_

