

NO. COPIES RECEIVED	
DISTRIBUTION	
SANTA FE	1
FILE	1
U.S.G.S.	2
LAND OFFICE	
OPERATOR	2

NEW MEXICO OIL CONSERVATION COMMISSION

Form C-101
Revised 1-1-65 3063920938

5A. Indicate Type of Lease
STATE ☐ FEE ☒

5. State Oil & Gas Lease No.

APPLICATION FOR PERMIT TO DRILL, DEEPEN, OR PLUG BACK

1a. Type of Work b. Type of Well OIL WELL <input type="checkbox"/> GAS WELL <input checked="" type="checkbox"/> OTHER <input type="checkbox"/> SINGLE ZONE <input checked="" type="checkbox"/> MULTIPLE ZONE <input type="checkbox"/>		7. Unit Agreement Name <u>Lindrith Unit</u> 8. Farm or Lease Name <u>Lindrith Unit</u>	
2. Name of Operator <u>El Paso Natural Gas Company</u>		9. Well No. <u>81</u>	
3. Address of Operator <u>PO Box 990, Farmington, NM 87401</u>		10. Field and Pool, or Wildcat <u>So. Blanco Pictured Cliffs</u>	
4. Location of Well UNIT LETTER <u>E</u> LOCATED <u>1475</u> FEET FROM THE <u>North</u> LINE AND <u>800</u> FEET FROM THE <u>West</u> LINE OF SEC. <u>12</u> TWP. <u>24N</u> RGE. <u>3W</u> NMPM		12. County <u>Rio Arriba</u>	
19. Proposed Depth <u>3335'</u>		19A. Formation <u>Pictured Cliffs</u>	
20. Rotary or C.T. <u>Rotary</u>		21. Elevations (Show whether DT, RT, etc.) <u>6980'GL</u>	
21A. Kind & Status Plug. Bond <u>statewide</u>		21B. Drilling Contractor	
22. Approx. Date Work will start			

23. PROPOSED CASING AND CEMENT PROGRAM

SIZE OF HOLE	SIZE OF CASING	WEIGHT PER FOOT	SETTING DEPTH	SACKS OF CEMENT	EST. TOP
12 1/4"	8 5/8"	24.0#	120'	106 cu. ft.	circulated to surface
6 3/4"	2 7/8"	6.4#	3335'	146 cu. ft.	cover Ojo Alamo

Selectively perforate and sandwater fracture the Pictured Cliffs formation.

The NW/4 of Section 12 is dedicated to this well.



EXPIRES 9 24 74
UNLESS
FOR
DRILLING
EXPENSES

IN ABOVE SPACE DESCRIBE PROPOSED PROGRAM: IF PROPOSAL IS TO DEEPEN OR PLUG BACK, GIVE DATA ON PRESENT PRODUCTIVE ZONE AND PROPOSED NEW PRODUCTIVE ZONE. GIVE BLOWOUT PREVENTER PROGRAM, IF ANY.

I hereby certify that the information above is true and complete to the best of my knowledge and belief.

Signed Don G. Brees Title Drilling Clerk Date June 26, 1974

(This space for State Use)

APPROVED BY [Signature] TITLE SUPERVISOR DIST. #3 DATE JUN 26 1974

CONDITIONS OF APPROVAL, IF ANY:

**NEW MEXICO OIL CONSERVATION COMMISSION
WELL LOCATION AND ACREAGE DEDICATION PLAT**

Form C-102
Supersedes C-128
Effective 1-1-65

All distances must be from the outer boundaries of the Section.

Operator El Paso Natural Gas Company			Lease Lindrith Unit (FEE)		Well No. 81
Unit Letter E	Section 12	Township 24N	Range 3W	County Rio Arriba	
Actual Footage Location of Well: 1475 feet from the North line and 800 feet from the West line					
Ground Level Elev. 6980	Producing Formation Pictured Cliffs		Pool So. Blanco Pictured Cliffs		Dedicated Acreage: 160.00 Acres

1. Outline the acreage dedicated to the subject well by colored pencil or hachure marks on the plat below.
2. If more than one lease is dedicated to the well, outline each and identify the ownership thereof (both as to working interest and royalty).
3. If more than one lease of different ownership is dedicated to the well, have the interests of all owners been consolidated by communitization, unitization, force-pooling, etc?

☒ Yes ☐ No If answer is "yes," type of consolidation Unitization

If answer is "no," list the owners and tract descriptions which have actually been consolidated. (Use reverse side of this form if necessary.) _____

No allowable will be assigned to the well until all interests have been consolidated (by communitization, unitization, forced-pooling, or otherwise) or until a non-standard unit, eliminating such interests, has been approved by the Commission.

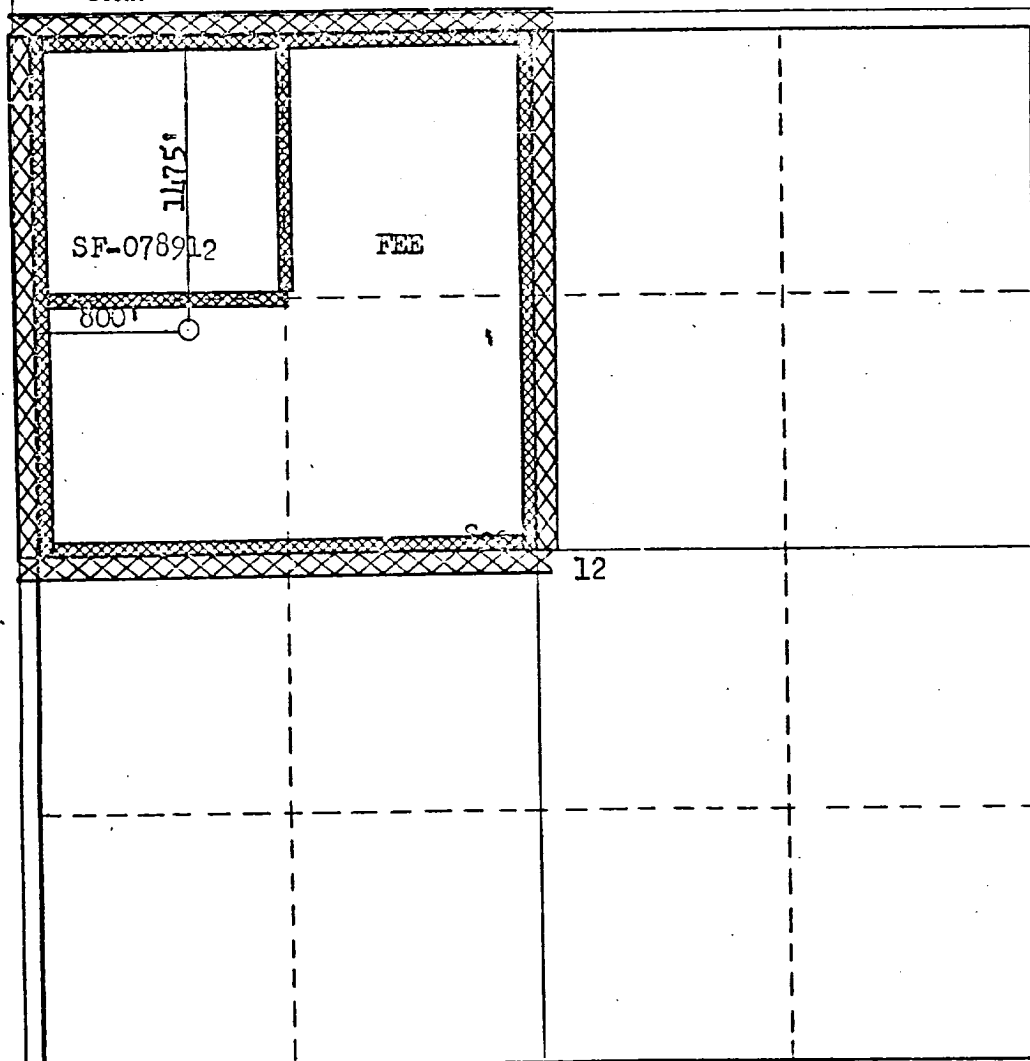

CERTIFICATION

I hereby certify that the information contained herein is true and complete to the best of my knowledge and belief.

A. G. Duico

Name
Drilling Clerk
Position
El Paso Natural Gas Company
Company
June 26, 1974
Date

I hereby certify that the well location shown on this plat was plotted from field notes of actual surveys made by me or under my supervision, and that the same is true and correct to the best of my knowledge and belief.

Date Surveyed
April 21, 1974
Registered Professional Engineer and/or Land Surveyor
Fred B. Kerr Jr.
Fred B. Kerr Jr.
Certificate No.
3950

