

UNITED STATES
DEPARTMENT OF THE INTERIOR
GEOLOGICAL SURVEY

SUBMIT IN REPLICATE
(Other instructions on
reverse side)

Form G-20 (Rev. 12-1-66)
Bureau of Land Management

API 30-039-21185

APPLICATION FOR PERMIT TO DRILL, DEEPEN, OR PLUG BACK

1a. TYPE OF WORK

DRILL ☒

DEEPEN ☐

PLUG BACK ☐

b. TYPE OF WELL

CR. ☐

GAS ☒

OTHER

SINGLE ☒

MULTIPLE ☐

2. NAME OF OPERATOR

Manning Gas & Oil Company

3. ADDRESS OF OPERATOR 1660 Lincoln Street, Suite 2322,

Denver, Colorado 80203

4. LOCATION OF WELL (Report location clearly and in accordance with any State requirements.)*

At surface

1040' FSL, 810' FWL

At pay and prod. zone

Same

14. DISTANCE IN MILES AND DIRECTION FROM NEAREST TOWN OR POST OFFICE*

15. DISTANCE FROM PROPOSED*

LOCATION TO NEAREST

PROD. OR LEASE LINE, FT.

(Also include dir., unit line, if any)

810'

16. NO. OF ACRES IN LEASE

2665

17. NO. OF ACRES ASSIGNED

TO THIS WELL

160

18. LOCATION FROM PROPOSED LOCATION*

TO EXISTING WELL, DRILLING, COMPLETED,
OR PLUGGED, ON THIS LEASE, FT.

19. PROPOSED DEPTH

2950

20. ROTARY OR CABLE TOOLS

Rotary

21. ELEVATIONS (Show as DF, RT, GR, etc.)

6742' GR

22. APPROX. DATE WORK WILL START*

March 1, 1976

23.

PROPOSED CASING AND CEMENTING PROGRAM

SIZE OF HOLE	SIZE OF CASING	WEIGHT PER FOOT	SETTING DEPTH	QUANTITY OF CEMENT
12-1/4	8-5/8	24.0	100	75 sxs
7-7/8	4-1/2	9.50	2950	100 sxs

It is proposed to drill this well with rotary tools using drilling mud for circulation through the Pictured Cliffs Formation. All possible production intervals in the Pictured Cliffs will be completed.

The SW/4 of Section 4 is dedicated to this well.

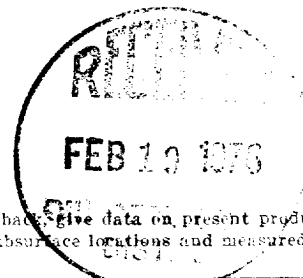

IN ABOVE SPACE DESCRIBE PROPOSED PROGRAM: If proposal is to deepen or plug back, give data on present productive zone and proposed new productive zone. If proposal is to drill or deepen directionally, give pertinent data on subsurface locations and measured and true vertical depths. Give blowout preventer program, if any.

24. For: Manning Gas and Oil Company President, Walsh Engineering

Well N. Walsh

TITLE & Production Corp.

DATE Feb. 17, 1976

(This space for Federal or State office use)

PERMIT NO.

APPROVAL DATE

APPROVED BY

TITLE

DATE

CONDITIONS OF APPROVAL, IF ANY:

OK

W

*See Instructions On Reverse Side

**NEW MEXICO OIL CONSERVATION COMMISSION
WELL LOCATION AND ACREAGE DEDICATION PLAT**

Form O-102
Supersedes C-128
Effective 1-1-65

All distances must be from the outer boundaries of the Section.

Operator MANNING GAS AND OIL COMPANY			Lease APACHE		Well No. 15
Unit Letter M	Section 4	Township 24 NORTH	Range 4 WEST	County RIO ARriba	
Actual Footage Location of Well: 1040 feet from the SOUTH line and 810 feet from the WEST line.					
Ground Level Elev. 6742	Producing Formation PICTURED CLIFFS		Pool So. Blanco Pictured Cliffs		Dedicated Acreage 160 Acres

1. Outline the acreage dedicated to the subject well by colored pencil or hachure marks on the plat below.
2. If more than one lease is dedicated to the well, outline each and identify the ownership thereof (both as to working interest and royalty).
3. If more than one lease of different ownership is dedicated to the well, have the interests of all owners been consolidated by communitization, unitization, force-pooling, etc?

☐ Yes ☐ No If answer is "yes," type of consolidation _____

If answer is "no," list the owners and tract descriptions which have actually been consolidated. (Use reverse side of this form if necessary.) _____

No allowable will be assigned to the well until all interests have been consolidated (by communitization, unitization, forced-pooling, or otherwise) or until a non-standard unit, eliminating such interests, has been approved by the Commission.

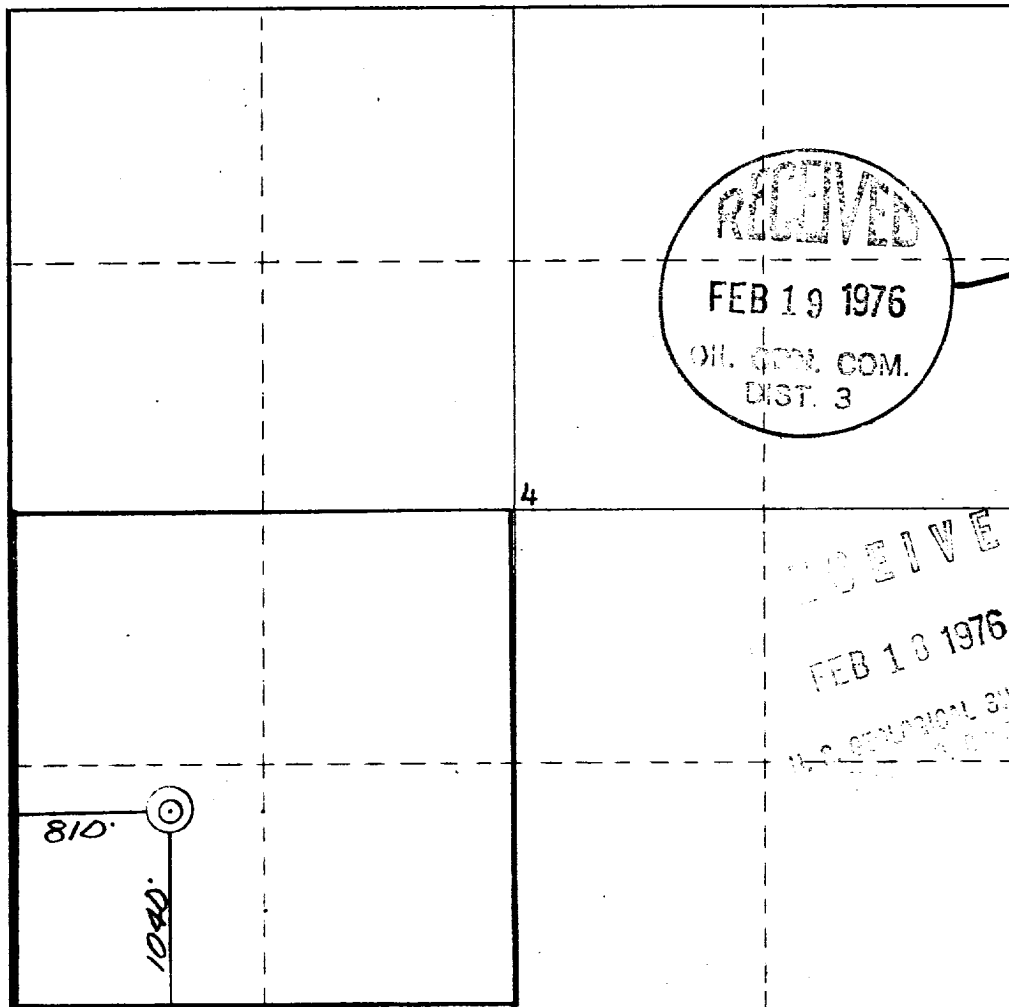

CERTIFICATION

I hereby certify that the information contained herein is true and complete to the best of my knowledge and belief.

For: Manning Gas & Oil Co.

Name _____
Position **Ewell N. Walsh, P.E.**

Company **President, Walsh Engr. & Prod. Corp.**

Date **February 17, 1976**

I hereby certify that the information shown on this plat was plotted from field notes of actual surveys made by me or under my supervision, and that the same is true and correct to the best of my knowledge and belief.

Date Surveyed **12 February 1976**

Registered Professional Engineer and/or Land Surveyor
James P. Leese

Certificate No. **1463**

