

UNITED STATES
DEPARTMENT OF THE INTERIOR
GEOLOGICAL SURVEY

SUBMIT IN TRIPLICATE*
(Other instructions on re-
verse side)

Form approved.
Budget Bureau No. 42-R1424.

5. LEASE DESIGNATION AND SERIAL NO.

SF-080472-B

6. IF INDIAN, ALLOTTEE OR TRIBE NAME

- - -

7. UNIT AGREEMENT NAME

- - -

8. FARM OR LEASE NAME

Tonkin

9. WELL NO.

4

10. FIELD AND POOL, OR WILDCAT

West Lindrith Gallup-Dakota

11. SEC., T., R., M., OR BLK. AND
SURVEY OR AREA

17-24N-3W

12. COUNTY OR PARISH

Rio Arriba

13. STATE

New Mexico

SUNDRY NOTICES AND REPORTS ON WELLS
(Do not use this form for proposals to drill or to deepen or plug back to a different reservoir.
Use "APPLICATION FOR PERMIT—" for such proposals.)

1. OIL ☐ WELL GAS ☒ WELL OTHER

2. NAME OF OPERATOR

Atlantic Richfield Company

3. ADDRESS OF OPERATOR

Suite 501, 1860 Lincoln Street, Denver, Colorado

4. LOCATION OF WELL (Report location clearly and in accordance with any State requirements.*
See also space 17 below.)
At surface

(SW NE) (UNIT E) 1700' FNL & 800' FWL Section 17

14. PERMIT NO.

Not Issued

15. ELEVATIONS (Show whether DF, RT, GR, etc.)

Not Available

16. Check Appropriate Box To Indicate Nature of Notice, Report, or Other Data

NOTICE OF INTENTION TO:

TEST WATER SHUT-OFF

PULL OR ALTER CASING

FRACTURE TREAT

MULTIPLE COMPLETE

SHOOT OR ACIDIZE

ABANDON*

REPAIR WELL

CHANGE PLANS

(Other)

Change Location

XX

SUBSEQUENT REPORT OF:

WATER SHUT-OFF

FRACTURE TREATMENT

SHOOTING OR ACIDIZING

(Other)

REPAIRING WELL

ALTERING CASING

ABANDONMENT*

(NOTE: Report results of multiple completion on Well
Completion or Recompletion Report and Log form.)

17. DESCRIBE PROPOSED OR COMPLETED OPERATIONS (Clearly state all pertinent details, and give pertinent dates, including estimated date of starting any proposed work. If well is directionally drilled, give subsurface locations and measured and true vertical depths for all markers and zones pertinent to this work.)*

Changed Location to comply with New Mexico Spacing Regulations.



18. I hereby certify that the foregoing is true and correct

SIGNED

W. A. Walker, Jr.

TITLE Operations Manager

DATE November 2, 1978

(This space for Federal or State office use)

APPROVED BY

TITLE

DATE

CONDITIONS OF APPROVAL, IF ANY:

NOV 3 1978

NEW MEXICO OIL CONSERVATION COMMISSION
WELL LOCATION AND ACREAGE DEDICATION PLAT

Form C-102
Supersedes C-128
Effective 1-1-55

All distances must be from the outer boundaries of the Section.

Operator THE ATLANTIC RICHFIELD COMPANY			Lease TONKIN		Well No. 4
Unit Letter E	Section 17	Township 24 NORTH	Range 3 WEST	County RIC ARriba	
Actual Footage Location of Well: 1700 feet from the NORTH line and 800 feet from the WEST line					
Ground Level Elev.	Producing Formation Dakota		Pool West Lindrith Gallup	Dedicated Acreage: 160 Acres	

1. Outline the acreage dedicated to the subject well by colored pencil or hachure marks on the plat below.
2. If more than one lease is dedicated to the well, outline each and identify the ownership thereof (both as to working interest and royalty).
3. If more than one lease of different ownership is dedicated to the well, have the interests of all owners been consolidated by communitization, unitization, force-pooling, etc? **N/A 100% Atlantic Richfield Company**

☐ Yes ☐ No If answer is "yes," type of consolidation _____

If answer is "no," list the owners and tract descriptions which have actually been consolidated. (Use reverse side of this form if necessary.) _____

No allowable will be assigned to the well until all interests have been consolidated (by communitization, unitization, forced-pooling, or otherwise) or until a non-standard unit, eliminating such interests, has been approved by the Commission.

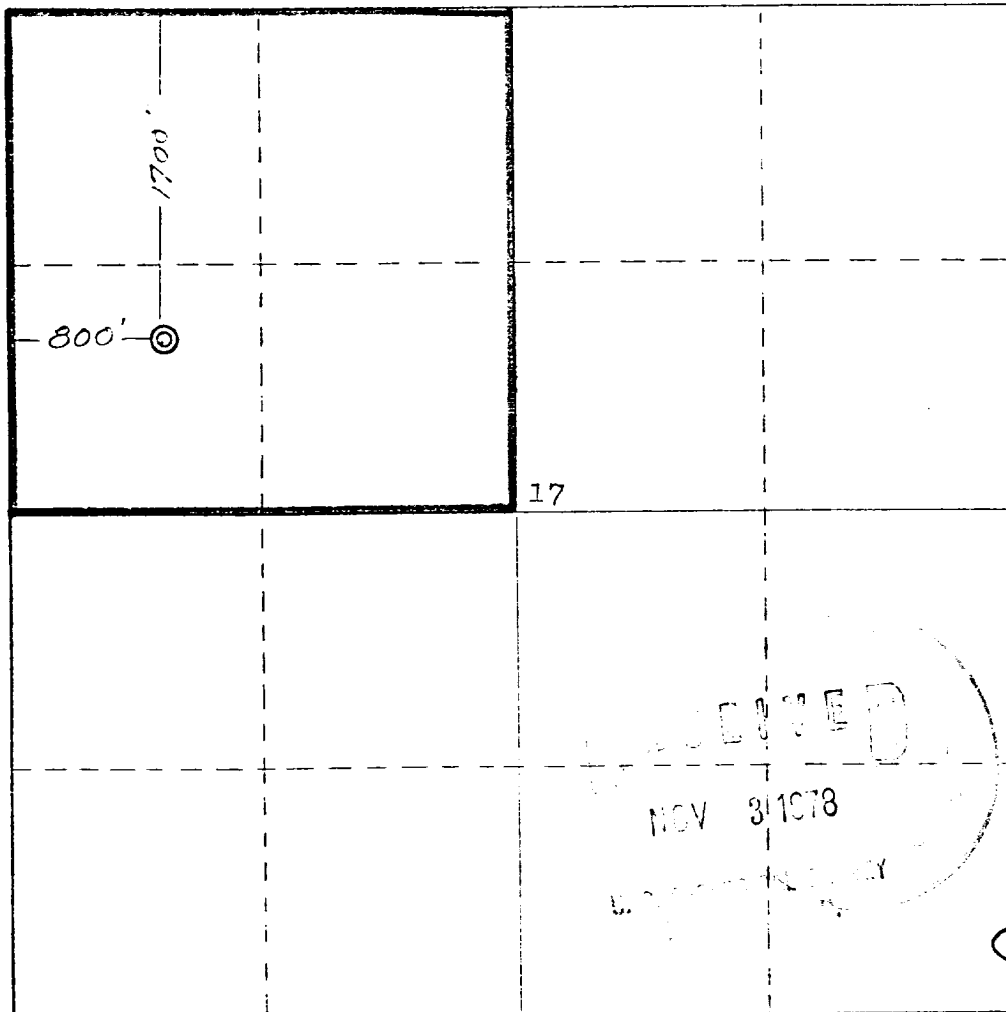

CERTIFICATION

I hereby certify that the information contained herein is true and complete to the best of my knowledge and belief.

W. A. Walther Jr.
Name
W. A. Walther, Jr.

Position
Operations Manager

Company
Atlantic Richfield Company

Date
November 2, 1978

I hereby certify that the well location shown on this plat was plotted from field notes of actual surveys made by me or under my supervision, and that the same is true and correct to the best of my knowledge and belief.

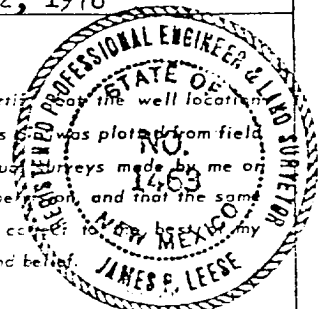

Date Surveyed
1 November 1978

Registered Professional Engineer
and
Land Surveyor
James P. Leese
James P. Leese

Certificate No.
1463

2640 2000 1500 1000 500 0