

UNITED STATES  
DEPARTMENT OF THE INTERIOR  
GEOLOGICAL SURVEY

## APPLICATION FOR PERMIT TO DRILL, DEEPEN, OR PLUG BACK

## 1a. TYPE OF WORK

DRILL ☒DEEPEN ☐PLUG BACK ☐

## b. TYPE OF WELL

OIL  
WELL ☒GAS  
WELL ☐OTHER ☐SINGLE  
ZONE ☒MULTIPLE  
ZONE ☐

## 2. NAME OF OPERATOR

Mobil Oil Corporation

## 3. ADDRESS OF OPERATOR

Nine Greenway Plaza, Suite 2700; Houston, Texas 77046

## 4. LOCATION OF WELL (Report location clearly and in accordance with any State requirements.\*)

At Surface

790' FSL and 1065' FWL, Sec. 21, T24N, R3W

At proposed prod. zone

Same as surface

## 14. DISTANCE IN MILES AND DIRECTION FROM NEAREST TOWN OR POST OFFICE\*

50 miles Southeast of Farmington

## 15. DISTANCE FROM PROPOSED\*

LOCATION TO NEAREST  
PROPERTY OR LEASE LINE, FT.  
(Also to nearest drlg. unit line, if any)

1065'

## 18. DISTANCE FROM PROPOSED LOCATION\*

TO NEAREST WELL, DRILLING, COMPLETED,  
OR APPLIED FOR, ON THIS LEASE, FT.

1603' South

## 16. NO. OF ACRES IN LEASE

26,365.43

## 19. PROPOSED DEPTH

8200'

17. NO. OF ACRES ASSIGNED  
TO THIS WELL

160

## 20. ROTARY OR CABLE TOOLS

Rotary

## 22. APPROX. DATE WORK WILL START\*

February 1, 1980

## 21. ELEVATIONS (Show whether DF, RT, GR, etc.)

6927' - Ground

## 23. PROPOSED CASING AND CEMENTING PROGRAM

SIZE OF HOLE	SIZE OF CASING	WEIGHT PER FOOT	SETTING DEPTH	QUANTITY OF CEMENT	
				1. Circulate to Surface	2. Circulate to Surface
17-1/2"	13-3/8"	48# H-40	0- 300'	3. Circulate to Surface	
12-1/2"	8-5/8"	24# K-55	0-2500'		
	8-5/8"	32# H-40	2500-3900'		
7-7/8"	5-1/2"	15.5# K-55	0-7500'		
	5-1/2"	17# K-55	7500-8200'		

## Cementing Program

- 1) Class A with 2% CaCl<sub>2</sub>  
3) Class H

(2) Class A with 6% gel tailed in with Neat cement

## Mud Program

Depth	Type of Mud	Weight	Viscosity	pH	Water Loss
0-300'	Spud Mud	10.0#	---	---	---
300-8100'	Fresh Water Gel	9.0#	40	---	---

## Blowout Preventer Program

See Attachment

IN ABOVE SPACE DESCRIBE PROPOSED PROGRAM: If proposal is to deepen or plug back, give data on present productive zone and proposed new productive zone. If proposal is to drill or deepen directionally, give pertinent data on subsurface locations and measured and true vertical depths. Give blowout preventer program, if any.

24.

SIGNED

A. D. Bond

TITLE Regulatory Engineering

DATE 12/11/79

(This space for Federal or State office use)

Coordinator II

PERMIT NO.

APPROVAL DATE

APPROVED BY

TITLE

DATE

CONDITIONS OF APPROVAL, IF ANY:

DEC 17 1979

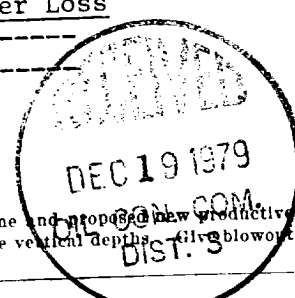

**NEW MEXICO OIL CONSERVATION COMMISSION  
WELL LOCATION AND ACREAGE DEDICATION PLAT**

Form C-102  
Supersedes C-128  
Effective 1-1-65

All distances must be from the outer boundaries of the Section.

Operator <b>Mobil Oil Corporation</b>			Lease <b>Lindrith B Unit</b>		Well No. <b>3</b>
Unit Letter <b>M</b>	Section <b>21</b>	Township <b>24N</b>	Range <b>3W</b>	County <b>Rio Arriba</b>	
Actual Forage Location of Well: <b>790</b> feet from the <b>South</b> line and <b>1065</b> feet from the <b>West</b> line					
Ground Level Elev. <b>6927'</b>	Producing Formation <b>Dakota</b>		Pool <b>Chacon-Dakota Associated</b>		Dedicated Acreage: <b>160</b> Acres

1. Outline the acreage dedicated to the subject well by colored pencil or hachure marks on the plat below.
2. If more than one lease is dedicated to the well, outline each and identify the ownership thereof (both as to working interest and royalty).
3. If more than one lease of different ownership is dedicated to the well, have the interests of all owners been consolidated by communitization, unitization, force-pooling, etc?

☒ Yes    ☐ No    If answer is "yes," type of consolidation Unitization

If answer is "no," list the owners and tract descriptions which have actually been consolidated. (Use reverse side of this form if necessary.) \_\_\_\_\_

No allowable will be assigned to the well until all interests have been consolidated (by communitization, unitization, forced-pooling, or otherwise) or until a non-standard unit, eliminating such interests, has been approved by the Commission.

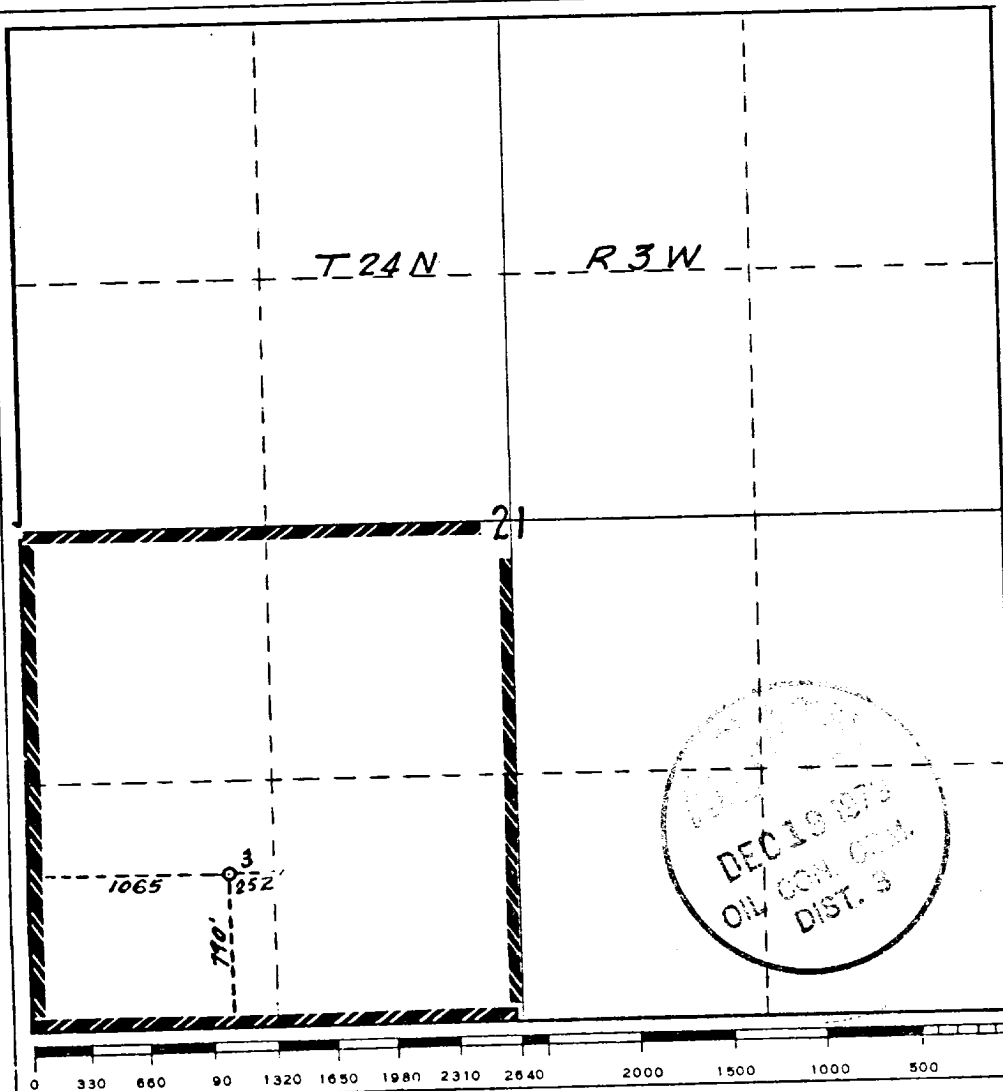

**CERTIFICATION**

I hereby certify that the information contained herein is true and complete to the best of my knowledge and belief.

*A. D. Bond*

Name

**A. D. Bond**

Position

**Regulatory  
Engineering Coordinator II**

Company

**Mobil Oil Corporation**

Date

**December 11, 1979**

I hereby certify that the well location shown on this plat was plotted from field notes of actual surveys made by me or under my supervision and that the same is true and correct to the best of my knowledge and belief.

*H. A. Carson, Jr.*

Date Surveyed

**November 14, 1979**

Registered Professional Engineer  
and/or Land Surveyor

**H. A. Carson, Jr.**

Certificate No.

**5063**

