

UNITED STATES  
DEPARTMENT OF THE INTERIOR  
GEOLOGICAL SURVEY

APPLICATION FOR PERMIT TO DRILL, DEEPEN, OR PLUG BACK

1a. TYPE OF WORK

DRILL ☒

DEEPEN ☐

PLUG BACK ☐

b. TYPE OF WELL

OIL  
WELL ☐

GAS  
WELL ☒

OTHER

SINGLE  
ZONE ☒

MULTIPLE  
ZONE ☐

2. NAME OF OPERATOR

Supron Energy Corporation

3. ADDRESS OF OPERATOR

P.O. Box 808, Farmington, New Mexico 87401

4. LOCATION OF WELL (Report location clearly and in accordance with any State requirements\*)

At surface

1775 Ft./South and 1685 Ft./West line

At proposed prod. zone

Same as above

14. DISTANCE IN MILES AND DIRECTION FROM NEAREST TOWN OR POST OFFICE\*

4 Miles North East of Ojito, New Mexico

U. S. GEOLOGICAL SURVEY  
FARMINGTON, N. M.

15. DISTANCE FROM PROPOSED\*

865 Ft.

16. NO. OF ACRES IN LEASE

120.00

17. NO. OF ACRES ASSIGNED  
TO THIS WELL

S 1/2 355.52

18. DISTANCE FROM PROPOSED LOCATION\*  
TO NEAREST WELL, DRILLING, COMPLETED,  
OR APPLIED FOR, ON THIS LEASE, FT.

165 Ft.

19. PROPOSED DEPTH

6300

20. ROTARY OR CABLE TOOLS

Rotary

21. ELEVATIONS (Show whether DF, RT, GR, etc.)

7234 GR

22. APPROX. DATE WORK WILL START\*

1 December 1980

23. PROPOSED CASING AND CEMENTING PROGRAM

SIZE OF HOLE	SIZE OF CASING	WEIGHT PER FOOT	SETTING DEPTH	QUANTITY OF CEMENT
12-1/4"	8-5/8"	24.0	150	200 Sacks
7-7/8"	4-1/2"	10.5	6300	625 Sacks

We desire to drill 12-1/4" surface hole to T.D. of  $\pm$  250 ft. and run new 8-5/8", 24.00# surface casing. Cement surface casing w/class "B" cement and circulate cement to the surface. Drill out w/7-7/8" bit using mud as the circulating medium to T.D. of  $\pm$  6300 ft. Run new 4-1/2" casing and cement in stages as follows: 1st stage 375 sx of 50-50 poz mix, 2nd stage cement w/150 sx of Howco lite followed by 100 sx of class "B" cement with the D.V. tool set at approx. 4050 ft. Perforate the casing in the Mesaverde zone, fracture to stimulate production and clean well up. Run tbg. to the production zone. Nipple down the well head. Test well and connect to a pipeline system.

IN ABOVE SPACE DESCRIBE PROPOSED PROGRAM: If proposal is to deepen or plug back, give data on present productive zone and proposed new productive zone. If proposal is to drill or deepen directionally, give pertinent data on subsurface locations and measured and true vertical depths. Give blowout preventer program, if any.

24.

SIGNED

Rudy D. Motto

TITLE Area Superintendent

DATE October 14, 1980

(This space for Federal or State office use)

PERMIT NO.

APPROVAL DATE

APPROVED BY

CONDITIONS OF APPROVAL

TITLE

DATE

DISTRICT ENGINEER

ok 3-1

# WELL LOCATION AND ACREAGE DEDICATION PLAT

Supercedes C-128  
Effective 1-1-85

All distances must be from the outer boundaries of the Section.

Owner <b>SUPRON ENERGY CORPORATION</b>			Lease <b>MCCRODEN "B"</b>		Well No. <b>-3</b>
Unit Letter <b>K</b>	Section <b>4</b>	Township <b>25 NORTH</b>	Range <b>3 WEST</b>	County <b>RIO ARriba</b>	
Actual Footage Location of Well:					
<b>1775</b>	feet from the	<b>SOUTH</b>	line and	<b>1685</b>	feet from the
					<b>WEST</b>
Ground Level Elev. <b>7234</b>	Producing Formation <b>MESAVERDE</b>		Pool <b>BLANCO</b>	Dedicated Acreage: <b>5 1/2 - 320.00</b> Acres	

1. Outline the acreage dedicated to the subject well by colored pencil or hatchure marks on the plat below.
2. If more than one lease is dedicated to the well, outline each and identify the ownership thereof (both as to working interest and royalty).
3. If more than one lease of different ownership is dedicated to the well, have the interests of all owners been consolidated by communitization, unitization, force-pooling, etc?

☐ Yes ☐ No If answer is "yes," type of consolidation \_\_\_\_\_

If answer is "no," list the owners and tract descriptions which have actually been consolidated. (Use reverse side of this form if necessary.) \_\_\_\_\_

No allowable will be assigned to the well until all interests have been consolidated (by communitization, unitization, forced-pooling, or otherwise) or until a non-standard unit, eliminating such interests, has been approved by the Commission.

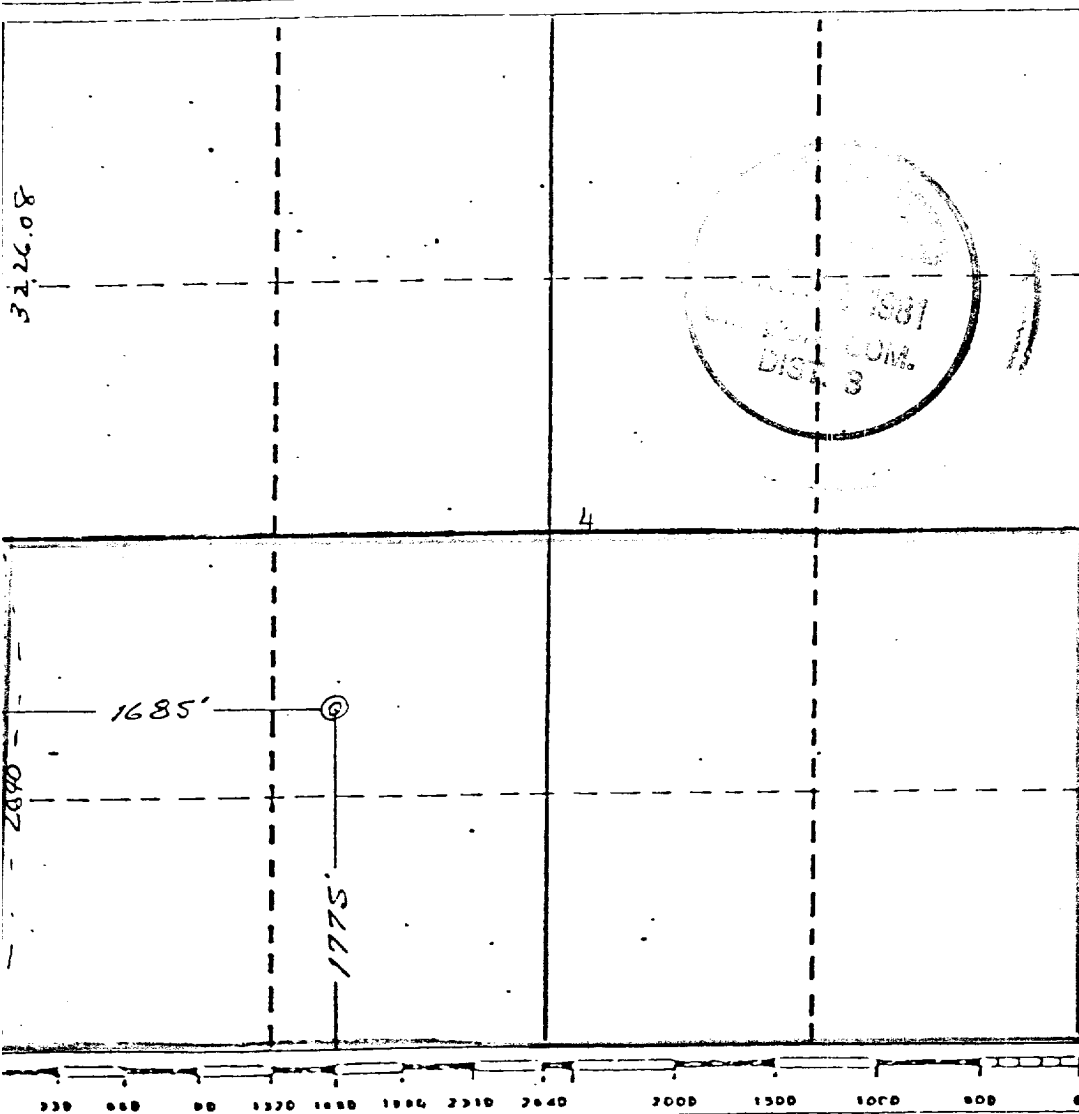
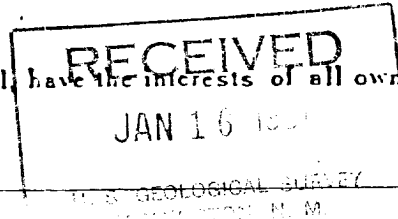

## CERTIFICATION

I hereby certify that the information contained herein is true and complete to the best of my knowledge and belief.

*Rudy D. Motto*  
Name

Rudy D. Motto

Position

Area Superintendent

Company

Supron Energy Corporation

Date

January 15, 1981

I hereby certify that the information shown on this plat was plotted from field notes of actual surveys made by me or under my supervision, and that the same is true and correct to the best of my knowledge and belief.

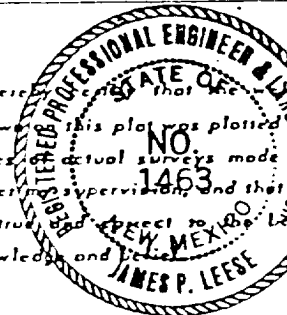

Date Surveyed

August 28, 1980

Registered Professional Engineer and/or Land Surveyor

*James P. Leese*  
James P. Leese

Certificate No.

- 1463

NMOC

SUPRON ENERGY CORPORATION

POST OFFICE BOX 808

FARMINGTON, NEW MEXICO 87401

October 14, 1980

United States Geological Survey  
P.O. Box 959  
Farmington, New Mexico 87401

Attention: Mr. James Sims

Dear Sir:

Supron Energy Corporation proposes to drill the McCroden "B" No. 3 well located 1775 feet from the South line and 1685 feet from the West line of Section 4, Township 25 North, Range 3 West, N.M.P.M., Rio Arriba County, New Mexico.

The following attachments are included with this application:

1. Map of existing roads.
2. No access road is needed.
3. Location of existing wells.
4. Lateral roads to well locations.
5. Location of surface equipment if required.
6. Drilling and completion water will be obtained from our water well in Wild Horse Canyon.
7. Waste will be disposed of by being placed in the reserve pit and buried upon completion of the well.
8. There will be no camp at or near the well site.
9. There will be no air strip.
10. A plat is attached showing the location of the rig, mud tanks, reserve pit, burn pit and etc.
11. A letter of certification is attached. The operator representative, for compliance purposes, is Rudy D. Motto, Area Superintendent, P.O. Box 808, Farmington, New Mexico. Phone (505) 325-3587.
12. After the well is completed the location will be cleaned up and bladed. The reserve pit will be allowed to dry then it will be filled and restored to its natural state.
13. The soil is sandy loam with the principal vegetation being sage juniper, greasewood, broom snakeweed, alkali sacaton, indian ricegrass, grama, prickley pear cactus, saltbush, narrow leaf yucca and ephedra.



Supron Energy Corporation  
McCroden B-3  
SW $\frac{1}{4}$  Sec. 4, T25N, R3W, N.M.P.M.  
Rio Arriba County, N.M.

4035  
T. 26 N.  
IOJITO 4556 1 NE  
4034  
T. 25 N.  
4033  
OJITO 2.4 MI  
25'  
4032  
4031  
4030  
4029

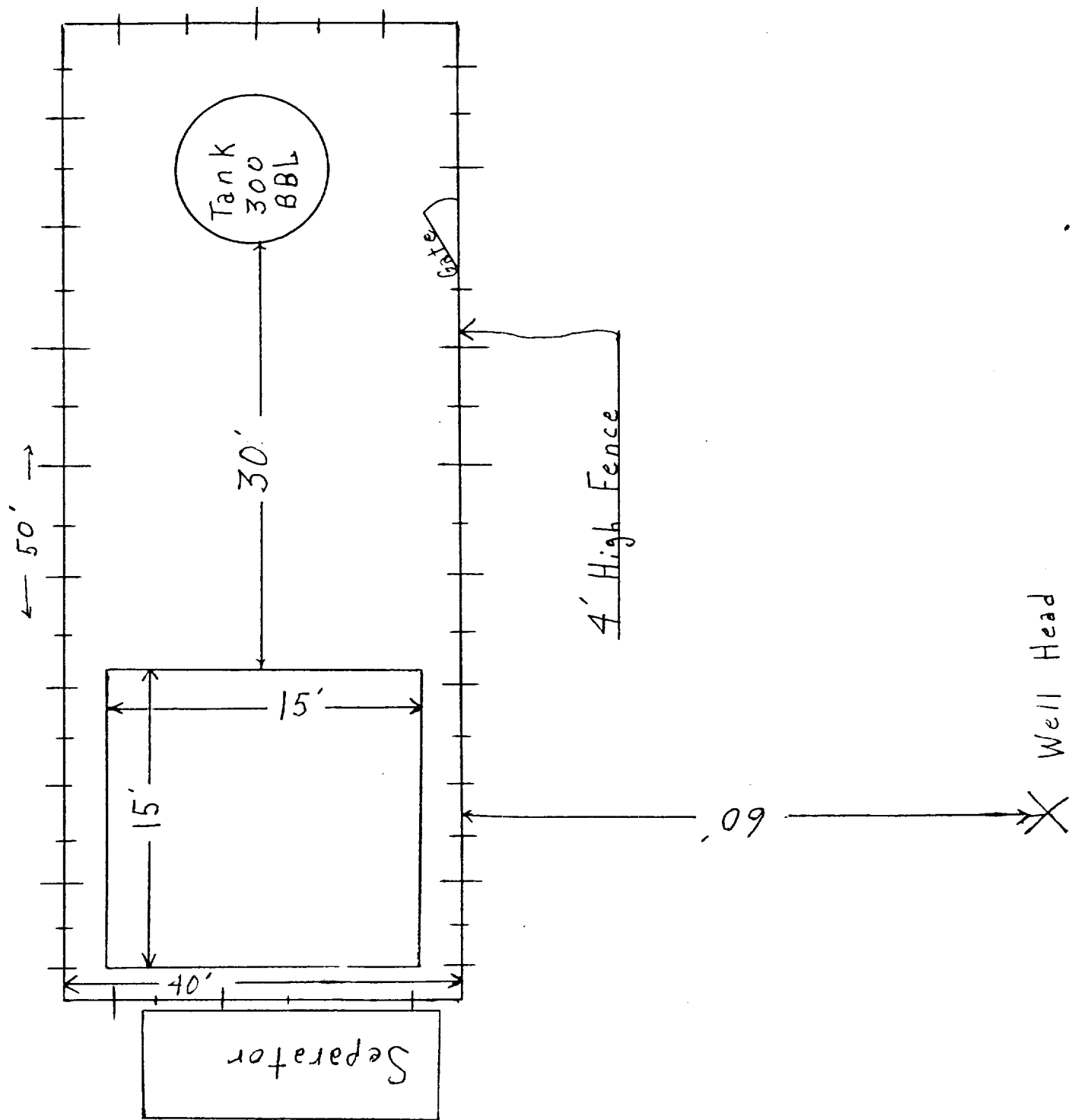

Blowout Preventer will be tested daily and prior to drilling out with the results to be logged on the drillers report.

The B.O.P. and all valve and fittings are rated at 3000 psi working pressure, and hydraulically operated

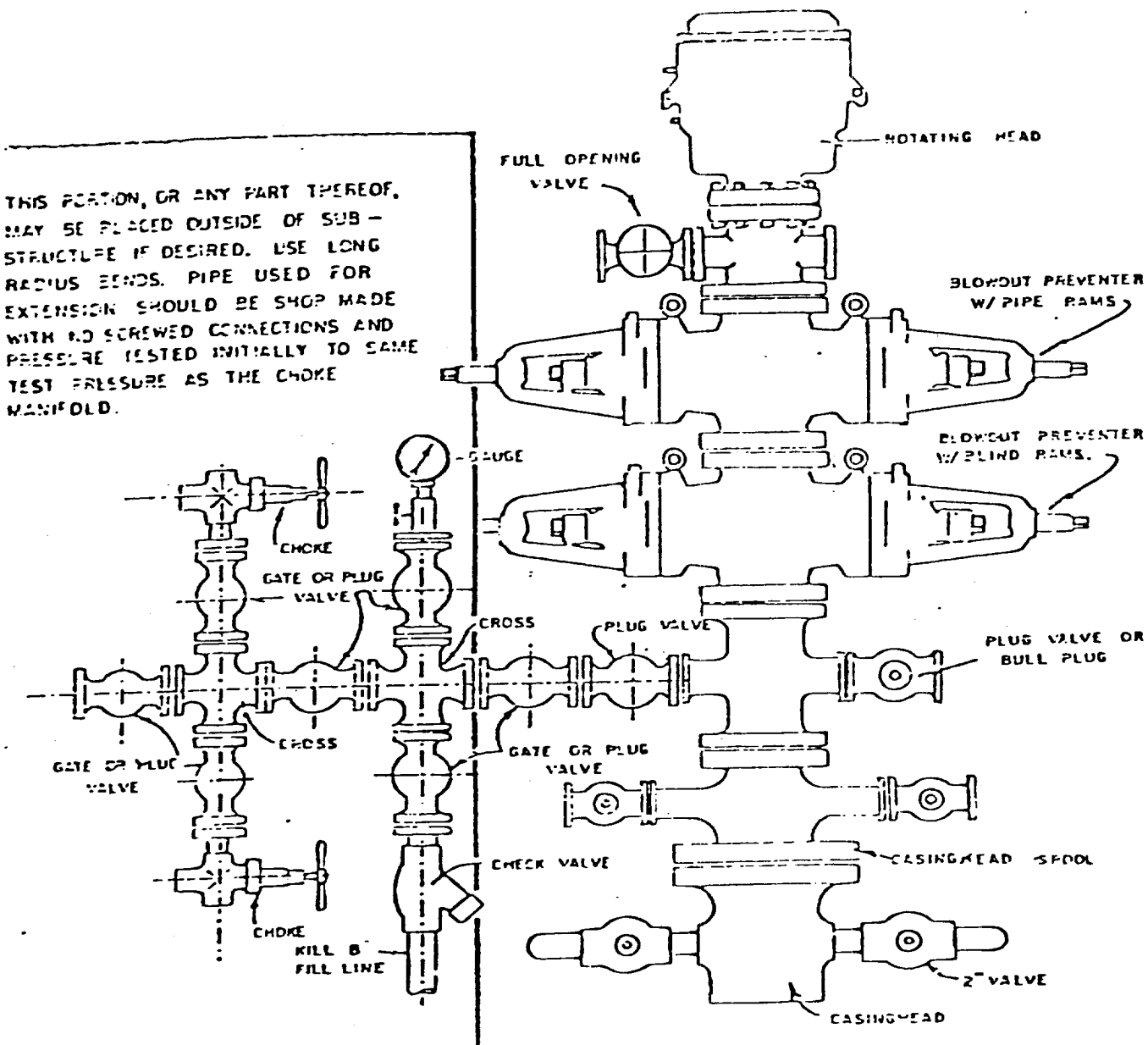

BLOWOUT PREVENTER HOOKUP

LOCATION AND EQUIPMENT LAYOUT

SUPRON ENERGY CORPORATION

MC CRODEN "B" NO. 3

Sec. 4, Twp. 25-N, Rge. 3-W  
Rio Arriba County, New Mexico

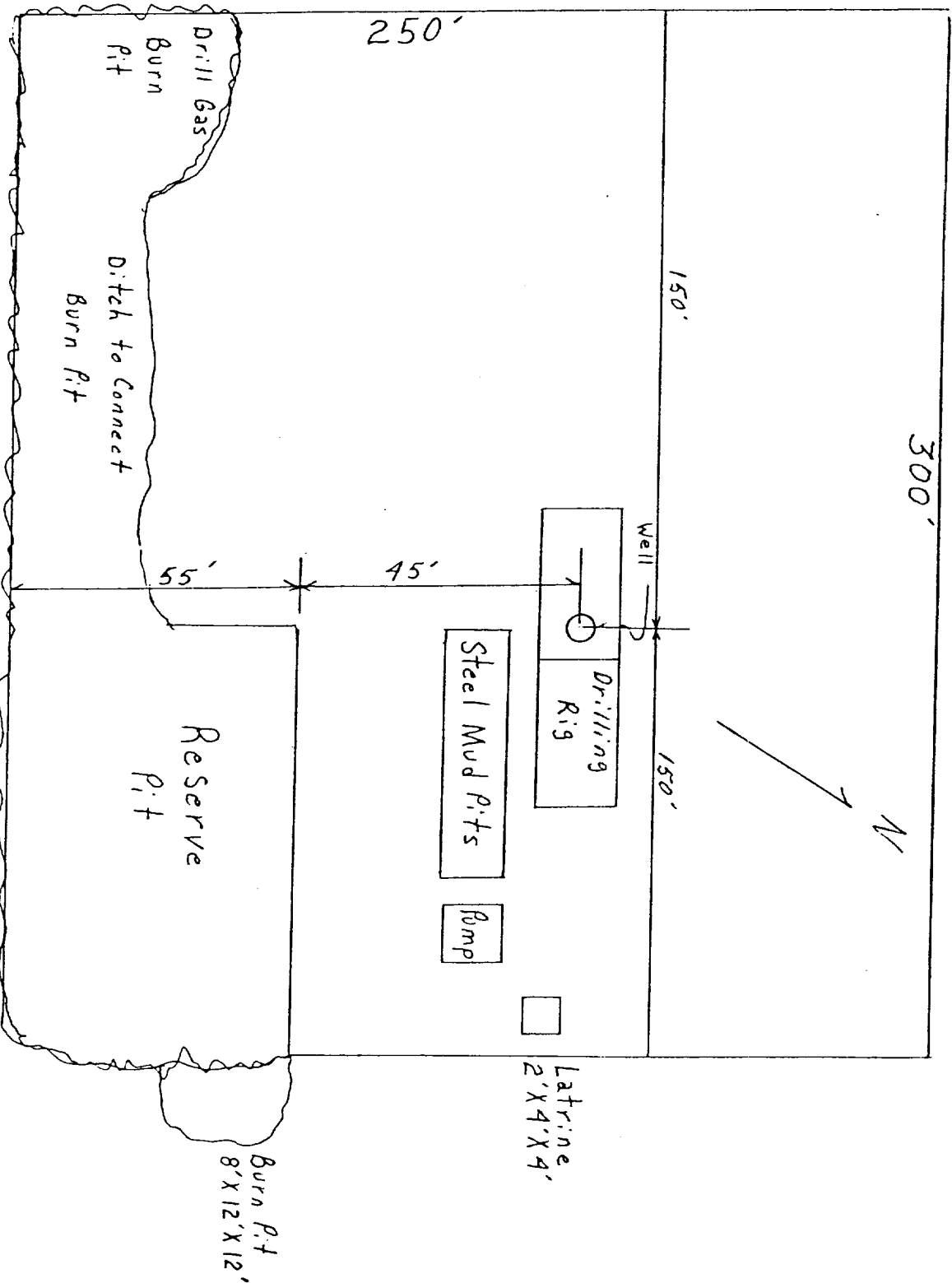

SUPRON ENERGY CORPORATION  
Post Office Box 808  
FARMINGTON, NEW MEXICO 87401

I hereby certify that I, or persons under my direct supervision, have inspected the proposed drillsite and access route; that I am familiar with the conditions which presently exist; that the statements made in this plan are, to the best of my knowledge, true and correct; and, that the work associated with the operations proposed herein will be performed by SUPRON ENERGY CORPORATION and its contractors subcontractors in conformity with this plan and the terms and conditions under which it is approved.

SUPRON ENERGY CORPORATION

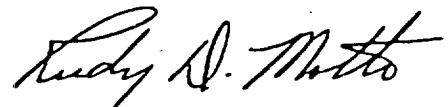
A handwritten signature in cursive script, reading "Rudy D. Motto".

Rudy D. Motto  
Area Superintendent  
Phone: 325-3587



SUPRON ENERGY CORPORATION

McCroden "B" No. 3  
SW ¼ Section 4, T-25N, R-3W, N.M.P.M.  
Rio Arriba County, New Mexico

1. The Geologic name of the surface formation is "Wasatch".
2. The estimated tops of important Geologic markers are:
  - A. Top of the Ojo Alamo - - - - - - - - - -3585'
  - B. Top of the Fruitland - - - - - - - - - -3808'
  - C. Top of the Pictured Cliffs - - - - - - - -3900'
  - D. Top of the Cliff House - - - - - - - - -5572'
  - E. Top of the Point Lookout - - - - - - - -6036'
3. The estimated depth at which anticipated water, oil or other mineral bearing formations are expected to be encountered are:
  - A. Top of the Ojo Alamo - - - - - - - - -3585' Water
  - B. Top of the Fruitland - - - - - - - - -3808' Water
  - C. Top of the Pictured Cliffs - - - - - - - -3900' Gas
  - D. Top of the Cliff House - - - - - - - - -5572' Gas
  - E. Top of the Point Lookout - - - - - - - -6036' Gas
4. The casing program is shown on 9-331C and all casing is new.
5. The lessee's pressure control equipment schematics are attached along with minimum specifications, testing procedures and frequencies.
6. The type, estimated volumes and characteristics of the circulating medium are as follows:
  - A. 0 to 250 feet Natural mud
  - B. 200 to 6036 feet Permaloid non dispersed mud containing approximately 67 sx. of Permaloid and 10 sx. of C.M.C.
7. The auxiliary equipment will be floats at the bit and a sub on the floor with a full opening valve to be stabbed into the drill pipe when the kelly is not in the string.
8. This well is in an area which is heavily developed; therefore we will not have a testing or coring program. The logging program is as follows:
  - A. E.S. Induction
  - B. Gamma Ray Density
  - C. Gamma Ray Correlation
  - D. Cement Bond or Temperature
9. We do not expect to find any abnormal pressures, temperatures or hydrogen sulfide problems in this heavily developed area.
10. The anticipated starting date for this well is December 15, 1980.