

UNITED STATES  
DEPARTMENT OF THE INTERIOR  
GEOLOGICAL SURVEY

## APPLICATION FOR PERMIT TO DRILL, DEEPEN, OR PLUG BACK

## 1a. TYPE OF WORK

DRILL ☒DEEPEN ☐PLUG BACK ☐

## b. TYPE OF WELL

OIL  
WELL ☐GAS  
WELL ☒

OTHER

SINGLE  
ZONE ☐MULTIPLE  
ZONE ☒

## 2. NAME OF OPERATOR

Upcon Energy Corporation

## 3. ADDRESS OF OPERATOR

P.O. Box 808, Farmington, New Mexico 87401

## 4. LOCATION OF WELL (Report location clearly and in accordance with any State requirements.)

At surface

790 Ft./South; 1850 Ft./West line

At proposed prod. zone Same as above

## 14. DISTANCE IN MILES AND DIRECTION FROM NEAREST TOWN OR POST OFFICE\*

20 Miles Northwest of Ojito, New Mexico

## 15. DISTANCE FROM PROPOSED\*

LOCATION TO NEAREST  
PROPERTY OR LEASE LINE, FT.  
(Also to nearest drlg. unit line, if any)

990 Ft.

990 Ft.

## 18. DISTANCE FROM PROPOSED LOCATION\*

TO NEAREST WELL, DRILLING, COMPLETED,  
OR APPLIED FOR, ON THIS LEASE, FT.

3220 Ft.

## 16. NO. OF ACRES IN LEASE

2560

## 19. PROPOSED DEPTH

7759

17. NO. OF ACRES ASSIGNED  
TO THIS WELL

320 (West Half) W 326.11

## 20. ROTARY OR CABLE TOOLS

Rotary

## 21. ELEVATIONS (Show whether DF, RT, GR, etc.)

6695 GR.

## 22. APPROX. DATE WORK WILL START\*

June 1, 1982

## 23.

## PROPOSED CASING AND CEMENTING PROGRAM

SIZE OF HOLE	SIZE OF CASING	WEIGHT PER FOOT	SETTING DEPTH	QUANTITY OF CEMENT
13-3/4"	10-3/4"	32.75#	250	200 sx. circulate
9-7/8"	7-5/8"	26.40#	3700	400 sx (Over Ojo Alamo)
6-3/4"	5-1/2"	15.50#	7759	425 sx.

We propose to drill a 13-3/4" surface hole to about 250 ft. and run 10-3/4", 32.75#, H-40 casing and cement with enough to circulate to the surface. This should be about 200 sacks. Pressure casing to 1000 P.S.I. We will then drill a 9-7/8" hole with starch - base mud to intermediate total depth of 3700 ft. We will run 7-5/8", 26.40#, K-55 casing and set at 3700 ft. and cement with about 300 sacks of 65-35-6 and 100 sacks of class "B". We then will drill a 6-3/4" hole with gas to total depth of 7759 ft. We will run 5-1/2", 15.50#, K-55 casing as a liner. Top of liner will be about 3550 ft. and bottom of the liner will be at 7759 ft. We will cement the liner with about 425 sacks of 50-50 pozmix. Perforate and fracture Dakota and set bridge plug between zones. Perforate and fracture Mesaverde zone. Remove bridge plug and clean up both zones. Run 2-1/16" tubing to the Dakota zone with a packer between the zones. Run an additional string of tubing to the Mesaverde zone. Run Packer-Leakage Test and hook up to a gas gathering system.

The gas from both these zones have been previously dedicated to a gas transporter.

IN ABOVE SPACE DESCRIBE PROPOSED PROGRAM: If proposal is to deepen or plug back, give data on present productive zone and proposed new productive zone. If proposal is to drill or deepen directionally, give pertinent data on subsurface locations and measured and true vertical depths. Give blowout preventer program, if any.

## 24.

SIGNED

Kenneth E. Roddy

TITLE

Production Superintendent

DATE 4-26-82

(This space for Federal or State office use)

PERMIT NO.

APPROVED BY

CONDITIONS OF APPROVAL, IF ANY:

TITLE

MAY 10 1982

OIL CON. COM.

DIST. 3

MCC

APPROVED  
AS AMENDED

MAY 6 1982

JAMES F. SIMS  
DISTRICT ENGINEER

## WELL LOCATION AND ACREAGE DEDICATION PLAT

Form C-104  
Supercedes C-14  
Effective 1-1-82

All distances must be from the outer boundaries of the Section.

Operator <b>SUPRON ENERGY CORPORATION</b>			Lease <b>JICARILLA "H"</b>		Well No. <b>11E</b>
Unit Letter <b>N</b>	Section <b>18</b>	Township <b>26 NORTH</b>	Range <b>4 WEST</b>	County <b>RIO ARriba</b>	
Actual Footage Location of Well: <b>790</b> feet from the <b>SOUTH</b> line and <b>1850</b> feet from the <b>WEST</b> line					
Ground Level Elev. <b>6695</b>	Producing Formation <b>DAKOTA</b> <b>MESAVERDE</b>		Pool <b>BASIN</b> <b>BLANCO</b>		Dedicated Acreage: <b>W/2 320.00</b>

1. Outline the acreage dedicated to the subject well by colored pencil or hatchure marks on the plat below.
2. If more than one lease is dedicated to the well, outline each and identify the ownership thereof (both as to working interest and royalty).
3. If more than one lease of different ownership is dedicated to the well, have the interests of all owners been consolidated by communitization, unitization, force-pooling, etc?

☐ Yes ☐ No If answer is "yes," type of consolidation \_\_\_\_\_

If answer is "no," list the owners and tract descriptions which have actually been consolidated. (Use reverse side of this form if necessary.) \_\_\_\_\_

No allowable will be assigned to the well until all interests have been consolidated (by communitization, unitization, forced-pooling, or otherwise) or until a non-standard unit, eliminating such interests, has been approved by the Commission.

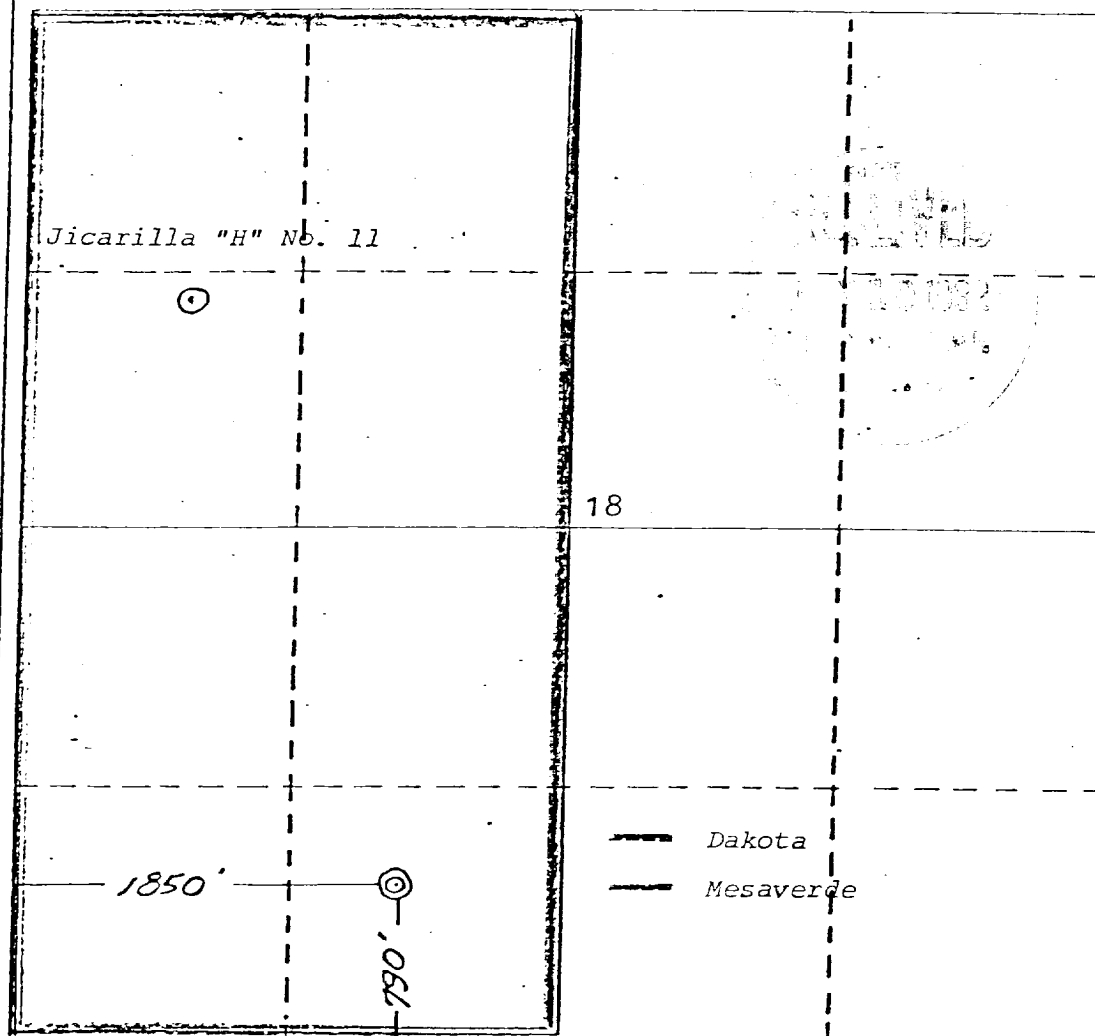

## CERTIFICATION

I hereby certify that the information contained herein is true and complete to the best of my knowledge and belief.

*Rudy D. Motto*  
Name

Rudy D. Motto

Position

Area Superintendent

Company

Supron Energy Corporation

Date

March 25, 1982

I hereby certify that the well location shown on this plat is based on field notes of actual surveys made by me or under my supervision, and that the same is true and correct to the best of my knowledge and belief.

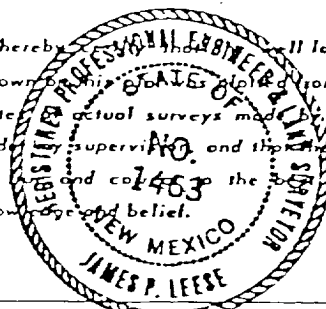

Date Surveyed

March 23, 1982

Registered Professional Engineer  
and/or Land Surveyor

*James P. Leese*  
James P. Leese

Certificate No.

1463