

5 NMOC, 1 McHugh, 1 Kenai, 1 File, 1 Northwest Exploration

STATE OF NEW MEXICO

ENERGY AND MINERALS DEPARTMENT

OIL CONSERVATION DIVISION

P. O. BOX 2088

SANTA FE, NEW MEXICO 87501

Form C-101

Revised 10-1-78

30-039-2313

NO. OF COPIES RECEIVED	
DISTRIBUTION	
SANTA FE	
FILE	
U.S.G.S.	
LAND OFFICE	
OPERATOR	

5A. Indicate Type of Lease

STATE ☐FEE ☒

5. State Oil &amp; Gas Lease No.

## APPLICATION FOR PERMIT TO DRILL, DEEPEN, OR PLUG BACK

1a. Type of Work		7. Unit Agreement Name	
b. Type of Well OIL WELL <input type="checkbox"/> GAS WELL <input checked="" type="checkbox"/> OTHER <input type="checkbox"/>		8. Farm or Lease Name E. T.	
2. Name of Operator Jerome P. McHugh		9. Well No. 1	
3. Address of Operator P. O. Box 208, Farmington, NM 87499		10. Field and Pool, or Wildcat Basin Dakota	
4. Location of Well UNIT LETTER C LOCATED 1100 FEET FROM THE North LINE AND 1600 FEET FROM THE West LINE OF SEC. 28 TWP. 25N RGE. 2W NMPM		12. County Rio Arriba	
19. Proposed Depth 8000'		19A. Formation Dakota	
20. Rotary or C.T. Rotary		21. Elevations (Show whether DF, RT, etc.) 7158' GL; 7170' RKB	
21A. Kind & Status Plug. Bend State-Wide		21B. Drilling Contractor Four Corners Drilling	
22. Approx. Date Work will start ASAP			

23.

## PROPOSED CASING AND CEMENT PROGRAM

SIZE OF HOLE	SIZE OF CASING	WEIGHT PER FOOT	SETTING DEPTH	SACKS OF CEMENT	EST. TOP
12-1/4"	8-5/8"	32#	200'	159 cu.ft.	surface
7-7/8"	4-1/2"	11.6 & 10.5	8000'	1850 cu.ft.	surface
				cemented in 3 stages.	

Plan to drill with spud mud to set surface casing at 200'. Will then drill with water-mud-gel mixture to test the Basin Dakota Formation. Plan to run IES and CDL logs and, if the well appears productive, will set 4½" casing, cementing in three stages. Plan to run 1½" or 2-3/8" tubing and complete well.

GAS DEDICATED.

APPROVAL EXPIRES 9-22-83

UNLESS DRILLING IS COMMENCED.

STUDY OF CLOSURE MUST BE SUBMITTED

VOLUME 1-2-83

RECEIVED

OIL CONSERVATION DIVISION

IN ABOVE SPACE DESCRIBE PROPOSED PROGRAM: IF PROPOSAL IS TO DEEPEN OR PLUG BACK, GIVE DATA ON PRESENT PRODUCTIVE ZONE AND PROPOSED NEW PRODUCTIVE ZONE. GIVE BLOWOUT PREVENTER PROGRAM, IF ANY.

I hereby certify that the information above is true and complete to the best of my knowledge and belief.

Signed Jerry McHugh Title Agent Date 3/21/83  
(This space for State Use)

APPROVED BY [Signature] TITLE SUPERVISOR DISTRICT # ? DATE MAR 22 1983  
CONDITIONS OF APPROVAL, IF ANY:

All distances must be from the outer boundaries of the Section.

Operator <b>Jerome P. McHugh</b>		Lease <b>E.T.</b>		Well No. <b>1</b>	
Unit Letter <b>C</b>	Section <b>28</b>	Township <b>25 North</b>	Range <b>2 West</b>	County <b>Rio Arriba</b>	
Actual Footage Location of Well: <b>1100</b> feet from the <b>North</b> line and <b>1600</b> feet from the <b>West</b> line					
Ground Level Elev. <b>7158</b>	Producing Formation <b>Dakota</b>	Pool <b>Basin Dakota</b>		Dedicated Acreage: <b>320</b> Acres	

- Outline the acreage dedicated to the subject well by colored pencil or hachure marks on the plat below.
- If more than one lease is dedicated to the well, outline each and identify the ownership thereof (both as to working interest and royalty).
- If more than one lease of different ownership is dedicated to the well, have the interests of all owners been consolidated by communitization, unitization, force-pooling, etc?

☒ Yes ☐ No If answer is "yes," type of consolidation Communitization

If answer is "no," list the owners and tract descriptions which have actually been consolidated. (Use reverse side of this form if necessary.)

No allowable will be assigned to the well until all interests have been consolidated (by communitization, unitization, forced-pooling, or otherwise) or until a non-standard unit, eliminating such interests, has been approved by the Division.

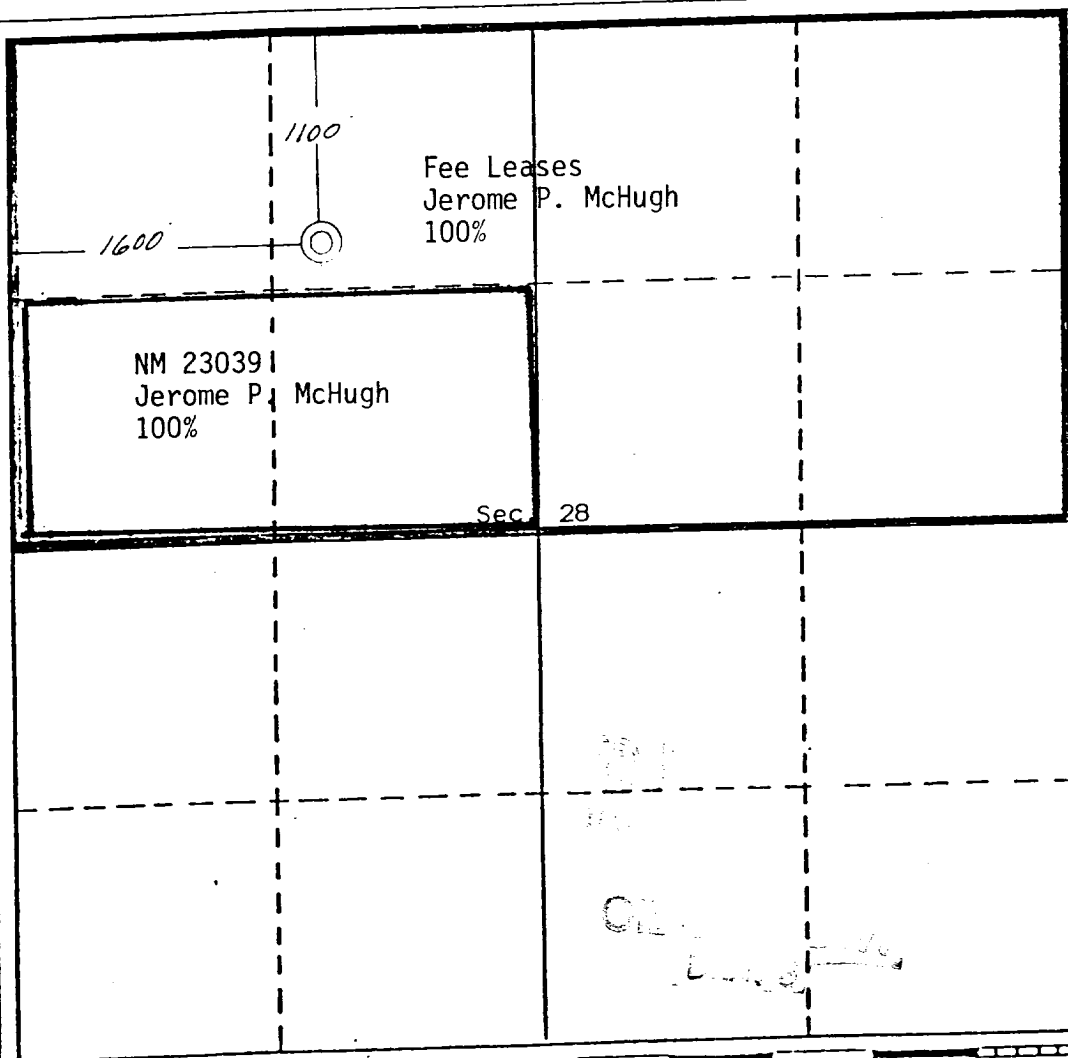

CERTIFICATION

I hereby certify that the information contained herein is true and complete to the best of my knowledge and belief.

*Jerry McHugh*  
Name  
**Jerry McHugh**

Position  
**Landman**

Company  
**Dugan Production Corp.**

Date  
**3/21/83**

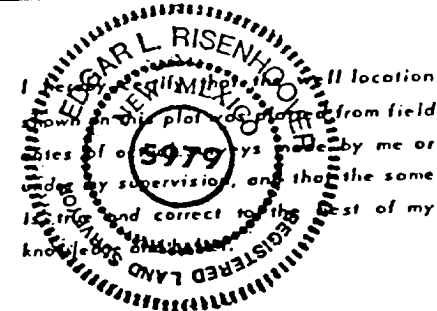

Date Surveyed

**March 17, 1983**

Registered Professional Engineer  
and/or Land Surveyor

*Edgar L. Risenhoover*

Certificate No. **5979**

**Edgar L. Risenhoover, L.S.**

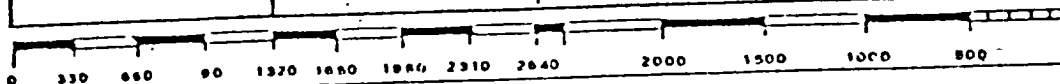



TONEY ANAYA  
GOVERNOR

STATE OF NEW MEXICO  
**ENERGY AND MINERALS DEPARTMENT**  
OIL CONSERVATION DIVISION  
AZTEC DISTRICT OFFICE

1000 RIO BRAZOS ROAD  
AZTEC, NEW MEXICO 87410  
(505) 334-6178

This application has been approved with the following conditions:

1. Trash is to be taken to a sanitary landfill, not buried at the wellsite, unless approved by the landowner.
2. Wells which produce oil during cleanup and testing shall be flowed through a separator and the oil recovered in a tank.
3. Cement quantities shall be reported in cubic feet on all reports, with a description of additives and different slurries used.
4. Casing and cementing reports must show water shut-off test, as required by Rule 107(c).
5. Reports of commencement of drilling operations must be filed within 10 days of spud, as required by Rule 1103.