

UNITED STATES
DEPARTMENT OF THE INTERIOR
GEOLOGICAL SURVEY

APPLICATION FOR PERMIT TO DRILL, DEEPEN, OR PLUG BACK

1a. TYPE OF WORK
DRILL ☒ DEEPEN ☐ PLUG BACK ☐b. TYPE OF WELL
OIL WELL ☒ GAS WELL ☐ OTHER ☐ SINGLE ZONE ☐ MULTIPLE ZONE ☒

2. NAME OF OPERATOR

Chace Oil Company, Inc.

3. ADDRESS OF OPERATOR

313 Washington, SE, Albuquerque, NM 87108

4. LOCATION OF WELL (Report location clearly and in accordance with any State requirements.)
At surface Unit 'G' - 1980' FNL & 1980' FEL

At proposed prod. zone

14. DISTANCE IN MILES AND DIRECTION FROM NEAREST TOWN OR POST OFFICE*

15 miles W-SW of Lindrith, New Mexico

U. S. GEOLOGICAL SURVEY
FARMINGTON, N. M.15. DISTANCE FROM PROPOSED*
LOCATION TO NEAREST
PROPERTY OR LEASE LINE, FT.
(Also to nearest drlg. unit line, if any) 1980' Lease Line
660' Unit Line16. NO. OF ACRES IN LEASE
256017. NO. OF ACRES ASSIGNED
TO THIS WELL
4018. DISTANCE FROM PROPOSED LOCATION*
TO NEAREST WELL, DRILLING, COMPLETED,
OR APPLIED FOR, ON THIS LEASE, FT.

1500'

19. PROPOSED DEPTH
7440'20. ROTARY OR CABLE TOOLS
Rotary

21. ELEVATIONS (Show whether DF, RT, GR, etc.)

7019' GL

DRILLING OPERATIONS AUTHORIZED ARE
SUBJECT TO COMPLIANCE WITH ATTACHED22. APPROX. DATE WORK WILL START*
9-1-83

23.

GENERAL REQUIREMENTS
PROPOSED CASING AND CEMENTING PROGRAMThis action is subject to administrative
appeal pursuant to 30 CFR 290.

SIZE OF HOLE	SIZE OF CASING	WEIGHT PER FOOT	SETTING DEPTH	QUANTITY OF CEMENT
9 3/4"	8 5/8"	22# (J-55)	225'	225 sxs (405 CF) Class B cement
7 7/8"	4 1/2"	11.6# (N-80)	7440'	1st stage: 750 sxs (1350 CF)
				50/50 pozmix
				2nd stage: 520 sxs (936 CF) 40/60
				Pozmix, 12% gel
				25 sxs (45 CF) Class B cement

Drill 230' of 9 3/4" surface hole. Set 225' of 8 5/8" casing. Cement to surface with 225 sxs (405 CF) cement. Use an oil base mud, (15% oil), and Schaeffer 5000# standard doublegate hydraulic BOP. Drill 7 7/8" hole to 7440' to test Dakota formation.

Wasatch formation on surface. Estimated tops: Ojo- 2425'; Pictured Cliffs-2885'; Chacra-3235'; Cliff House-4445'; Pt. Lookout-4960'; Gallup-6065'; Tootito-6690'; Greenhorn-7000'; Dakota 'A'-7085'; Dakota 'D'-7230'; Burro Canyon-7335'.

D. V. Tool @ 2935'. Float Collar @ 7410'.

RECEIVED

MAY 24 1983

IN ABOVE SPACE DESCRIBE PROPOSED PROGRAM: If proposal is to deepen or plug back, give data on present productive zone and proposed new productive zone. If proposal is to drill or deepen directionally, give pertinent data on subsurface locations and measured and true vertical depths. Give blowout preventer program, if any.

24.

SIGNED

TITLE

Geologist

DATE

1-12-83

(This space for Federal or State office use)

PERMIT NO.

APPROVAL DATE

APPROVED BY

TITLE

CONDITIONS OF APPROVAL, IF ANY:

APPROVED
AS AMENDED

DATE

MAY 23 1983
JAMES F. SIMS
DISTRICT ENGINEER

*See Instructions On Reverse Side

NMDC

All distances must be from the outer boundaries of the Section.

Operator CHACE OIL COMPANY, INC.		Lease SICARILLA TRIBAL #70		Well No. 17
Unit Letter G	Section 34	Township 24 NORTH	Range 4 WEST	County RIO ARriba
Actual Footage Location of Well:				
1980 feet from the NORTH line and		1980 feet from the EAST line		
Ground Level Elev. 7019	Producing Formation GALLUP - DAKOTA	Pool S. Lindrith GALLUP - DAKOTA	Dedicated Acreage 40 Acres	

1. Outline the acreage dedicated to the subject well by colored pencil or hatchure marks on the plat below.
2. If more than one lease is dedicated to the well, outline each and identify the ownership thereof (both as to working interest and royalty).
3. If more than one lease of different ownership is dedicated to the well, have the interests of all owners been consolidated by communitization, unitization, force-pooling, etc?

☐ Yes ☐ No If answer is "yes," type of consolidation _____

If answer is "no," list the owners and tract descriptions which have actually been consolidated. (Use reverse side of this form if necessary.) _____

No allowable will be assigned to the well until all interests have been consolidated (by communitization, unitization, forced-pooling, or otherwise) or until a non-standard unit, eliminating such interests, has been approved by the Division.

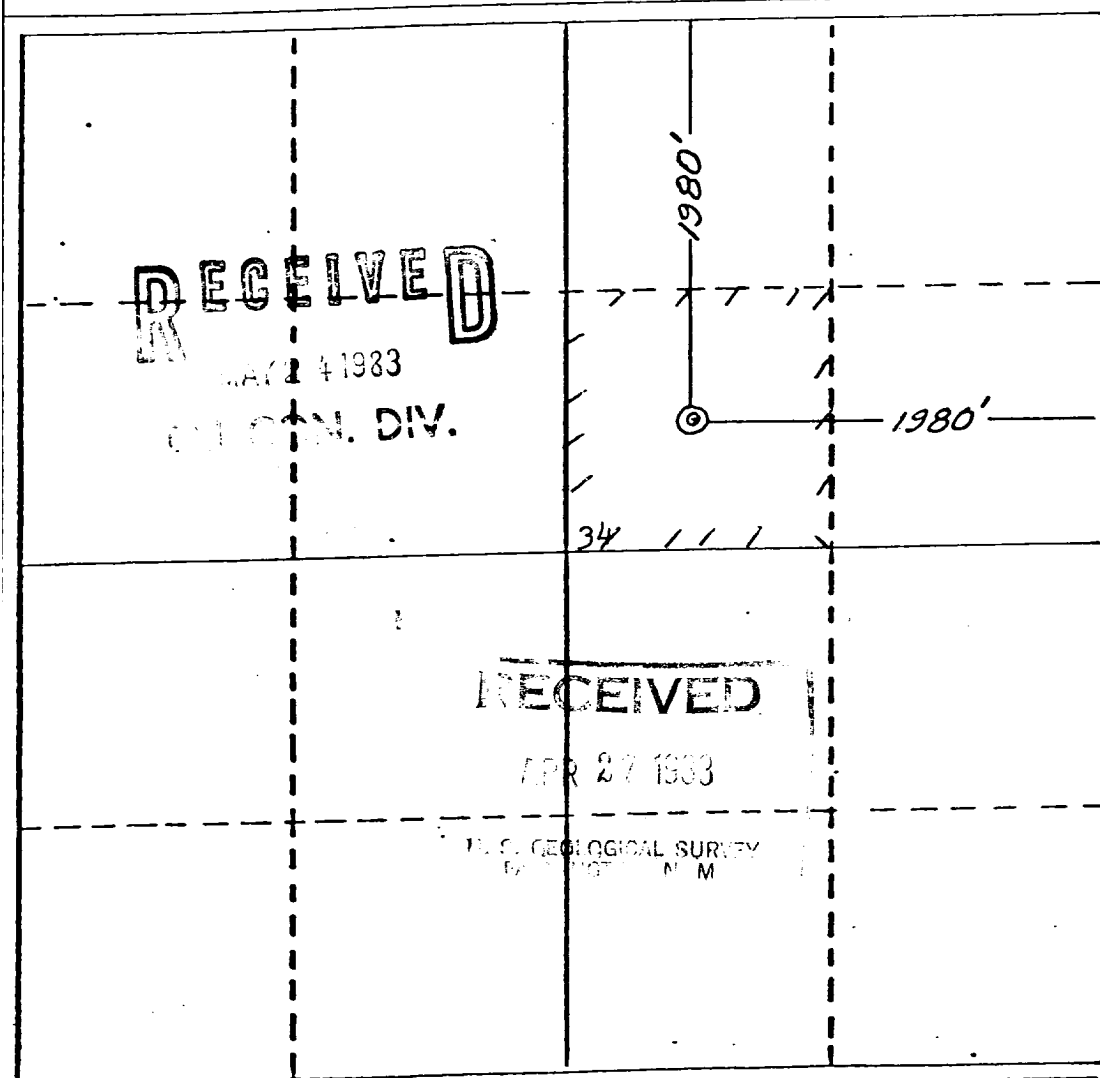

CERTIFICATION

I hereby certify that the information contained herein is true and complete to the best of my knowledge and belief.

Name *James P. Leese*
Position *Geologist*
Company *Chace Oil Co.*
Date *1-10-83*

I hereby certify that the location shown on this plat was plotted in the field notes of actual surveys made by me or under my supervision, and that the same is true and correct to the best of my knowledge and belief.

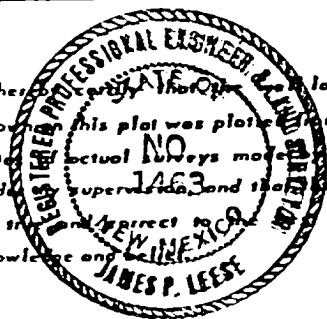

Date Surveyed
November 15, 1982
Registered Professional Engineer and/or Land Surveyor
James P. Leese
Certificate No.
1463

