

UNITED STATES  
DEPARTMENT OF THE INTERIOR  
GEOLOGICAL SURVEY

5. LEASE DESIGNATION AND SERIAL NO.

NM01138

6. IF INDIAN, ALLOTTEE OR TRIBE NAME

7. UNIT AGREEMENT NAME

8. FARM OR LEASE NAME

Fred Phillips "C"

9. WELL NO.

3

10. FIELD AND POOL, OR WILDCAT

Blanco Mesaverde/Ojito Gallup-

11. SEC., T., R., M., OR BLK.  
AND SURVEY OR AREA

Dakota

SW/NW, Section 15, T25N, R3W

12. COUNTY OR PARISH

13. STATE

Rio Arriba

New Mexico

APPLICATION FOR PERMIT TO DRILL, DEEPEN, OR PLUG BACK

1a. TYPE OF WORK

DRILL ☒

DEEPEN ☐

PLUG BACK ☐

b. TYPE OF WELL

OIL  
WELL ☒

GAS  
WELL ☒

OTHER

SINGLE  
ZONE ☐

MULTIPLE  
ZONE ☒

2. NAME OF OPERATOR

Amoco Production Company

3. ADDRESS OF OPERATOR

501 Airport Drive, Farmington, NM 87401

4. LOCATION OF WELL (Report location clearly and in accordance with any State requirements.)

At surface

1650' FNL x 910' FWL

At proposed prod. zone

Same

14. DISTANCE IN MILES AND DIRECTION FROM NEAREST TOWN OR POST OFFICE\*

2 miles northwest of Lindrith, New Mexico

15. DISTANCE FROM PROPOSED\*

LOCATION TO NEAREST  
PROPERTY OR LEASE LINE, FT.  
(Also to nearest drlg. unit line, if any)

910'

16. NO. OF ACRES IN LEASE

1720

18. DISTANCE FROM PROPOSED LOCATION\*

TO NEAREST WELL, DRILLING, COMPLETED,  
OR APPLIED FOR, ON THIS LEASE, FT.

200'

19. PROPOSED DEPTH

8340'

17. NO. OF ACRES ASSIGNED  
TO THIS WELL

320/40

20. ROTARY OR CABLE TOOLS

Rotary

21. ELEVATIONS (Show whether DF, RT, GR, etc.)

7332' GL

DRILLING OPERATIONS AUTHORIZED ARE

SUBJECT TO COMPLIANCE WITH ATTACHED

"GENERAL REQUIREMENTS"

22. APPROX. DATE WORK WILL START\*

As soon as permitted  
This action is subject to administrative  
appeal pursuant to 30 CFR 290.

23. PROPOSED CASING AND CEMENTING PROGRAM

SIZE OF HOLE	SIZE OF CASING	WEIGHT PER FOOT	SETTING DEPTH	QUANTITY OF CEMENT
12-1/4"	9-5/8" (NEW)	32 # K-55	300'	354 cu. ft. Class "B" w/2% CaCl2-
8-3/4"	7" (NEW)	23 # K-55	8340'	circ. Stage 1 - 240 cu. ft. Class
				"B" w/50:50 POZ, 6% gel, 2# med tuf
				plug/sx, and 0.8% FLA. Tail in w/
				118 cu. ft. Class "B" Neat - circ..
				Stage 2 - 830 cu. ft. Class "B" w/
				65:35 POZ, 6% gel, 2# med tuf plug/
				sx, and 0.8% FLA. Tail in w/118 cu
				ft. Class "B" neat - circ.

DV tool set at 6200'.

Amoco proposes to drill the above well to further develop the Mesaverde - Dakota reservoirs. The well will be drilled to the surface casing point using native mud. The well will then be drilled to TD with a low solids non-dispersed mud system. Completion design will be based on open hole logs. Copies of all logs will be filed upon completion. Amoco's standard blowout prevention will be employed; see attached drawing for blowout preventer design.

Upon completion, the well location will be cleaned and the reserve pit filled and leveled.

Gas produced from this well is not dedicated.

IN ABOVE SPACE DESCRIBE PROPOSED PROGRAM: If proposal is to deepen or plug back, give data on present productive zone and proposed new productive zone. If proposal is to drill or deepen directionally, give pertinent data on subsurface locations and measured and true vertical depths. Give blowout preventer program, if any.

24.

SIGNED

TITLE District Engineer

DATE 4/26/83

(This space for Federal or State office use)

PERMIT NO.

APPROVAL DATE

APPROVED BY

CONDITIONS OF APPROVAL, IF ANY:

RECEIVED

JUN 1 1983

OIL CON. DIV.

AMOCO

APPROVED  
AS AMENDED

MAY 3 1983

JAMES F. SIMS  
DISTRICT ENGINEER

All distances must be from the outer boundaries of the Section.

Operator AMOCO PRODUCTION COMPANY			Lease FRED PHILLIPS "C"		Well No. 3
Unit Letter E	Section 15	Township 25N	Range 3W	County Rio Arriba	
Actual Footage Location of Well: 1650 feet from the North line and 910 feet from the West line					
Ground Level Elev. 7332	Producing Formation Mesaverde/Dakota		Pool Blanco Mesaverde/Ojito Gal.-Dak.		Dedicated Acreage: 320/40 Acres

1. Outline the acreage dedicated to the subject well by colored pencil or hatchure marks on the plat below.
2. If more than one lease is dedicated to the well, outline each and identify the ownership thereof (both as to working interest and royalty).
3. If more than one lease of different ownership is dedicated to the well, have the interests of all owners been consolidated by communitization, unitization, force-pooling, etc?

☐ Yes ☐ No If answer is "yes," type of consolidation \_\_\_\_\_

If answer is "no," list the owners and tract descriptions which have actually been consolidated. (Use reverse side of this form if necessary.) \_\_\_\_\_

No allowable will be assigned to the well until all interests have been consolidated (by communitization, unitization, forced-pooling, or otherwise) or until a non-standard unit, eliminating such interests, has been approved by the Commission.

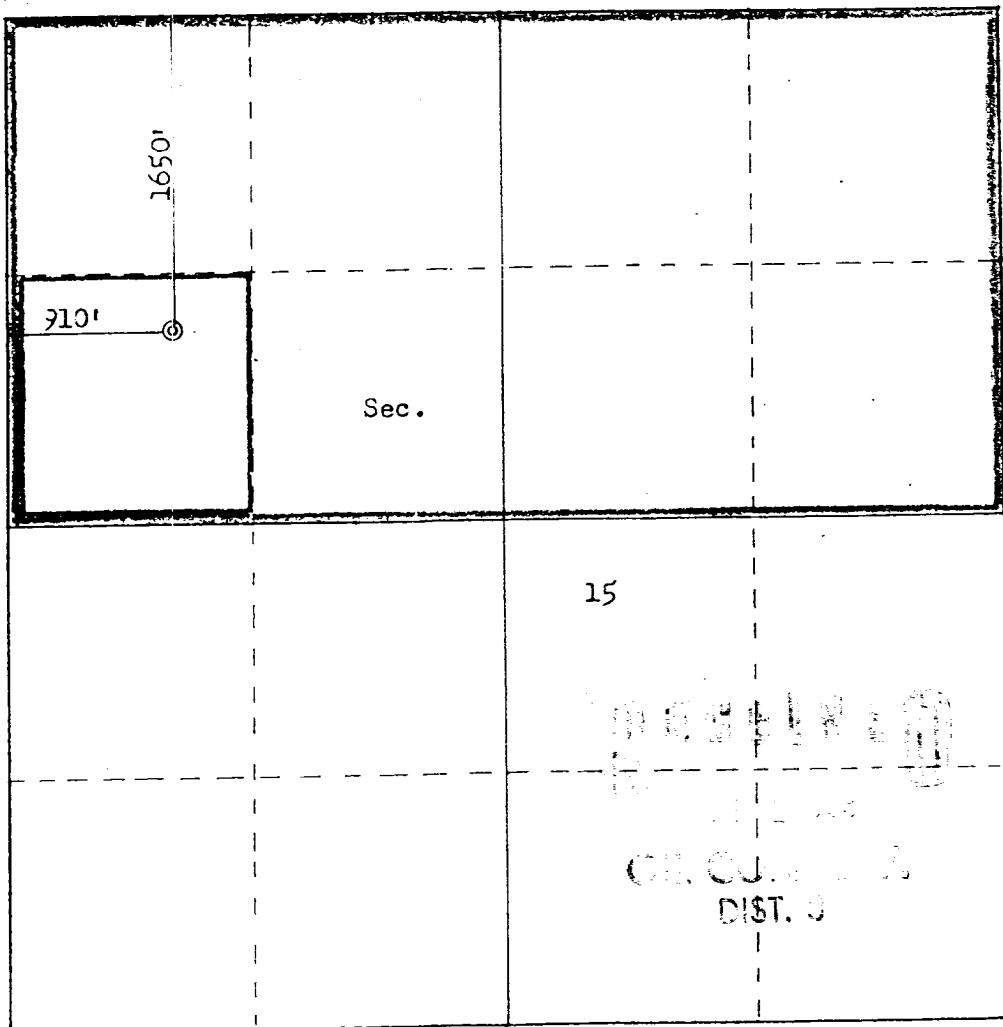

CERTIFICATION

I hereby certify that the information contained herein is true and complete to the best of my knowledge and belief.

*Dale H. Shoemaker*

Name  
DALE H. SHOEMAKER

Position  
DISTRICT ENGINEER

Company  
AMOCO PRODUCTION COMPANY

Date  
4-15-83

I hereby certify that the well location shown on this plat was plotted from field notes of actual surveys made by me or under my supervision, and that the same is true and correct to the best of my knowledge and belief.

Date Surveyed  
February 9, 1983

Registered Professional Engineer  
and Land Surveyor

*Fred S. Kent Jr.*  
Fred S. Kent Jr.

Certificate No. 4000  
2050