

District III

State of New Mexico

1000 Rio Bravos Rd

Aztec, NM 87410

DEPUTY COMMISSIONER INSPECTOR

FEB 9 1999

Energy, Minerals and Natural Resources Department

OIL CONSERVATION DIVISION

2040 S. PACHECO

Santa Fe, New Mexico 87505

Submit 1 copy to
Appropriate District
and 1 copy to
Santa Fe Office

PIT REMEDIATION AND CLOSURE REPORT

Operator: Apache Corporation \ MW Petroleum Telephone: 505-325-0318Address: 2855 Southside River Road, Suite A, Farmington, NM 87401Facility or Well Name: Jic Apache Tribal 124 #13Location: Unit or Qtr/Qtr Sec P Sec 24 T 25 N R 4W County Rio ArribaPit Type: Separator: _____ Dehydrator _____ Other Blow PitLand Type: Jicarilla Tribal

Beginning Pit Dimensions: Length 25' Width 25' Depth 3'
 Pit Location: Ending Pit Dimensions: Length 36' Width 32' Depth 9'
 (Attach diagram) Reference: Wellhead XXX Other _____
 Footage from reference: 250'
 Direction from reference: 180 Degrees _____ East _____ North _____
 _____ West _____ South XX

Depth To Groundwater:

(vertical distance from
contaminants to seasonal
high water elevation of
groundwater)

Less than 50 feet (20 points) _____
 50 feet to 99 feet (10 points) _____
 Greater than 100 feet (0 points) 0

Wellhead Protection Area:

(Less than 200 feet from a private
domestic water source, or, less than
1000 feet from all other water sources)

Yes (20 points) _____
 No (0 points) 0

Distance To Surface Water:

(Horizontal distance to perennial
lakes, ponds, rivers, streams, creeks,
irrigation canals and ditches)

Less than 200 feet (20 points) _____
 200 feet to 1000 feet (10 points) _____
 Greater than 1000 feet (0 points) 0

RANKING SCORE (TOTAL POINTS) 0

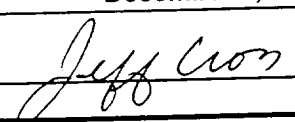
Date Remediation Started:		<u>6/17/97</u>	Date Completed:		<u>6/19/97</u>
Remediation Method: (Check all appropriate sections)		Excavation	<u>XXX</u>	Approx. cubic yards	<u>370</u>
		Landfarmed	<u>XX</u>	Insitu Bioremediation	
		Other			
Remediation Location: (i.e. landfarmed onsite, name and location of offsite facility)		Onsite	<u>XX</u>	Offsite	
General Description of Remedial Action:					
<u>Excavate pit to 9' , took PID readings. Hit bedrock at 9' ,</u>					
<u>Sprayed pit bottom with 46-0-0 Liquid Fertilizer. Spread soil on location for remediation. Took</u>					
<u>soil samples. Contour pit, remediate soil to be spread on location.</u>					
Groundwater Encountered:		No	<u>XX</u>	Yes	Depth <u> </u>
Final Pit:	Sample location	<u>4 point composite sample taken from pit sidewalls. Grab sample</u>			
Closure Sampling: (in multiple samples, attach sample results and diagram of sample locations and depths)	Sample depth	<u>9'</u>	<u>8 to 10" into pit sidewalls 10" into pit bottom</u>		
	Sample Date	<u>6/19/97</u>	Sample Time	<u>10:45 AM</u>	
	Sample results				
	Benzene	(ppm)	<u>ND</u>		
	Total BTEX	(ppm)	<u>ND</u>		
	Field Headspace	(ppm)	<u>3.82</u>		
	TPH		<u>Side/ND</u> <u>Btm/2100</u>		
Groundwater Sample:		Yes	<u> </u>	No	<u>XX</u> (If yes attach sample results)
I HEREBY CERTIFY THAT THE INFORMATION ABOVE IS TRUE AND COMPLETE TO THE BEST OF MY KNOWLEDGE AND BELIEF.					
DATE		<u>December 1, 1998</u>	PRINTED NAME		<u>Jeff Cross</u>
SIGNATURE		<u></u>	AND TITLE		<u>Project Manager</u>

JICARILLA APACHE TRIBE
ENVIRONMENTAL PROTECTION OFFICE
P. O. BOX 507
DULCE, NEW MEXICO 87528

Submit 1 copy to
Natural Resource Dept.
and Oil & Gas Administration

PIT REMEDIATION AND CLOSURE REPORT

Operator: <u>MW PETROLEUM</u>		Telephone <u>505-325-0318</u>																										
Address: <u>2855 Southside River Road, Suite A, Farmington, NM 87401</u>																												
Facility or Well Name: <u>JAT 124 # 13</u>																												
Location:	Unit or Qtr/Qtr	Sec	County																									
	<u>P</u>	<u>SEC 24</u>	<u>T 25 N R 4 W</u> <u>Rio Arriba</u>																									
Pit Type:	Separator: _____	Dehydrator: _____	Other: <u>BLOW PIT</u>																									
Land Type: <u>Jicarilla Tribal</u>																												
<table border="0" style="width: 100%;"> <tr> <td>Pit Location:</td> <td>Pit Dimensions:</td> <td>Length <u>36'</u></td> <td>Width <u>32'</u></td> <td>Depth <u>9'</u></td> </tr> <tr> <td>(Attach diagram)</td> <td>Reference:</td> <td>Wellhead <u>XX</u></td> <td>Other _____</td> <td></td> </tr> <tr> <td></td> <td>Footage from reference:</td> <td colspan="3"><u>250'</u></td> </tr> <tr> <td></td> <td>Direction from reference:</td> <td><u>180</u> Degrees</td> <td>_____ East</td> <td>North _____</td> </tr> <tr> <td></td> <td></td> <td></td> <td>_____ West</td> <td>South <u>XX</u></td> </tr> </table>				Pit Location:	Pit Dimensions:	Length <u>36'</u>	Width <u>32'</u>	Depth <u>9'</u>	(Attach diagram)	Reference:	Wellhead <u>XX</u>	Other _____			Footage from reference:	<u>250'</u>				Direction from reference:	<u>180</u> Degrees	_____ East	North _____				_____ West	South <u>XX</u>
Pit Location:	Pit Dimensions:	Length <u>36'</u>	Width <u>32'</u>	Depth <u>9'</u>																								
(Attach diagram)	Reference:	Wellhead <u>XX</u>	Other _____																									
	Footage from reference:	<u>250'</u>																										
	Direction from reference:	<u>180</u> Degrees	_____ East	North _____																								
			_____ West	South <u>XX</u>																								
Depth To Groundwater:		Less than 50 feet	(20 points) _____																									
(vertical distance from		50 feet to 99 feet	(10 points) _____																									
contaminants to seasonal		Greater than 100 feet	(0 points) <u>0</u>																									
high water elevation of																												
groundwater)																												
Distance to an Ephemeral Stream:		Less than 100 feet	(10 points) _____																									
(Downgradient dry wash greater than		Greater than 100 feet	(0 points) <u>0</u>																									
ten feet in width																												
Distance to Nearest Lake, Playa, or Watering Pond:		Less than 100 feet	(10 points) _____																									
(Downgradient lakes, playas and		Greater than 100 feet	(0 points) <u>0</u>																									
livestock or wildlife watering ponds)																												
Wellhead Protection Area:		Yes	(20 points) _____																									
(Less than 200 feet from a private		No	(0 points) <u>0</u>																									
domestic water source, or less than																												
1000 feet from all other water sources)																												
Distance To Surface Water:		Less than 100 feet	(20 points) _____																									
(Horizontal distance to perennial		100 feet to 1000 feet	(10 points) _____																									
lakes, ponds, rivers, streams, creeks,		Greater than 1000 feet	(0 points) <u>0</u>																									
irrigation canals and ditches)																												
RANKING SCORE (TOTAL POINTS)			<u>0</u>																									

Date Remediation Started: 6/17/97 Date Completed: 6/19/97

Remediation Method: Excavation XXX Approx. cubic yards 370
(Check all appropriate sections) Landfarmed XX Insitu Bioremediation _____

Other _____

Remediation Location: Onsite XX Offsite _____
(i.e. landfarmed onsite, name and location of offsite facility)

General Description of Remedial Action: EXCAVATE PIT TO 9', TOOK PID READINGS.
HIT BED ROCK AT 9', SPRAYED PIT BOTTOM WITH 46-0-0 LIQUID FERTILIZED.
SPREAD SOIL ON LOCATION FOR REMEDIATION. TOOK SOIL SAMPLES.
CONTOUR PIT, REMD. SOIL TO BE SPREAD ON LOC.

Groundwater Encountered: No X Yes _____ Depth _____

Final Pit: Sample location 4 point composite taken from pit sidewalls

Closure Sampling: (in multiple samples, attach sample results and diagram of sample locations and depths) 1 point grab sample taken from pit bottom center.

Sample depth 9'

Sample Date 6/19/97 Sample Time 10:45AM
Sample results

Soil:	Benzene	(ppm)	<u>ND</u>	Water:	Benzene	(ppb)	<u>NA</u>
	Total BTEX	(ppm)	<u>ND</u>		Toluene	(ppb)	<u>NA</u>
	Field Headspace	(ppm)	<u>3.82</u>		Ethylbenzene	(ppb)	<u>NA</u>
	TPH	(ppm)	<u>ND\SIDE</u>		Total Xylenes	(ppb)	<u>NA</u>
			<u>2100\BTM</u>				

Groundwater Sample: Yes _____ No X (If yes attach sample results)

I HEREBY CERTIFY THAT THE INFORMATION ABOVE IS TRUE AND COMPLETE TO THE BEST OF MY KNOWLEDGE AND BELIEF.

DATE 9/22/98 PRINTED NAME JEFF CROSS

SIGNATURE Jeff Cross AND TITLE Project Manager

AFTER REVIEW OF THE PIT CLOSURE INFORMATION, PIT CLOSURE IS APPROVED IN ACCORDANCE TO THE JICARILLA APACHE TRIBE PIT CLOSURE ORDINANCE.

APPROVED: YES X NO _____ (REASON) _____

SIGNED: Karen C. Marshall DATE: 11-13-98

MW PETROLEUM/FARMINGTON DISTRICT PIT EXCAVATION AND CLOSURE REPORT

LOCATION JAT 124 # 13

PIT COUNT 1

Jicarilla Apache Tribal EPO/OCD/BLM

Review and Approval

OCD--BLM

EPO Representative

Date of Review

START		6/17/97			FINISH		6/19/97		
DIMENSIONS									
	L	W	D		L	W	D	CU YDS	
Pit 1	25'	25'	3'	Pit 1	36'	32'	9'	370	
Pit 2				Pit 2					
Pit 3				Pit 3					
DATE:		Pit 1 @ 6'	Pit 2 @	Pit 3 @	Date:		Pit 1 @ 9'	Pit 2 @	Pit 3 @
P I D	Center	525			P I D	Center	98.6		
	NW Corner	418				NW Corner	73.5		
	NE Corner	402				NE Corner	75		
	SW Corner	275				SW Corner	43.2		
	SE Corner	250				SE Corner	42.7		

NOTES:

6/17/97 START EXCAVATION OF PIT , PID READINGS HIGH @ 6'.

6/18/97 CONTINUE EXCAVATION OF PIT, HIT ROCK BOTTOM @ 9', PID READINGS GOOD.

6/19/97 EXCAVATE PIT SIDE WALLS , PID READINGS GOOD.

6/19/97 TOOK SOIL SAMPLES OF PIT SIDE WALLS AND PIT BOTTOM, SENT TO ASSAIGAI LABS.

DATE		6/19/97			SOIL SAMPLING				
		Pit 1 @ 9'	Pit 2 @	Pit 3 @	ANALYSIS RESULTS			PER LAB	Assaigai
P I D	Center	98.6			PIT NO	TPH	BETEX	WITNESS	DATE
	NW Corner	73.5				SIDE\BTM	SIDE\BTM		
	NE Corner	75			1	ND\2100	ND\ND	J.C	6/19/97
	SW Corner	43.2			2				
	SE Corner	42.7			3				

RE-SAMPLE

DATE:		Pit 1 @	Pit 2 @	Pit 3 @	ANALYSIS RESULTS			PER LAB	
P I D	Center				PIT NO	TPH	BETEX	WITNESS	DATE
	NW Corner					SIDE\BTM	SIDE\BTM		
	NE Corner				1				
	SW Corner				2				
	SE Corner				3				

RE-SAMPLE

DATE:		Pit 1 @	Pit 2 @	Pit 3 @	ANALYSIS RESULTS			PER LAB	
P I D	Center				PIT NO	TPH	BETEX	WITNESS	DATE
	NW Corner					SIDE\BTM	SIDE\BTM		
	NE Corner				1				
	SW Corner				2				
	SE Corner				3				

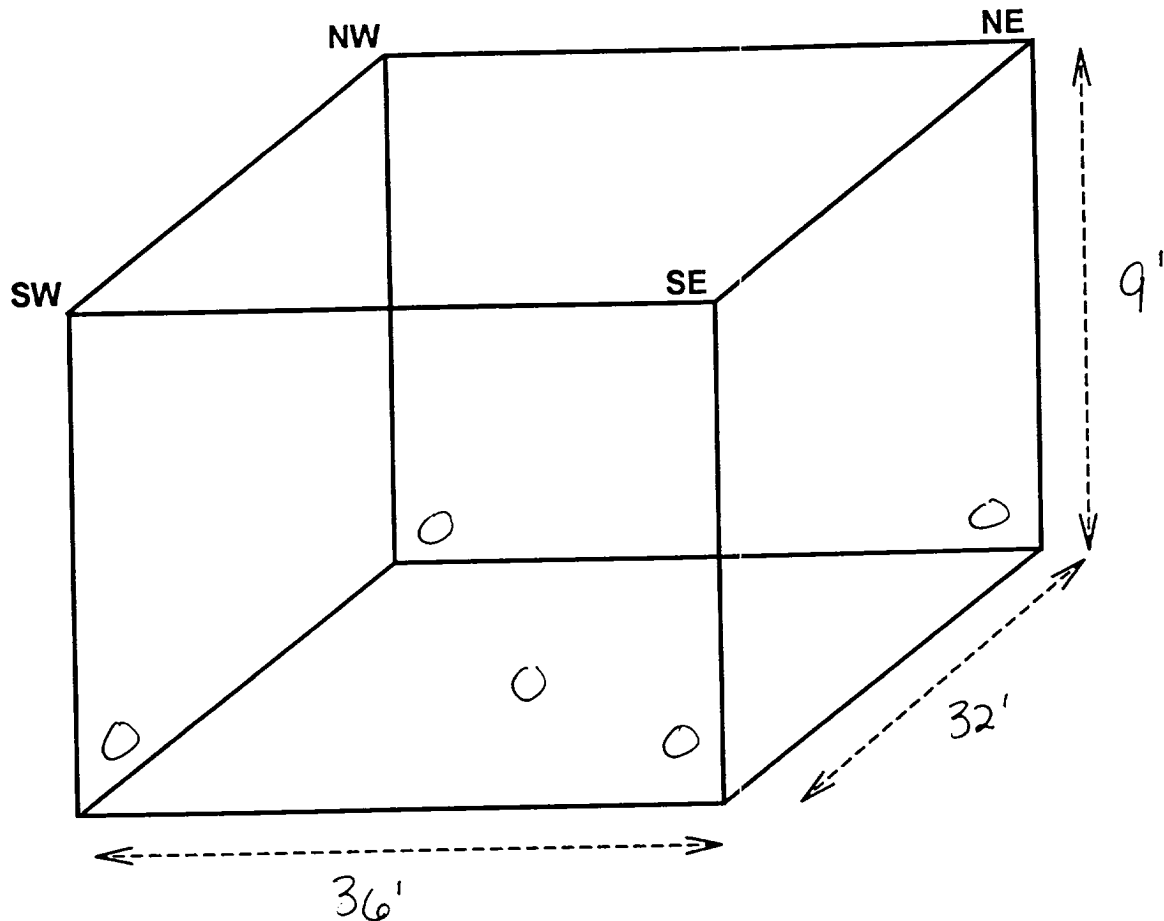

○ = SAMPLE AREA

WELL NAME JAT 124 # 13

SAMPLE DATE 6/19/97

NOTES 4 POINT COMPOSITE SAMPLE TAKEN 8" TO 10" INTO PIT
SIDEWALL
1 POINT GRAB SAMPLE TAKEN 10" TO 12" INTO BOTTOM CENTER
HIT BED ROCK

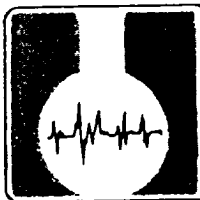

**ASSAIGAI
ANALYTICAL
LABORATORIES, INC.**

JUL 21 1997

7300 Jefferson, N.E. • Albuquerque, New Mexico 87109 • (505) 345-8964 • FAX (505) 345-7259

3332 Wedgewood, E-5 • El Paso, Texas 79925 • (915) 593-6000 • FAX (915) 593-7820

Report Generated:
June 30, 1997 16:41

**CERTIFICATE OF ANALYSIS
RESULTS BY SAMPLE**

SENT APACHE CORPORATION
TO: 304 N. BEHREND
FARMINGTON, NM 87401

WORKORDER # : 9706229
WORK ID : JICARILLA PIT CLOSURES
CLIENT CODE : APA01
DATE RECEIVED : 06/23/97

ATTN: JEFF CROSS

Page: 1

Lab ID: 9706229-01A
Sample ID: JAT 124 #13 SIDES

Collected: 06/19/97 10:45:00
Matrix: SOIL

TEST / METHOD	RESULT	UNITS	LIMIT	D_F	DATE ANAL	BATCH_ID
BTEX/SW846 8020A						
Benzene	ND	mg/kg	0.0050	100	06/25/97	SBTXME172
Toluene	ND	mg/kg	0.0050	100	06/25/97	SBTXME172
Ethylbenzene	ND	mg/kg	0.0050	100	06/25/97	SBTXME172
P-&m-Xylene	ND	mg/kg	0.010	100	06/25/97	SBTXME172
O-Xylene	ND	mg/kg	0.0050	100	06/25/97	SBTXME172

Lab ID: 9706229-01B
Sample ID: JAT 124 #13 SIDES

Collected: 06/19/97 10:45:00
Matrix: SOIL

TEST / METHOD	RESULT	UNITS	LIMIT	D_F	DATE ANAL	BATCH_ID
Diesel Range OG Soil/M8015						
Diesel Range OG in Soil	ND	mg/Kg	50	25	06/28/97	SDRO037

Lab ID: 9706229-02A
Sample ID: JAT 124 #13 BOTTOM

Collected: 06/19/97 11:00:00
Matrix: SOIL

TEST / METHOD	RESULT	UNITS	LIMIT	D_F	DATE ANAL	BATCH_ID
BTEX/SW846 8020A						
Benzene	ND*	mg/kg	0.0050	250	06/25/97	SMSVOA453
Toluene	ND*	mg/kg	0.0050	250	06/25/97	SMSVOA453
Ethylbenzene	ND*	mg/kg	0.0050	250	06/25/97	SMSVOA453
P-&m-Xylene	ND*	mg/kg	0.010	250	06/25/97	SMSVOA453
O-Xylene	ND*	mg/kg	0.0050	250	06/25/97	SMSVOA453



Job ID: 9706229-02B

Collected: 06/19/97 11:00:00

Sample ID: JAT 124 #13 BOTTOM

Matrix: SOIL

TEST / METHOD	RESULT	UNITS	LIMIT	D_F	DATE ANAL	BATCH_ID
Diesel Range OG Soil/M8015 Diesel Range OG in Soil	2100	mg/Kg	50	25	06/28/97	SDRO037

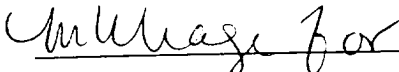
William P. Biava
President

WORKORDER COMMENTS

DATE : 06/30/97
WORKORDER: 9706229

DEFINITIONS/DATA QUALIFIERS

The following are definitions, abbreviations, and data qualifiers which may have been utilized in your report:

- ND = Analyte "not detected" in analysis at the sample specific detection limit.
- D_F = Sample "dilution factor"
- NT = Analyte "not tested" per client request.
- B = Analyte was also detected in laboratory method QC blank.
- E = Analyte concentration (result) is an estimated value or exceeds analysis calibration range.
- LIMIT = The minimum amount of the analyte that AAL can detect utilizing the specified analysis.

Please Note: Multiply the "Limit" value (AAL's Detection Limit) by Dilution Factor (D_F) to obtain the sample specific Detection Limit.

REPORT COMMENTS

*Please note: Sample 02A was analyzed by GC/MS method SW846-8240.

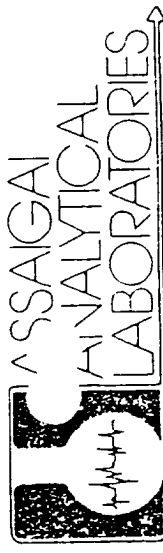

Chain of Custody Record

ALBUQUERQUE, NEW MEXICO 87109
(505) 345-8964

3332 WEDGEWOOD
EL PASO, TEXAS 79925
(915) 593-6000

1910 N. BIG SPRING
MIDLAND, TEXAS 79705
(915) 570-1116

MELQUIADES ALANIS
6411 LOCAL UNO
CIUDAD JUAREZ, CHIHUAHUA MEXICO 32320

Client Apache Corporation Project Manager / Contact Jeff Cross

Address 304 N. Behrend Telephone No. (505) 774-6643

City / State / Zip Earmington, NM 87401 Fax No. (505) 774-6624

Project Name / Number JICARILLA PIT CLOSURES Samplers: (Signature) Jeff Cross

Contract / Purchase Order / Quote _____

ALL FRACTION NUMBER	Field Sample Number / Location	Date	Time	Sample Type	Type / Size of Container	Preservation	
						Temp.	Chemical
01A	JAT 124 #13 S.O.E.S	6-19-97	10:45	50.1	402 glass		ICE
01B	" "		10:45				
02A	JAT 124 #13 Bottom		11:00				
02B	" "		11:00				
03							
04							
05							
06							
07							
08							
09							
10							
11							
12							
13							
14							
15							
16							
17							
18							
19							
20							
21							
22							
23							
24							
25							
26							
27							
28							
29							
30							
31							
32							
33							
34							
35							
36							
37							
38							
39							
40							
41							
42							
43							
44							
45							
46							
47							
48							
49							
50							
51							
52							
53							
54							
55							
56							
57							
58							
59							
60							
61							
62							
63							
64							
65							
66							
67							
68							
69							
70							
71							
72							
73							
74							
75							
76							
77							
78							
79							
80							
81							
82							
83							
84							
85							
86							
87							
88							
89							
90							
91							
92							
93							
94							
95							
96							
97							
98							
99							
100							

Analysis Required

No. of Containers: BTX (mod. 8015)

Remarks

Received by: Jeff Cross
Signature: Jeff Cross
Printed: Jeff Cross
Company: Apache Corp.
Reason:

Date: 6-23-97
Time: 15:30

Relinquished by: Jeff Cross
Signature: Jeff Cross
Printed: Jeff Cross
Company: Apache Corp.
Reason:

After analysis, samples are to be:
☐ Disposed of (additional fee)
☐ Stored (30 days max)
☐ Stored over 30 days (additional fee)
☐ Returned to customer

LABORATORY

M W PETROLEUM

JICARILLA APACHE TRIBAL 124 WELL 13

SE/4 SE/4 (P). FED. LEASE # 09000124

SECTION 24. TOWNSHIP 25N. RANGE 4W

RIO ARriba COUNTY, NM

LAND FARM

100' x 100' x 12"

370 years.

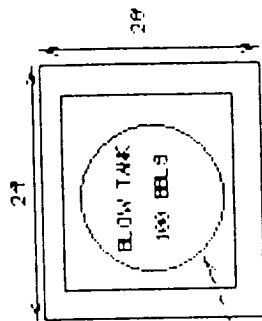

WELL HEAD

DIRECTION OF DRAINAGE

N

PIT

(1)

JICARILLA APACHE TRIBE
ENVIRONMENTAL PROTECTION OFFICE
P. O. BOX 507
DULCE, NEW MEXICO 87528

Submit 1 copy to
Natural Resource Dept.
and Oil & Gas Administration

ON-SITE SOIL REMEDIATION REPORT

Operator: <u>M W PETROLUEM</u> Telephone <u>505-325-0318</u>	
Address: <u>2855 SOUTHSIDE RIVER ROAD /SUITE A/FARMINGTON, N.M. 87401-7947</u>	
Facility or Well Name: <u>JAT 124 # 13</u>	
Location: Unit or Qtr/Qtr Sec <u>P</u> SEC <u>24</u> T <u>25 N</u> R <u>4 W</u> County <u>RIO ARRIBA</u>	
Land Type <u>JIC. TRIBAL</u>	
Date Remediation Started: <u>6/17/97</u> Date Completed: <u>8/18/98</u>	
Remediation Method: Landfarmed <u>XXX</u> Approx. cubic yards <u>370</u>	
Composted _____	
Other <u>REMEDIATED SOIL TO BE SPREAD ON LOCATION.</u>	
Depth to Groundwater: (pts) <u>0</u>	Final Closure Sampling Sampling Date: <u>8/18/98</u> Time: <u>12:25PM</u> Sample Results: Field Headspace (ppm) <u>0</u> TPH (ppm) <u>740</u> Method <u>M8015</u> Other <u>BTEX \ SW846 , 8020A (ND)</u>
Distance to an Ephemeral Stream: (pts) <u>0</u>	
Distance to Nearest Lake, Playa, or Watering Pond: (pts) <u>0</u>	
Wellhead Protection Area: (pts) <u>0</u>	
Distance To Surface Water: (pts) <u>0</u>	
RANKING SCORE (TOTAL POINTS) <u>0</u>	
I HEREBY CERTIFY THAT THE INFORMATION ABOVE IS TRUE AND COMPLETE TO THE BEST OF MY KNOWLEDGE AND BELIEF	
DATE: <u>9/22/98</u>	PRINTED NAME <u>JEFF CROSS</u>
SIGNATURE <u>Jeff Cross</u>	TITLE <u>PROJECT MANAGER</u>
AFTER REVIEW OF THE SOIL REMEDIATION INFORMATION. ON-SITE REMEDIATION IS APPROVED IN ACCORDANCE TO THE JICARILLA APACHE TRIBE PIT CLOSURE ORDINANCE.	
APPROVED: YES <u>X</u> NO _____ (REASON) _____	
SIGNED: <u>Ken C. McNeill</u>	DATE: <u>11-13-98</u>

M W PETROLEUM/FARMINGTON DISTRICT SOIL REMEDIATIONS STATUS REPORT

REMEDIATION SITE JAT 124 # 13

* AMOUNT OF SOIL UNDERGOING REMEDIATION 370 Yds.

CELL No. <u>1</u>	SampDATE	TPH	BTEX
	6/10/98	2000	ND
	8/18/98	740	ND
DIMENSIONS(LxWxH) <u>100' X 100' X 12"</u>			
CELL LOCATION (dir. from well head) <u>SOUTH</u>			
* DATE BEGAN: <u>6/17/97</u>			
DATE TERMINATED (TPH <5,000 ppm/BTEX< 50 ppm/Benzene < 10 ppm) <u>8/18/98</u>			
CELL No. <u>2</u>	SampDATE	TPH	BTEX
DIMENSIONS(LxWxH) _____			
CELL LOCATION (dir. from well head) _____			
* DATE BEGAN: _____			
DATE TERMINATED (TPH <5,000 ppm/BTEX< 50 ppm/Benzene < 10 ppm) _____			
CELL No. <u>3</u>	SampDATE	TPH	BTEX
DIMENSIONS(LxWxH) _____			
CELL LOCATION (dir. from well head) _____			
* DATE BEGAN: _____			
DATE TERMINATED (TPH <5,000 ppm/BTEX< 50 ppm/Benzene < 10 ppm) _____			
REMEDICATION RECORD: (Date, Treatment, Tilling)			
6/23/97 TREAT SOIL WITH 46-0-0 FERTILIZER,WATER,PLOW AND TILL.			
7/3/97 PLOW AND TILL SOIL. 5/7/98 TILL SOIL.			
7/16/97 PLOW AND TILL SOIL. 6/8/98 PLOW AND TILL SOIL.			
7/28/97 PLOW AND TILL SOIL. 6/19/98 WATER,PLOW AND TILL SOIL.			
8/7/97 WATER , PLOW AND TILL SOIL. 7/10/98 PLOW AND SOIL.			
8/20/97 PLOW AND TILL SOIL. 7/28/98 WATER,PLOW AND TILL SOIL.			
4/23/98 PLOW AND TILL SOIL. 8/6/98 PLOW AND TILL SOIL.			
5/6/98 PLOW SOIL. 8/17/98 PLOW AND TILL SOIL.			

From excavation reports.

WELL NAME: JAT 124 #13 cell
SAMPLE DATE: 8-18-98
DIMENSIONS: 100' x 100' x 12"

○ = SAMPLE AREA

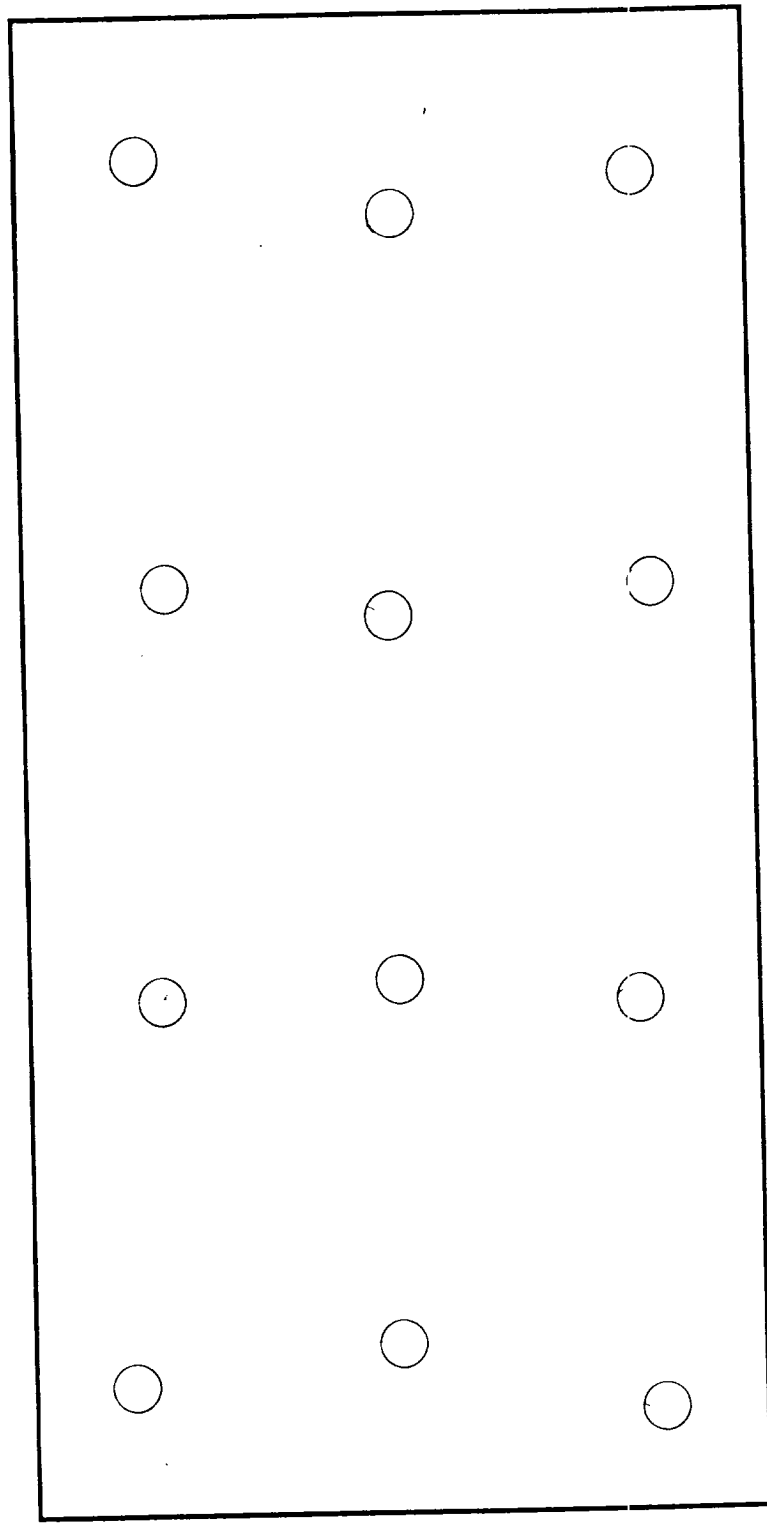

NOTES: ALL SAMPLES TAKEN 10" TO 12" INTO CELL.
12 point composite sample



ASSAIGAI ANALYTICAL LABORATORIES, INC.

7300 Jefferson, NE • Albuquerque, New Mexico 87109 • (505) 345-8964 • FAX (505) 845-7259

3332 Wedgewood, E-5 • El Paso, Texas 79925 • (915) 593-6000 • FAX (915) 593-7820
127 Eastgate Drive, 212-C • Los Alamos, New Mexico 87544 • (505) 662-2558

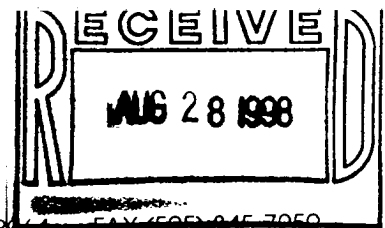

APACHE CORPORATION
attn: JEFF CROSS
2855 SOUTHSIDE RIVER RD STE A
FARMINGTON, NM 87401-7947

* explanation of codes

B	analyte detected in Method Blank
E	result is estimated
H	analyzed out of hold time
N	tentatively identified compound
S	subcontracted
1-9	see footnote

Assaigai Analytical Laboratories, Inc.

Certificate of Analysis

Client: APACHE CORPORATION
Project: 9808188 JICARILLA PIT CLOSURES

William P. Biava
William P. Biava: President of Assaigai Analytical Laboratories, Inc.

Client Sample ID		JAT 124 #13 CELL		Sample Matrix		SOIL		Sample Collected		08/18/98 12:25:00									
Fraction		QC Group		CAS #		Result		Units		Dilution Factor		Detection Limit		*		Sequence		Run Date	
Test: SW846 8015A/8020A GRO / Purgeable Aromatics																			
9808188-01A		X98392		71-43-2		Benzene		ND		mg / Kg		50		0.005		XG.1998.704-14		08/21/98	
		X98392		100-41-4		Ethylbenzene		ND		mg / Kg		50		0.005		XG.1998.704-14			
		X98392		95-47-6		o-Xylene		ND		mg / Kg		50		0.005		XG.1998.704-14			
		X98392				p/m Xylenes		ND		mg / Kg		50		0.01		XG.1998.704-14			
		X98392		108-88-3		Toluene		ND		mg / Kg		50		0.005		XG.1998.704-14			
Test: SW846 8015A Diesel Range Organics by GC/FID																			
9808188-01B		X98389				Diesel Range Organics		740		mg / Kg		25		25		XG.1998.699-16		08/21/98	

*** Sample specific analytical Detection Limit is determined by multiplying the sample Dilution Factor by the listed method Detection Limit. ***
*** Results relate only to the items tested. ***



Custody records

Lab job no

232

Date _____

Page 1 of 1

Apache Corporation

Project Manager / Contact ~~Jeff Cross~~

dress 2855 Southside River Rd. Ste. A

Telephone No. (505) 774-6643

State / Zip Farmington, NM 87401-7947

Fax No. (505) 774-6624

Project Name / Number JICARILLA PIT CLOSURES

Samplers: (Signature) [Signature]

Abstract: Purchase Order / Quote[illegible]

LABORATORY