

UNITED STATES
DEPARTMENT OF THE INTERIOR
GEOLOGICAL SURVEY

APPLICATION FOR PERMIT TO DRILL, DEEPEN, OR PLUG BACK

1a. TYPE OF WORK

DRILL ☒DEEPEN ☐PLUG BACK ☐

b. TYPE OF WELL

OIL
WELL ☒GAS
WELL ☐

OTHER

SINGLE
ZONE ☒MULTIPLE
ZONE ☐

2. NAME OF OPERATOR

Eastern States Exploration Company, Inc.

3. ADDRESS OF OPERATOR

913 King Street, Alexander, Virginia 22314

4. LOCATION OF WELL (Report location clearly and in accordance with any State requirements.)*

At surface

700' FSL, 1940' FWL

At proposed prod. zone

Same

14. DISTANCE IN MILES AND DIRECTION FROM NEAREST TOWN OR POST OFFICE*

40 Miles Northeast of Cuba, New Mexico

15. DISTANCE FROM PROPOSED*

LOCATION TO NEAREST

PROPERTY OR LEASE LINE, FT.

(Also to nearest drlg. unit line, if any)

700'

18. DISTANCE FROM PROPOSED LOCATION*

TO NEAREST WELL, DRILLING, COMPLETED,
OR APPLIED FOR, ON THIS LEASE, FT.

500'

16. NO. OF ACRES IN LEASE

2564.36

19. PROPOSED DEPTH

8300'

17. NO. OF ACRES ASSIGNED
TO THIS WELL

160

20. ROTARY OR CABLE TOOLS

Rotary

21. ELEVATIONS (Show whether DF, RT, GR, etc.)

7314' GR

22. APPROX. DATE WORK WILL START*

9-15-83

23.

PROPOSED CASING AND CEMENTING PROGRAM

This action is subject to administrative
appeal pursuant to 30 CFR 290.
QUANTITY OF CEMENT

SIZE OF HOLE	SIZE OF CASING	WEIGHT PER FOOT	SETTING DEPTH	QUANTITY OF CEMENT
12 1/4"	8 5/8"	24.0	300'	310 cu. ft.
7 7/8"	4 1/2"	10.50 & 11.60	8300'	1550 cu. ft.-3 stages

All producing intervals in Dakota and Gallup Formations will be perforated and stimulated as necessary.

EXHIBITS

"A" Location & Elevation Plat

"B" Ten Point Compliance Program

"C" Blowout Preventer Diagram

"D" Multi Point Requirements of APD

"E" Access to Road to Location

"F" Radius Map of Field

"G" Drill Rig Layout

"H" Fracturing Program Layout

"I" Location Profile

The gas for this well is committed.

The SW/4 Section 10 is dedicated to this well.

IN ABOVE SPACE DESCRIBE PROPOSED PROGRAM: If proposal is to deepen or plug back, give data on present productive zone and proposed new productive zone. If proposal is to drill or deepen directionally, give pertinent data on subsurface locations and measured true vertical depths. Give blowout preventer program, if any.

24. For: Eastern States Exploration Co., Inc.

SIGNED

Ewell N. Walsh, P.E.

TITLE President, Walsh Engr. &

DATE 8-9-83

(This space for Federal or State office use)

PERMIT NO.

APPROVAL DATE

APPROVED BY

TITLE

DATE

CONDITIONS OF APPROVAL, IF ANY:

*See Instructions On Reverse Side

RECEIVED
SEP 13 1983
OIL & GAS DIV.
DIST. 3

AS AMENDED

R. Bingham
Asst.
A. L.

All distances must be from the outer boundaries of the Section.

Operator EASTERN STATES EXPLORATION CO. INC.			Lease Jicarilla Contract 122		Well No. 2
Unit Letter N	Section 10	Township 25N	Range 4W	County Rio Arriba	
Actual Footage Location of Well: 700 feet from the South line and 1940 feet from the West line					
Ground Level Elev. 7314	Producing Formation Gallup-Dakota		Pool Lindrith Gallup-Dakota, West, Extension		Dedicated Acreage: 160 Acres

1. Outline the acreage dedicated to the subject well by colored pencil or hatchure marks on the plat below.
2. If more than one lease is dedicated to the well, outline each and identify the ownership thereof (both as to working interest and royalty).
3. If more than one lease of different ownership is dedicated to the well, have the interests of all owners been consolidated by communitization, unitization, force-pooling, etc?

☐ Yes ☐ No If answer is "yes," type of consolidation _____

If answer is "no," list the owners and tract descriptions which have actually been consolidated. (Use reverse side of this form if necessary.) _____

No allowable will be assigned to the well until all interests have been consolidated (by communitization, unitization, forced-pooling, or otherwise) or until a non-standard unit, eliminating such interests, has been approved by the Commission.

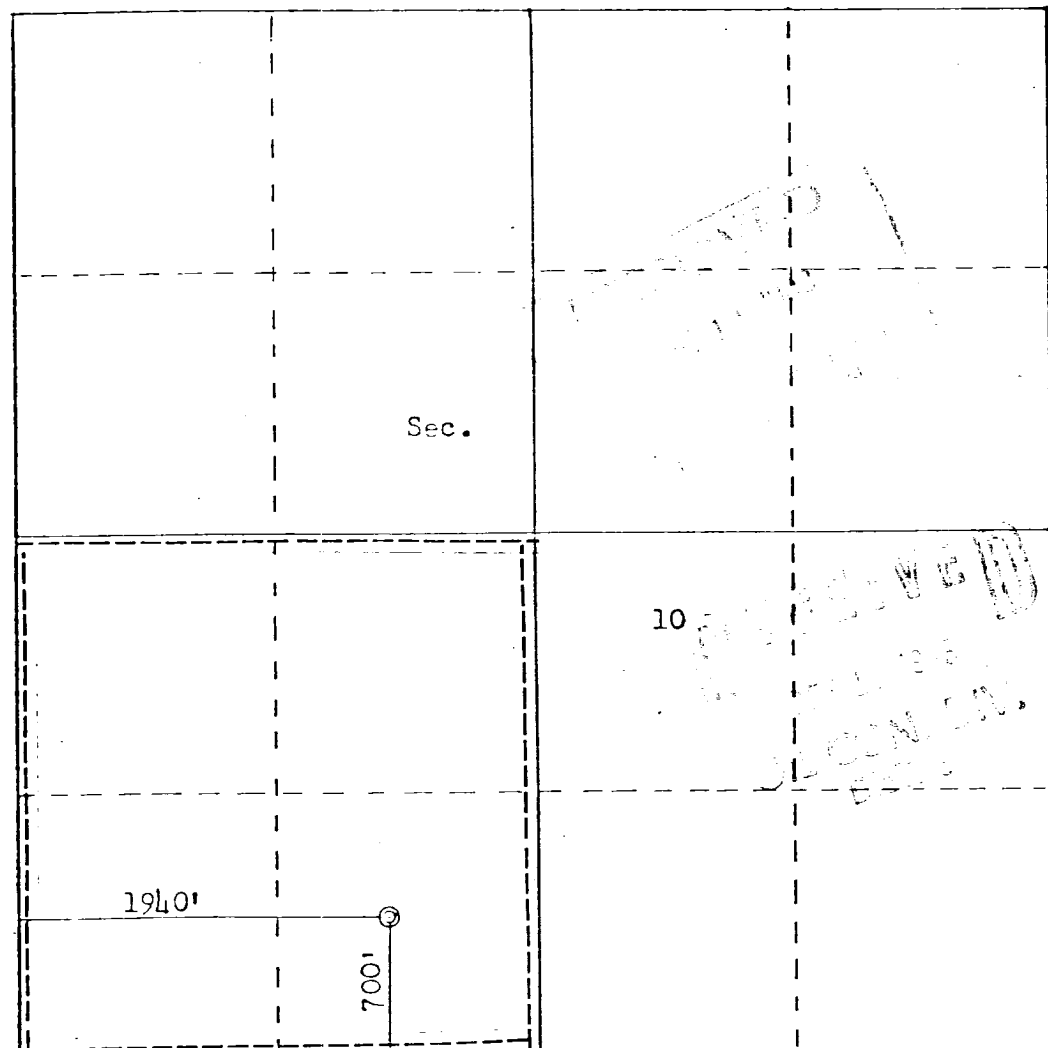

Scale: 1"=1000'

CERTIFICATION

I hereby certify that the information contained herein is true and complete to the best of my knowledge and belief.
For: Eastern States Exploration Co. Inc.

Name
Ewell N. Walsh, P.E.
Position
President
Company **Walsh Engineering & Production Corporation**
Date
August 9, 1983

I hereby certify that the well location shown on this plat was plotted from field notes of actual surveys made by me or under my supervision, and that the same is true and correct to the best of my knowledge and belief.

Date Surveyed **August 4, 1983**
Registered Professional Engineer and Land Surveyor
Fred B. Kerr Jr.
Certificate No. **3950**

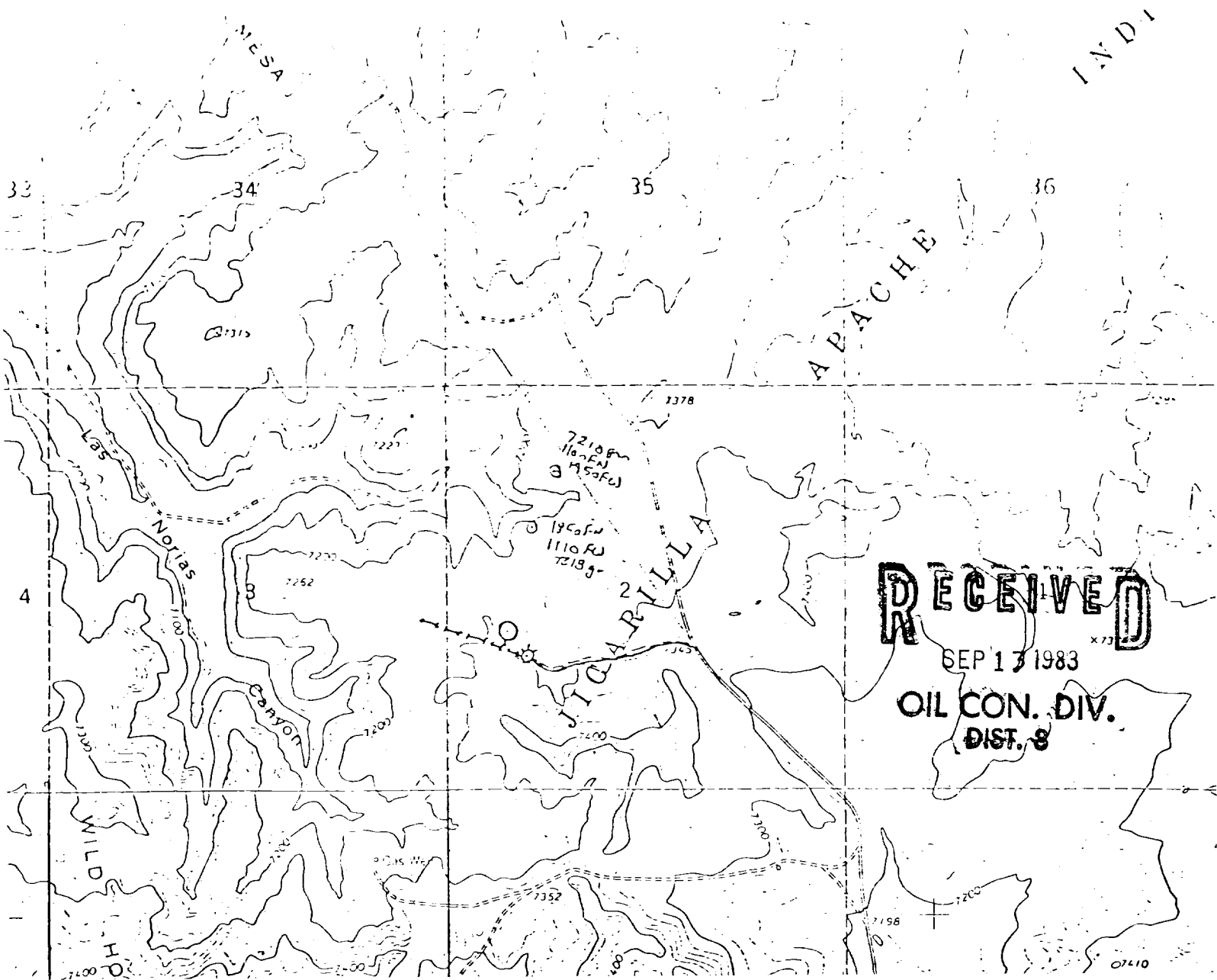

RECEIVED

SEP 17 1983

OIL CON. DIV.
DIST. 8