



STATE OF NEW MEXICO
ENERGY AND MINERALS DEPARTMENT
OIL CONSERVATION DIVISION

November 9, 1983

TONY ANAYA
GOVERNOR

POST OFFICE BOX 2088
STATE LAND OFFICE BUILDING
SANTA FE, NEW MEXICO 87501
(505) 827-5800

El Paso Exploration Company
P. O. Box 4289
Farmington, New Mexico 87499-4289

Attention: G. W. Brink

Administrative Order NSL-1756

Gentlemen:

Reference is made to your application for a non-standard location for your Canyon Largo Unit Well No. 324 located 1850 feet from the South line and 1465 feet from the West line of Section 20, Township 24 North, Range 6 West, NMPM, Devils Fork Gallup Associated Pool, Rio Arriba County, New Mexico.

By authority granted me under the provisions of Rule 2c of Order No. R-5353, the above-described unorthodox location is hereby approved.

Sincerely,

JOE D. RAMEY,
Director

JDR/RLS/dr

cc: Oil Conservation Division - Aztec
Oil & Gas Engineering Committee - Hobbs
Bureau of Land Management - Farmington

RECEIVED
NOV 17 1983
OIL CON. DIV. 1
DIST. 3



P. O. BOX 4289
FARMINGTON, NEW MEXICO 87499-4289
PHONE: 505-325-2841

October 14, 1983

New Mexico Oil Conservation Division
Post Office Box 2088
Santa Fe, New Mexico 87501

Att: Mr. Joe Ramey

Gentlemen:

This is a request for administrative approval for an unorthodox gas well location in the Devil's Fork Gallup Associated Pool.

It is intended to locate the El Paso Natural Gas Company's Canyon Largo Unit #324 at 1850' from the South line and 1465' from the West line of Section 20, T-24-N, R-6-W, Rio Arriba County, New Mexico.

Extremely rough terrain in the form of steep cliffs, an existing dry wash, and two pipelines in the southwest corner of this section makes it impossible to building an orthodox gas well location.

Copies of this application are being submitted to all offset operators by certified mail with a request that they furnish your Santa Fe office with a waiver of objection and return a copy to this office.

Plats showing the proposed well location and the terrain of Section 20, along with an ownership plat, are attached.

Sincerely yours,

G. W. Brink
Project Drilling Engineer

GWB:pb

WAIVER

_____ hereby waives objection to El Paso Natural Gas Company's application for an unorthodox location for their Canyon Largo Unit #324 as proposed above.

By: _____
Date: _____



P. O. BOX 4289
FARMINGTON, NEW MEXICO 87499-4289
PHONE: 505-325-2841

October 14, 1983

New Mexico Oil Conservation Division
Post Office Box 2088
Santa Fe, New Mexico 87501

Att: Mr. Joe Ramey

Gentlemen:

This is a request for administrative approval for an unorthodox gas well location in the Devil's Fork Gallup Associated Pool.

It is intended to locate the El Paso Natural Gas Company's Canyon Largo Unit #324 at 1850' from the South line and 1465' from the West line of Section 20, T-24-N, R-6-W, Rio Arriba County, New Mexico.

Extremely rough terrain in the form of steep cliffs, an existing dry wash, and two pipelines in the southwest corner of this section makes it impossible to building an orthodox gas well location.

Copies of this application are being submitted to all offset operators by certified mail with a request that they furnish your Santa Fe office with a waiver of objection and return a copy to this office.

Plats showing the proposed well location and the terrain of Section 20, along with an ownership plat, are attached.

Sincerely yours,

G. W. Brink
Project Drilling Engineer

GWB:pb

WAIVER

_____ hereby waives objection to El Paso Natural Gas Company's application for an unorthodox location for their Canyon Largo Unit #324 as proposed above.

By: _____
Date: _____



P. O. BOX 4289
FARMINGTON, NEW MEXICO 87499-4289
PHONE: 505-325-2841

October 14, 1983

New Mexico Oil Conservation Division
Post Office Box 2088
Santa Fe, New Mexico 87501

Att: Mr. Joe Ramey

Gentlemen:

This is a request for administrative approval for an unorthodox gas well location in the Devil's Fork Gallup Associated Pool.

It is intended to locate the El Paso Natural Gas Company's Canyon Largo Unit #324 at 1850' from the South line and 1465' from the West line of Section 20, T-24-N, R-6-W, Rio Arriba County, New Mexico.

Extremely rough terrain in the form of steep cliffs, an existing dry wash, and two pipelines in the southwest corner of this section makes it impossible to building an orthodox gas well location.

Copies of this application are being submitted to all offset operators by certified mail with a request that they furnish your Santa Fe office with a waiver of objection and return a copy to this office.

Plats showing the proposed well location and the terrain of Section 20, along with an ownership plat, are attached.

Sincerely yours,

G. W. Brink
Project Drilling Engineer

GWB:pb

WAIVER

_____ hereby waives objection to El Paso Natural Gas Company's application for an unorthodox location for their Canyon Largo Unit #324 as proposed above.

By: _____
Date: _____

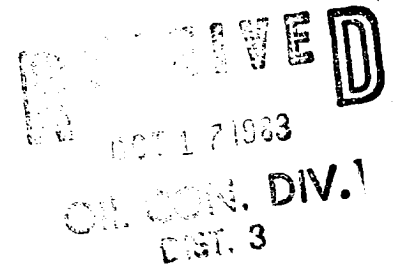

Offset operators for Canyon Largo Unit #324

E. B. Germany & Sons
PO Box 12266
Dallas, TX 75225

BCO, Inc.
135 Grant
Santa Fe, NM 87501

Getty Oil Co.
Three Park Central, Suite 700
1515 Arapahoe St.
Denver, CO 80202

RECEIVED
OCT 17 1983
OIL CON. DIV.
DIST. 3

EL PASO NATURAL GAS COMPANY

Well Name Canyon Largo Unit #324, Devils Fork Gallup

Footage----- 1850' FSL, 1465' FWL

APPLICATION FOR NON-STANDARD LOCATION

County Rio Arriba State New Mexico Section 20 Township 24N Range 6W

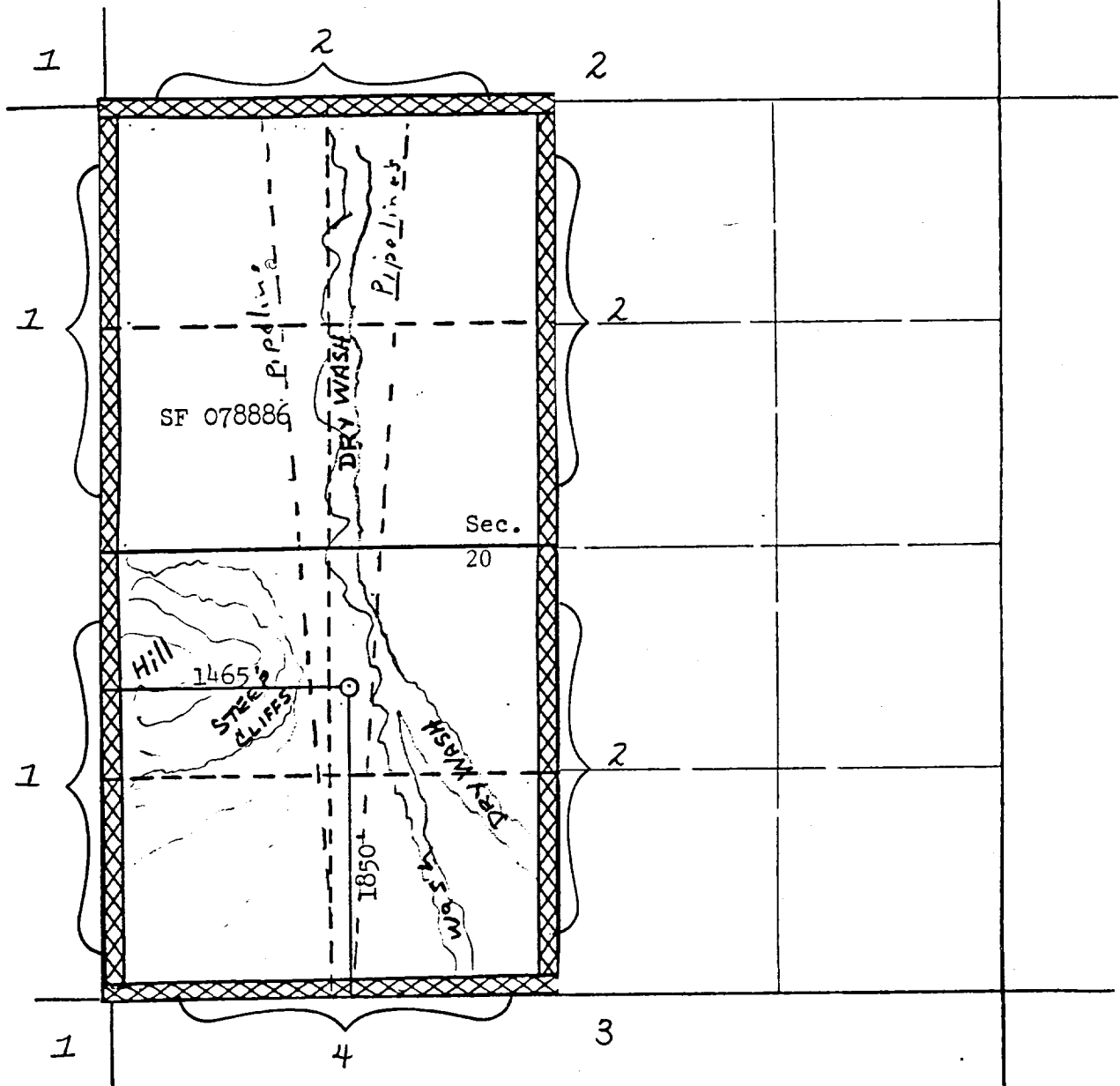

REMARKS:

- (1) E. B. Germany & Sons
- (2) Canyon Largo Unit, El Paso Natural Gas Company-Operator
- (3) Getty Oil Company
- (4) BCO, Inc.

RECEIVED
OCT 1 1974
GALLUP, N.M.