

UNITED STATES
DEPARTMENT OF THE INTERIOR
GEOLOGICAL SURVEY

APPLICATION FOR PERMIT TO DRILL, DEEPEN, OR PLUG BACK

1a. TYPE OF WORK
DRILL ☒ DEEPEN ☐ PLUG BACK ☐

b. TYPE OF WELL
OIL WELL ☒ GAS WELL ☐ OTHER ☐
SINGLE ZONE ☐ MULTIPLE ZONE ☐

2. NAME OF OPERATOR
Merrion Oil & Gas Corporation

3. ADDRESS OF OPERATOR
P. O. Box 1017, Farmington, New Mexico, 87499

4. LOCATION OF WELL (Report location clearly and in accordance with any State requirements.)
At surface 2060' FNL and 990' FWL
At proposed prod. zone Same

14. DISTANCE IN MILES AND DIRECTION FROM NEAREST TOWN OR POST OFFICE*
13 miles North of Counselors, New Mexico

15. DISTANCE FROM PROPOSED*
LOCATION TO NEAREST
PROPERTY OR LEASE LINE, FT.
(Also to nearest drlg. unit line, if any)

16. NO. OF ACRES IN LEASE
2552

17. NO. OF ACRES ASSIGNED
TO THIS WELL
160 175.60

18. DISTANCE FROM PROPOSED LOCATION*
TO NEAREST WELL, DRILLING, COMPLETED,
OR APPLIED FOR, ON THIS LEASE, FT.

19. PROPOSED DEPTH
6025

20. ROTARY OR CABLE TOOLS
Rotary

21. ELEVATIONS (Show whether DE, RT, GR, etc.)
6795' GL

22. APPROX. DATE WORK WILL START*
Winter, 1983

23. PROPOSED CASING AND CEMENTING PROGRAM

This action is subject to administrative
appeal pursuant to 30 CFR 290.

SIZE OF HOLE	SIZE OF CASING	WEIGHT PER FOOT	SETTING DEPTH	QUANTITY OF CEMENT
12-1/4"	8-5/8"	24 #/ft	200'	175 sx (360.5 cu. ft.)
7-7/8"	4-1/2"	10.5 #/ft.	6025'	900 sx (1098 cu. ft.)

We will drill a 12-1/4" hole to 200 ft. and set 200 ft. of 8-5/8", K-55, 24 #/ft. casing with 175 sx Class B cement with 3% CaCl₂. Will run open hole logs and if appears productive, will run 6025' of 4-1/2", K-55, 10.5 #/ft. casing and cement with 900 sx Class H cement, 50-50 Poz mix with 2% gel. Circulating medium will be clear water and clay. Will set stage collar at approximately 4770' KB and bring cement up across Ojo Alamo Formation. Will perforate and stimulate as required. Minimum specifications for pressure control equipment which is to be used - 10", 900 series double ram BOP.

Estimated Tops

Ojo Alamo	1765	Cliffhouse	3815	TD	6025
Kirtland	1915	Menefee	3915		
Fruitland	2165	Point Lookout	4460		
Pictured Cliffs	2325	Mancos	4770		
Lewis	2415	Gallup	5615		

IN ABOVE SPACE DESCRIBE PROPOSED PROGRAM: If proposal is to deepen or plug back, give data on present productive zone and proposed new productive zone. If proposal is to drill or deepen directionally, give pertinent data on subsurface locations and measured and true vertical depths. Give blowout preventer program, if any.

24.

SIGNED [Signature] TITLE Operations Manager DATE 9/20/83

(This space for Federal or State office use)

PERMIT NO.

APPROVED BY
CONDITIONS OF APPROVAL, IF ANY:

TITLE

RECEIVED

NOV 29 1983

OIL CON. DIV.]
NMOC DIST. 3

APPROVED
AS AMENDED

DATE

NOV 25 1983

M. MILLENBACH
AREA MANAGER

OIL CONSERVATION DIVISION

P. O. BOX 2088

SANTA FE, NEW MEXICO 87501

Form C-107
Revised 10-1-78STATE OF NEW MEXICO
ENERGY AND MINERALS DEPARTMENT

All distances must be from the outer boundaries of the Section.

Operator MERRION OIL & GAS CORPORATION			Lease CANYON LARGO UNIT		Well No. 333
Unit Letter E	Section 1	Township 24N	Range 7W	County Rio Arriba	
Actual Footage Location of Well:					
2060		feet from the North line and		990 feet from the West line	
Ground Level Elev: 6868	Producing Formation Gallup		Pool Devils Fork Gallup		Dedicated Acreage: 160 175.60 Acres

1. Outline the acreage dedicated to the subject well by colored pencil or hatchure marks on the plat below.
2. If more than one lease is dedicated to the well, outline each and identify the ownership thereof (both as to working interest and royalty).
3. If more than one lease of different ownership is dedicated to the well, have the interests of all owners been consolidated by communitization, unitization, force-pooling, etc?

☐ Yes ☐ No If answer is "yes," type of consolidation _____

If answer is "no," list the owners and tract descriptions which have actually been consolidated. (Use reverse side of this form if necessary.) _____

No allowable will be assigned to the well until all interests have been consolidated (by communitization, unitization, forced-pooling, or otherwise) or until a non-standard unit, eliminating such interests, has been approved by the Commis-

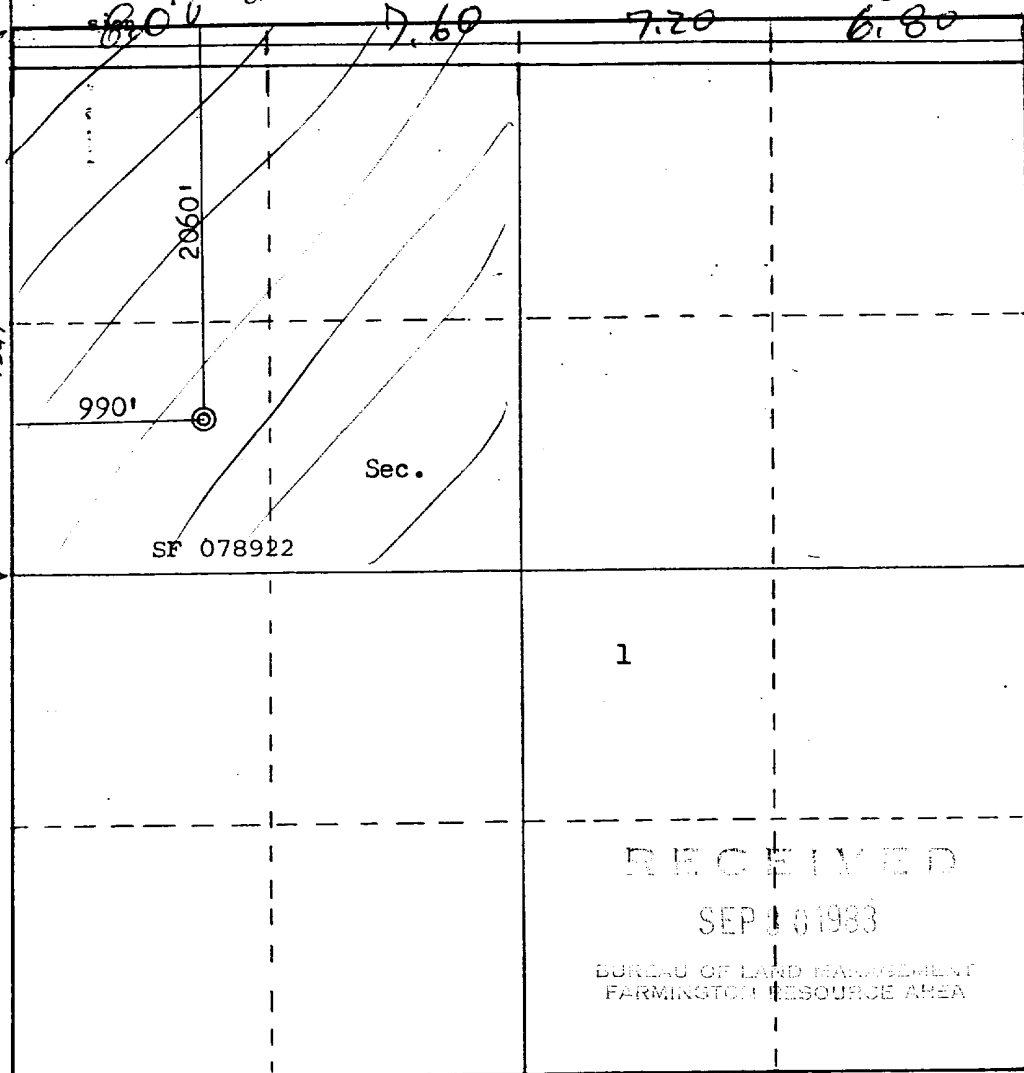

CERTIFICATION

I hereby certify that the information contained herein is true and complete to the best of my knowledge and belief.

Name

Steve S. Dunn

Position

Operations Manager

Company

Merrion Oil & Gas Corporation

Date

9/29/83

I hereby certify that the well location shown on this plat was plotted from field notes of actual surveys made by me or under my supervision, and that the same is true and correct to the best of my knowledge and belief.

Date Surveyed

September 27, 1983

Registered Professional Engineer and Land Surveyor.

Fred B. Kerr Jr.

Certificate No. 3950

Scale: 1"=1000'

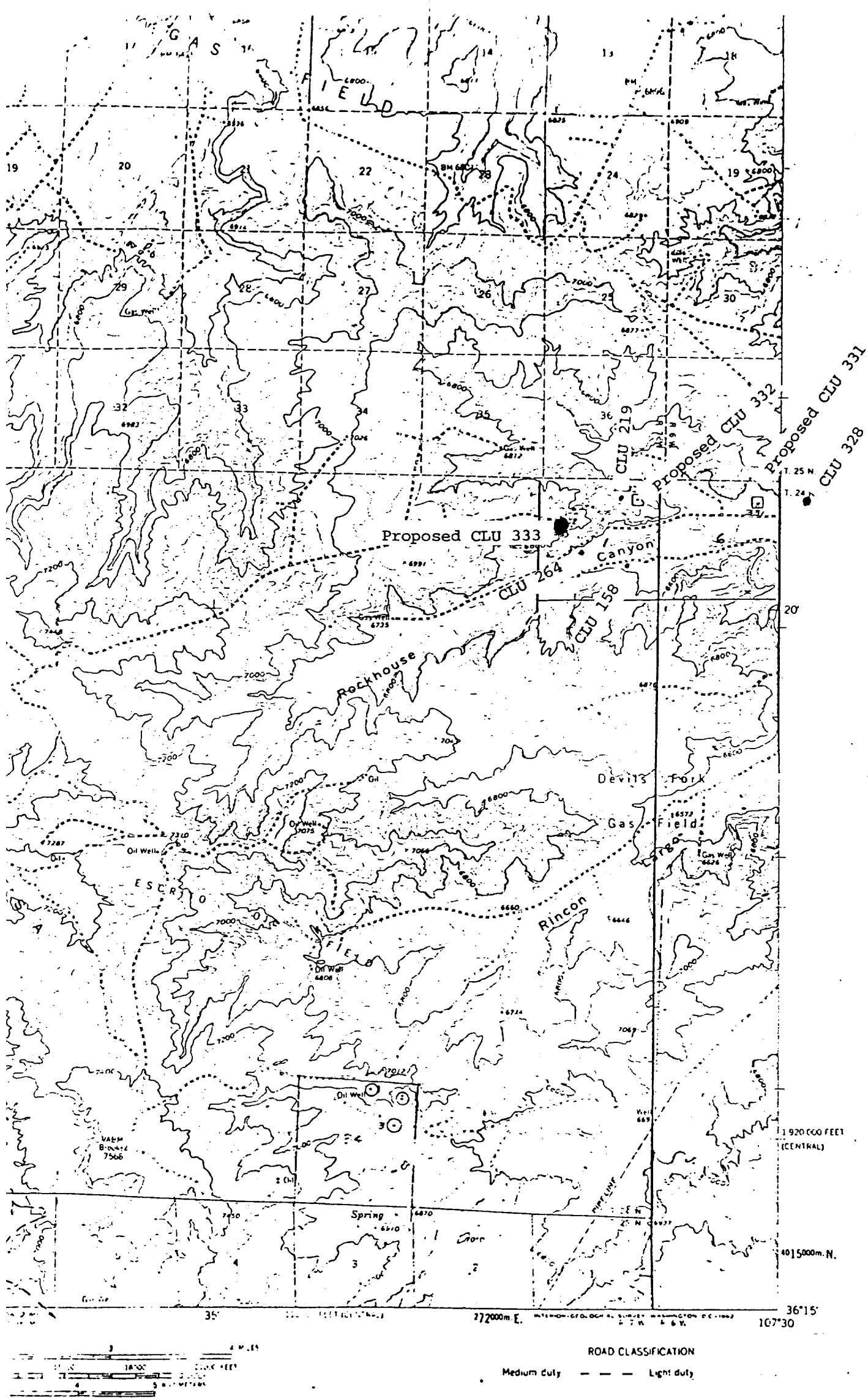

Vicinity Map for
 MERRION OIL & GAS CORP. #333 CANYON LARGO UNIT
 2060'FNL 990'FWL Sec. 1-T24N-R7W
 RIO ARriba COUNTY, NEW MEXICO

N. MEX.