

UNITED STATES
DEPARTMENT OF THE INTERIOR
GEOLOGICAL SURVEY

APPLICATION FOR PERMIT TO DRILL, DEEPEN, OR PLUG BACK

1a. TYPE OF WORK

DRILL ☒

DEEPEN ☐

PLUG BACK ☐

b. TYPE OF WELL

OIL
WELL ☒

GAS
WELL ☐

OTHER ☐

SINGLE
ZONE ☒

MULTIPLE
ZONE ☐

2. NAME OF OPERATOR

Robert L. Bayless

3. ADDRESS OF OPERATOR

P.O. Box 1541, Farmington, NM 87401

4. LOCATION OF WELL (Report location clearly and in accordance with any State requirements.)

At surface

975' FNL & 2290' FEL

At proposed prod. zone

same

14. DISTANCE IN MILES AND DIRECTION FROM NEAREST TOWN OR POST OFFICE*

15. DISTANCE FROM PROPOSED*
LOCATION TO NEAREST
PROPERTY OR LEASE LINE, FT.
(Also to nearest drig. unit line, if any)

18. DISTANCE FROM PROPOSED LOCATION*
TO NEAREST WELL, DRILLING, COMPLETED,
OR APPLIED FOR, ON THIS LEASE, FT.

21. ELEVATIONS (Show whether DF, RT, GR, etc.)

7345' GL

23.

PROPOSED CASING AND CEMENTING PROGRAM

SIZE OF HOLE	SIZE OF CASING	WEIGHT PER FOOT	SETTING DEPTH	QUANTITY OF CEMENT
12-1/4"	8-5/8"	30#	225'	89 ft ³ , circulated to surface
7-7/8"	4-1/2"	11.6#	8220'	413 ft ³ 1st stg., 472 ft ³ 2nd stg.

Will drill 12-1/4" hole to 225' and set 225' of 8-5/8", 20# new casing with 89 ft³ of Class "B" cement w/2% CaCl. Will drill 7-7/8" hole to 8220' to test Dakota formation. After logging will run 8220' of 4-1/2", 11.6#, J-55 new casing. Will set D.V. tool at 5000' and cement as follows: 1st stage 368 ft³ Class "B" with 2% econofil followed by 413 ft³ Class "B" neat cement; 2nd stage 735 ft³ Class "B" w/2% econofil followed by 472 ft³ Class "B" neat cement. Circulating medium will be clear water, natural mud and water loss control additives. No abnormal pressures or temperatures are anticipated. Blowout preventer schematic is attached. The gas from this formation is dedicated to a gas contract.

ESTIMATED TOPS

Pic. Cliffs	- 3788	Chacra	- 4640	Cliff House	- 5179
Menefee	- 5448	Point Lookout	- 5921	Gallup	- 6578
Green Horn	- 7872	Dakota	- 7960	T.D.	8220'

IN ABOVE SPACE DESCRIBE PROPOSED PROGRAM: If proposal is to deepen or plug back, give data on present productive zone and proposed new productive zone. If proposal is to drill or deepen directionally, give pertinent data on subsurface locations and measured and true vertical depths. Give blowout preventer program, if any.

24.

SIGNED

TITLE

Operator

DATE

10/18/82

(This space for Federal or State office use)

PERMIT NO.

APPROVAL DATE

APPROVED BY

TITLE

CONDITIONS OF APPROVAL, IF ANY:

APPROVED
AS AMENDED

DATE

OCT 28 1982

for JAMES F. SIMS
DISTRICT ENGINEER

OIL CONSERVATION DIVISION

P. O. BOX 2088

SANTA FE, NEW MEXICO 87501

Form C-107

Revised 10-1-78

STATE OF NEW MEXICO

ENERGY AND MINERALS DEPARTMENT

All distances must be from the outer boundaries of the Section.

Operator R. L. BAYLESS		Lease JICARILLA 65 B		Well No. 2
Unit Letter B	Section 16	Township 25N	Range 4W	County Rio Arriba
Actual Footage Location of Well: 975 feet from the North line and 2290 feet from the East line				
Ground Level Elev. 7345	Producing Formation West Lindriith Gal-Dakota		Pool West Lindriith Gallup-Dakota Ext	Dedicated Acreage: 160 Acres

1. Outline the acreage dedicated to the subject well by colored pencil or hatchure marks on the plat below.
2. If more than one lease is dedicated to the well, outline each and identify the ownership thereof (both as to working interest and royalty).
3. If more than one lease of different ownership is dedicated to the well, have the interests of all owners been consolidated by communitization, unitization, force-pooling, etc?

☐ Yes ☐ No If answer is "yes," type of consolidation _____

If answer is "no," list the owners and tract descriptions which have actually been consolidated. (Use reverse side of this form if necessary.) _____

No allowable will be assigned to the well until all interests have been consolidated (by communitization, unitization, forced-pooling, or otherwise) or until a non-standard unit, eliminating such interests, has been approved by the Commission.

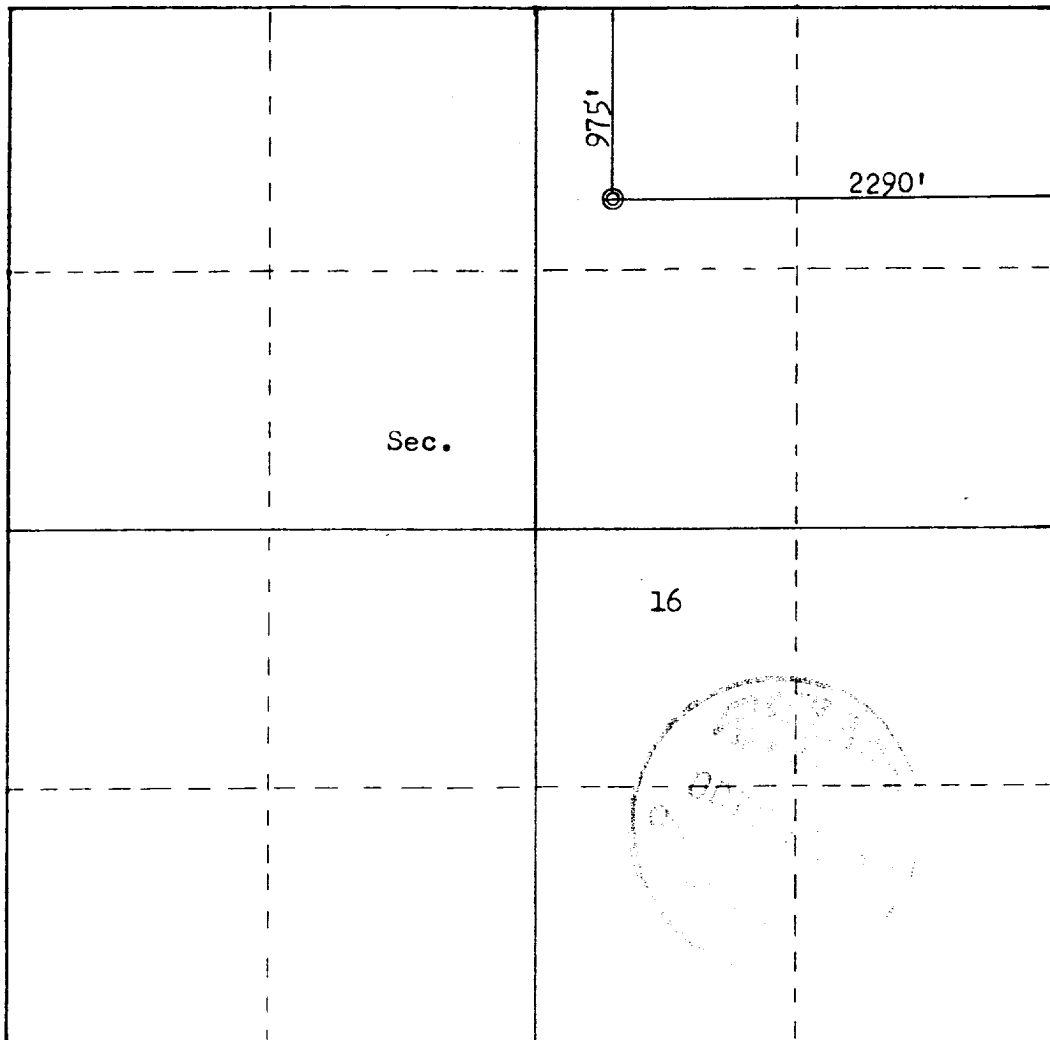

Scale: 1"=1000'

CERTIFICATION

I hereby certify that the information contained herein is true and complete to the best of my knowledge and belief.

Name

Robert L. Bayless

Position

Operator

Company

Robert L. Bayless

Date

October 6, 1982

I hereby certify that the well location shown on this plat was plotted from field notes of actual surveys made by me or under my supervision, and that the same is true and correct to the best of my knowledge and belief.

Date Surveyed

September 23, 1982

Registered Professional Engineer
and Land Surveyor
Fred B. Kerr Jr.

Certificate No.

3950

