

NO. OF COPIES RECEIVED	
DISTRIBUTION	
SANTA FE	
FILE	
U.S.G.S.	
LAND OFFICE	
OPERATOR	

NEW MEXICO OIL CONSERVATION COMMISSION

30-034-23464
Form C-101
Revised 1-1-65

5A. Indicate Type of Lease	
STATE <input type="checkbox"/>	FEE <input checked="" type="checkbox"/>
5. State Oil & Gas Lease No.	

APPLICATION FOR PERMIT TO DRILL, DEEPEN, OR PLUG BACK

1a. Type of Work		7. Unit Agreement Name	
b. Type of Well OIL WELL <input checked="" type="checkbox"/> GAS WELL <input type="checkbox"/> OTHER <input type="checkbox"/> DRILL <input checked="" type="checkbox"/> DEEPEN <input type="checkbox"/> PLUG BACK <input type="checkbox"/> SINGLE ZONE <input checked="" type="checkbox"/> MULTIPLE ZONE <input type="checkbox"/>		8. Farm or Lease Name W. O. Hughes	
2. Name of Operator MOBIL PRODUCING TX. & N.M. INC.		9. Well No. 7	
3. Address of Operator Nine Greenway Plaza, Suite 2700 Houston, TX 77046		10. Field and Pool, or Wildcat West Lindrieth Gallup-Dakota	
4. Location of Well UNIT LETTER H LOCATED 1650 FEET FROM THE North LINE AND 753 FEET FROM THE East LINE OF SEC. 8 TWP. 24N RGE. 3W NMPM		12. County Rio Arriba	
19. Proposed Depth 7700'		19A. Formation Gallup-Dakota	
20. Rotary or C.T. Rotary		21. Elevations (Show whether DF, RT, etc.) 6911' GL	
21A. Kind & Status Plug. Bond On File		21B. Drilling Contractor Unknown	
22. Approx. Date Work will start			

PROPOSED CASING AND CEMENT PROGRAM

SIZE OF HOLE	SIZE OF CASING	WEIGHT PER FOOT	SETTING DEPTH	SACKS OF CEMENT	EST. TOP
17-1/2"	13-3/8"	48# H-40	0 - 400	Circulate	Surface
12-1/4"	8-5/8"	24# K-55	0 - 2500	Circulate	Surface
		32# K-55	2500 - 3300		
6-1/2"	4-1/2"	10.5# K-55	0 - 7700	Circulate	Surface

BLOWOUT PREVENTER PROGRAM:

Casing String	Equipment Size & API Series	Number & Type	Test Pressure (psi)
Surface	13-5/8" x 3000#	1 Master Gate & 1 Pipe Ram	3000
Intermediate	9" x 3000#	1 Master Gate & 1 Pipe Ram	3000

APPROVAL EXPIRES 12-1-84
UNLESS DRILLING IS COMMENCED.
SPUD NOTICE MUST BE SUBMITTED
WITHIN 10 DAYS.

RECEIVED

JUN 01 1984

OIL CON. DIV.
DIST. 3

IN ABOVE SPACE DESCRIBE PROPOSED PROGRAM: IF PROPOSAL IS TO DEEPEN OR PLUG BACK, GIVE DATA ON PRESENT PRODUCTIVE ZONE AND PROPOSED NEW PRODUCTIVE ZONE. GIVE BLOWOUT PREVENTER PROGRAM, IF ANY.

I hereby certify that the information above is true and complete to the best of my knowledge and belief.

Signed A. D. Bond A. D. Bond Title Supervisor Date May 23, 1984

(This space for State Use)

APPROVED BY [Signature] TITLE SUPERVISOR DISTRICT # 3 DATE JUN 01 1984

CONDITIONS OF APPROVAL, IF ANY:

OIL CONSERVATION DIVISION

STATE OF NEW MEXICO
ENERGY AND MINERALS DEPARTMENTP. O. BOX 2088
SANTA FE, NEW MEXICO 87501Form C-102
Revised 10-1-78

All distances must be from the outer boundaries of the Section.

Operator MOBIL PRODUCING TX. & N.M. INC.			Lease W. O. Hughes		Well No. 7
Unit Letter H	Section 8	Township 24N	Range 3W	County Rio Arriba	
Actual Postage Location of Well:					
1650 feet from the North line and		753 feet from the East line			
Ground Level Elev. 6911'	Producing Formation Gallup-Dakota	Pool West Lindrith Gallup-Dakota	Dedicated Acreage: 160 Acres		

1. Outline the acreage dedicated to the subject well by colored pencil or hatchure marks on the plat below.
2. If more than one lease is dedicated to the well, outline each and identify the ownership thereof (both as to working interest and royalty).
3. If more than one lease of different ownership is dedicated to the well, have the interests of all owners been consolidated by communitization, unitization, force-pooling, etc?

☐ Yes ☐ No If answer is "yes," type of consolidation _____

If answer is "no," list the owners and tract descriptions which have actually been consolidated. (Use reverse side of this form if necessary.) _____

No allowable will be assigned to the well until all interests have been consolidated (by communitization, unitization, forced-pooling, or otherwise) or until a non-standard unit, eliminating such interests, has been approved by the Division.

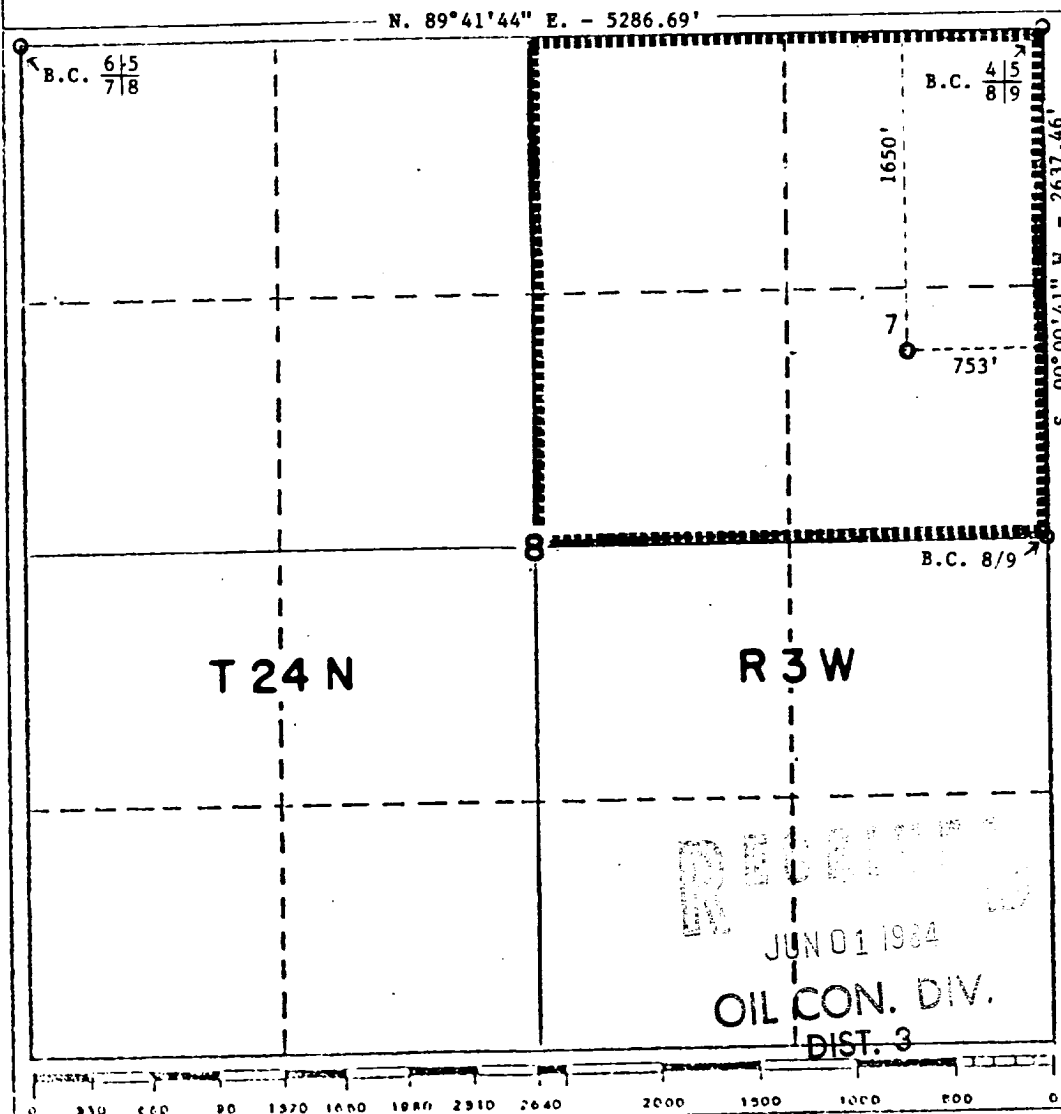

CERTIFICATION

I hereby certify that the information contained herein is true and complete to the best of my knowledge and belief.

Name A. D. Bond
Position Regulatory Technician Supervisor
Company Mobil Producing TX. & N.M. Inc.

Date May 23, 1984

I hereby certify that the well location shown on this plat was plotted from field notes of actual surveys made by me or under my supervision and that the same is true and correct to the best of my knowledge.

H. A. Carson, Jr.
Date Surveyed MAY 1, 1984
Registered Professional Engineer and/or Land Surveyor

H. A. Carson, Jr.
Certificate No. 5063

