

STATE OF NEW MEXICO
ENERGY AND MINERALS DEPARTMENT

OIL CONSERVATION DIVISION

P. O. BOX 2088
SANTA FE, NEW MEXICO 87501

Form C-101
Revised 10-1-78

NO. OF COPIES RECEIVED	
DISTRIBUTION	
SANTA FE	
FILE	
U.S.G.S.	
LAND OFFICE	
OPERATOR	

RECEIVED
SEP 21 1984
OIL CON. DIV.

5A. Indicate Type of Lease
STATE ☐ FEE ☒

5. State Oil & Gas Lease No.

APPLICATION FOR PERMIT TO DRILL, DEEPEN, OR PLUG BACK

1a. Type of Work b. Type of Well DRILL <input checked="" type="checkbox"/> DEEPEN <input type="checkbox"/> OIL WELL <input checked="" type="checkbox"/> GAS WELL <input type="checkbox"/> OTHER <input type="checkbox"/> SINGLE ZONE <input type="checkbox"/> MULTIPLE ZONE <input checked="" type="checkbox"/>		7. Unit Agreement Name
2. Name of Operator Merrion Oil & Gas Corporation		8. Form or Lease Name Krystina
3. Address of Operator P. O. Box 1017, Farmington, New Mexico 87499		9. Well No. 1
4. Location of Well UNIT LETTER L LOCATED 1850 FEET FROM THE South LINE AND 990 FEET FROM THE West LINE OF SEC. 14 TWP. 24N RGE. 2W NMPM		10. Field and Pool, or Wildcat Gallup/Dak. Gavilan Mancos Undes.
12. County Rio Arriba		
19. Proposed Depth 8080' KB	19A. Formation Mancos/Gallup/Dak.	20. Rotary or C.T. Rotary
21. Elevations (Show whether DF, RT, etc.) 7301' GL	21A. Kind & Status Plug. Bond Nationwide	21B. Drilling Contractor Unknown
		22. Approx. Date Work will start Fall, 1984

PROPOSED CASING AND CEMENT PROGRAM

SIZE OF HOLE	SIZE OF CASING	WEIGHT PER FOOT	SETTING DEPTH	SACKS OF CEMENT	EST. TOP
12-1/4"	9-5/8", J-55	32 #/ft.	300'	225 sx Class B	(148 cu. ft.)
8-3/4"					
7-7/8"	5-1/2", J-55	15.5 & 17 #/ft.	8080'	715 sx as below	

Propose to drill 12-1/4" hole to 300' and set 300' of 9-5/8", 32 #/ft, J-55 surface casing with 125 sx Class B (148 cu. ft.) cement, 3% CaCl₂. Will drill 8-3/4" hole to approximately 5000'. Will reduce to 7-7/8" hole to TD. Will run open hole logs. If well appears productive will run 5-1/2" 15.5 and 17 #/ft. J-55 casing to TD and cement in three stages. 1st Stage 300 sx Class H 2% gel (366 cu. ft.) to cover Gallup and Dakota. 2nd Stage - set stage tool @ 5734' and cement with 165 sx Class B 2% D-79 (340 cu. ft.) followed by 50 sx Class H (61 cu. ft.) 2% gel to cover Mesaverde. Third Stage Tool @ 3492' KB with 150 sx Class B (309 cu. ft.) 2% D-79 followed by 50 sx (61 cu. ft.) Class H 2% gel to cover Pictured Cliffs, Fruitland, Kirtland, and Ojo Alamo. Will perforate and stimulate the Gallup and Dakota as necessary. 10" 900 series Double Ram Preventers will be used in drilling.

Drilling circulating medium will be low solids, non-dispersed, low water loss mud using Bentonite, Starch, CMC and fresh water.

Estimated tops on back.

Lost circulation is expected.

APPROVAL EXPIRES 3-21-85
UNLESS DRILLING IS COMMENCED.
SPUD NOTICE MUST BE SUBMITTED
WITHIN 10 DAYS

IN ABOVE SPACE DESCRIBE PROPOSED PROGRAM: IF PROPOSAL IS TO DEEPEN OR PLUG BACK, GIVE DATA ON PRESENT PRODUCTIVE ZONE AND PROPOSED NEW PRODUCTIVE ZONE. GIVE BLOWOUT PREVENTER PROGRAM, IF ANY.

I hereby certify that the information above is true and complete to the best of my knowledge and belief.

Signed [Signature] Title Operations Manager Date 9/18/84

(This space for State Use)

APPROVED BY [Signature]
CONDITIONS OF APPROVAL, IF ANY:

SUPERVISOR DISTRICT # 3

DATE

SEP 21 1984

ESTIMATED TOPS

Ojo Alamo	2420
Kirtland	2460
Fruitland	2890
Pictured Cliffs	3292
Cliffhouse	5020
Menefee	5120
Point Lookout	5520
Mancos	5734
Gallup	6714
Greenhorn	7614
Dakota	7724
Total Depth	8080

All distances must be from the outer boundaries of the Section.

Operator MERRION OIL & GAS CORPORATION			Lease KRYSTINA COM		Well No. 1
Unit Letter L	Section 14	Township 24N	Range 2W	County Rio Arriba	
Actual Footage Location of Well: 1850 feet from the South line and 990 feet from the West line					
Ground Level Elev: 7301	Producing Formation Mancos/Gallup/Dakota	Pool Gabilan Mancos, Undes. Gal/Dak.		Dedicated Acreage 320 40/100 Acres	

1. Outline the acreage dedicated to the subject well by colored pencil or hatchure marks on the plat below.
2. If more than one lease is dedicated to the well, outline each and identify the ownership thereof (both as to working interest and royalty).
3. If more than one lease of different ownership is dedicated to the well, have the interests of all owners been consolidated by communitization, unitization, force-pooling, etc?

☒ Yes ☐ No If answer is "yes," type of consolidation will be communitized

If answer is "no," list the owners and tract descriptions which have actually been consolidated. (Use reverse side of this form if necessary.)

No allowable will be assigned to the well until all interests have been consolidated (by communitization, unitization, forced-pooling, or otherwise) or until a non-standard unit, eliminating such interests, has been approved by the Commission.

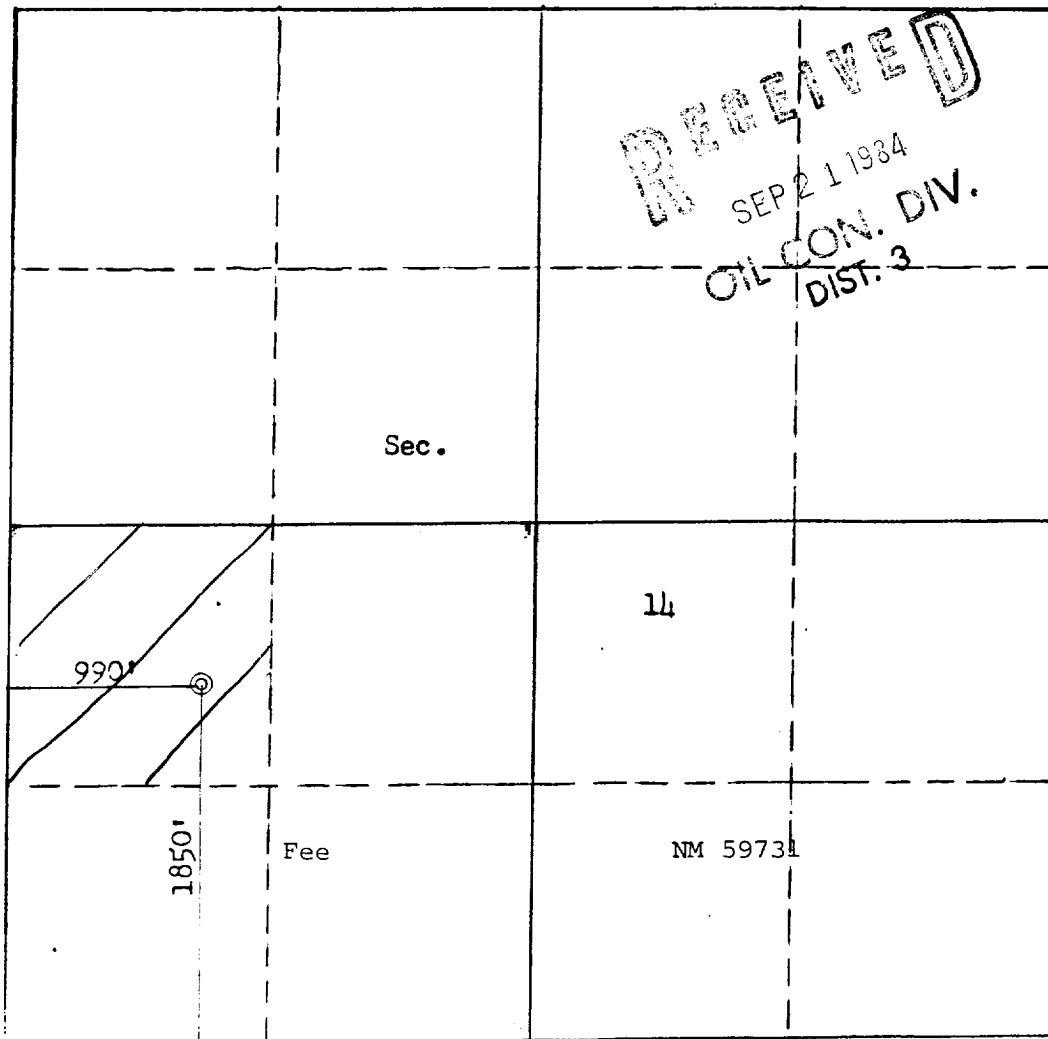

CERTIFICATION

I hereby certify that the information contained herein is true and complete to the best of my knowledge and belief.

Steve S. Dunn
Name

Steve S. Dunn

Position

Operations Manager

Company

Merrion Oil & Gas Corporation

Date

9/18/84

I hereby certify that the well location shown on this plat was plotted from field notes of actual surveys made by me or under my supervision, and that the same is true and correct to the best of my knowledge and belief.

Date Surveyed

September 15, 1984

Registered Professional Engineer and Land Surveyor

Fred B. Kerr Jr.
Fred B. Kerr Jr.

Certificate No.

3950

Scale: 1"=1000'

