

F

30-039-22890

1-15-82

F. Loc. 2010/N;1720/E Elev. 6470 GL Spd. Comp. TD PB

Casing S. @ W Sx Int. @ W Sx Pr. @ W Sx T. @
Csg. Perf. Prod. Stim.T
R
A
N
S

I.P. BO/D MCF/D After Hrs. SICP PSI After Days GOR Grav. 1st Del. s

TOPS	NIID X	Well Log	TEST DATA							Ref.No.
Kirtland	C-103 ✓	Plat X	Schd.	PC	Q	PW	PD	D		
Fruitland	C-104	Electric Log								
Pictured Cliffs		C-122								
Cliff House	Ditr	Dfa								
Menefee	Datr	Dac								
Point Lookout	178.95									
Mancos										
Gallup										
Sanostee										
Greenhorn										
Dakota										
Morrison										
Entrada										

p
o

Devils Fork Co. RA S 5 T 24N R 6W UG Oper Merrion O & G Corp. Lse. Canyon Largo Unit No. 308

Canyon Largo Unit #308

G-5-24N-6W

MERRION OIL & GAS CORP.

CALLER SERVICE 4104
FARMINGTON, NEW MEXICO 87499

NOV 01 1983

CERTIFIED

Merrion Oil and Gas Corporation
P.O. Box 1017
Farmington, New Mexico 87499

RECEIVED

NOV 2 - 1983

OIL CON. DIV.
DIST. 3

Gentlemen:

Reference is made to your Applications for Permit (APDs) for the following wells:

- 1) 307 Canyon Largo Unit, NE $\frac{1}{4}$ SE $\frac{1}{4}$ sec. 11, T. 24 N., R. 6 W., Rio Arriba County, New Mexico, lease Santa Fe 078577.
- 2) 308 Canyon Largo Unit, SW $\frac{1}{4}$ NE $\frac{1}{4}$ sec. 5, T. 24 N., R. 6 W., Rio Arriba County, New Mexico, lease Santa Fe 078874.
- 3) 309 Canyon Largo Unit, SW $\frac{1}{4}$ NW $\frac{1}{4}$ sec. 4, T. 24 N., R. 6 W., Rio Arriba County, New Mexico, lease Santa Fe 078874.
- 4) 2 Stephenson, NW $\frac{1}{4}$ SE $\frac{1}{4}$ sec. 7, T. 25 N., R. 8 W., San Juan County, New Mexico, lease Santa Fe 078475.
- 5) 1 SOB Federal, SW $\frac{1}{4}$ NW $\frac{1}{4}$ sec. 8, T. 25 N., R. 8 W., San Juan County, New Mexico, lease NM-47169.

As discussed with Ann Miller of your company on October 20 and 27, 1983, the subject APD's are rescinded and returned due to drilling operations not being commenced within a six month extension period following the original approval date.

You are required to request surface rehabilitation instructions from this office if construction activities occurred on the reference drill sites. If this office does not receive comment within 15 days, it will presume that no construction occurred and proceed accordingly. Later discovery that construction activities have in fact occurred, will result in assessment of liquidated damages.

Sincerely yours,

Area Manager

cc: NMOC/D

UNITED STATES
DEPARTMENT OF THE INTERIOR
GEOLOGICAL SURVEY

30-039-22890

APPLICATION FOR PERMIT TO DRILL, DEEPEN, OR PLUG BACK

1a. TYPE OF WORK DRILL <input checked="" type="checkbox"/> DEEPEN <input type="checkbox"/> PLUG BACK <input type="checkbox"/>				5. LEASE DESIGNATION AND SERIAL NO. SF-078874 & SF-078957	
b. TYPE OF WELL OIL WELL <input checked="" type="checkbox"/> GAS WELL <input type="checkbox"/> OTHER <input type="checkbox"/> SINGLE ZONE <input checked="" type="checkbox"/> MULTIPLE ZONE <input type="checkbox"/>				6. IF INDIAN, ALLOTTEE OR TRIBE NAME	
2. NAME OF OPERATOR J. Gregory Merrion & Robert L. Bayless				7. UNIT AGREEMENT NAME	
3. ADDRESS OF OPERATOR P.O. Box 507, Farmington, NM 87401				8. FARM OR LEASE NAME Canyon Largo Unit	
4. LOCATION OF WELL (Report location clearly and in accordance with any State requirements.)* At surface 2010 FNL & 1720 FEL				9. WELL NO. 308	
At proposed prod. zone same				10. FIELD AND POOL, OR WILDCAT Devils Fork Gallup	
14. DISTANCE IN MILES AND DIRECTION FROM NEAREST TOWN OR POST OFFICE*				11. SEC., T., R., M., OR BLK. AND SURVEY OR AREA G Sec. 5, T24N, R6W	
15. DISTANCE FROM PROPOSED* LOCATION TO NEAREST PROPERTY OR LEASE LINE, FT. (Also to nearest drlg. unit line, if any)		16. NO. OF ACRES IN LEASE 2559		17. NO. OF ACRES ASSIGNED TO THIS WELL 178.95	
18. DISTANCE FROM PROPOSED LOCATION* TO NEAREST WELL, DRILLING, COMPLETED, OR APPLIED FOR, ON THIS LEASE, FT.		19. PROPOSED DEPTH 5665'		20. ROTARY OR CABLE TOOLS Rotary	
21. ELEVATIONS (Show whether DF, RT, GR, etc.) 6470 Ground				22. APPROX. DATE WORK WILL START* August 15, 1981	
23. GENERAL REQUIREMENTS This action is subject to administrative appeal pursuant to 30 CFR 290.					
SIZE OF HOLE	SIZE OF CASING	WEIGHT PER FOOT	SETTING DEPTH		
12-1/4"	8-5/8"	24#	200'	150 sacks	
7-7/8"	4-1/2"	10.5#	5665'	500 sacks	

Will drill 12-1/4" hole to 200 ft. and set 200 ft. of 8-5/8", K-55, 24#, used casing with 150 sacks Class B cement w/3% CACL₂. Will run open hole logs and if appears productive will run 5665' of 4-1/2", K-55, 10.5#, used casing and cement with 500 sacks Class H cement, 50-50 pozmix w/2% gel. Circulating medium will be clear water and clay. Will set stage collar at approximately 4250 ft. and bring cement up across Ojo Alamo formation. Will perforate and stimulate as required. Minimum specifications for pressure control equipment which is to be used. 10", 900 series double ram BOP.

ESTIMATED TOPS

San Jose-----Surface
Ojo Alamo-----1480'
Kirtland-----1770'
Fruitland-----1890'
Pic. Cliffs---2110'

Cliff House-----3630'
Point Lookout----4317'
Gallup-----5400'

IN ABOVE SPACE DESCRIBE PROPOSED PROGRAM: If proposal is to deepen or plug back, give data on present productive zone and proposed new productive zone. If proposal is to drill or deepen directionally, give pertinent data on subsurface locations and measured and true vertical depths. Give blowout preventer program, if any.

24.

SIGNED [Signature] TITLE Operator DATE July 10, 1981

(This space for Federal or State office use)

PERMIT NO. _____ APPROVAL DATE _____

APPROVED BY _____ TITLE _____

CONDITIONS OF APPROVAL, IF ANY:

Needs NWU from Aztec Office Hold C104 for it

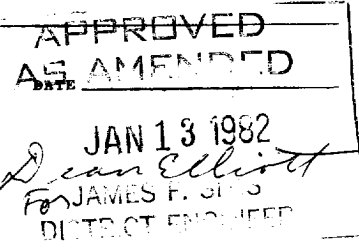
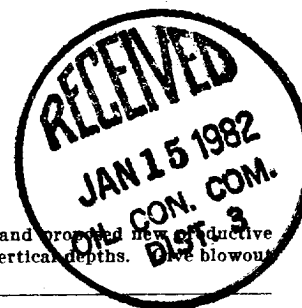

NMOC

NEW MEXICO OIL CONSERVATION COMMISSION
WELL LOCATION AND ACREAGE DEDICATION PLAT

Form C-102
Supersedes C-128
Effective 1-1-65

All distances must be from the outer boundaries of the Section.

Merrion & Bayless		Lease CANYON LARGO UNIT		Well No. 308	
Section 5	Township 24N	Range 6W	County Rio Arriba		
Actual Footage Location of Well: North					
2010 feet from the		line and 1720		feet from the East	
Ground Level Elev: 6470	Producing Formation Gallup	Pool Devils Fork Gallup		Dedicated Acreage: 178.95 Acres	

1. Outline the acreage dedicated to the subject well by colored pencil or hatchure marks on the plat below.
2. If more than one lease is dedicated to the well, outline each and identify the ownership thereof (both as to working interest and royalty). Both leases have identical ownership.
3. If more than one lease of different ownership is dedicated to the well, have the interests of all owners been consolidated by communitization, unitization, force-pooling, etc?

☐ Yes ☐ No If answer is "yes," type of consolidation _____

If answer is "no," list the owners and tract descriptions which have actually been consolidated. (Use reverse side of this form if necessary.) _____

No allowable will be assigned to the well until all interests have been consolidated (by communitization, unitization, forced-pooling, or otherwise) or until a non-standard unit, eliminating such interests, has been approved by the Commission.

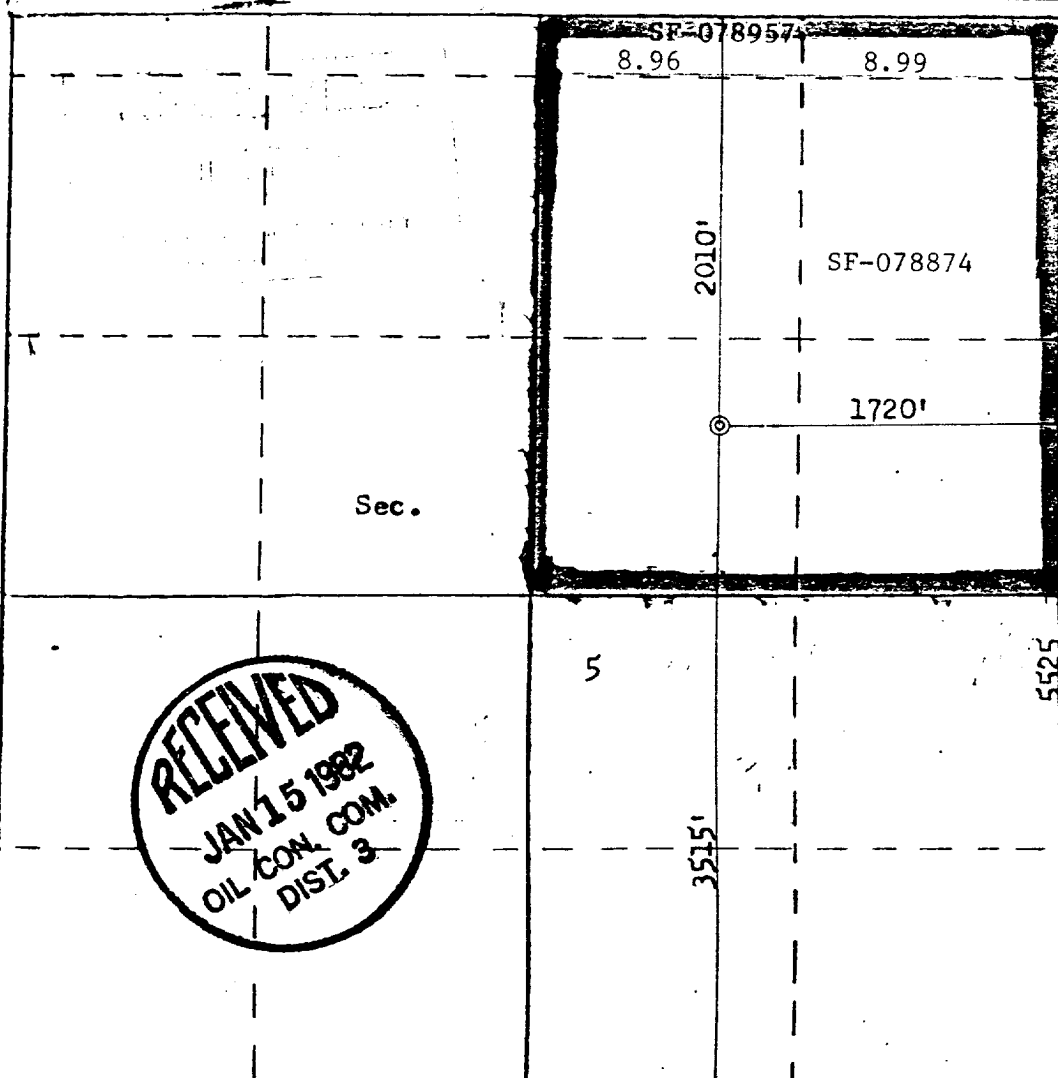

CERTIFICATION

I hereby certify that the information contained herein is true and complete to the best of my knowledge and belief.

Robert L. Bayless

Name
Robert L. Bayless

Position
Co-Owner

Company
Merrion & Bayless

Date
July 10, 1981

I hereby certify that the well location shown on this plat was plotted from field notes of actual surveys made by me or under my supervision, and that the same is true and correct to the best of my knowledge and belief.

Date Surveyed
June 23, 1981

Registered Professional Engineer and Land Surveyor
00000
N.M.
04
Certified



UNITED STATES
DEPARTMENT OF THE INTERIOR
GEOLOGICAL SURVEY

SUNDRY NOTICES AND REPORTS ON WELLS

(Do not use this form for proposals to drill or to deepen or plug back to a different reservoir. Use Form 9-331-C for such proposals.)

1. oil ☒ well gas ☐ well other

2. NAME OF OPERATOR
Merrion Oil & Gas Corporation

3. ADDRESS OF OPERATOR
P. O. Box 1017, Farmington, New Mexico 87499

4. LOCATION OF WELL (REPORT LOCATION CLEARLY. See space 17 below.)
AT SURFACE: 3515' E&L and 1720' FEL
AT TOP PROD. INTERVAL: Same
AT TOTAL DEPTH: Same

16. CHECK APPROPRIATE BOX TO INDICATE NATURE OF NOTICE, REPORT, OR OTHER DATA

REQUEST FOR APPROVAL TO:

TEST WATER SHUT-OFF ☐
FRACTURE TREAT ☐
SHOOT OR ACIDIZE ☐
REPAIR WELL ☐
PULL OR ALTER CASING ☐
MULTIPLE COMPLETE ☐
CHANGE ZONES ☐
ABANDON* ☐

(other) Extension of APD

SUBSEQUENT REPORT OF

☐
☐
☐
☐
☐
☐
☐
☐

RECEIVED
DEC 23 1982

(No report results of multiple completion or zone change on Form 9-330.)
U. S. GEOLOGICAL SURVEY
FARMINGTON, N. M.

5. LEASE
SF 078874

6. IF INDIAN, ALLOTTEE OR TRIBE NAME

7. UNIT AGREEMENT NAME

8. FARM OR LEASE NAME
Canyon Largo Unit

9. WELL NO.
308

10. FIELD OR WILDCAT NAME
Devils Fork Gallup

11. SEC., T., R., M., OR BLK. AND SURVEY OR AREA
Sec. 5, T24N, R6W

12. COUNTY OR PARISH
Rio Arriba

13. STATE
New Mexico

14. API NO.

15. ELEVATIONS (SHOW DF, KDB, AND WD)

17. DESCRIBE PROPOSED OR COMPLETED OPERATIONS (Clearly state all pertinent details, and give pertinent dates, including estimated date of starting any proposed work. If well is directionally drilled, give subsurface locations and measured and true vertical depths for all markers and zones pertinent to this work.)*

Please extend the Application for Permit to Drill for another six months.

extended to 7/13/83

RECEIVED
DEC 30 1982
GEOLOGICAL SURVEY
FARMINGTON, N. M.

Subsurface Safety Valve: Manu. and Type

Set @ Ft.

18. I hereby certify that the foregoing is true and correct

SIGNED [Signature] TITLE Operations Manager DATE 12/22/82

(This space for Federal or State office use)

APPROVED BY
CONDITIONS OF APPROVAL, IF ANY:

TITLE

APPROVED
~~AS AMENDED~~

*See Instructions on Reverse Side

NMOCG

DEC 28 1982
[Signature]
JAMES F. SIMS
DISTRICT ENGINEER

UNITED STATES
DEPARTMENT OF THE INTERIOR
GEOLOGICAL SURVEY

SUNDRY NOTICES AND REPORTS ON WELLS

(Do not use this form for proposals to drill or to deepen or plug back to a different reservoir. Use Form 9-331-C for such proposals.)

1. oil well ☒ gas well ☐ other

2. NAME OF OPERATOR
Merrion Oil & Gas Corporation

3. ADDRESS OF OPERATOR
P. O. Box 1017, Farmington, New Mexico 87499

4. LOCATION OF WELL (REPORT LOCATION CLEARLY. See space 17 below.) 2010 N 11500 E

AT TOP PROD. INTERVAL: Same
AT TOTAL DEPTH: Same

16. CHECK APPROPRIATE BOX TO INDICATE NATURE OF NOTICE,
REPORT, OR OTHER DATA

REQUEST FOR APPROVAL TO:

TEST WATER SHUT-OFF	<input type="checkbox"/>
FRACTURE TREAT	<input type="checkbox"/>
SHOOT OR ACIDIZE	<input type="checkbox"/>
REPAIR WELL	<input type="checkbox"/>
PULL OR ALTER CASING	<input type="checkbox"/>
MULTIPLE COMPLETE	<input type="checkbox"/>
CHANGE ZONES	<input type="checkbox"/>
ABANDON*	<input type="checkbox"/>
(other) Extension of APD	<input type="checkbox"/>

~~SUBSEQUENT REPORT~~

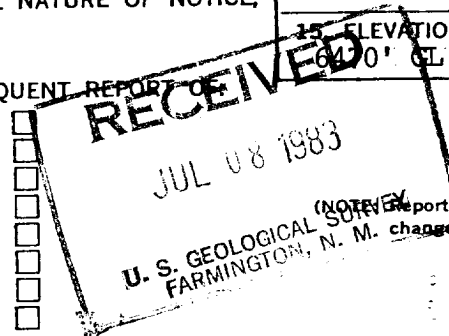

5. LEASE
SF 078874

6. IF INDIAN, ALLOTTEE OR TRIBE NAME,

7. UNIT AGREEMENT NAME

8. FARM OR LEASE NAME
Canyon Largo Unit

9. WELL NO.
308

10. FIELD OR WILDCAT NAME
Devils Fork Gallup

11. SEC., T., R., M., OR BLK. AND SURVEY OR
AREA
Sec. 5, T24N, R6W

12. COUNTY OR PARISH	13. STATE
Rio Arriba	New Mexico

14. API NO.

15. ELEVATIONS (SHOW DF, KDB, AND WD)
6470' CL

17. DESCRIBE PROPOSED OR COMPLETED OPERATIONS (Clearly state all pertinent details, and give pertinent dates, including estimated date of starting any proposed work. If well is directionally drilled, give subsurface locations and measured and true vertical depths for all markers and zones pertinent to this work.)*

Please extend the Application for Permit to Drill for another six months.

extended to 10/13/83

Subsurface Safety Valve: Manu. and Type

Set @ _____ Ft.

18. I hereby certify that the foregoing is true and correct

SIGNED The [Signature] TITLE Operations Manager DATE 11/1/2011

(This space for Federal or State office use)

APPROVED BY _____ TITLE _____ DATE _____
CONDITIONS OF APPROVAL, IF ANY: _____

***See Instructions on Reverse Side**

NMOCC

APPROVED

~~AS AMENDED~~

AUG 10 1983

R. Bingham
 AREA MANAGER
 FARMINGTON RESOURCE AREA