

UNITED STATES
DEPARTMENT OF THE INTERIOR
BUREAU OF LAND MANAGEMENT

APPLICATION FOR PERMIT TO DRILL, DEEPEN, OR PLUG BACK

1a. TYPE OF WORK

DRILL ☒

DEEPEN ☐

PLUG BACK ☐

b. TYPE OF WELL

OIL
WELL ☒

GAS
WELL ☐

OTHER

SINGLE
ZONE ☐

MULTIPLE
ZONE ☐

2. NAME OF OPERATOR

Cotton Petroleum Corporation

3. ADDRESS OF OPERATOR

3773 Cherry Creek Drive No., #750, Denver, Colorado 80209

4. LOCATION OF WELL (Report location clearly and in accordance with any State requirements.)*
At surface

3006' FNL 2171' FEL, Sec 2 T24N

At proposed prod. zone

14. DISTANCE IN MILES AND DIRECTION FROM NEAREST TOWN OR POST OFFICE*

BUREAU OF LAND MANAGEMENT
FARMINGTON RESOURCE AREA

10. DISTANCE FROM PROPOSED*

LOCATION TO NEAREST
PROPERTY OR LEASE LINE, FT.
(Also to nearest drlg. unit line, if any)

16. NO. OF ACRES IN LEASE

2665

17. NO. OF ACRES ASSIGNED
TO THIS WELL

222.00

18. DISTANCE FROM PROPOSED LOCATION*
TO NEAREST WELL, DRILLING, COMPLETED,
OR APPLIED FOR, ON THIS LEASE, FT.

19. PROPOSED DEPTH

7680'

20. ROTARY OR CABLE TOOLS

Rotary

21. ELEVATIONS (Show whether DF, RT, GR, etc.)

GR 6959'

DRILLING OPERATIONS AUTHORIZED ARE
SUBJECT TO COMPLIANCE WITH ATTACHED
"GENERAL REQUIREMENTS"

22. APPROX. DATE WORK WILL START*

12-15-84

23. PROPOSED CASING AND CEMENTING PROGRAM

This action is subject to administrative
appeal pursuant to 30 CFR 290.

SIZE OF HOLE	SIZE OF CASING	WEIGHT PER FOOT	SETTING DEPTH	QUANTITY OF CEMENT
12-1/4"	8-5/8"	24#	300'	300 sxs
7-7/8"	4-1/2"	10.5#	7680'	1210 sxs or sufficient vol to cover Ojo Alamo @ approx 2666'

Log Gallup and Dakota for potential hydrocarbon. EXHIBITS ATTACHED

1. Location Plat
2. Drilling Prognosis
3. Surface use Plan
4. Surface Casing Cement
5. Production Casing Cement
6. Schematic Diagram of Rig BOP
7. BOP Test Procedure
8. Rig Layout & Inventory
9. Existing & Planned Access Roads and Water Supply
10. Existing Wells - One Mile Radius
11. Existing or Proposed Facilities - One Mile Radius
12. Detailed Location Plat of Production Facilities
13. Well Site Layout
14. Drill Pad Layout with Elevations
15. Cross Sections of Planned Cut & Fill Across Location
16. Archaeological/Cultural Resource Inventory
17. Lease Special Stipulations

IN ABOVE SPACE DESCRIBE PROPOSED PROGRAM: If proposal is to deepen or plug back, give data on present productive zone and proposed new productive zone. If proposal is to drill or deepen directionally, give pertinent data on subsurface locations and measured and true vertical depths. Give blowout preventer program, if any.

24. SIGNED [Signature] TITLE Division Prod. Mgr.

(This space for Federal or State office use)

PERMIT NO.

APPROVAL DATE

APPROVED BY

TITLE

CONDITIONS OF APPROVAL, IF ANY:

EEB 071985

OIL CON. DIV.
DIST. 3

*See Instructions On Reverse Side

APPROVED
AS AMENDED

JAN 22 1985

AREA MANAGER
FARMINGTON RESOURCE AREA

Operator COTTON PETROLEUM CORPORATION			Lease JICARILLA CONTRACT # 126 Apache		Well No. 143
Unit Letter G	Section 2	Township 24 NORTH	Range 4 WEST	County RIO ARRIBA	
Actual Postage Location of Well:					
3006		feet from the NORTH line and		2171	feet from the EAST line
Ground Level Elev. 6959	Producing Formation		Pool West Lindrith Gallup-Dakota		Dedicated Acreage: 160.222 Acres

1. Outline the acreage dedicated to the subject well by colored pencil or hachure marks on the plat below.
2. If more than one lease is dedicated to the well, outline each and identify the ownership thereof (both as to working interest and royalty).
3. If more than one lease of different ownership is dedicated to the well, have the interests of all owners been consolidated by communitization, unitization, force-pooling, etc?

☐ Yes ☐ No If answer is "yes," type of consolidation _____

If answer is "no," list the owners and tract descriptions which have actually been consolidated. (Use reverse side of this form if necessary.) _____

No allowable will be assigned to the well until all interests have been consolidated (by communitization, unitization, forced-pooling, or otherwise) or until a non-standard unit, eliminating such interests, has been approved by the Division

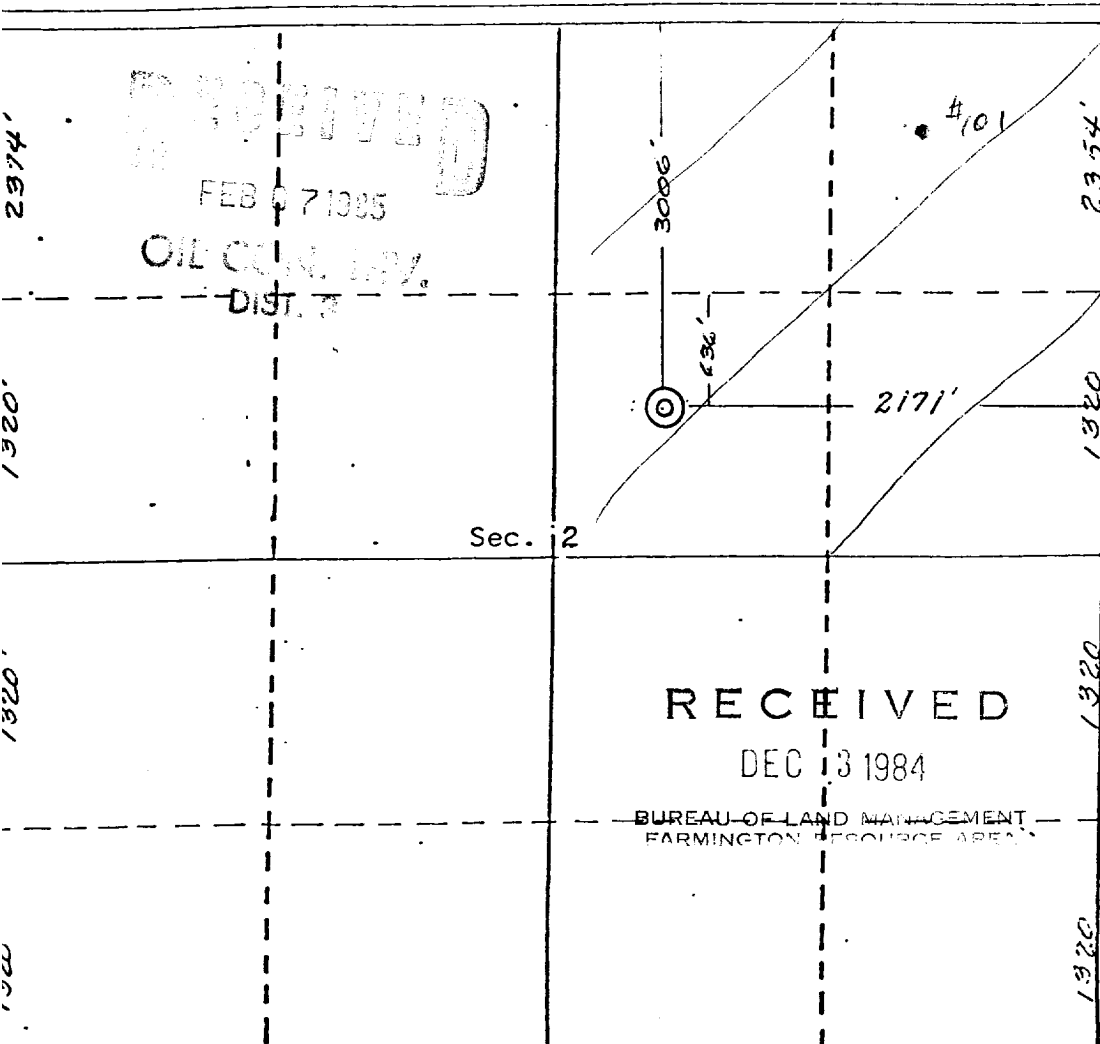

CERTIFICATION

I hereby certify that the information contained herein is true and complete to the best of my knowledge and belief.

Name

Position

Company

Date

I hereby certify that the well location shown on this plat was plotted from field notes of actual surveys made by me or under my supervision, and that the same is true and correct to the best of my knowledge and belief.

REGISTERED LAND SURVEYOR
8 November 1984

Date of Survey
Curtis C. Stocking
Registered Professional Engineer
and/or Surveyor
Curtis C. Stocking

Certificate No.
5980

EXHIBIT A
APACHE #143

[illegible][illegible]

EXHIBIT C
APACHE #143
SEC 2-T24N-R4W

LEGEND
 PROPOSED RD
 Existing Rd includes truck
 route from well to Water Hole

The map shows a rugged terrain with numerous contour lines. A proposed road, indicated by a dashed line, runs from the bottom left towards the center. A solid line represents an existing road. A water hole is marked with a black dot near the top center. The map includes labels for 'Canada', 'Larga', 'Cottonwood Canyon', and 'Brill'. Elevation markers such as 6743, 6760, 6812, 6815, 6820, 6831, 6857, 6867, 6900, 6920, 6936, 6948, 6962, 6970, 6980, 6990, 7000, 7010, 7020, 7030, 7040, 7050, 7060, 7070, 7080, 7090, 7100, 7110, 7120, 7130, 7140, 7150, 7160, 7170, 7180, 7190, 7200, 7210, 7220, 7230, 7240, 7250, 7260, 7270, 7280, 7290, 7300, 7310, 7320, 7330, 7340, 7350, 7360, 7370, 7380, 7390, 7400, 7410, 7420, 7430, 7440, 7450, 7460, 7470, 7480, 7490, 7500, 7510, 7520, 7530, 7540, 7550, 7560, 7570, 7580, 7590, 7600, 7610, 7620, 7630, 7640, 7650, 7660, 7670, 7680, 7690, 7700, 7710, 7720, 7730, 7740, 7750, 7760, 7770, 7780, 7790, 7800, 7810, 7820, 7830, 7840, 7850, 7860, 7870, 7880, 7890, 7900, 7910, 7920, 7930, 7940, 7950, 7960, 7970, 7980, 7990, 8000, 8010, 8020, 8030, 8040, 8050, 8060, 8070, 8080, 8090, 8100, 8110, 8120, 8130, 8140, 8150, 8160, 8170, 8180, 8190, 8200, 8210, 8220, 8230, 8240, 8250, 8260, 8270, 8280, 8290, 8300, 8310, 8320, 8330, 8340, 8350, 8360, 8370, 8380, 8390, 8400, 8410, 8420, 8430, 8440, 8450, 8460, 8470, 8480, 8490, 8500, 8510, 8520, 8530, 8540, 8550, 8560, 8570, 8580, 8590, 8600, 8610, 8620, 8630, 8640, 8650, 8660, 8670, 8680, 8690, 8700, 8710, 8720, 8730, 8740, 8750, 8760, 8770, 8780, 8790, 8800, 8810, 8820, 8830, 8840, 8850, 8860, 8870, 8880, 8890, 8900, 8910, 8920, 8930, 8940, 8950, 8960, 8970, 8980, 8990, 9000, 9010, 9020, 9030, 9040, 9050, 9060, 9070, 9080, 9090, 9100, 9110, 9120, 9130, 9140, 9150, 9160, 9170, 9180, 9190, 9200, 9210, 9220, 9230, 9240, 9250, 9260, 9270, 9280, 9290, 9300, 9310, 9320, 9330, 9340, 9350, 9360, 9370, 9380, 9390, 9400, 9410, 9420, 9430, 9440, 9450, 9460, 9470, 9480, 9490, 9500, 9510, 9520, 9530, 9540, 9550, 9560, 9570, 9580, 9590, 9600, 9610, 9620, 9630, 9640, 9650, 9660, 9670, 9680, 9690, 9700, 9710, 9720, 9730, 9740, 9750, 9760, 9770, 9780, 9790, 9800, 9810, 9820, 9830, 9840, 9850, 9860, 9870, 9880, 9890, 9900, 9910, 9920, 9930, 9940, 9950, 9960, 9970, 9980, 9990, 10000.

EXHIBIT D
APACHE #143
SEC 2-T24N-R4W

LEGEND
 PROPOSED RD
 Existing Rd includes truck
 route from well to Water Hole

Well
 Water Hole
 Cottonwood Canyon
 Larga
 Canada
 Pipeline
 6815
 6812
 6810
 6808
 6806
 6804
 6802
 6800
 6798
 6796
 6794
 6792
 6790
 6788
 6786
 6784
 6782
 6780
 6778
 6776
 6774
 6772
 6770
 6768
 6766
 6764
 6762
 6760
 6758
 6756
 6754
 6752
 6750
 6748
 6746
 6744
 6742
 6740
 6738
 6736
 6734
 6732
 6730
 6728
 6726
 6724
 6722
 6720
 6718
 6716
 6714
 6712
 6710
 6708
 6706
 6704
 6702
 6700
 6698
 6696
 6694
 6692
 6690
 6688
 6686
 6684
 6682
 6680
 6678
 6676
 6674
 6672
 6670
 6668
 6666
 6664
 6662
 6660
 6658
 6656
 6654
 6652
 6650
 6648
 6646
 6644
 6642
 6640
 6638
 6636
 6634
 6632
 6630
 6628
 6626
 6624
 6622
 6620
 6618
 6616
 6614
 6612
 6610
 6608
 6606
 6604
 6602
 6600
 6598
 6596
 6594
 6592
 6590
 6588
 6586
 6584
 6582
 6580
 6578
 6576
 6574
 6572
 6570
 6568
 6566
 6564
 6562
 6560
 6558
 6556
 6554
 6552
 6550
 6548
 6546
 6544
 6542
 6540
 6538
 6536
 6534
 6532
 6530
 6528
 6526
 6524
 6522
 6520
 6518
 6516
 6514
 6512
 6510
 6508
 6506
 6504
 6502
 6500
 6498
 6496
 6494
 6492
 6490
 6488
 6486
 6484
 6482
 6480
 6478
 6476
 6474
 6472
 6470
 6468
 6466
 6464
 6462
 6460
 6458
 6456
 6454
 6452
 6450
 6448
 6446
 6444
 6442
 6440
 6438
 6436
 6434
 6432
 6430
 6428
 6426
 6424
 6422
 6420
 6418
 6416
 6414
 6412
 6410
 6408
 6406
 6404
 6402
 6400
 6398
 6396
 6394
 6392
 6390
 6388
 6386
 6384
 6382
 6380
 6378
 6376
 6374
 6372
 6370
 6368
 6366
 6364
 6362
 6360
 6358
 6356
 6354
 6352
 6350
 6348
 6346
 6344
 6342
 6340
 6338
 6336
 6334
 6332
 6330
 6328
 6326
 6324
 6322
 6320
 6318
 6316
 6314
 6312
 6310
 6308
 6306
 6304
 6302
 6300
 6298
 6296
 6294
 6292
 6290
 6288
 6286
 6284
 6282
 6280
 6278
 6276
 6274
 6272
 6270
 6268
 6266
 6264
 6262
 6260
 6258
 6256
 6254
 6252
 6250
 6248
 6246
 6244
 6242
 6240
 6238
 6236
 6234
 6232
 6230
 6228
 6226
 6224
 6222
 6220
 6218
 6216
 6214
 6212
 6210
 6208
 6206
 6204
 6202
 6200
 6198
 6196
 6194
 6192
 6190
 6188
 6186
 6184
 6182
 6180
 6178
 6176
 6174
 6172
 6170
 6168
 6166
 6164
 6162
 6160
 6158
 6156
 6154
 6152
 6150
 6148
 6146
 6144
 6142
 6140
 6138
 6136
 6134
 6132
 6130
 6128
 6126
 6124
 6122
 6120
 6118
 6116
 6114
 6112
 6110
 6108
 6106
 6104
 6102
 6100
 6098
 6096
 6094
 6092
 6090
 6088
 6086
 6084
 6082
 6080
 6078
 6076
 6074
 6072
 6070
 6068
 6066
 6064
 6062
 6060
 6058
 6056
 6054
 6052
 6050
 6048
 6046
 6044
 6042
 6040
 6038
 6036
 6034
 6032
 6030
 6028
 6026
 6024
 6022
 6020
 6018
 6016
 6014
 6012
 6010
 6008
 6006
 6004
 6002
 6000
 5998
 5996
 5994
 5992
 5990
 5988
 5986
 5984
 5982
 5980
 5978
 5976
 5974
 5972
 5970
 5968
 5966
 5964
 5962
 5960
 5958
 5956