

SUBMIT IN TRIPLICATE\*

(Other instructions on reverse side)

Form approved  
Budget Bureau No. 1004-0136  
Expires August 31, 1985Form 3160-3  
(November 1983)  
(formerly 9-331C)UNITED STATES  
DEPARTMENT OF THE INTERIOR  
BUREAU OF LAND MANAGEMENT

## APPLICATION FOR PERMIT TO DRILL, DEEPEN, OR PLUG BACK

## 1A. TYPE OF WORK

DRILL ☒DEEPEN ☐PLUG BACK ☐

## B. TYPE OF WELL

OIL WELL ☒GAS WELL ☐OTHER ☐SINGLE ZONE ☒MULTIPLE ZONE ☐

## 2. NAME OF OPERATOR

BCO, Inc.

## 3. ADDRESS OF OPERATOR

135 Grant Avenue, Santa Fe, New Mexico 87501

## 4. LOCATION OF WELL (Report location clearly and in accordance with any State requirements.)\*

250' FWL 2040' FSL Sec 21, T24N R7W, N.M.P.M., Rio Arriba County  
At proposed prod. zone

Same

## 14. DISTANCE IN MILES AND DIRECTION FROM NEAREST TOWN OR POST OFFICE\*

Approximately 5 Miles North of Escrito Trading Post, New Mexico

16. DISTANCE FROM PROPOSED LOCATION TO NEAREST PROPERTY OR LEASE LINE, FT.  
(Also to nearest drlg. unit line, if any)

250 feet

## 18. DISTANCE FROM PROPOSED LOCATION TO NEAREST WELL, DRILLING, COMPLETED, OR APPLIED FOR, ON THIS LEASE, FT.

3420 feet

## 16. NO. OF ACRES IN LEASE

240

## 19. PROPOSED DEPTH

6200'

## 17. NO. OF ACRES ASSIGNED TO THIS WELL

80

## 20. ROTARY OR CABLE TOOLS

Rotary

## 21. ELEVATIONS (Show whether DF, RT, GR, etc.)

GR 7285'

## DRILLING OPERATIONS AUTHORIZED ARE

## SUBJECT TO COMPLIANCE WITH ATTACHED

## "GENERAL REQUIREMENTS" PROPOSED CASING AND CEMENTING PROGRAM

## 22. APPROX. DATE WORK WILL START\*

3/1/85

## 23.

This action is subject to administrative appeal pursuant to 30 CFR 290.

SIZE OF HOLE	SIZE OF CASING	WEIGHT PER FOOT	SETTING DEPTH	
12 1/2"	8 5/8" New	24# 8 Rd	200'±	150 sacks Class H
7 7/8"	4 1/2" New	11.6# N80	6200'	1630 Sacks Class H

Drill surface hole to 200'±. Cement to surface with approximately 150 sacks Class H, 3% CaCl, 1/2# flocele. Drill 7 7/8" hole to T.D. 6200'. Run 4 1/2" casing to T.D. Cement to be as follows:

First Stage: 10 bbls. of mud flush, approximately 175 sacks Class H 2% CaCl, 8# salt, 1/2# flocele, 6 1/2# gilsonite, mixed at 15.2#'s. Yield 1.36 cubic feet per sack for a total of 238 cubic feet. Top of cement will be reported on subsequent Sundry Notice based on the cement log.

Second State: 10 bbls. of water, 1000 gallons of FLO CHECK, 5 bbls. of water approximately 1455 sacks of 65/35 Class H, 3% gel, 12 1/2# gilsonite, 5.6# salt, 8.2 Calseal mixed at 13.35#'s. Yield 1.68 cubic feet per sack. Plan to circulate to surface. Actual Second Stage size will be determined after caliper log determines area to be cemented.

IN ABOVE SPACE DESCRIBE PROPOSED PROGRAM: If proposal is to deepen or plug back, give data on present productive zone and proposed new productive zone. If proposal is to drill or deepen directionally, give pertinent data on subsurface locations and measured and true vertical depths. Give blowout preventer program, if any.

## 24.

SIGNED

Elizabeth B. Keeshan

TITLE

Comptroller

(This space for Federal or State office use)

PERMIT NO.

APPROVAL DATE

APPROVED BY

CONDITIONS OF APPROVAL, IF ANY:

DIST. 9

APPROVED

AS AMENDED

JAN 31 1985

DATE

(SGD) MAT MILLENBACH  
AREA MANAGER  
FARMINGTON RESOURCE AREA

NMOCC

\*See Instructions On Reverse Side

Title 18 U.S.C. Section 1001, makes it a crime for any person knowingly and willfully to make to any department or agency of the United States any false, fictitious or fraudulent statements or representations as to any matter within its jurisdiction.

1

...

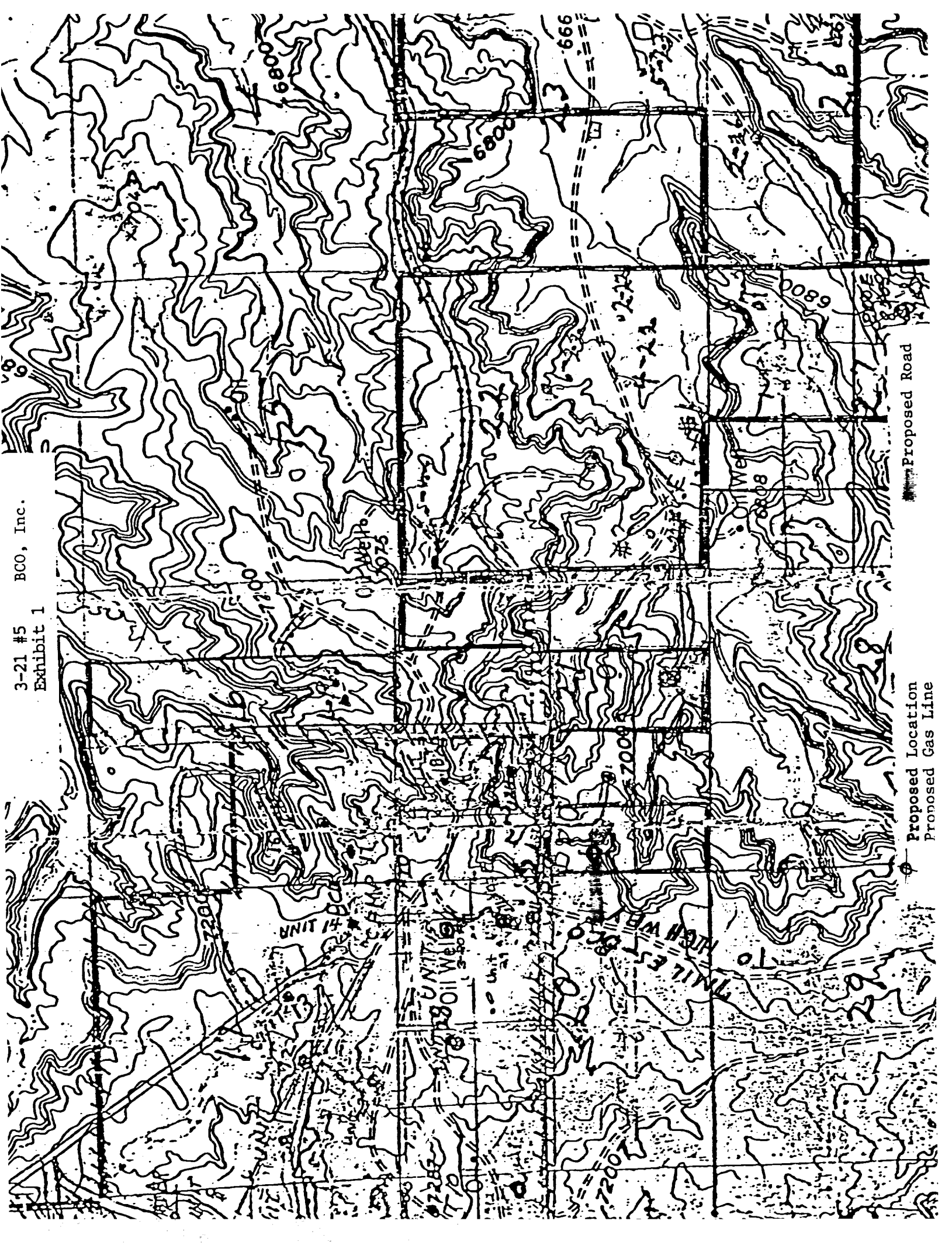



STATE OF NEW MEXICO  
**ENERGY AND MINERALS DEPARTMENT**  
OIL CONSERVATION DIVISION

JAN 30 1985

January 25, 1985

TONY ANAYA  
GOVERNOR

POST OFFICE BOX 2088  
STATE LAND OFFICE BUILDING  
SANTA FE, NEW MEXICO 87501  
(505) 827-5800

Ernest L. Padilla  
Attorney  
P. O. Box 2523  
Santa Fe, New Mexico 87501

Attention: Ernest L. Padilla

Administrative Order NSL-1976

Dear Mr. Padilla:

Reference is made to your application on behalf of BCO, Inc. for a non-standard location for their 3-21 Well No. 5 to be located 250 feet from the West line and 2040 feet from the South line of Section 21, Township 24 North, Range 7 West, NMPM, Escrito-Gallup Pool, Rio Arriba County, New Mexico.

By authority granted me under the provisions of the Special Rule of Division Order No. R-5353, the above-described unorthodox location is hereby approved.

Sincerely,



R. L. STAMETS, DIRECTOR

RLS/GPQ/dr

cc: Oil Conservation Division - Aztec  
Oil & Gas Engineering Committee - Hobbs  
Bureau of Land Management - Farmington

**RECEIVED**  
FEB 06 1985  
OIL CON. DIV.  
DIST. 3

## OIL CONSERVATION DIVISION

P. O. BOX 2088

Form C-102  
Revised 10-1-78

STATE OF NEW MEXICO

ENERGY AND MINERALS DEPARTMENT

SANTA FE, NEW MEXICO 87501

All distances must be from the outer boundaries of the Section.

Operator BCO, Inc.		Lease 3-21		Well No. 5	
Well Letter L	Section 21	Township 24 North	Range 7 West	County Rio Arriba	
Actual Footage Location of Wells: 2040 feet from the South line and 250 feet from the West line					
Ground Level Elev. 7285	Producing Formation Gallup		Pool Escrito Gallup		Dedicated Acreage: 80 Acres

1. Outline the acreage dedicated to the subject well by colored pencil or hatchure marks on the plat below.

2. If more than one lease is dedicated to the well, outline each and identify the ownership thereof (both as to working interest and royalty).

3. If more than one lease of different ownership is dedicated to the well, have the interests of all owners been consolidated by communitization, unitization, force-pooling, etc?

☐ Yes ☐ No If answer is "yes," type of consolidation \_\_\_\_\_

If answer is "no," list the owners and tract descriptions which have actually been consolidated. (Use reverse side of this form if necessary.) \_\_\_\_\_

No allowable will be assigned to the well until all interests have been consolidated (by communitization, unitization, forced-pooling, or otherwise) or until a non-standard unit, eliminating such interests, has been approved by the Division.

## CERTIFICATION

I hereby certify that the information contained herein is true and complete to the best of my knowledge and belief.

Elizabeth B. Keeshan

Name

Elizabeth B. Keeshan

Position

Comptroller

Company

BCO, Inc.

Date

January 7, 1985

I hereby certify that the location shown on this plat was taken from field notes of actual survey made by me or under my supervision and that the same is true and correct to the best of my knowledge and belief.

Date Surveyed

December 7, 1984

Registered Professional Engineer  
and/or Land SurveyorEdgar L. Risenhoover  
Certificate No. 5979