

UNITED STATES
DEPARTMENT OF THE INTERIOR
BUREAU OF LAND MANAGEMENT

APPLICATION FOR PERMIT TO DRILL, DEEPEN, OR PLUG BACK

1a. TYPE OF WORK

DRILL ☒

DEEPEN ☐

PLUG BACK ☐

b. TYPE OF WELL

OIL
WELL ☒

GAS
WELL ☐

OTHER

SINGLE
ZONE ☒

MULTIPLE
ZONE ☐

2. NAME OF OPERATOR

Union Texas Petroleum Corporation

3. ADDRESS OF OPERATOR

4001 Bloomfield Hwy, Box 11, Farmington, New Mexico 87401

4. LOCATION OF WELL (Report location clearly and in accordance with applicable requirements)
At surface

790' FSL; 790' FEL

At proposed prod. zone Same as above

SEP 20 1985

14. DISTANCE IN MILES AND DIRECTION FROM NEAREST TOWN OR POST OFFICE*

7 miles north of Otero, New Mexico

BUREAU OF LAND MANAGEMENT
FARMINGTON RESOURCE AREA

15. DISTANCE FROM PROPOSED*
LOCATION TO NEAREST
PROPERTY OR LEASE LINE, FT.
(Also to nearest drig. unit line, if any)

790'

790'

16. NO. OF ACRES IN LEASE

2026.20

17. NO. OF ACRES ASSIGNED
TO THIS WELL

SE/4 160

18. DISTANCE FROM PROPOSED LOCATION*
TO NEAREST WELL, DRILLING, COMPLETED,
OR APPLIED FOR, ON THIS LEASE, FT.

1216'

19. PROPOSED DEPTH

7180'

20. ROTARY OR CABLE TOOLS

Rotary

21. ELEVATIONS (Show whether DF, RT, GR, etc.)

6699 GR

22. APPROX. DATE WORK WILL START*

January 1, 1986

23.

DRILLING OPERATIONS AUTHORIZED ARE
SUBJECT TO COMPLIANCE WITH ATTACHED
"GENERAL REQUIREMENTS"

PROPOSED CASING AND CEMENTING PROGRAM

This action is subject to technical and
procedural review pursuant to 43 CFR 3165.3
and appeal pursuant to 43 CFR 3165.4.

SIZE OF HOLE	SIZE OF CASING	WEIGHT PER FOOT	SETTING DEPTH	
12-1/4	New 8-5/8"	24.00#	(+) 250'	200 sx (circulated)
7-7/8	New 4-1/2"	11.60#	(+) 7180'	1100 sx (cover Ojo Alamo)

We propose to drill a 12-1/4" hole to about 250' using natural mud. 8-5/8", 24.00# csg will be set at approximately 250'. The csg will be cmtd with enough cmt to circulate to the surface (about 200 sxs). We will drill a 7-7/8" hole to total depth of 7180' using a starch-base mud. 4-1/2", 11.60#, K-55 casing will be set at about 7180' with stage collars at about 5250' and 3820'. The first stage will be cmtd with 250 sacks of 50-50 POZ. The second stage will be cmtd. with 350 sxs of 50-50 POZ and 100 sxs of Cl "B". The third stage will be cmtd with 300 sxs of 65-35 Poz, 6% Gel and 100 sxs of CL "B". We will drill out stage collars and pressure-test casing. We will then perforate and fracture the Dakota zone and run a bridge plug between the zones. The Gallup will be perforated and fractured. The bridge plug will be removed and both zones cleaned up.

The gas from both zones has been previously dedicated to a gas transporter.

IN ABOVE SPACE DESCRIBE PROPOSED PROGRAM: If proposal is to deepen or plug back, give data on present productive zone and proposed new productive zone. If proposal is to drill or deepen directionally, give pertinent data on subsurface locations and measured and true vertical depths. Give blowout preventer program, if any.

24.

SIGNED

R. C. Frank

(This space for Federal or State office use)

TITLE Regulatory Analyst

DATE August 28, 1985

PERMIT NO.

APPROVED BY

CONDITIONS OF APPROVAL, IF ANY:

RECEIVED
NOV 14 1985

OIL CON. DIV
DIST. 2

APPROVED
AS AMENDED

NOV 08 1985

J. Stan McKee

M. MILLENBACH
AREA MANAGER

NMOCC

*See Instructions On Reverse Side

NEW MEXICO OIL CONSERVATION COMMISSION
WELL LOCATION AND ACREAGE DEDICATION PLAT

Form C-102
Supersedes C-128
Effective 1-1-65

All distances must be from the outer boundaries of the Section.

Operator SUPRON ENERGY CORPORATION			Lease JICARILLA L		Well No. 8621
Unit Letter P	Section 33	Township 25 NORTH	Range 5 WEST	County RIO ARriba	
Actual Footage Location of Well:					
790 feet from the SOUTH line and		790 feet from the EAST line			
Ground Level Elev. 5699	Producing Formation Dakota Gallup	Pool West Lindreth EXT	Dedicated Acreage: SE/4 160 Acres		

1. Outline the acreage dedicated to the subject well by colored pencil or hachure marks on the plat below.
2. If more than one lease is dedicated to the well, outline each and identify the ownership thereof (both as to working interest and royalty).
3. If more than one lease of different ownership is dedicated to the well, have the interests of all owners been consolidated by communitization, unitization, force-pooling, etc?

☐ Yes ☐ No If answer is "yes," type of consolidation _____

If answer is "no," list the owners and tract descriptions which have actually been consolidated. (Use reverse side of this form if necessary.) _____

No allowable will be assigned to the well until all interests have been consolidated (by communitization, unitization, forced-pooling, or otherwise) or until a non-standard unit, eliminating such interests, has been approved by the Commission.

RECEIVED
NOV 14 1985
OIL CON. DIV.
DIST. 3

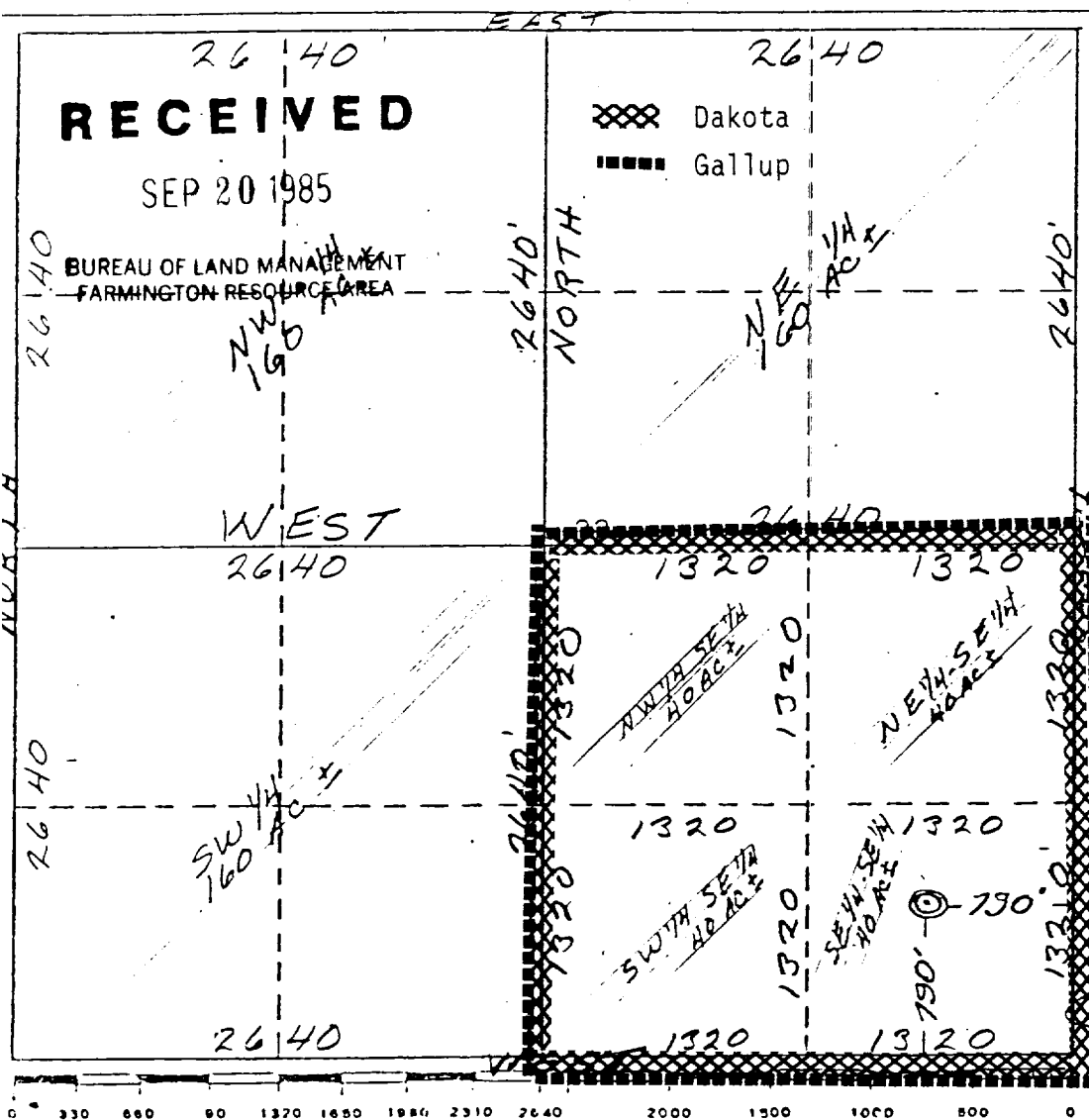

CERTIFICATION

I hereby certify that the information contained herein is true and complete to the best of my knowledge and belief.

Robert C. Frank

Name
Robert C. Frank
Position
Regulatory Analyst
Company
Union Texas Petroleum Corp.
Date
August 29, 1985

I hereby certify that the well location shown on this plat is plotted from field notes of actual survey made by me or under my supervision, and that the same is true and correct to the best of my knowledge and belief.

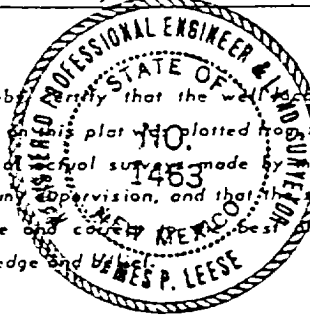

Date Surveyed
March 22, 1982
Registered Professional Engineer and/or Land Surveyor
James P. Leese
James P. Leese
Certificate No.
1463

Rio Arriba County, N.M.

