

UNITED STATES
DEPARTMENT OF THE INTERIOR
BUREAU OF LAND MANAGEMENT

APPLICATION FOR PERMIT TO DRILL, DEEPEN, OR PLUG BACK

1a. TYPE OF WORK

DRILL ☒

DEEPEN ☐

PLUG BACK ☐

b. TYPE OF WELL

OIL
WELL ☒

GAS
WELL ☐

OTHER

SINGLE
ZONE ☒

MULTIPLE
ZONE ☐

2. NAME OF OPERATOR

MOBIL PRODUCING TX & NM, INC.

3. ADDRESS OF OPERATOR

P.O. BOX 633 MIDLAND, TX 79702

4. LOCATION OF WELL (Report location clearly and in accordance with any State requirements.)*
At surface

2150' FEL: 2150 FNL Sec. 4
At proposed prod. zone

Same

14. DISTANCE IN MILES AND DIRECTION FROM NEAREST TOWN OR POST OFFICE

15.5 miles SW of Regina, N.M.

15. DISTANCE FROM PROPOSED*

LOCATION TO NEAREST
PROPERTY OR LEASE LINE, FT.
(Also to nearest drig. unit line, if any)

2150'

16. NO. OF ACRES IN LEASE

1046.87 640 Ac.

17. NO. OF ACRES ASSIGNED
TO THIS WELL

160 Ac.

18. DISTANCE FROM PROPOSED LOCATION*

TO NEAREST WELL, DRILLING, COMPLETED,
OR APPLIED FOR, ON THIS LEASE, FT.

2825'

19. PROPOSED DEPTH

7900'

20. ROTARY OR CABLE TOOLS

Rotary

21. ELEVATIONS (Show whether on or off ground) DRILLING OPERATIONS AUTHORIZED ARE

7145' GR

SUBJECT TO COMPLIANCE WITH ATTACHED

22. APPROX. DATE WORK WILL START*

7-1-86

23. "GENERAL REQUIREMENTS" CASING AND CEMENTING PROGRAM

This action is subject to technical and
procedural review pursuant to 43 CFR 3106.9
and appeal pursuant to 43 CFR 3106.4.

SIZE OF HOLE	SIZE OF CASING	WEIGHT PER FOOT	SETTING DEPTH
12 1/2	8 5/8	36 H40	0-400'
7 7/8	5 1/2	15.5 K55	0-7900'

(1) 472 Cu.Ft. circulated to surf.

(2) a. 590 Cu.Ft. Circulated to DV
tool @ 6000'
b. 2004 Cu.Ft. circulated from
6000' @ DV to surface

CEMENTING PROGRAM

- 2%
(1) 472 Cu.FT. Class B + 1% CaCl₂ + 1/4# sk. Celloseal
(2) a. 236 Cu.Ft. Pacesetter lite + 1/4# sk. Celloseal;
354 Cu.Ft. Class B neat
b. 1650 Cu.Ft. Class B neat; 236 Cu.Ft. Class B + 2% CaCl₂; 118 Cu.Ft. Class B Thix Set

MUD PROGRAM

DEPTH	TYPE	WEIGHT	VISCOSITY	WATER LOSS
0-400'	FW-Spud	8.8-9.2	40-50	N/C
400'-TD	FW-Gel	8.8-9.2	38-42	6-8

LOGGING PROGRAM

DIL-GR	3000-TD
FDC-CNL-CAL-GR	3000-TD
BHC-Sonic-CAL-GR	3000-TD

BLOWOUT PREVENTER PROGRAM -- See Attachment

There are no other wells on this quarter-quarter section to my knowledge.

IN ABOVE SPACE DESCRIBE PROPOSED PROGRAM: If proposal is to deepen or plug back, give data on present productive zone and proposed new productive zone. If proposal is to drill or deepen directionally, give pertinent data on subsurface locations and measured and true vertical depths. Give blowout preventer program, if any.

24.

SIGNED C. Moore for G.E. Tate

TITLE Env. & Reg. Manager

DATE 6-3-86

(This space for Federal or State office use)

PERMIT NO. _____

APPROVAL DATE

JUN 19 1986

APPROVED BY _____

TITLE _____

DATE _____

CONDITIONS OF APPROVAL, IF ANY:

holdings of the Bureau of Land Management or title to this lease.

*See Instructions On Reverse Side

STATE OF NEW MEXICO
ENERGY AND MINERALS DEPARTMENT

OIL CONSERVATION DIVISION

P. O. BOX 2088
SANTA FE, NEW MEXICO 87501

Form C-102
Revised 10-1-78

All distances must be from the outer boundaries of the Section.

Operator Mobil Producing Tx & NM, Inc.		Lease Cullins-Federal		Well No. 5
Unit Letter G	Section 4	Township T-24-N	Range R-3-W	County Rio Arriba
Actual Footage Location of Well: 2150 feet from the North line and 2150 feet from the East line				
Ground Level Elev. 7145'	Producing Formation Gallup/Dakota	Pool West Lindrith-Gallup/Dakota	Dedicated Acreage 160	Acres

1. Outline the acreage dedicated to the subject well by colored pencil or hatchure marks on the plat below.
2. If more than one lease is dedicated to the well, outline each and identify the ownership thereof (both as to working interest and royalty).
3. If more than one lease of different ownership is dedicated to the well, have the interests of all owners been consolidated by communitization, unitization, force-pooling, etc?

☐ Yes ☐ No If answer is "yes," type of consolidation _____

If answer is "no," list the owners and tract descriptions which have actually been consolidated. (Use reverse side of this form if necessary.) _____

No allowable will be assigned to the well until all interests have been consolidated (by communitization, unitization, forced-pooling, or otherwise) or until a non-standard unit, eliminating such interests, has been approved by the Division.

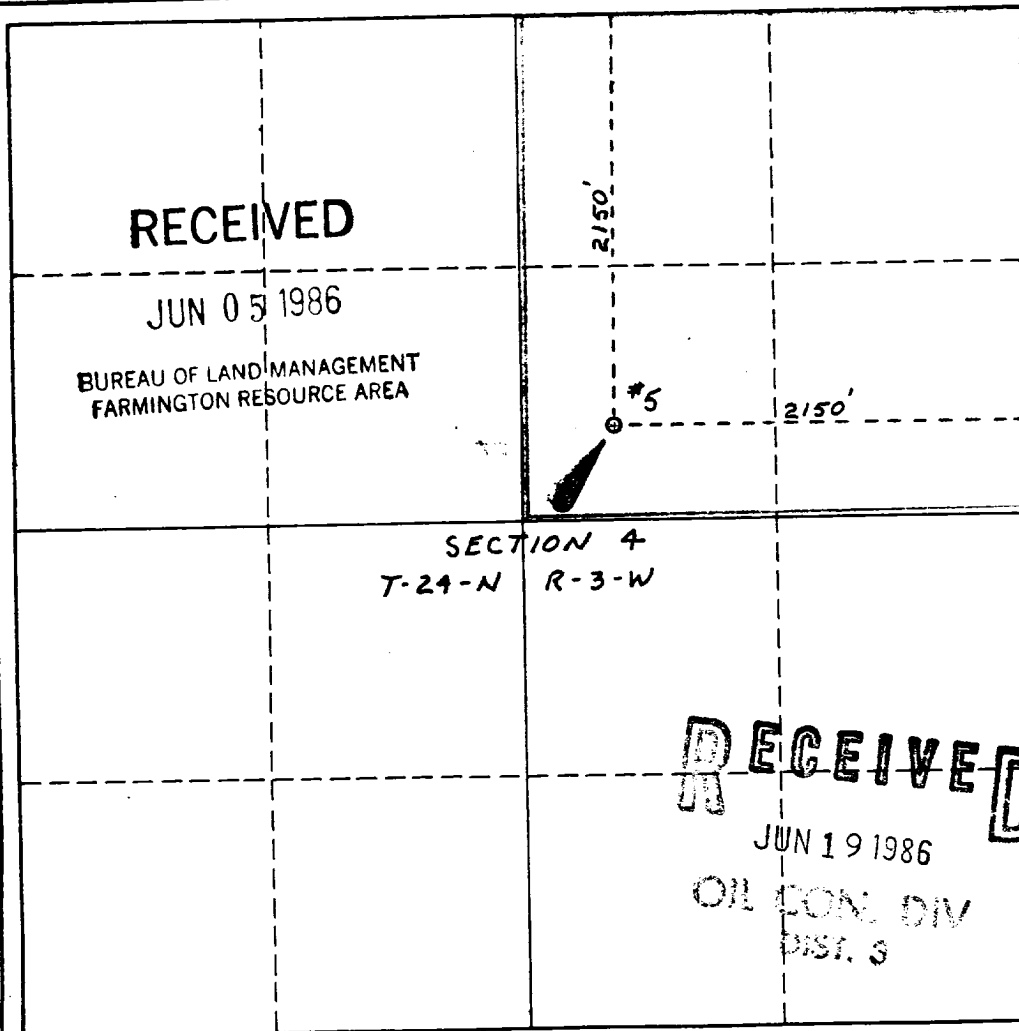

CERTIFICATION

I hereby certify that the information contained herein is true and complete to the best of my knowledge and belief.

C.A. Moore for **G.E. Tate**

Name
Eng. & Reg. Manager
Position
Mobil Producing Tx & NM, Inc.
Company
June 3, 1986
Date

I hereby certify that the well location shown on this plat was plotted from field notes of actual surveys made by me or under my supervision, and that the same is true and correct to the best of my knowledge.

Date Surveyed
REGISTERED PROFESSIONAL ENGINEER
and/or LAND SURVEYOR
Norman E. Cumings
Certificate No.

9669

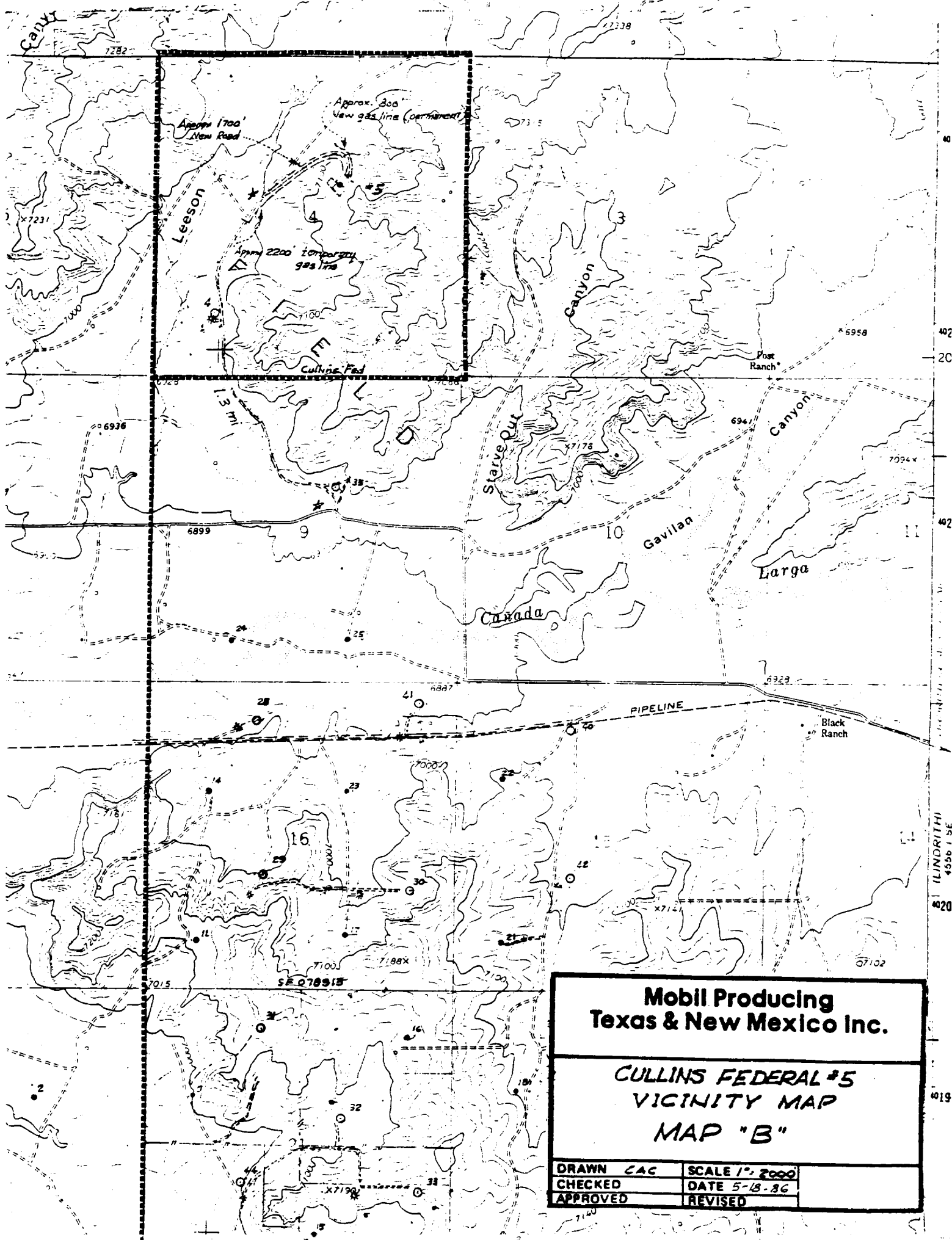

**Mobil Producing
Texas & New Mexico Inc.**

**CULLINS FEDERAL #5
VICINITY MAP
MAP "B"**

DRAWN CAC	SCALE 1" = 2000'
CHECKED	DATE 5-18-86
APPROVED	REVISED