

UNITED STATES
DEPARTMENT OF THE INTERIOR
BUREAU OF LAND MANAGEMENT

APPLICATION FOR PERMIT TO DRILL, DEEPEN, OR PLUG BACK

1a. TYPE OF WORK
DRILL ☒ DEEPEN ☐ PLUG BACK ☐

b. TYPE OF WELL
OIL WELL ☐ GAS WELL ☐ OTHER ☐ SINGLE ZONE ☒ MULTIPLE ZONE ☐

2. NAME OF OPERATOR
ARCO Oil and Gas Company, A Division of Atlantic Richfield Co.

3. ADDRESS OF OPERATOR
P. O. Box 1610, Midland, Texas 79702

4. LOCATION OF WELL (Report location clearly and in accordance with any State requirements.)
At surface
990' FSL and 1850' FWL
At proposed prod. zone
Approximately same as above

14. DISTANCE IN MILES AND DIRECTION FROM NEAREST TOWN OR POST OFFICE
±8 miles northwest of Lindrith, New Mexico

10. DISTANCE FROM PROPOSED LOCATION TO NEAREST PROPERTY OR LEASE LINE, FT.
(Also to nearest drlg. unit line, if any) 330'

18. DISTANCE FROM PROPOSED LOCATION TO NEAREST WELL, DRILLING, COMPLETED, OR APPLIED FOR, ON THIS LEASE, FT. 2777'

21. ELEVATIONS (Show whether ~~Dr. P.T. (GS, etc.)~~
7223' (ungraded GL)

23. ~~and appeal pursuant to 42 CFR 101.11~~
CEMENTING PROGRAM

SIZE OF HOLE	SIZE OF CASING	WEIGHT PER FOOT	SETTING DEPTH
12-1/4	9-5/8	36#	750'
8-3/4	5-1/2	17#	8170'

Pursuant to Onshore Oil and Gas Order No. 1
Certified Location Plat (Exhibit #1)
Drilling Plan w/attachments
Surface Use & Operations Plan w/attachments

This well is proposed to be drilled to 8170' and to be completed in the Dakota Formation as described in the attached plans.

Please contact Sandy Stash-Zdinak, Drilling Engineer (915)688-5675 if additional information is required.

IN ABOVE SPACE DESCRIBE PROPOSED PROGRAM: If proposal is to deepen or plug back, give data on present productive zone and proposed new productive zone. If proposal is to drill or deepen directionally, give pertinent data on subsurface locations and measured and true vertical depths. Give blowout preventer program, if any.

24. SIGNED J.D. Kimbrell TITLE District Drilling Engineer

(This space for Federal or State office use)

PERMIT NO. _____ APPROVAL DATE _____

APPROVED BY _____ TITLE _____

CONDITIONS OF APPROVAL, IF ANY:

APPROVED
AS AMENDED

OCT 05 1986

/s/ J. Stan McKee

FOR AREA MANAGER

NMOCC

*See Instructions On Reverse Side

STATE OF NEW MEXICO
ENERGY AND MINERALS DEPARTMENT

OIL CONSERVATION DIVISION

P. O. BOX 2088
SANTA FE, NEW MEXICO 87501

EXHIBIT "A"
Certified Plat

Form C-102
Revised 10-1-78

All distances must be from the outer boundaries of the Section.

Operator ARCO OIL & GAS			Lease Gardner 13		Well No. 13-1 Alt.
Unit Letter N	Section 13	Township 25 North	Range 3 West	County Rio Arriba	
Actual Footage Location of Well: (cardinal) 990 feet from the South line and 1850 feet from the West line					
Ground Level Elev. 7223	Producing Formation Dakota		Pool Com. / on Greenhorn / Traveres	Dedicated Acreage: 320	Acres

1. Outline the acreage dedicated to the subject well, by colored pencil or hachure marks on the plat below.
2. If more than one lease is dedicated to the well, outline each and identify the ownership thereof (both as to working interest and royalty).
3. If more than one lease of different ownership is dedicated to the well, have the interests of all owners been consolidated by communitization, unitization, force-pooling, etc?

☐ Yes ☐ No If answer is "yes," type of consolidation _____

If answer is "no," list the owners and tract descriptions which have actually been consolidated. (Use reverse side of this form if necessary.) _____

No allowable will be assigned to the well until all interests have been consolidated (by communitization, unitization, forced-pooling, or otherwise) or until a non-standard unit, eliminating such interests, has been approved by the Division.

* Record GLO 1917 plat

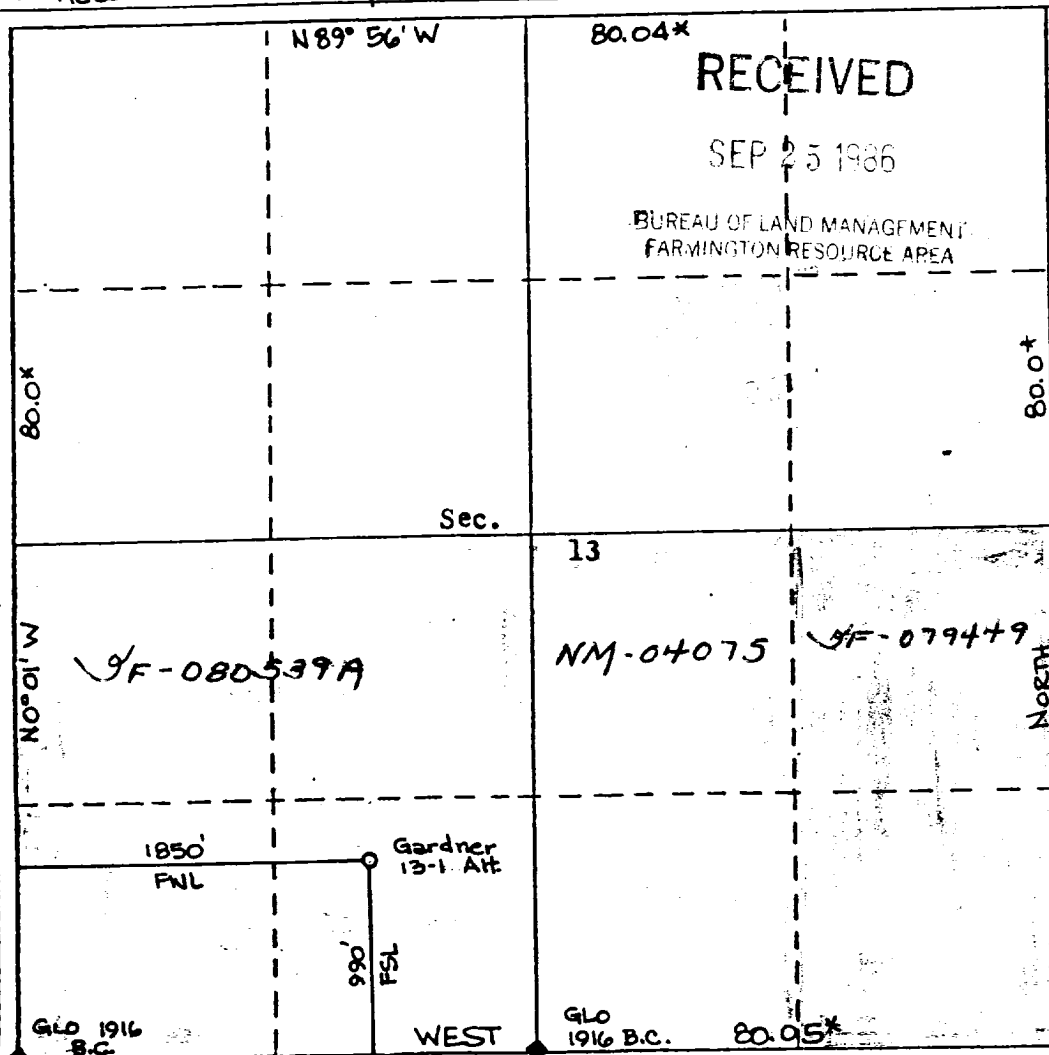

CERTIFICATION	
I hereby certify that the information contained herein is true and complete to the best of my knowledge and belief.	
Name	Andra Hash-Zdenak
Position	DRILLING ENGINEER
Company	ARCO OIL & GAS
Date	9/19/86
I hereby certify that the well location shown on this plat was plotted from field notes of actual surveys made by me or under my supervision, and that the same is true and correct to the best of my knowledge and belief.	
Date Surveyed	Aug. 1, 1986
Registered Professional Engineer and/or Land Surveyor	
Certificate No.	

EXHIBIT "B"
Topo Map and one (1) mile
radius map

Ojito

Cañon de los Ojitos

HURT #3

WF HURT #1

WF HURT #4

ARCO #1371 GARDNER

HILL #7

HILL #4

GARDNER #1

ARCO HILL #23-2

GI Walt

P+9

PIKE LINE

OJITO, N. MEX.
N3622 5-W10700/7 5

EXHIBIT "B"
Topo Map and one (1) mile
radius map

Ojito

Cañon de los Ojitos

HURT #3

WF HURT #1

WF HURT #4

ARCO #1371 GARDNER

HILL #7

HILL #4

GARDNER #1

ARCO HILL #23-2

GI Walt

P+9

PIKE LINE

OJITO, N. MEX.
N3622 5-W10700/7 5