

UNITED STATES
DEPARTMENT OF THE INTERIOR
BUREAU OF LAND MANAGEMENT

RECEIVED
SUBMITTING TRIPLICATE
(Other instructions on
reverse side)

30-039-24116
Form approved.
Budget Bureau No. 1004-0136
Expires August 31, 1985

MAR 18 1987

APPLICATION FOR PERMIT TO DRILL, DEEPEN, OR PLUG BACK

1a. TYPE OF WORK

DRILL ☒

DEEPEEN ☒

PLUG BACK ☒

b. TYPE OF WELL

OIL WELL ☒

GAS WELL ☐

OTHER

NOV 13 1986

SINGLE ZONE ☒

MULTIPLE ZONE ☒

2. NAME OF OPERATOR

Mesa Grande Resources, INC.

3. ADDRESS OF OPERATOR

P. O. Box 274, Farmington, New Mexico 87499

4. LOCATION OF WELL (Report location clearly and in accordance with any State requirements.)*

At surface

910' FNL & 1705' FEL of Section 5, T25N, R2W

At proposed prod. zone

14. DISTANCE IN MILES AND DIRECTION FROM NEAREST TOWN OR POST OFFICE*

1 mile East of Ojito, New Mexico

15. DISTANCE FROM PROPOSED* LOCATION TO NEAREST PROPERTY OR LEASE LINE, FT.

910'

16. NO. OF ACRES IN LEASE

160640.20

17. NO. OF ACRES ASSIGNED TO THIS WELL

320.20

18. DISTANCE FROM PROPOSED LOCATION* TO NEAREST WELL, DRILLING, COMPLETED, OR APPLIED FOR, ON THIS LEASE, FT.

5000'±

19. PROPOSED DEPTH

8320'

20. ROTARY OR CABLE TOOLS

Rotary

21. ELEVATIONS (Show whether DE, RT, GR, etc.)

7394' GR

DRILLING OPERATIONS AUTHORIZED ARE
SUBJECT TO COMPLIANCE WITH ATTACHED
"GENERAL REQUIREMENTS FOR PROPOSED CASING AND CEMENTING PROGRAM"

22. APPROX. DATE WORK WILL START*

December 15, 1986

This action is subject to technical and
procedural review pursuant to 43 CFR 3160.3
and appeal pursuant to 43 CFR 3160.4.

SIZE OF HOLE	SIZE OF CASING	WEIGHT PER FOOT	SETTING DEPTH	
12-1/4"	8-5/8"	24#, K-55	500' ±	163 sxs (196 ft. ³)
7-7/8"	4-1/2"	15.5#&17#, J-55		640 sxs (1044.2 ft. ³)
	5 1/2"			

PROPOSED PROGRAM:

- The proposed well will be drilled through the Dakota Formation and will evaluate the hydrocarbon potential of the Dakota, Graneros, Greenhorn, and Mancos zones. The completion program will be determined at total depth after log analysis.
- A BOP will be installed after surface casing is set and cemented. Prior to drilling out from under surface, BOP will be tested to 500# SIP. All subsequent work will be conducted through BOP.
- Drilling mud will be low solid non-dispersed; 35-45 visc., 8.5-9.2 ppg.

IN ABOVE SPACE DESCRIBE PROPOSED PROGRAM: If proposal is to deepen or plug back, give data on present productive zone and proposed new productive zone. If proposal is to drill or deepen directionally, give pertinent data on subsurface locations and measured and true vertical depths. Give blowout preventer program, if any.

CONTINUED ON SEPARATE SHEET

24.

SIGNED David M. Blandford

TITLE Petroleum Engineer

DATE 11/11/86

(This space for Federal or State office use)

PERMIT NO. _____

APPROVAL DATE _____

RECEIVED
APPROVED
AS AMENDED
MAR 20 1987
MAR 18 1987
L. J. Stan McKee

TITLE

NMOCC

CON. DIV.
DIST. 3

AREA MANAGER

"Approval of this action does
not warrant that the applicant
holds legal or equitable rights
or title to this lease."

Title 18 U.S.C. Section 1001, makes it a crime for any person knowingly and willfully to make to any department or agency of the

OIL CONSERVATION DIVISION

STATE OF NEW MEXICO
ENERGY AND MINERALS DEPARTMENTP. O. BOX 2088
SANTA FE, NEW MEXICO 87501Form C-102
Revised 10-1-70

All distances must be from the outer boundaries of the Section.

Operator MESA GRANDE RESOURCES			Lease PROWLER		Well No. 2
Unit Letter B	Section 5	Township 25 North	Range 2 West	County Rio Arriba	
Actual Footage Location of Well: (cardinal) 910 feet from the North line and 1705 feet from the East line					
Ground Level Elev. 7394	Producing Formation Mancos	Pool Gavilan	Dedicated Acreage: 37.0-20 Acres		

1. Outline the acreage dedicated to the subject well by colored pencil or hatchure marks on the plat below.
2. If more than one lease is dedicated to the well, outline each and identify the ownership thereof (both as to working interest and royalty).
3. If more than one lease of different ownership is dedicated to the well, have the interests of all owners been consolidated by communitization, unitization, force-pooling, etc?

☐ Yes ☐ No If answer is "yes," type of consolidation _____

If answer is "no," list the owners and tract descriptions which have actually been consolidated. (Use reverse side of this form if necessary.) _____

No allowable will be assigned to the well until all interests have been consolidated (by communitization, unitization, forced-pooling, or otherwise) or until a non-standard unit, eliminating such interests, has been approved by the Division.

* Record GLO 1917 plot

Ft. 1916 B.C.

Ft. 1916 B.C.

RECEIVED NOV 13 1986 BUREAU OF LAND MANAGEMENT FARMINGTON RESOURCE AREA	80.0* 910' FEL Prowler #2 1705' FEL NM-01806
	MGR 60.9375% Dugan 25.0000% NWPL 14.0625% NM-01804
79.93* 50° 3' E RECEIVED MAR 18 1987 BUREAU OF LAND MANAGEMENT FARMINGTON RESOURCE AREA	Reading & Bates 33.3333% HK&W, Inc. 33.3333% P.C., Ltd 15.6087% Ibex Petroleum 15.6087% Clark & Oatman 2.1160% NM-01804
50° 3' E RECEIVED MAR 20 1987 OIL CON. DIV. DIST. 3	Chevron-100% MG, Ltd-95.00% Arriba, Ltd - 5.00% SF-079332 NM-43749 79.93* N 89° 56' W

CERTIFICATION

I hereby certify that the information contained herein is true and complete to the best of my knowledge and belief.

Robert M. Bradford
Name

Petroleum Engineer
Position

Mesa Grande Resources, Inc
Company

11/11/86
Date

Date

I hereby certify that the well location shown on this plat was plotted from field notes of actual surveys made by me or under my supervision, and that the same is true and correct to the best of my knowledge and belief.

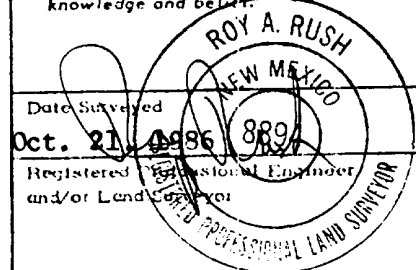

Date Surveyed

Oct. 21, 1986

Registered Professional Engineer and/or Land Surveyor

Certificate No.

8894

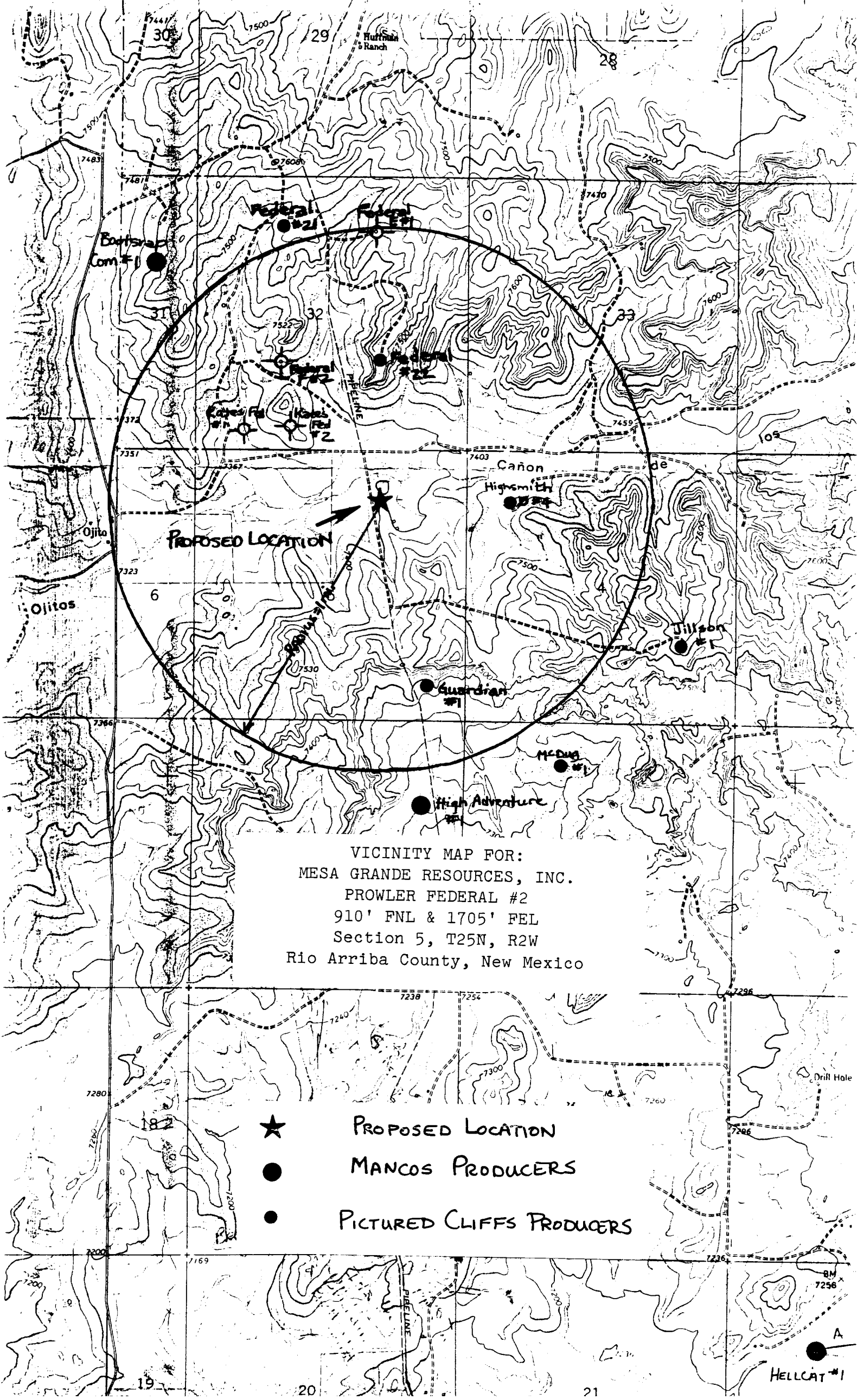

VICINITY MAP FOR:
MESA GRANDE RESOURCES, INC.
PROWLER FEDERAL #2
910' FNL & 1705' FEL
Section 5, T25N, R2W
Rio Arriba County, New Mexico



PROPOSED LOCATION



MANCOS PRODUCERS



PICTURED CLIFFS PRODUCERS

HELLCAT #1