

UNITED STATES
DEPARTMENT OF THE INTERIOR
BUREAU OF LAND MANAGEMENT

APPLICATION FOR PERMIT TO DRILL, DEEPEN, OR PLUG BACK

1a. TYPE OF WORK

DRILL ☒

DEEPEN ☐

PLUG BACK ☐

b. TYPE OF WELL

OIL
WELL ☒

GAS
WELL ☐

OTHER ☐

SINGLE
ZONE ☒

MULTIPLE
ZONE ☐

2. NAME OF OPERATOR

JACK A. COLE

3. ADDRESS OF OPERATOR

FARMINGTON RESOURCE AREA

P.O. Box 191, Farmington, New Mexico 87499

4. LOCATION OF WELL (Report location clearly and in accordance with any State requirements.)*

At surface

1680' FSL, 750 FEL

At proposed prod. zone

SAME

14. DISTANCE IN MILES AND DIRECTION FROM NEAREST TOWN OR POST OFFICE*

10 miles NW Counselor's Trading Post, New Mexico

15. DISTANCE FROM PROPOSED*
LOCATION TO NEAREST
PROPERTY OR LEASE LINE, FT.
(Also to nearest drig. unit line, if any)

16. NO. OF ACRES IN LEASE

1202.88 640

17. NO. OF ACRES ASSIGNED
TO THIS WELL

40

18. DISTANCE FROM PROPOSED LOCATION*
TO NEAREST WELL, DRILLING, COMPLETED,
OR APPLIED FOR, ON THIS LEASE, FT.

19. PROPOSED DEPTH

5655

20. ROTARY OR CABLE TOOLS

Rotary

21. ELEVATIONS (Show whether DE, RT, GR, etc.)

6807GR

SUBJECT TO COMPLIANCE WITH ATTACHED

22. APPROX. DATE WORK WILL START*

May 15, 1987

23. "GENERAL REQUIREMENTS" AND CEMENTING PROGRAM

SIZE OF HOLE	SIZE OF CASING	WEIGHT PER FOOT	SETTING DEPTH	Procedure, rev. and appeal
12 1/2"	8 5/8"	24.0 J-55	250'	250 sacks
7 7/8"	4 1/2"	10.50 K-55	5655'	to be determined after logging.

All producing intervals in Gallup formation will be stimulated as necessary.

Exhibits:

"A" Location and elevation plat

"B" Ten point compliance program

"C" Blowout preventor diagram

"D" Multi-point requirements of APD

"E" Access road to location

"F" Drill rig layout

"G" Fracturing program layout

"H" Location profile

"I" Proposed pipeline

The gas for this well is committed.

RECEIVED
JUN -1 1987

OIL CON. DIV.
DIST. 3

IN ABOVE SPACE DESCRIBE PROPOSED PROGRAM: If proposal is to deepen or plug back, give data on present productive zone and proposed new productive zone. If proposal is to drill or deepen directionally, give pertinent data on subsurface locations and measured and true vertical depths. Give blowout preventer program, if any.

SIGNED Dwayne Blount

TITLE Production Superintendent

DATE 4-21-87

(This space for Federal or State office use)

PERMIT NO. ok

APPROVAL DATE 6/2

APPROVED
AS AMENDED

MAY 28 1987

/s/ J. Stan McKee

FOR AREA MANAGER

"Approval of this action does
not warrant that the applicant
holds legal or equitable rights
or title to this lease."

*See Instructions On Reverse Side

Title 18 U.S.C. Section 1001, makes it a crime for any person knowingly and willfully to make to any department or agency of the

All distances must be from the outer boundaries of the Section.

Operator JACK A. COLE		Lessee MARCUS ¹⁶ 4		Well No. # 98
Unit Letter I	Section 35	Township 24 NORTH	Range 7 WEST	County RIO ARriba
Actual Footage Location of Well: 1680 feet from the SOUTH line and 750 feet from the EAST line				
Ground Level Elev. 6807	Producing Formation Gallup	Pool Lybrook Gallup-EXT	Dedicated Acreage 40 Acres	

1. Outline the acreage dedicated to the subject well by colored pencil or hachure marks on the plat below.
2. If more than one lease is dedicated to the well, outline each and identify the ownership thereof (both as to working interest and royalty).
3. If more than one lease of different ownership is dedicated to the well, have the interests of all owners been consolidated by communitization, unitization, force-pooling, etc?

☐ Yes ☐ No If answer is "yes," type of consolidation _____

If answer is "no," list the owners and tract descriptions which have actually been consolidated. (Use reverse side of this form if necessary.) _____

No allowable will be assigned to the well until all interests have been consolidated (by communitization, unitization, forced-pooling, or otherwise) or until a non-standard unit, eliminating such interests, has been approved by the Division.

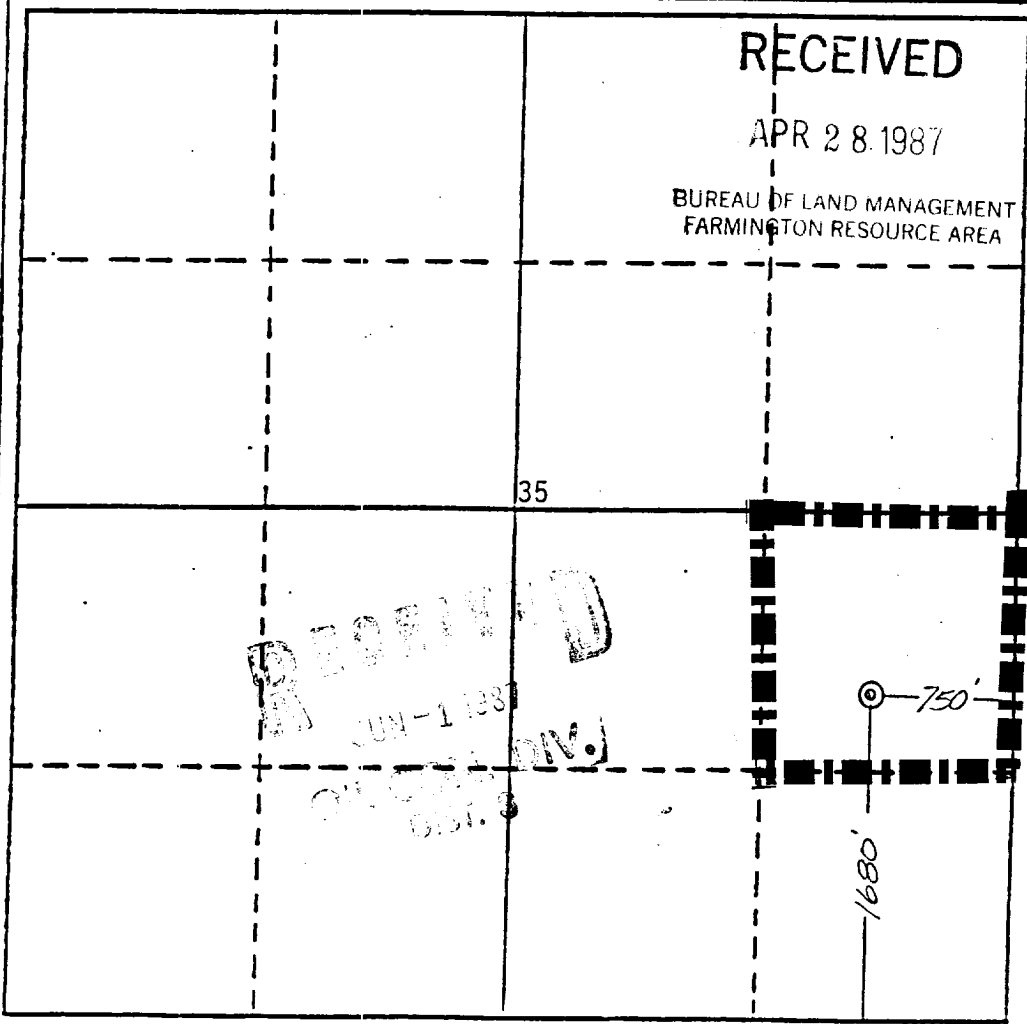

CERTIFICATION

I hereby certify that the information contained herein is true and complete to the best of my knowledge and belief.

Dewayne Blancett
Name

Dewayne Blancett

Position
Production Superintendent

Company
Cole Production Co.

Date
4-21-87

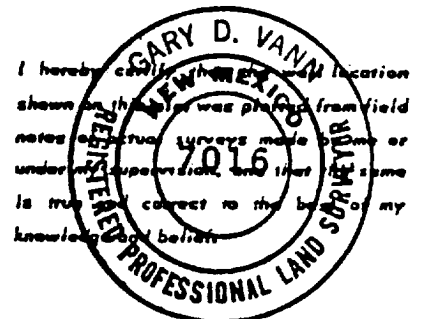

Date Surveyed
April 1, 1987

Registered Professional Engineer
and/or Land Surveyor
Gary D. Vann

Gary D. Vann

Certificate No.
7016

EXHIBIT "E"

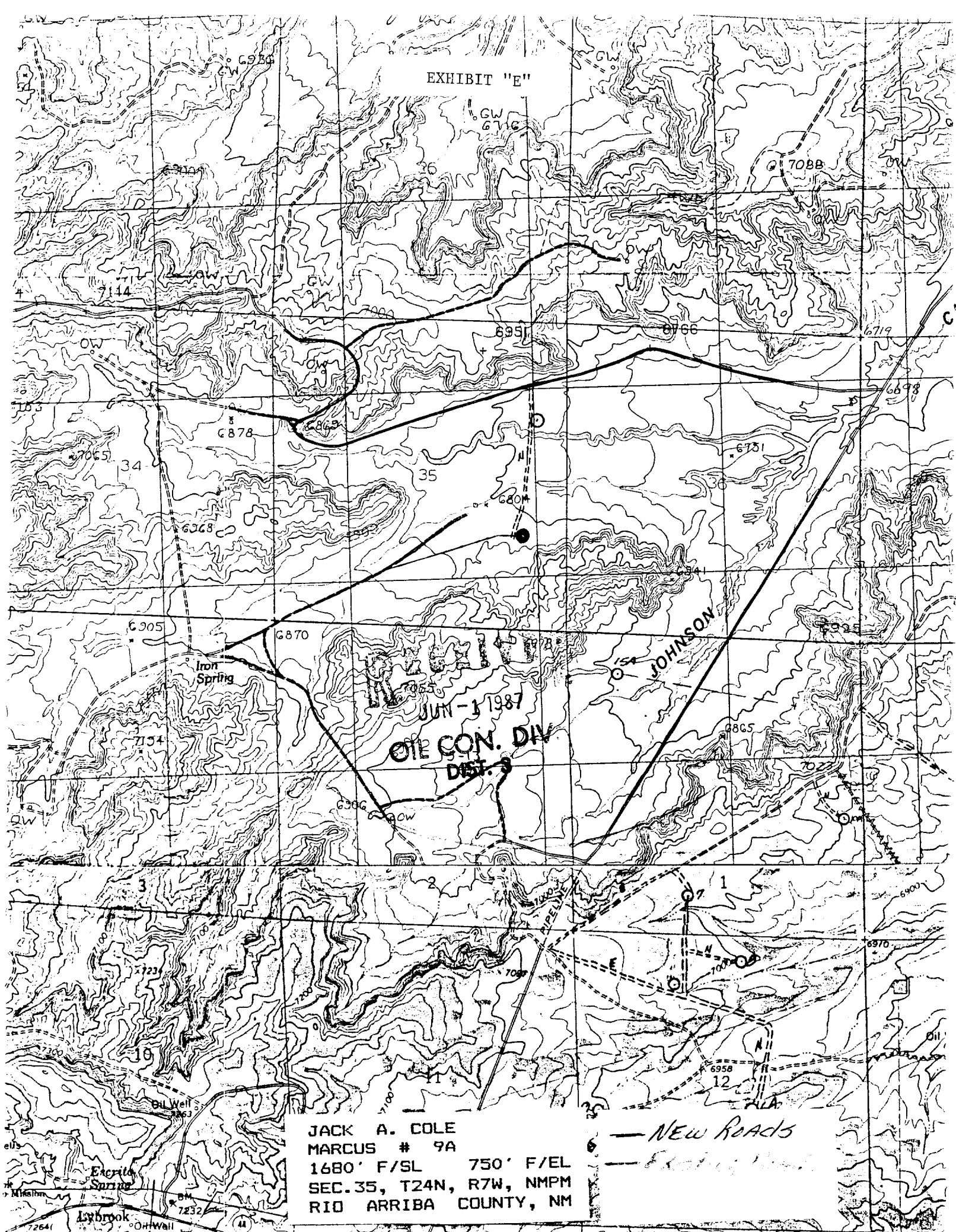

JACK A. COLE
 MARCUS # 9A
 1680' F/SL 750' F/EL
 SEC. 35, T24N, R7W, NMPM
 RIO ARRIBA COUNTY, NM

NEW ROADS