

UNITED STATES
DEPARTMENT OF THE INTERIOR
BUREAU OF LAND MANAGEMENT

APPLICATION FOR PERMIT TO DRILL, DEEPEN, OR PLUG BACK

1a. TYPE OF WORK

DRILL ☒

DEEPEN ☐

PLUG BACK ☐

b. TYPE OF WELL

OIL
WELL ☒

GAS
WELL ☐

OTHER ☐

2. NAME OF OPERATOR

Bannon Energy, Inc.

3. ADDRESS OF OPERATOR

P.O. Box 2058, Farmington NM 87499

4. LOCATION OF WELL (Report location clearly and in accordance with any State requirements.)*

At surface

980

330' FNL, 785' FWL

At proposed prod. zone
same

14. DISTANCE IN MILES AND DIRECTION FROM NEAREST TOWN OR POST OFFICE*

7 1/2 miles NNW from Counselors Trading Post

15. DISTANCE FROM PROPOSED*

LOCATION TO NEAREST
PROPERTY OR LEASE LINE, FT.
(Also to nearest drlg. unit line, if any)

13. DISTANCE FROM PROPOSED LOCATION*

TO NEAREST WELL, DRILLING, COMPLETED,
OR APPLIED FOR, ON THIS LEASE, FT.

21. ELEVATIONS (Show whether DF, RT, GR, etc.)

6654' GR

23.

PROPOSED CASING AND CEMENTING PROGRAM

SIZE OF HOLE	SIZE OF CASING	WEIGHT PER FOOT	SETTING DEPTH
12 1/4"	8 5/8"	24.0 lb. J-55	300'
7 7/8"	4 1/2"	10.5 lb. K-55	5800'

16. NO. OF ACRES IN LEASE

560

17. NO. OF ACRES ASSIGNED

TO THIS WELL
160

19. PROPOSED DEPTH

5800'

20. ROTARY OR CABLE TOOLS

Rotary

22. APPROX. DATE WORK WILL START*

September 1, 1989

This action is subject to technical and
procedural review pursuant to 43 CFR 3165.3
and appeal pursuant to 43 CFR 3165.4.

Cement to Surface

800 sx - volumes to be
calculated subsequent to
logging.

NOV 03 1989

OIL CON. DIV

WELL to be drilled to penetrate the Gallup Formation. All producing
intervals in the Gallup will be stimulated as necessary.

EXHIBITS:

- "A" Location and Elevation Plat
 - "B" Ten point compliance program
 - "C" Blowout preventor diagram
 - "D" Multi-point requirements of APD
- The gas from this lease is committed.

- "E" Site specific checklist
for roads
- "F" Drill rig layout
- "G" Completion program layout
- "H" Location Profile
- "I" Proposed Pipeline

IN ABOVE SPACE DESCRIBE PROPOSED PROGRAM: If proposal is to deepen or plug back, give data on present productive zone and proposed new productive zone. If proposal is to drill or deepen directionally, give pertinent data on subsurface locations and measured and true vertical depths. Give blowout preventer program, if any.

SIGNED

TITLE Agent for Bannon Energy Inc. 7/24/89

(This space for Federal or State office use)

PERMIT NO.

APPROVAL DATE

APPROVED BY

TITLE

CONDITIONS OF APPROVAL, IF ANY:

APPROVED

AS AMENDED

NOV 01 1989

AREA MANAGER

*See Instructions On Reverse Side

Submit to Appropriate
District Office
State Lease - 4 copies
Fee Lease - 3 copies

State of New Mexico
Energy, Minerals and Natural Resources Department

Form C-102
Revised 1-1-89

OIL CONSERVATION DIVISION

P.O. Box 2088
Santa Fe, New Mexico 87504-2088

DISTRICT I
P.O. Box 1980, Hobbs, NM 88240

DISTRICT II
P.O. Drawer DD, Artesia, NM 88210

DISTRICT III
1000 Rio Brazos Rd., Aztec, NM 87410

WELL LOCATION AND ACREAGE DEDICATION PLAT

All Distances must be from the outer boundaries of the section

Operator Bannon Energy, Inc.			Lease Federal 24		Well No. 24-1R
Unit Letter D	Section 24	Township T.24 N.	Range R.7 W.	County NMPM	Rio Arriba
Actual Footage Location of Well: 980 feet from the North line and 985 feet from the West line					
Ground level Elev. 6687	Producing Formation Gallup		Pool Devils Fork	Dedicated Acreage: 168 Acres	

1. Outline the acreage dedicated to the subject well by colored pencil or hatchure marks on the plat below.
2. If more than one lease is dedicated to the well, outline each and identify the ownership thereof (both as to working interest and royalty).
3. If more than one lease of different ownership is dedicated to the well, have the interest of all owners been consolidated by communitization, unitization, force-pooling, etc.?
☐ Yes ☐ No If answer is "yes" type of consolidation _____

If answer is "no" list the owners and tract descriptions which have actually been consolidated. (Use reverse side of this form if necessary.)

No allowable will be assigned to the well until all interests have been consolidated (by communitization, unitization, forced-pooling, or otherwise) or until a non-standard unit, eliminating such interest, has been approved by the Division.

OPERATOR CERTIFICATION

I hereby certify that the information contained herein in true and complete to the best of my knowledge and belief.

Signature
Printed Name

Position

Company

Date

SURVEYOR CERTIFICATION

I hereby certify that the well location shown on this plat was plotted from field notes of actual surveys made by me or under my supervision, and that the same is true and correct to the best of my knowledge and belief.

Date Surveyed
Signature & Seal of New Mexico Professional Surveyor

Howard Dagges
Professional Surveyor

Certificate No. 9697
Registered Professional Land Surveyor

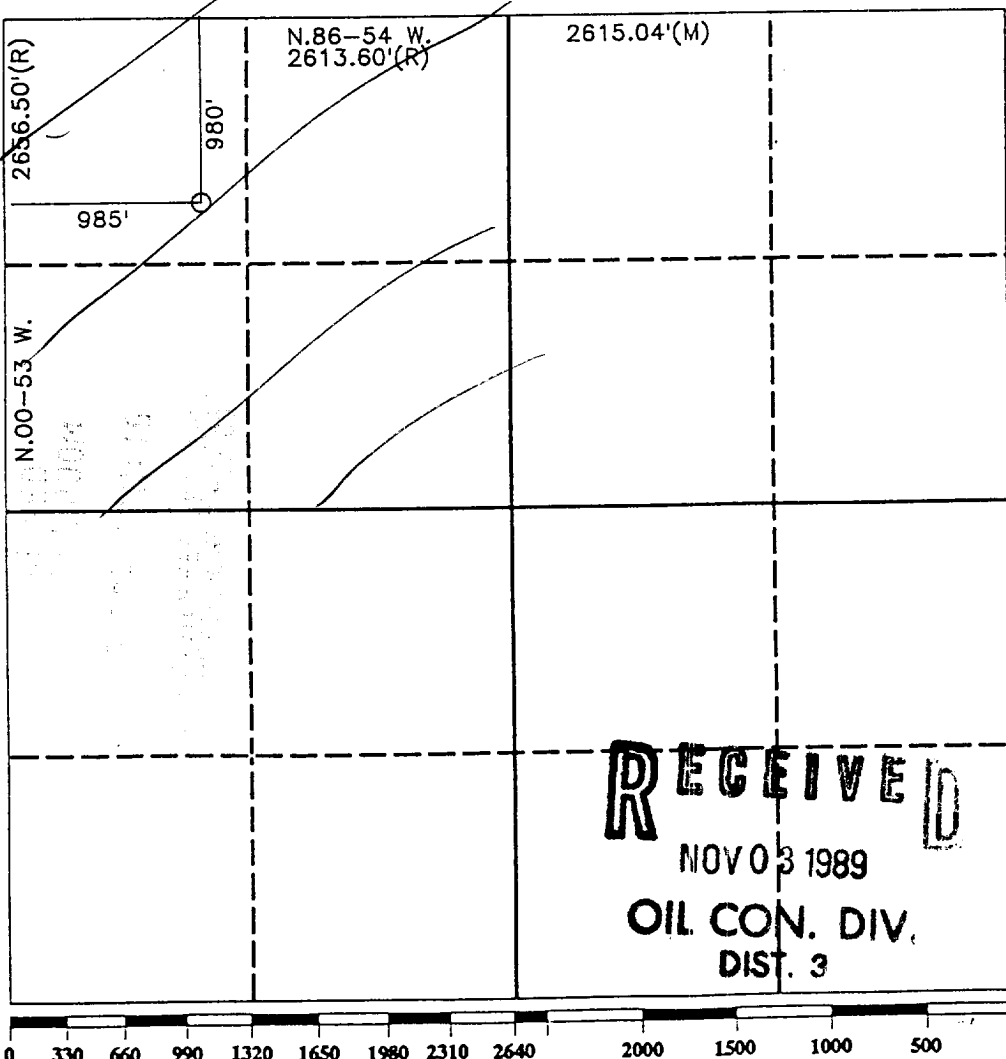

UNITED STATES
DEPARTMENT OF THE INTERIOR
BUREAU OF LAND MANAGEMENT

SUBMIT IN TRIPLICATE*
(Other instructions on re-
verse side)

Form approved.
Budget Bureau No. 1004-0135
Expires August 31, 1985

SUNDRY NOTICES AND REPORTS ON WELLS

(Do not use this form for proposals to drill or to deepen or plug back to a different reservoir.
Use "APPLICATION FOR PERMIT—" for such proposals.)

1. OIL WELL <input checked="" type="checkbox"/> GAS WELL <input type="checkbox"/> OTHER <input type="checkbox"/>		5. LEASE DESIGNATION AND SERIAL NO. SF 078563
2. NAME OF OPERATOR Bannon Energy, Inc.		6. IF INDIAN, ALLOTTEE OR TRIBE NAME Federal
3. ADDRESS OF OPERATOR P.O. Box 2058, Farmington, NM 87499		7. UNIT AGREEMENT NAME
4. LOCATION OF WELL (Report location clearly and in accordance with any State requirements.* See also space 17 below.) At surface Unit C 330' FNL 2130' FWL		8. FARM OR LEASE NAME Grace Federal 24
14. PERMIT NO.		9. WELL NO. 1R
15. ELEVATIONS (Show whether DP, RT, GR, etc.) 6654' GR		10. FIELD AND POOL, OR WILDCAT Devils Fork Gallup
		11. SEC., T., E., M., OR BLK. AND SURVEY OR AREA Sec. 24 T24N R7W
		12. COUNTY OR PARISH Rio Arriba
		13. STATE NM

16. Check Appropriate Box To Indicate Nature of Notice, Report, or Other Data

NOTICE OF INTENTION TO:		SUBSEQUENT REPORT OF:	
TEST WATER SHUT-OFF <input type="checkbox"/>	PULL OR ALTER CASING <input type="checkbox"/>	WATER SHUT-OFF <input type="checkbox"/>	REPAIRING WELL <input type="checkbox"/>
FRACTURE TREAT <input type="checkbox"/>	MULTIPLE COMPLETE <input type="checkbox"/>	FRACTURE TREATMENT <input type="checkbox"/>	ALTERING CASING <input type="checkbox"/>
SHOOT OR ACIDIZE <input type="checkbox"/>	ABANDON* <input type="checkbox"/>	SHOOTING OR ACIDIZING <input type="checkbox"/>	ABANDONMENT* <input type="checkbox"/>
REPAIR WELL <input type="checkbox"/>	CHANGE PLANT <input type="checkbox"/>	(Other) <input type="checkbox"/>	(Other) <input type="checkbox"/>
(Other) AMEND APD <input type="checkbox"/>		(NOTE: Report results of multiple completion on Well Completion or Recompletion Report and Log form.)	

17. DESCRIBE PROPOSED OR COMPLETED OPERATIONS (Clearly state all pertinent details, and give pertinent dates, including estimated date of starting any proposed work. If well is directionally drilled, give subsurface locations and measured and true vertical depths for all markers and zones pertinent to this work.)*

The following is intended to satisfy BOP requirements as specified in Onshore Order #2 (See Attachment No. 1).

1. No annular preventers will be used BOP to be used is equipped with blind rams and drill pipe rams. *
2. Upper kelly cock will be in use with handle available on drill floor.
3. Safety valve and subs will fit all drill string connections in use.
4. All BOP connections subjected to well pressure will be flanged. *
5. All lines to and from BOP stack and valves therein will be 2", except the flow line which will be 3".

18. I hereby certify that the foregoing is true and correct

SIGNED W. D. Holcomb TITLE Agent, Bannon Energy, Inc. DATE Sept. 26, 1989

(This space for Federal or State office use)

APPROVED BY _____ TITLE _____ DATE _____
CONDITIONS OF APPROVAL, IF ANY:

*See Instructions on Reverse Side

EXHIBIT C

Grace Federal 24-1R
Sec. 24 T24N R1W
Rio Arriba County, NM
2 M System

