

Submit to Appropriate
District Office
State Lease - 6 copies
Fee Lease - 5 copies

State of New Mexico
Energy, Minerals and Natural Resources Department

Form C-101
Revised 1-1-89

OIL CONSERVATION DIVISION
P.O. Box 2088
Santa Fe, New Mexico 87504-2088

DISTRICT I
P.O. Box 1980, Hobbs, NM 88240

DISTRICT II
P.O. Drawer DD, Artesia, NM 88210

DISTRICT III
1000 Rio Brazos Rd., Aztec, NM 87410

API NO. (assigned by OCD on New Wells)

30-039-24872

5. Indicate Type of Lease

STATE ☒

FEE ☐

6. State Oil & Gas Lease No.

E-6833

APPLICATION FOR PERMIT TO DRILL, DEEPEN, OR PLUG BACK

1a. Type of Work:

DRILL ☒

RE-ENTER ☐

DEEPEN ☐

PLUG BACK ☐

b. Type of Well:

OIL
WELL ☒

GAS
WELL ☐

OTHER ☐

SINGLE
ZONE ☐

MULTIPLE
ZONE ☐

7. Lease Name or Unit Agreement Name

STATE 32

2. Name of Operator

Bannon Energy, Inc., c/o Daggett & Chenault, Inc.

3. Address of Operator

3539 E. 30th, Suite 7B, Farmington, NM 87401

8. Well No.

5

9. Pool name or Wildcat

Lybrook/Gallup Ext.

4. Well Location

Unit Letter

B

591

Feet From The North

Line and

1991

Feet From The

East

Line

Section

32

Township

24N

Range

7W

NMPM Rio Arriba,

County

10. Proposed Depth
5800'

11. Formation

Gallup

12. Rotary or C.T.

Rotary

13. Elevations (Show whether DF, RT, GR, etc.)

7426 GL

14. Kind & Status Plug. Boord

15. Drilling Contractor

16. Approx. Date Work will start
August 15, 1990

17. PROPOSED CASING AND CEMENT PROGRAM

SIZE OF HOLE	SIZE OF CASING	WEIGHT PER FOOT	SETTING DEPTH	SACKS OF CEMENT	EST. TOP
12 1/4"	8 5/8"	24.0 lb. J-55	300'	Cement to surface	
7 7/8"	4 1/2"	11.6 lb. K-55	5800'	800 SX-Vol. to be	
				calculated subsequent to	

logging & circulated to surface.

Well to be drilled to penetrate the Gallup formation. All producing intervals in the Gallup will be stimulated as necessary.

EXHIBITS:

"A" Topo map

"B" BOP

BOP = API series 2000'

RECEIVED

AUG 10 1990

OIL CON. DIV
DIST. 3

IN ABOVE SPACE DESCRIBE PROPOSED PROGRAM: IF PROPOSAL IS TO DEEPEN OR PLUG BACK, GIVE DATA ON PRESENT PRODUCTIVE ZONE AND PROPOSED NEW PRODUCTIVE ZONE. GIVE BLOWOUT PREVENTER PROGRAM, IF ANY.

I hereby certify that the information above is true and complete to the best of my knowledge and belief.

SIGNATURE

R. Howard Daggett

TITLE Agent, Daggett & Chenault DATE 8-10-90

TYPE OR PRINT NAME R. Howard Daggett

TELEPHONE NO. (505) 326-171

(This space for State Use)

APPROVED BY Original Signed by FRANK T. CHAVEZ

TITLE

SUPERVISOR DISTRICT

DATE

AUG 13 1990

CONDITIONS OF APPROVAL, IF ANY:

APPROVAL EXPIRES 2-13-91
UNLESS DRILLING IS COMMENCED.
SPUD NOTICE MUST BE SUBMITTED
WITHIN 10 DAYS.

Submit to Appropriate
District Office
State Lease - 4 copies
Fee Lease - 3 copies

State of New Mexico
Energy, Minerals and Natural Resources Department

Form C-102
Revised 1-1-89

OIL CONSERVATION DIVISION

P.O. Box 2088
Santa Fe, New Mexico 87504-2088

DISTRICT I
P.O. Box 1980, Hobbs, NM 88240

DISTRICT II
P.O. Drawer DD, Artesia, NM 88210

DISTRICT III
1000 Rio Brazos Rd., Aztec, NM 87410

WELL LOCATION AND ACREAGE DEDICATION PLAT

All Distances must be from the outer boundaries of the section

Operator BANNON ENERGY, INC.			Lease STATE 32		Well No. 5
Unit Letter B	Section 32	Township T.24 N.	Range R.7 W.	County RIO ARriba COUNTY	
Actual Footage Location of Well: 591 feet from the NORTH line and 1991 feet from the EAST line					
Ground level Elev. 7426	Producing Formation Gallup		Pool Lybrook Ext.	Dedicated Acreage: 40 Acres	

1. Outline the acreage dedicated to the subject well by colored pencil or hachure marks on the plat below.

2. If more than one lease is dedicated to the well, outline each and identify the ownership thereof (both as to working interest and royalty).

3. If more than one lease of different ownership is dedicated to the well, have the interest of all owners been consolidated by communitization, unitization, force-pooling, etc.?

☐ Yes ☐ No If answer is "yes" type of consolidation _____

If answer is "no" list the owners and tract descriptions which have actually been consolidated. (Use reverse side of this form if necessary.) _____

No allowable will be assigned to the well until all interests have been consolidated (by communitization, unitization, forced-pooling, or otherwise) or until a non-standard unit, eliminating such interest, has been approved by the Division.

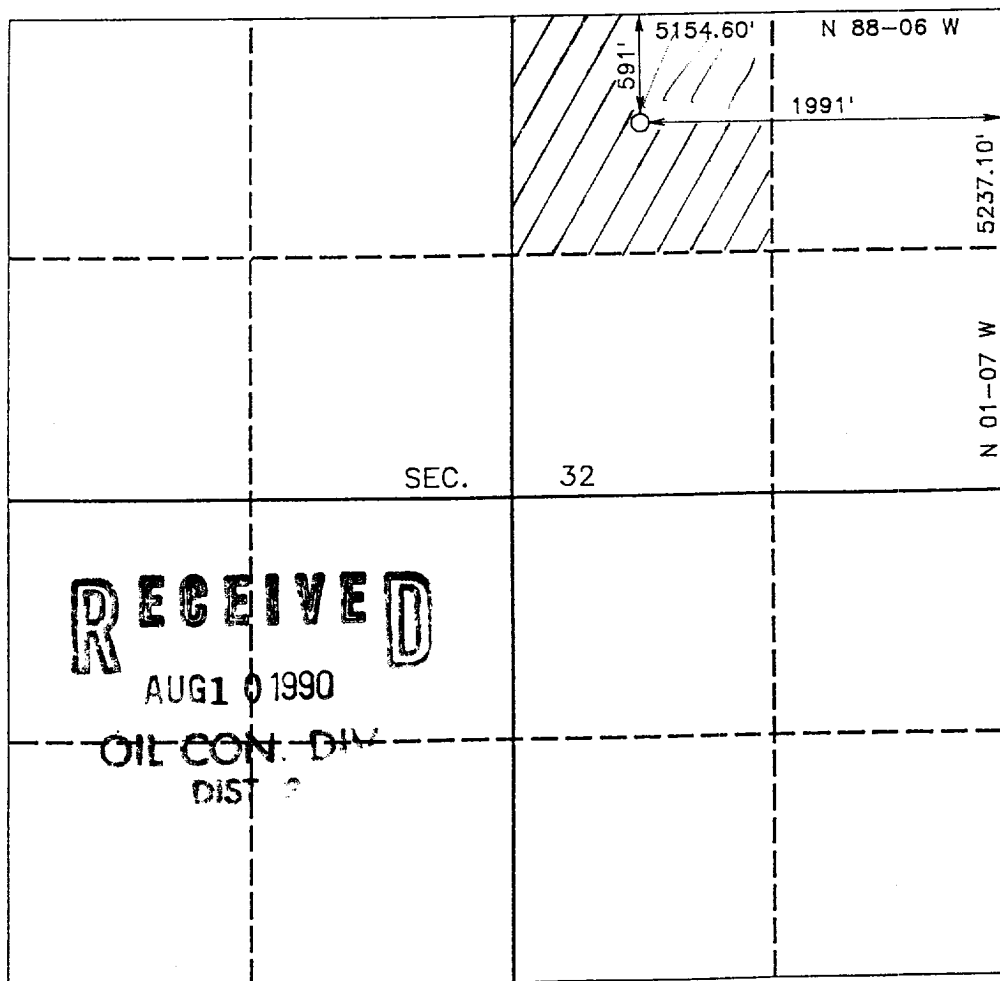

OPERATOR CERTIFICATION

I hereby certify that the information contained herein is true and complete to the best of my knowledge and belief.

Signature

Printed Name

R. Howard Daggett

Position

Right of Way Agent

Company

Daggett & Chenault Inc.

Date

August 13, 1990

SURVEYOR CERTIFICATION

I hereby certify that the well location shown on this plat was plotted from field notes of actual surveys made by me or under my supervision, and that the same is true and correct to the best of my knowledge and belief.

Date Surveyed

MARCH 25, 1990

Signature & Seal
Professional Surveyor

R. HOWARD DAGGETT

Certificate No.

8679
Registered Professional
Land Surveyor

FARMINGTON DISTRICT BLOWOUT PREVENTER REQUIREMENTS

EXHIBIT "B"

1. Blowout Preventers and Master Valve to be fluid operated, and all fittings must be in good condition. Handwheels must be installed prior to drilling out.
2. Equipment through which bit must pass shall be as large as the inside diameter of the casing that is being drilled through.
3. All fittings to be flanged, (except for flare line).
4. Full opening safety valve and inside BOP valve must be available on rig floor at all times with proper connection or sub for drill pipe and drill collars.
5. Upper kelly cock will be in use with handle available on drill floor.

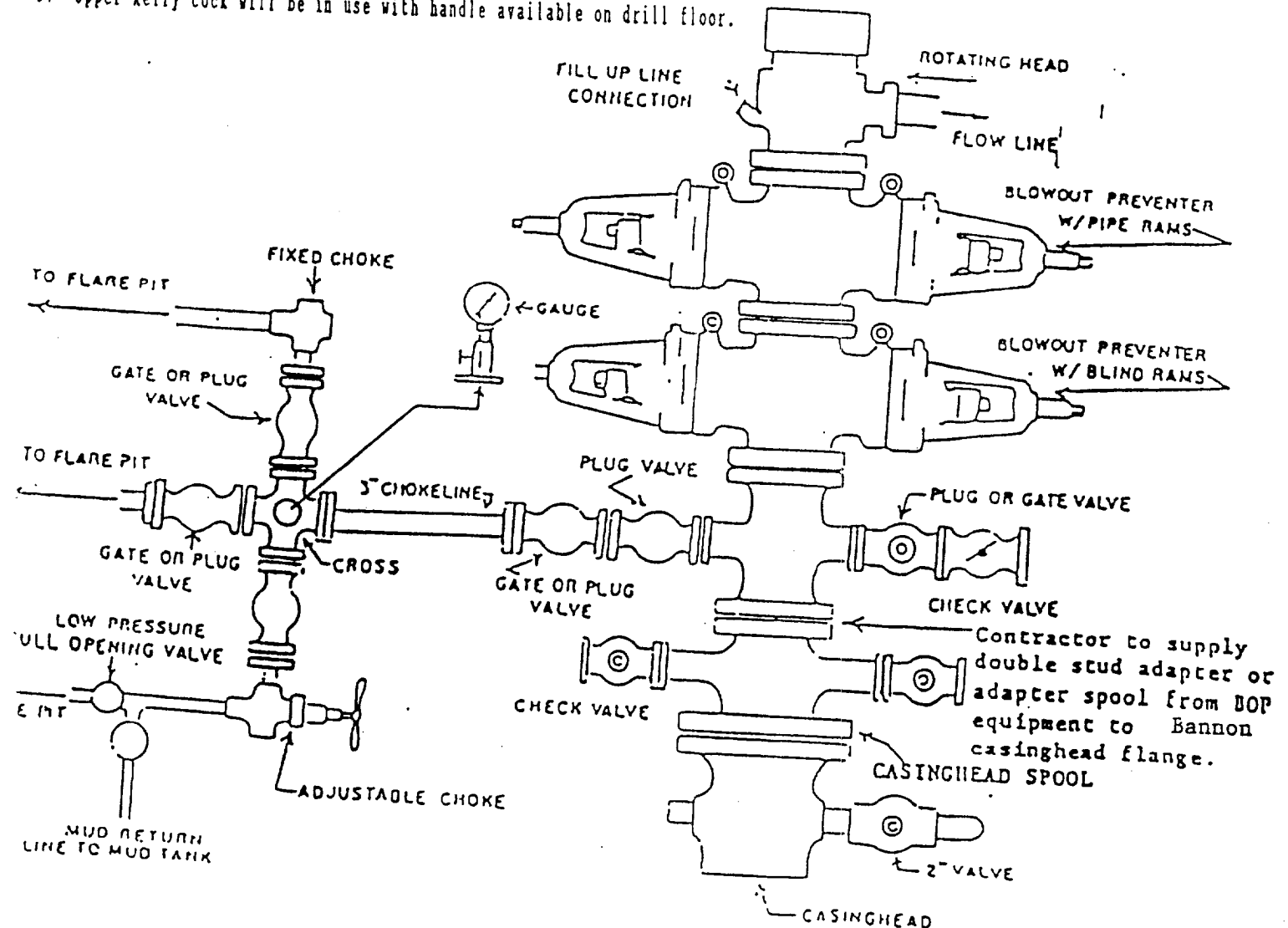

BLOWOUT PREVENTER HOOKUP

API Series 7 2000

ration of BOP by closing both pipe and blind rams will be tested each trip or, on long runs, pipe rams will be closed once each 24 hours.

State 32-5
591 FNL, 1991 FEL
Section 32, T24N-R7W
Rio Arriba Co., NM

