





Submit to Appropriate  
District Office  
State Lease - 4 copies  
Fee Lease - 3 copies

DISTRICT I  
P.O. Box 1980, Hobbs, NM 88240

DISTRICT II  
P.O. Drawer DD, Artesia, NM 88210

DISTRICT III  
1000 Rio Brazos Rd., Aztec, NM 87410

State of New Mexico  
Energy, Minerals and Natural Resources Department

OIL CONSERVATION DIVISION

P.O. Box 2088  
Santa Fe, New Mexico 87504-2088

RECEIVED  
SLM

Form C-102  
Revised 1-1-89

JUL 14 AM 8:16

010 FARM, HOBBS, N.M.

WELL LOCATION AND ACREAGE DEDICATION PLAT

All Distances must be from the outer boundaries of the section

Operator <b>BANNON ENERGY, INC.</b>		Lease <b>LEESON</b>		Well No. <b>5</b>
Unit Letter <b>J</b>	Section <b>27</b>	Township <b>T.25 N.</b>	Range <b>R.3 W.</b>	County <b>RIO ARriba COUNTY</b>
Actual Footage Location of Well: <b>1663</b> feet from the <b>SOUTH</b> line and <b>2300</b> feet from the <b>EAST</b> line				
Ground level Elev. <b>7261</b>	Producing Formation <b>Gallup /Dakota</b>		Pool <b>West Lindrith Gallup/Dakota</b>	Dedicated Acreage: <b>160</b> Acres
1. Outline the acreage dedicated to the subject well by colored pencil or hatchure marks on the plat below.				
2. If more than one lease is dedicated to the well, outline each and identify the ownership thereof (both as to working interest and royalty).				
3. If more than one lease of different ownership is dedicated to the well, have the interest of all owners been consolidated by communitization, unitization, force-pooling, etc.? <input type="checkbox"/> Yes <input type="checkbox"/> No If answer is "yes" type of consolidation _____ If answer is "no" list the owners and tract descriptions which have actually been consolidated. (Use reverse side of this form if necessary.) No allowable will be assigned to the well until all interests have been consolidated (by communitization, unitization, forced-pooling, or otherwise) or until a non-standard unit, eliminating such interest, has been approved by the Division.				

OPERATOR CERTIFICATION

I hereby certify that the information contained herein is true and complete to the best of my knowledge and belief.

Signature  
*Robert S. Larson*  
Printed Name  
**Robert S. Larson**  
Position  
**Permit Agent**  
Company  
**Daggett & Chenault Inc.**  
Date  
**May 1, 1991**

SURVEYOR CERTIFICATION

I hereby certify that the well location shown on this plat was plotted from field notes of actual surveys made by me or under my supervision, and that the same is true and correct to the best of my knowledge and belief.

Date Surveyed  
**MARCH 15, 1991**

Signature of Surveyor  
*Henry Broadhurst, Jr.*  
Professional Surveyor  
**HENRY BROADHURST, JR.**  
Certificate No.  
**11393**  
REGISTERED PROFESSIONAL SURVEYOR

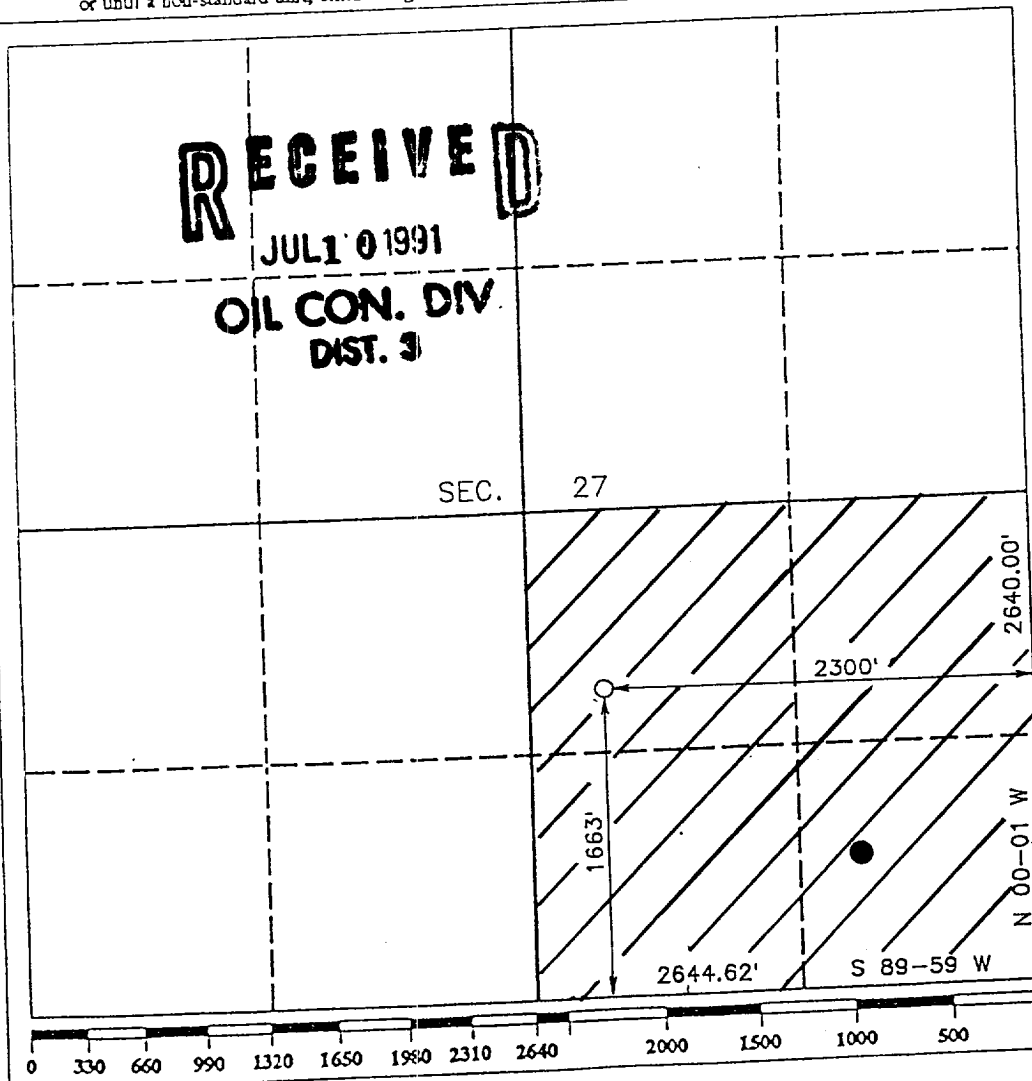



T25N-R3W

N





18' Culverts



Water Well

24' Culvert

Occupied Dwelling

BANNON ENERGY  
BANNON - LEESON NO. 5  
NW 1/4 SE 1/4, Sec. 27, T25N-R3W  
Rio Arriba County, NM

-  Staked Location
-  Proposed New Well
-  Producing Wells
-  Plugged or Abandoned Wells

-  Drilling Well
-  Water Wells
-  Reservoirs

Existing Road

Proposed New Access Road

