

UNITED STATES
DEPARTMENT OF THE INTERIOR
BUREAU OF LAND MANAGEMENT

APPLICATION FOR PERMIT TO DRILL, DEEPEN, OR PLUG BACK

1a. TYPE OF WORK

DRILL ☒

DEEPEN ☐

PLUG BACK ☐

b. TYPE OF WELL

OIL
WELL ☒

GAS
WELL ☐

OTHER

SINGLE
ZONE ☐

MULTIPLE
ZONE ☐

2. NAME OF OPERATOR

Mobil Producing Texas & New Mexico Inc.

3. ADDRESS OF OPERATOR % Mobil Exploration & producing US. INC
P O Box 633 Midland, Tx 79702

4. LOCATION OF WELL (Report location clearly and in accordance with any State requirements.)

At surface 990' FSL, 540' FWL

At proposed prod. zone
SAME

14. DISTANCE IN MILES AND DIRECTION FROM NEAREST TOWN OR POST OFFICE*

5 Miles NW of Lindrith, N.M.

15. DISTANCE FROM PROPOSED*

LOCATION TO NEAREST
PROPERTY OR LEASE LINE, FT.
(Also to nearest drlg. unit line, if any)

6200' FNE Corner

16. NO. OF ACRES IN LEASE

2370.92

18. DISTANCE FROM PROPOSED LOCATION*

TO NEAREST WELL, DRILLING, COMPLETED,
OR APPLIED FOR, ON THIS LEASE, FT.

8100' NW to #82

19. PROPOSED DEPTH

8900

7950

17. NO. OF ACRES ASSIGNED
TO THIS WELL

160 40

20. ROTARY OR CABLE TOOLS

Rotary

21. ELEVATIONS (Show whether DF, RT, GR, etc.) This action is subject to technical and
procedural review pursuant to 43 CFR 3165.3
and appeal pursuant to 43 CFR 3165.4.

GL - 7205

22. APPROX. DATE WORK WILL START*

June 1, 1992

23.

PROPOSED CASING AND CEMENTING PROGRAM

DRILLING OPERATIONS AUTHORIZED ARE
SUBJECT TO QUANTITIES WITH ATTACHED
"GENERAL REQUIREMENTS".

SIZE OF HOLE	SIZE OF CASING	WEIGHT PER FOOT	SETTING DEPTH
17 1/2	13 3/8	48#	450
11	7	26#	3300
8 3/4	7	26#	7950

665 cubic feet
1000 cubic feet
1800 cubic feet

See attached 8 Point Well Control Plan for Additional Drilling Information.

RECEIVED
JUN 11 1992
OIL CON. DIV.
DIST. 3

CONFIDENTIAL

IN ABOVE SPACE DESCRIBE PROPOSED PROGRAM: If proposal is to deepen or plug back, give data on present productive zone and proposed new productive zone. If proposal is to drill or deepen directionally, give pertinent data on subsurface locations and measured and true vertical depths. Give blowout preventer program, if any.

24.

SIGNED

Shakey Joda

TITLE Env. & Reg. Technician

DATE 5-6-92

(This space for Federal or State office use)

PERMIT NO.

APPROVAL DATE

APPROVED BY

TITLE

CONDITIONS OF APPROVAL, IF ANY:

APPROVED
AS AMENDED

JUN 02 1992

AREA MANAGER

*See Instructions On Reverse Side

EVIDENCE

[illegible]

**NEW MEXICO OIL CONSERVATION COMMISSION
WELL LOCATION AND ACREAGE DEDICATION PLAT**

Form C-189
Supersedes C-128
Effective 1-1-85

All distances must be from the outer boundaries of the Section.

RECEIVED

Operator MOBIL PRODUCING TX & NEW MEXICO INC.		Lease LINDRITH		Well No. B-84
MOBIL EXPLORATION & PRODUCING, UNITED STATES				
Unit Letter M	Section 16	Township 24 NORTH	Range 2 WEST	County RIO ARriba
Actual Footage Location of Well 990 feet from the SOUTH line and 540 feet from the WEST line				915 FARMINGTON, N.M.
Ground Level Elev. 7248.5 7249	Producing Formation DAKOTA	Pool LINDRITH DAKOTA	Dedicated Acreages 2370.92 46 Acres	

1. Outline the acreage dedicated to the subject well by colored pencil or hatchure marks on the plat below.
2. If more than one lease is dedicated to the well, outline each and identify the ownership thereof (both as to working interest and royalty).
3. If more than one lease of different ownership is dedicated to the well, have the interests of all owners been consolidated by communitization, unitization, force-pooling, etc?

☐ Yes ☐ No If answer is "yes," type of consolidation _____

If answer is "no," list the owners and tract descriptions which have actually been consolidated. (Use reverse side of this form if necessary.) _____

No allowable will be assigned to the well until all interests have been consolidated (by communitization, unitization, forced-pooling, or otherwise) or until a non-standard unit, eliminating such interests, has been approved by the Commission.

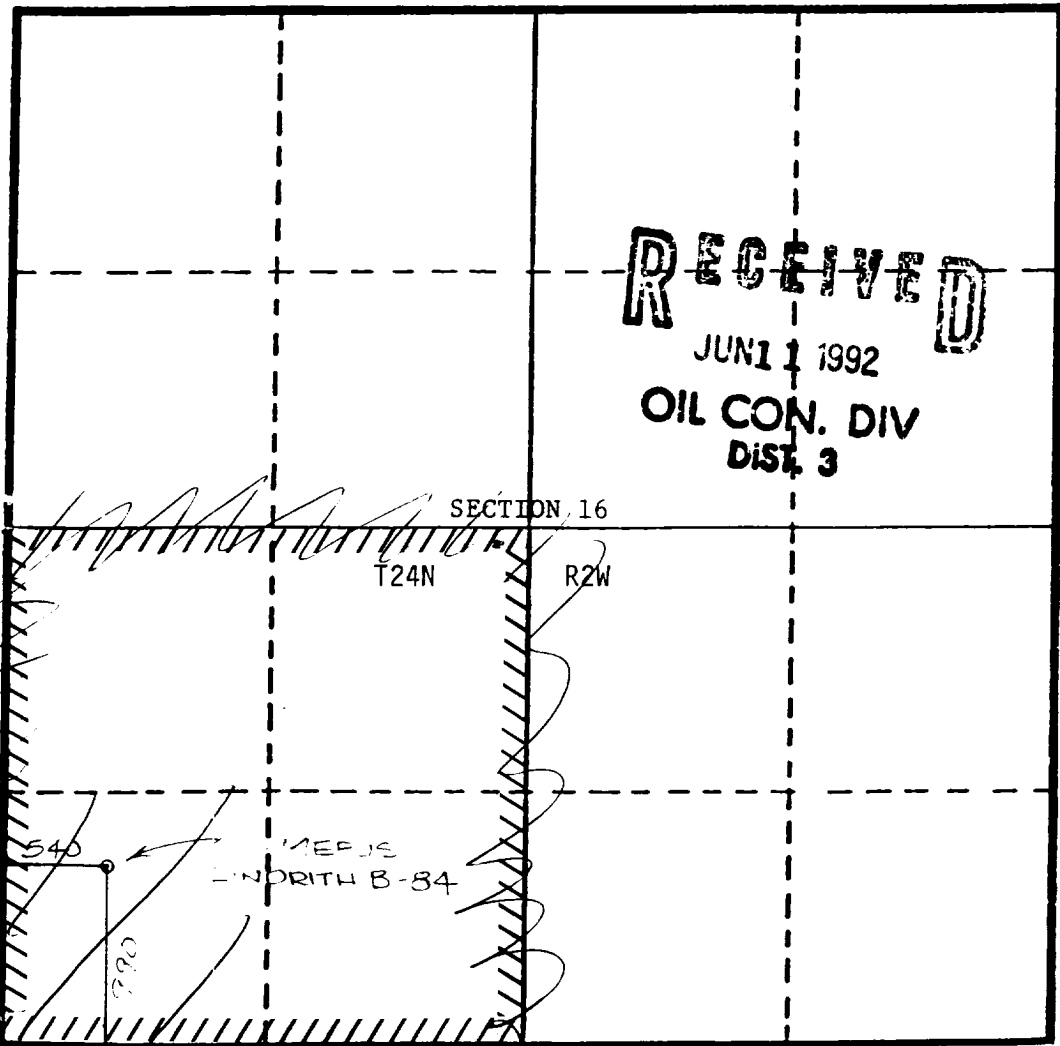

CERTIFICATION

I hereby certify that the information contained herein is true and complete to the best of my knowledge and belief.

Shirley Todd

Name
Shirley Todd

Position
Env. & Reg Technician

Company
Mobil Producing TX & NM Inc.

Date
5-6-92

I hereby certify that the well location shown on this plat was plotted from field notes of actual surveys made by me or under my supervision, and that the same is true and correct to the best of my knowledge and belief.

Date Surveyed
February 29, 1992

Registered Professional Surveyor
Robert B. Stannard Jr., P.S.

Certification No.
115085

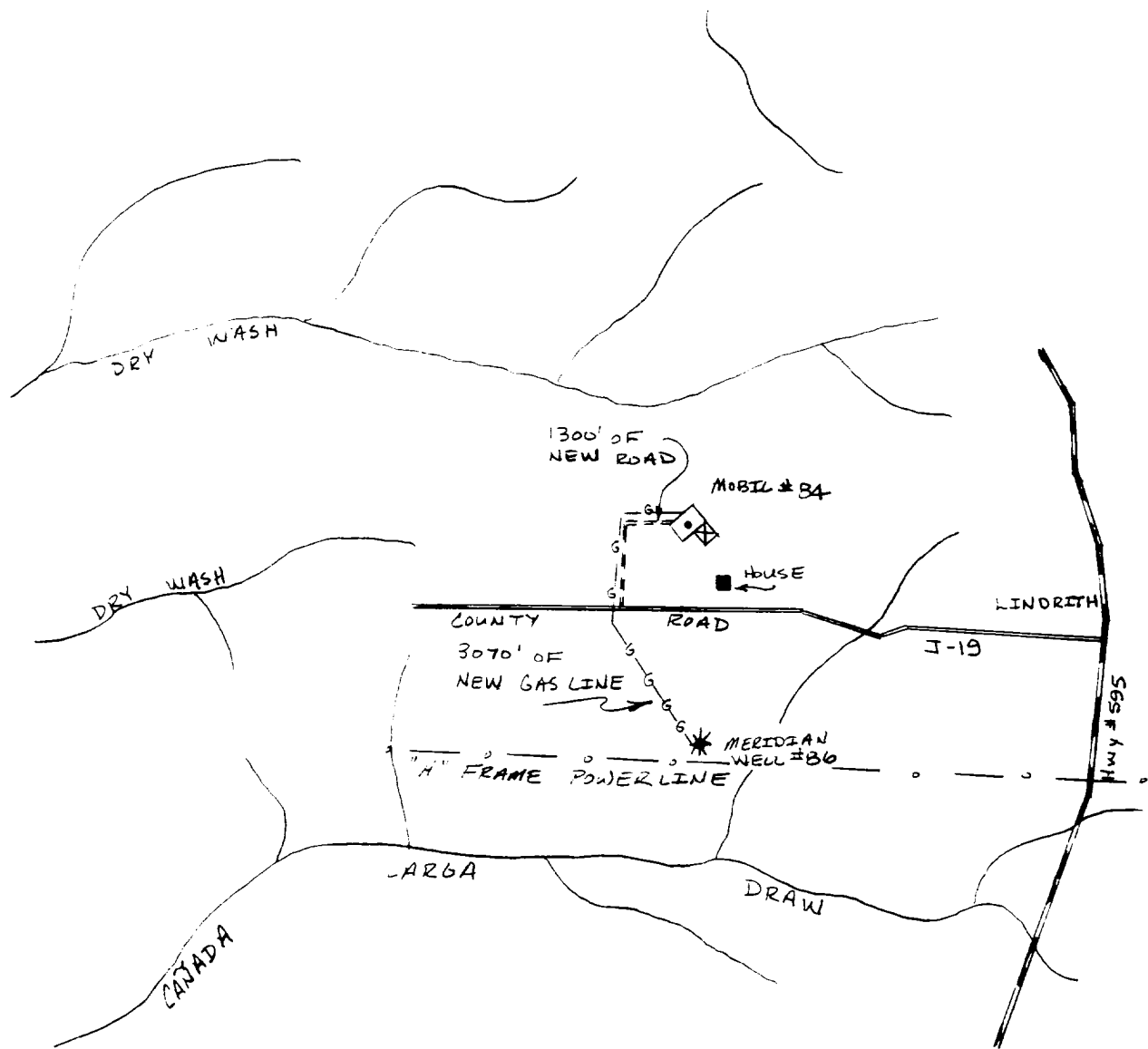

MOBIL EXPLORATION AND PRODUCING U.S. INC.
MIDLAND DIVISION

MAP "C"
LINDRITH "B" UNIT
LOCATION # 84
RIO ARRIBA COUNTY,
NEW MEXICO

S.E. WILKINSON 4-2-82 SCALE: 1" = 2000'