

UNITED STATES
DEPARTMENT OF THE INTERIOR
BUREAU OF LAND MANAGEMENT

FORM APPROVED
Budget Bureau No. 1004-0135
Expires: March 31, 1993

SUNDRY NOTICES AND REPORTS ON WELLS

Do not use this form for proposals to drill or to deepen or reentry to a different reservoir.
Use "APPLICATION FOR PERMIT—" for such proposals

5. Lease Designation and Serial No.
SF079602

6. If Indian, Allottee or Tribe Name

7. If Unit or CA, Agreement Designation

8. Well Name and No.
L.L. McCONNELL LEASE

9. API Well No.

10. Field and Pool, or Exploratory Area
West Lindrith GAL/DK

11. County or Parish, State
Rio Arriba, NM

SUBMIT IN TRIPLICATE

1. Type of Well
 Oil Well Gas Well Other

2. Name of Operator
Texaco Exploration & Production Inc.

3. Address and Telephone No.
3300 N. Butler, Farmington N.M. 87401 (505)325-4397

4. Location of Well (Footage, Sec., T., R., M., or Survey Description)
Sec. 29, 30, 31 T25N / R3W

12. CHECK APPROPRIATE BOX(S) TO INDICATE NATURE OF NOTICE, REPORT, OR OTHER DATA

| TYPE OF SUBMISSION | TYPE OF ACTION |
|--|---|
| <input checked="" type="checkbox"/> Notice of Intent | <input type="checkbox"/> Abandonment |
| <input type="checkbox"/> Subsequent Report | <input type="checkbox"/> Recompletion |
| <input type="checkbox"/> Final Abandonment Notice | <input type="checkbox"/> Plugging Back |
| | <input type="checkbox"/> Casing Repair |
| | <input type="checkbox"/> Altering Casing |
| | <input checked="" type="checkbox"/> Other PRODUCTION MEASURING |
| | <input type="checkbox"/> Change of Plans |
| | <input type="checkbox"/> New Construction |
| | <input type="checkbox"/> Non-Routine Fracturing |
| | <input type="checkbox"/> Water Shut-Off |
| | <input type="checkbox"/> Conversion to Injection |
| | <input type="checkbox"/> Dispose Water |

(Note: Report results of multiple completion on Well Completion or Recompletion Report and Log form.)

RECEIVED
DEC - 6 1993
OIL CON. DIV.,
DIST. 3

13. Describe Proposed or Completed Operations (Clearly state all pertinent details, and give pertinent dates, including estimated date of starting any proposed work. If well is directionally drilled, give subsurface locations and measured and true vertical depths for all markers and zones pertinent to this work.)*

Texaco E & P, Inc. proposes the following on the subject lease:
Production from the L.L. McConnell #19, 14 wells be measured in the following manner.

GAS
Texaco proposes to make the existing E.P.N.G. meter at L.L. McConnell #14 a Central-Point-Delivery(CPD) meter.

LIQUIDS
Texaco proposes to surface commingle produced fluids into a common flowline before collecting at a central tank battery located at L.L. McConnell #14 wellsite.

Each well will test Oil, Gas, & Water monthly for allocation purposes.

Refer to attached map and battery schematic.

14. I hereby certify that the foregoing is true and correct

Signed *Hector A. Villalobos* Title Senior Engineer Date 10/18/93

(This space for Federal Office use)
(Original Signed) HECTOR A. VILLALOBOS Title AREA MANAGER
RIO PUERCO RESOURCE AREA Date DEC 2 1993

Approved by _____ Title _____ Date _____
Conditions of approval, if any:

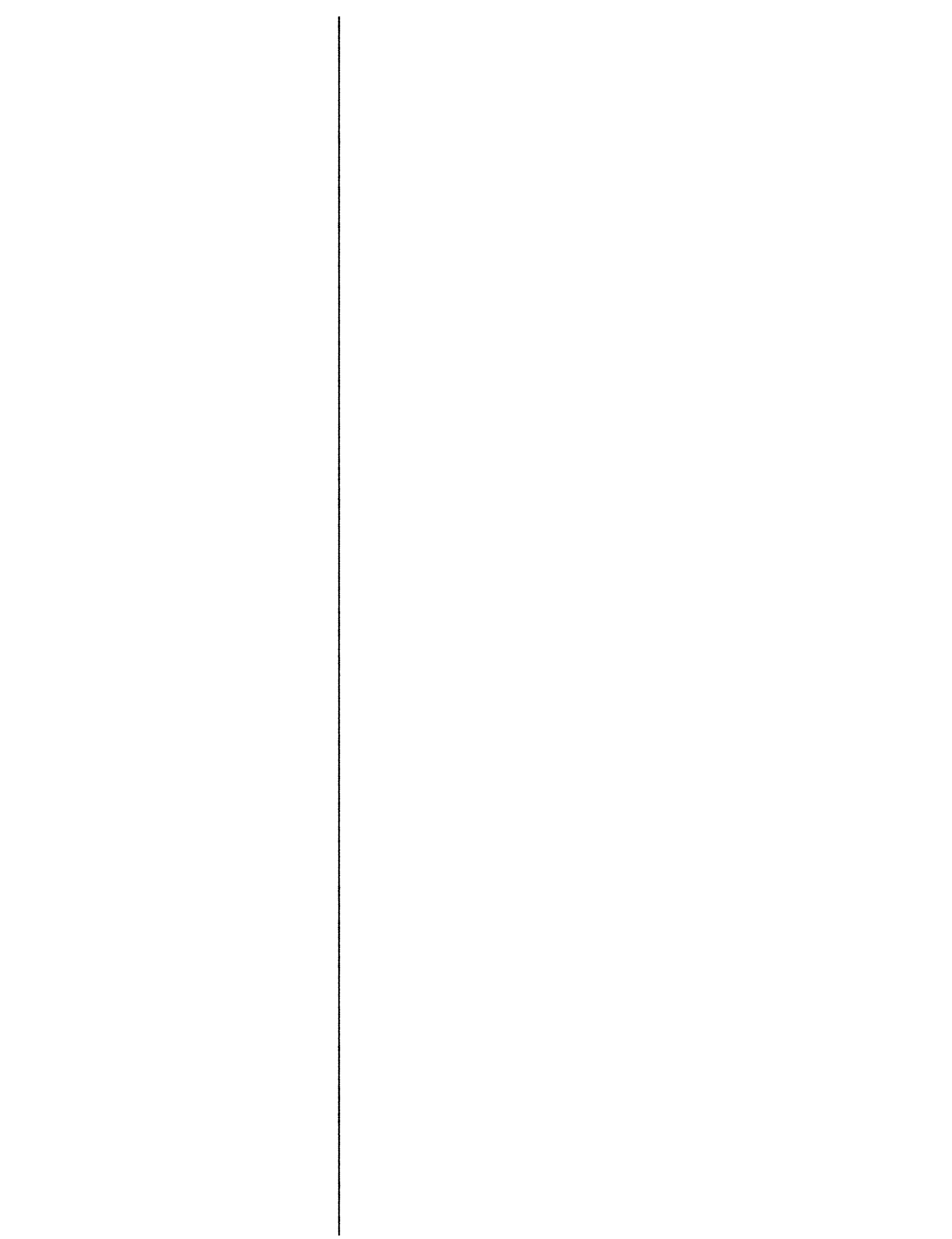

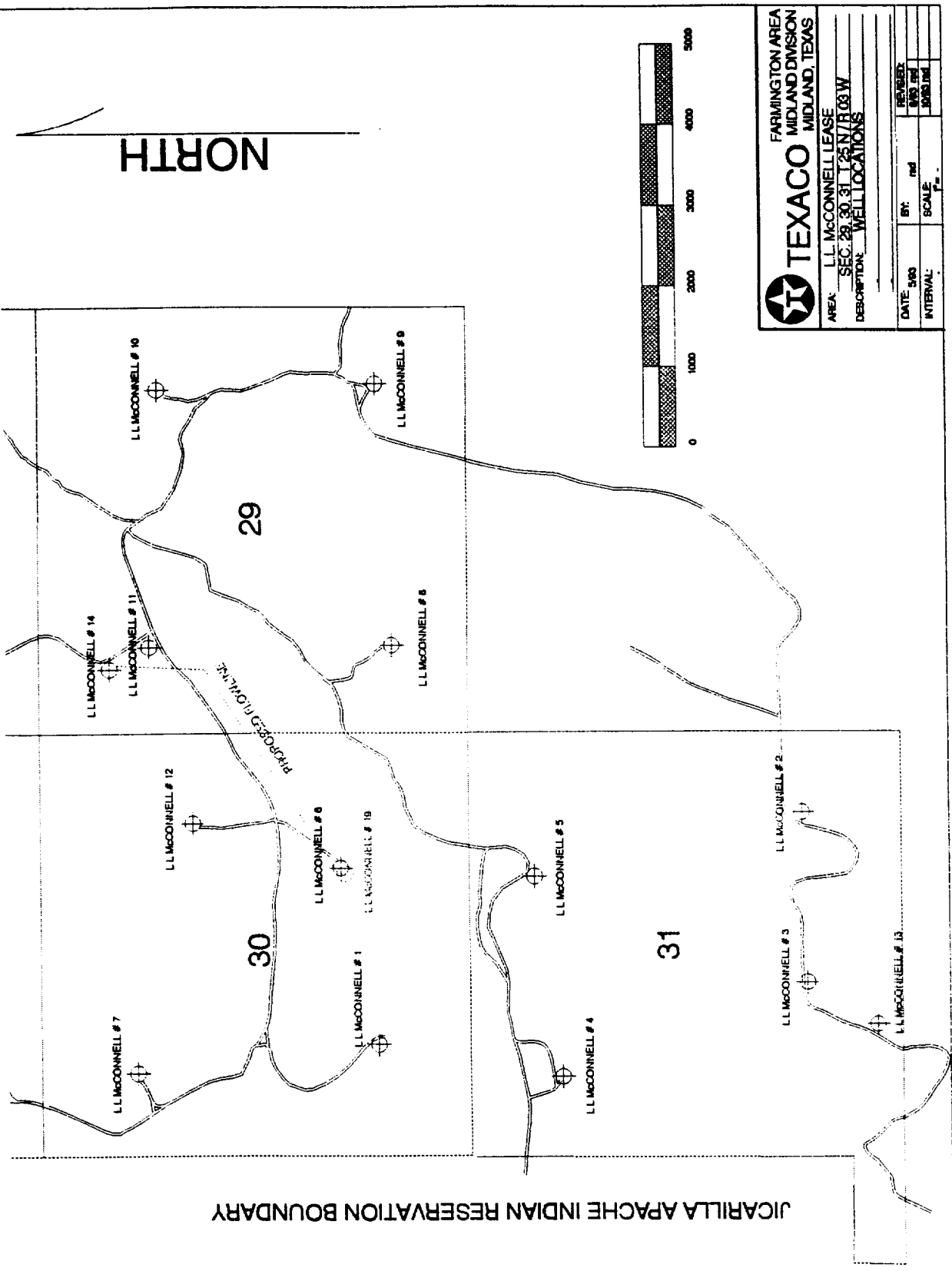

JICARILLA APACHE INDIAN RESERVATION BOUNDARY

L.L. McCONNELL #14 BATTERY

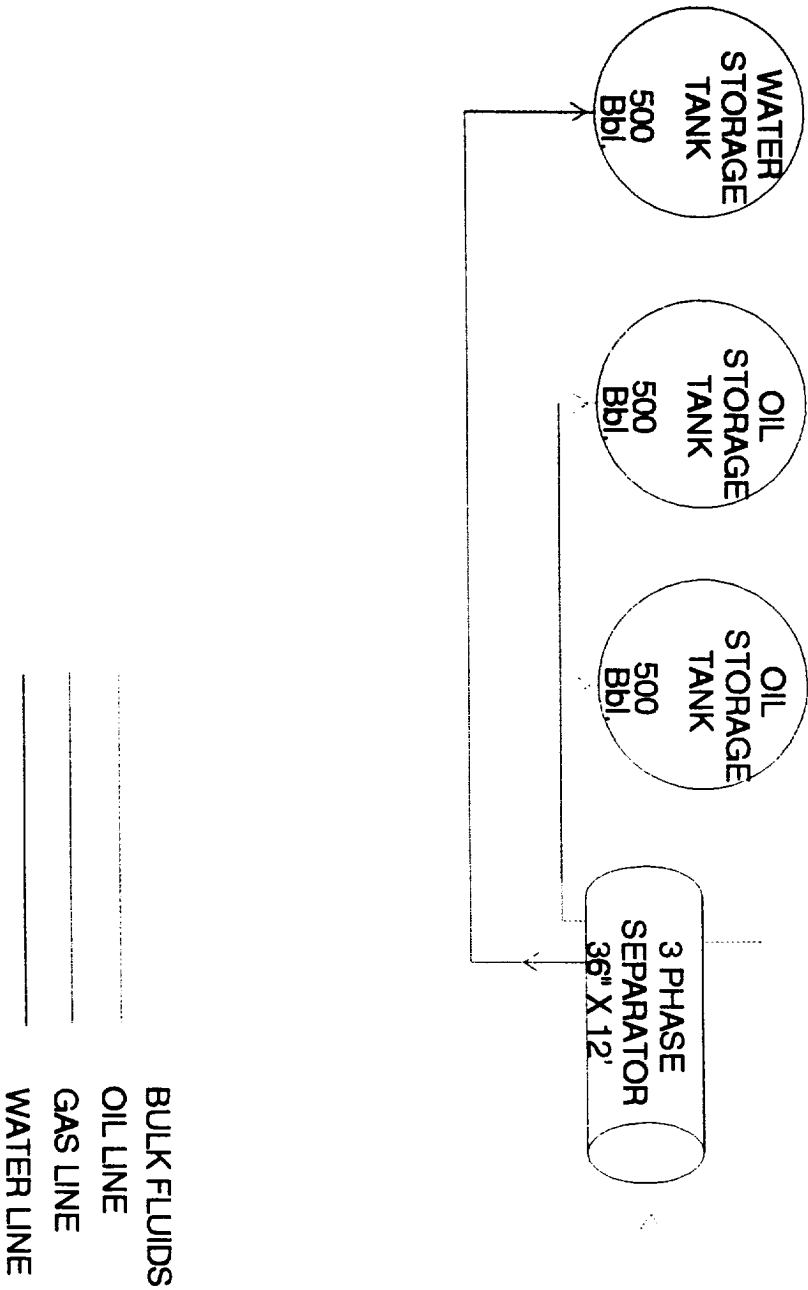

FLOWLINE FROM
L.L. McCONNELL #19
L.L. McCONNELL #14

METER
E.P.N.G.

SALES

BULK FLUIDS
OIL LINE
GAS LINE
WATER LINE

| | | | |
|--|---------|--|--|
|  TEXACO FARMINGTON AREA MIDLAND DIVISION MIDLAND, TEXAS | | AREA: L.L. McCONNELL LEASE | |
| | | DESCRIPTION: SITE SCHEMATIC L.L. McCONNELL #14 BATTERY SEC. 29, 30 T25N/R30W | |
| DATE: 9-80 | BY: SED | REVISION: | |
| INTERVAL: | SCALE: | | |
