

(SUBMIT IN TRIPLICATE)

Indian Agency Jicarilla

UNITED STATES
DEPARTMENT OF THE INTERIOR
GEOLOGICAL SURVEY

Contract #10
Allottee

Lease No.

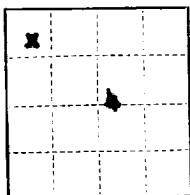

SUNDRY NOTICES AND REPORTS ON WELLS

NOTICE OF INTENTION TO DRILL	<input checked="" type="checkbox"/>	SUBSEQUENT REPORT OF WATER SHUT-OFF	
NOTICE OF INTENTION TO CHANGE PLANS		SUBSEQUENT REPORT OF SHOOTING OR ACIDIZING	
NOTICE OF INTENTION TO TEST WATER SHUT-OFF		SUBSEQUENT REPORT OF ALTERING CASING	
NOTICE OF INTENTION TO REDRILL OR REPAIR WELL		SUBSEQUENT REPORT OF REDRILLING OR REPAIR	
NOTICE OF INTENTION TO SHOOT OR ACIDIZE		SUBSEQUENT REPORT OF ABANDONMENT	
NOTICE OF INTENTION TO PULL OR ALTER CASING		SUPPLEMENTARY WELL HISTORY	
NOTICE OF INTENTION TO ABANDON WELL			

(INDICATE ABOVE BY CHECK MARK NATURE OF REPORT, NOTICE, OR OTHER DATA)

November 4, 1959

Well No. Jicarilla is located 985 ft. from N line and 605 ft. from W line of sec. 4

NW 1/4 Sec. 4 24N 5W RMP
(1/4 Sec. and Sec. No.) (Twp.) (Range) (Meridian)
Otero Rio Arriba County New Mexico
(Field) (County or Subdivision) (State or Territory)

The elevation of the ~~center~~ ^{ungrd ground} above sea level is 6729 ft.

DETAILS OF WORK

(State names of and expected depths to objective sands; show sizes, weights, and lengths of proposed casings; indicate mudding jobs, cementing points, and all other important proposed work)

Propose to set 9 5/8" surface casing at approximately 200'. Cement to surface using 175 sz regular. Drill 7 7/8" hole to T.D. of 7200'. Test Gallup and Dakota formations. Set 5 1/2" casing @ T.D. with DV Tool at Approximately 3200' or 3700' to protect Chacra and Pictured Cliffs if encountered on log. Frac Dakota and Gallup formations separately with oil-sand. Dually complete if both found productive. The North 1/2 of Sec. 4, containing 320 acres, is dedicated to this well.

I understand that this plan of work must receive approval in writing by the Geological Survey before operations may be commenced.

Company ARMED DRILLING COMPANY JOHNSTON-SHEAR

Address 3010 Monte Vista Blvd., N. E.

Albuquerque, New Mexico

By W. H. Johnston
President
Title

NEW MEXICO OIL CONSERVATION COMMISSION

Well Location and Acreage Dedication Plat

Section A.

Date November 4, 1959

Operator Johnston and Shear Lease Jicarilla
Well No. 1-4 Unit Letter D Section 4 Township 24 North Range 5 West NMPM
Located 985 Feet From North Line, 805 Feet From West Line
County Rio Arriba G. L. Elevation 6729 Dedicated Acreage 320 Acres
Name of Producing Formation Gallup-Dakota Pool Otero

1. Is the Operator the only owner* in the dedicated acreage outlined on the plat below?
Yes X No
2. If the answer to question one is "no," have the interests of all the owners been consolidated by communitization agreement or otherwise? Yes No . If answer is "yes,"
Type of Consolidation
3. If the answer to question two is "no," list all the owners and their respective interests below:

Owner

Land

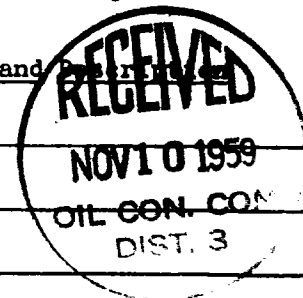

Section. B

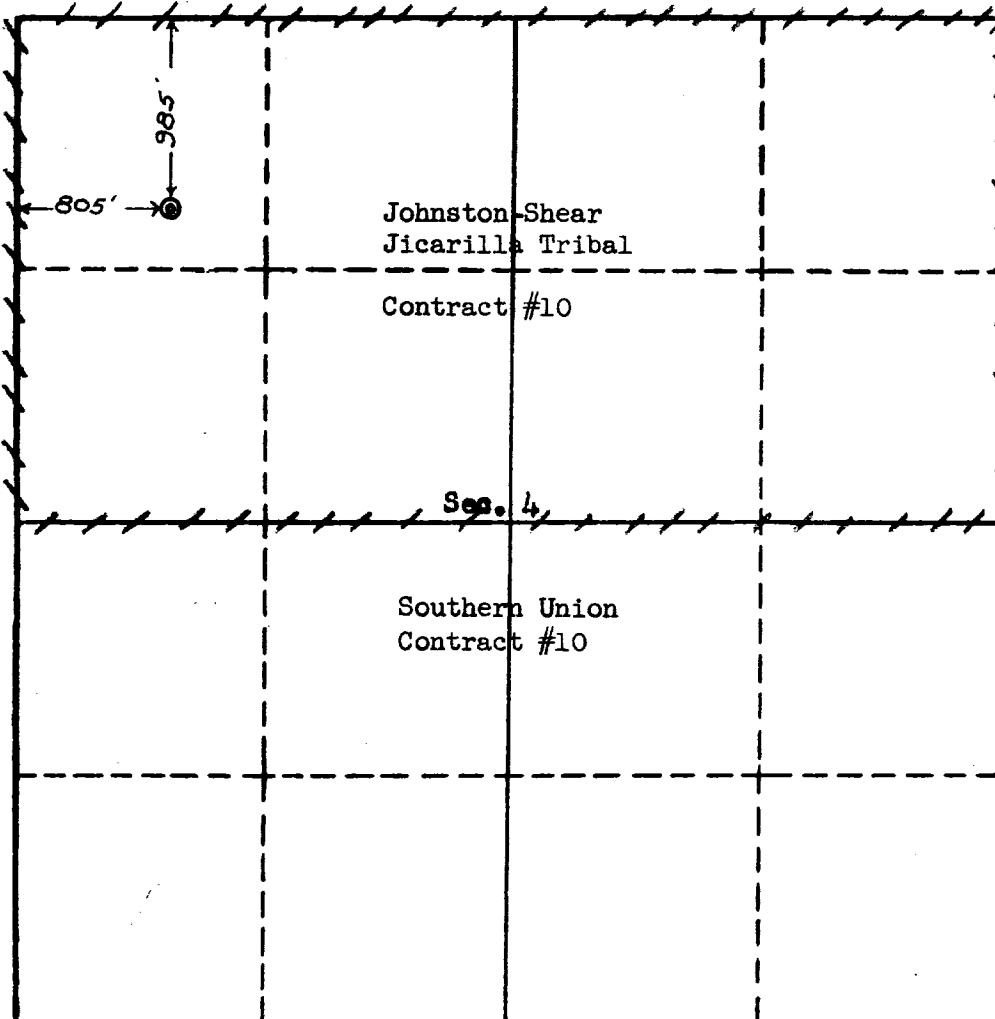

This is to certify that the information in Section A above is true and complete to the best of my knowledge and belief.

Johnston-Shear

(Operator)

W. R. Johnston

(Representative)

3010 Monte Vista, N. E.
Albuquerque, New Mexico

Address

This is to certify that the well location on the plat is true and correct from field survey, and I, the undersigned, as a Registered Land Surveyor, consider my survey to be the same as the plat to the best of my knowledge and belief.

Date Surveyed October 20, 1959

Ernest V. Echohawk
Ernest V. Echohawk
Registered Land Surveyor.

Certificate No. 1545