

(SUBMIT IN TRIPLICATE)

UNITED STATES
DEPARTMENT OF THE INTERIOR
GEOLOGICAL SURVEY

Land Office Santa Fe
Lease No. MM 0175780
Unit _____

SUNDRY NOTICES AND REPORTS ON WELLS

NOTICE OF INTENTION TO DRILL	<input checked="" type="checkbox"/>	SUBSEQUENT REPORT OF WATER SHUT-OFF
NOTICE OF INTENTION TO CHANGE PLANS	<input type="checkbox"/>	SUBSEQUENT REPORT OF SHOOTING OR ACIDIZING
NOTICE OF INTENTION TO TEST WATER SHUT-OFF	<input type="checkbox"/>	SUBSEQUENT REPORT OF ALTERING CASING
NOTICE OF INTENTION TO RE-DRILL OR REPAIR WELL	<input type="checkbox"/>	SUBSEQUENT REPORT OF RE-DRILLING OR REPAIR
NOTICE OF INTENTION TO SHOOT OR ACIDIZE	<input type="checkbox"/>	SUBSEQUENT REPORT OF ABANDONMENT
NOTICE OF INTENTION TO PULL OR ALTER CASING	<input type="checkbox"/>	SUPPLEMENTARY WELL HISTORY
NOTICE OF INTENTION TO ABANDON WELL	<input type="checkbox"/>	

(INDICATE ABOVE BY CHECK MARK NATURE OF REPORT, NOTICE, OR OTHER DATA)

January 16, 1962

Well No. 1 is located 990 ft. from N line and 990 ft. from W line of sec. 27

NW/4 - 27 24 North 1 West NMPM
(1/4 Sec. and Sec. No.) (Twp.) (Range) (Meridian)

Undesignated Rio Arriba New Mexico
(Field) (County or Subdivision) (State or Territory)

The elevation of the ~~surface~~ ^{ground} floor above sea level is 7258 ft.

DETAILS OF WORK

(State names of and expected depths to objective sands; show sizes, weights, and lengths of proposed casings; indicate mudding jobs, cementing points, and all other important proposed work)

To set a minimum of 100 feet of 8 5/8" surface casing and cement with 100 sacks. To drill with rotary tools to an approximate total depth of 3250 feet. To run electric log to total depth. If productive, to set approximately 3250 feet of 4 1/2" casing, and cement with 100 sacks. To perforate the Pictured Cliffs sand, sand-water frac, and run 1 1/2" tubing. To comply with the rules and regulations of the U.S.G. and the New Mexico Oil and Gas Commission.

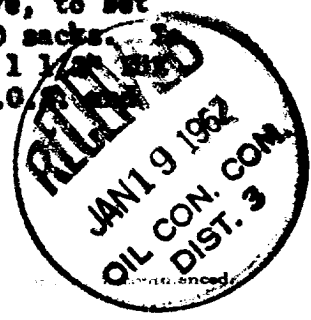

I understand that this plan of work must receive approval in writing by the Geological Survey before operation.

Company SHAR-ALAN OIL COMPANY
Address 1402 Denver U. S. National Center
Denver 2, Colorado

Send approval to:
By Richard S. Hunt
Title Mgr., Lands and Exploration
Box 1428, Durango, Colorado

NEW MEXICO OIL CONSERVATION COMMISSION Well Location and Acreage Dedication Plat

SECTION A.

Date September 19, 1961

Operator Shaw-Alan Oil Company

Lease Edwards-Federal 11 0175740

Well No. 1 Unit Letter _____ Section 27 Township 24 North Range 1 West

NMPM

Located 990 Feet From North Line, 990 Feet From West Line

County Albuquerque G. L. Elevation 7258 Dedicated Acreage 1/4 160 Acres

Name of Producing Formation Pictured Cliffs Pool Undesignated

1. Is the Operator the only owner* in the dedicated acreage outlined on the plat below? Yes X No _____
2. If the answer to question One is "No," have the interests of all the owners been consolidated by communitization agreement or otherwise? Yes _____ No _____. If answer is "Yes," Type of Consolidation _____
3. If the answer to question Two is "No," list all the owners and their respective interests below:

OWNER

LAND DESCRIPTION

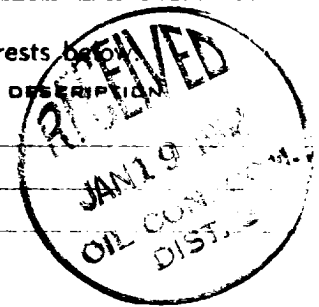

SECTION B.

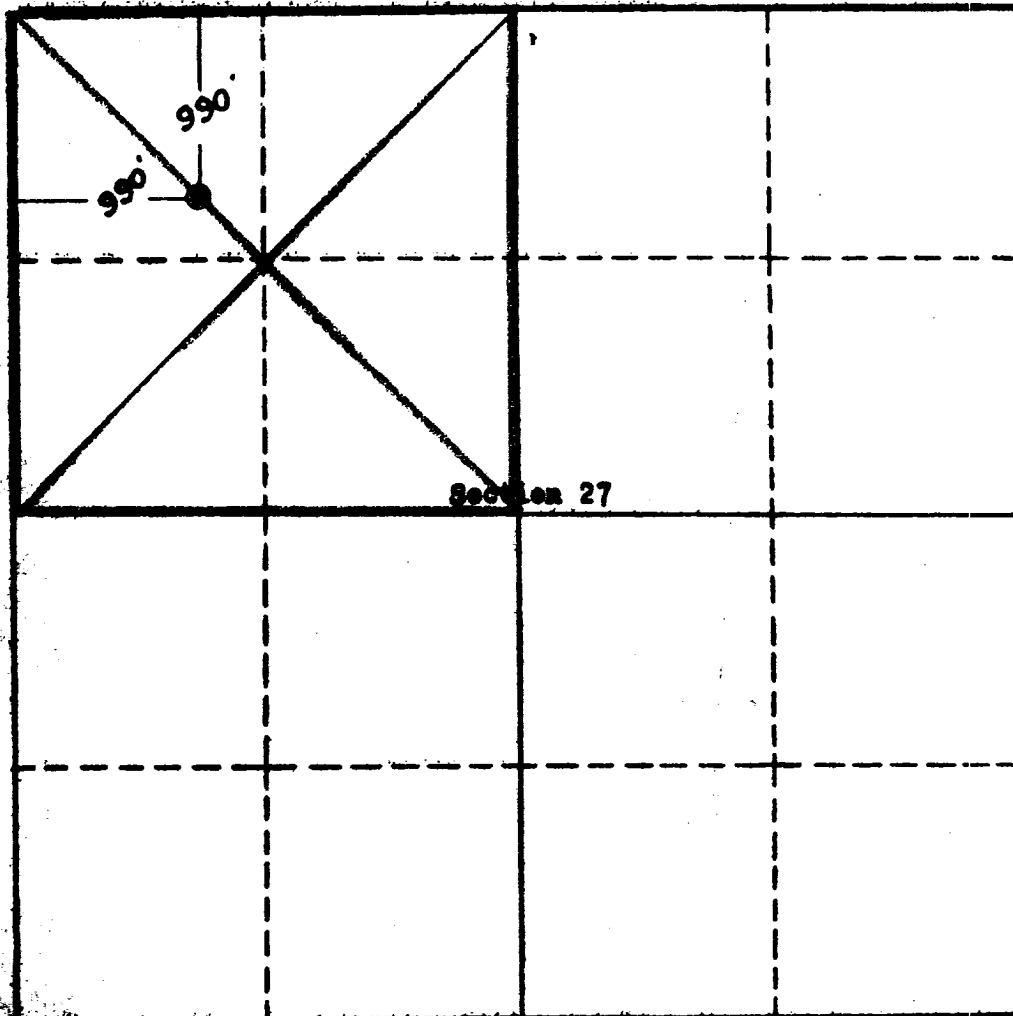

This is to certify that the information in Section A above is true and complete to the best of my knowledge and belief.

Shaw-Alan Oil Company
(OPERATOR)

By: Richard G. Hunt
Mgr. Lands & Exploration
Box 1428
Durango, Colorado
(ADDRESS)

This is to certify that the well location shown on this plat in Section B was plotted from field notes of actual survey made by me or under my supervision and that the same is true and correct to the best of my knowledge and belief.

Date Surveyed November 10, 1961

Four States Engineering Co.
FARMINGTON, NEW MEXICO

C. L. Poter
REGISTERED ENGINEER OR
LAND SURVEYOR

Certificate No. 3084

